

NUCRAFT

Installation Instructions

Ativa
ID: 058

Before Beginning Installation

- Read through the entire instruction thoroughly
- A minimum of 2 persons is required for this assembly
- If damage is found, STOP. Document damage and packaging and report to dealer.

Required Tools

- Drill Driver
- #2-#3 Phillips Bit
- ½" Nut Driver
- Laser Level
- Provided: Draw-Tight Fastener Tool

- Provided Hardware:

- Doubled Ended Pin HW0459



- Single Ended Pin HW0456



- HW0613



- HW4640



- HW1093, HW1094, HW0266

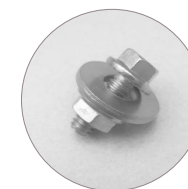

Ativa Enclosed with Door Access

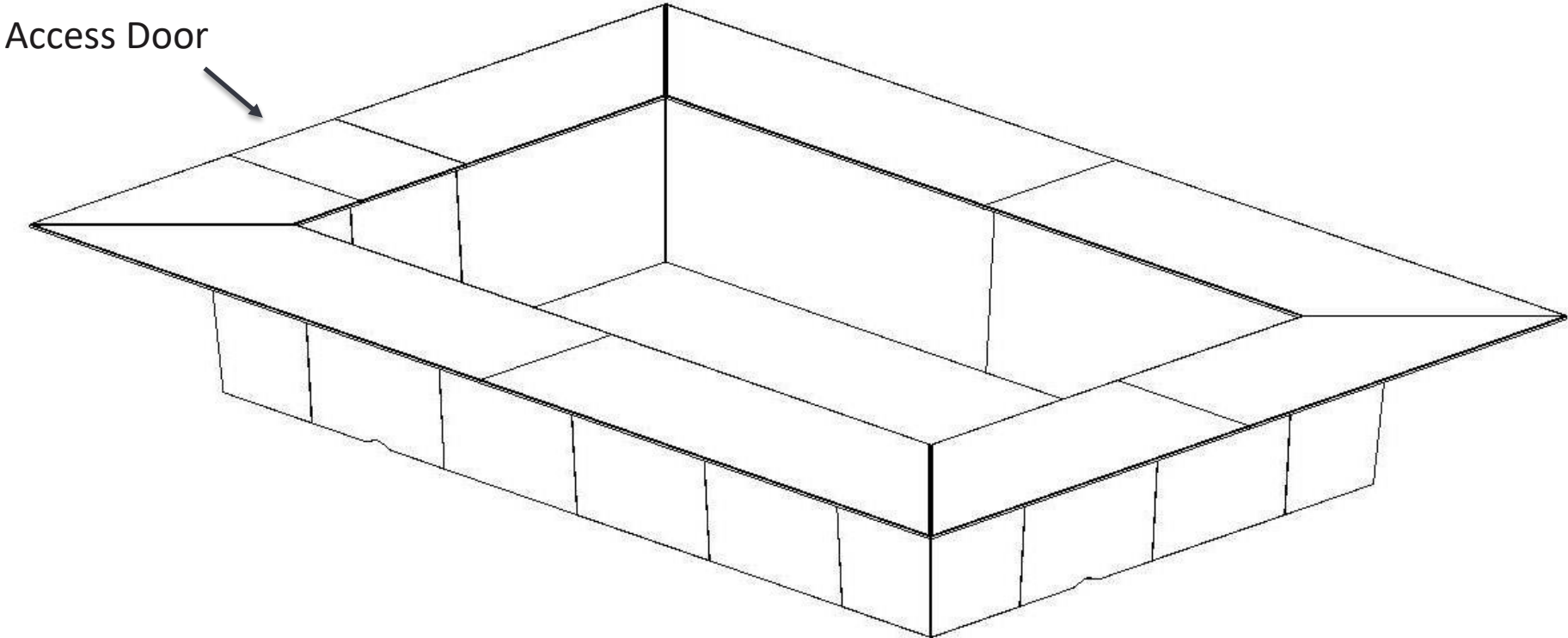

Ativa U-Shape Exploded

1. Top
2. Shroud
3. Modesty Panel
4. End Panel
5. Support Frame
6. Access Panel

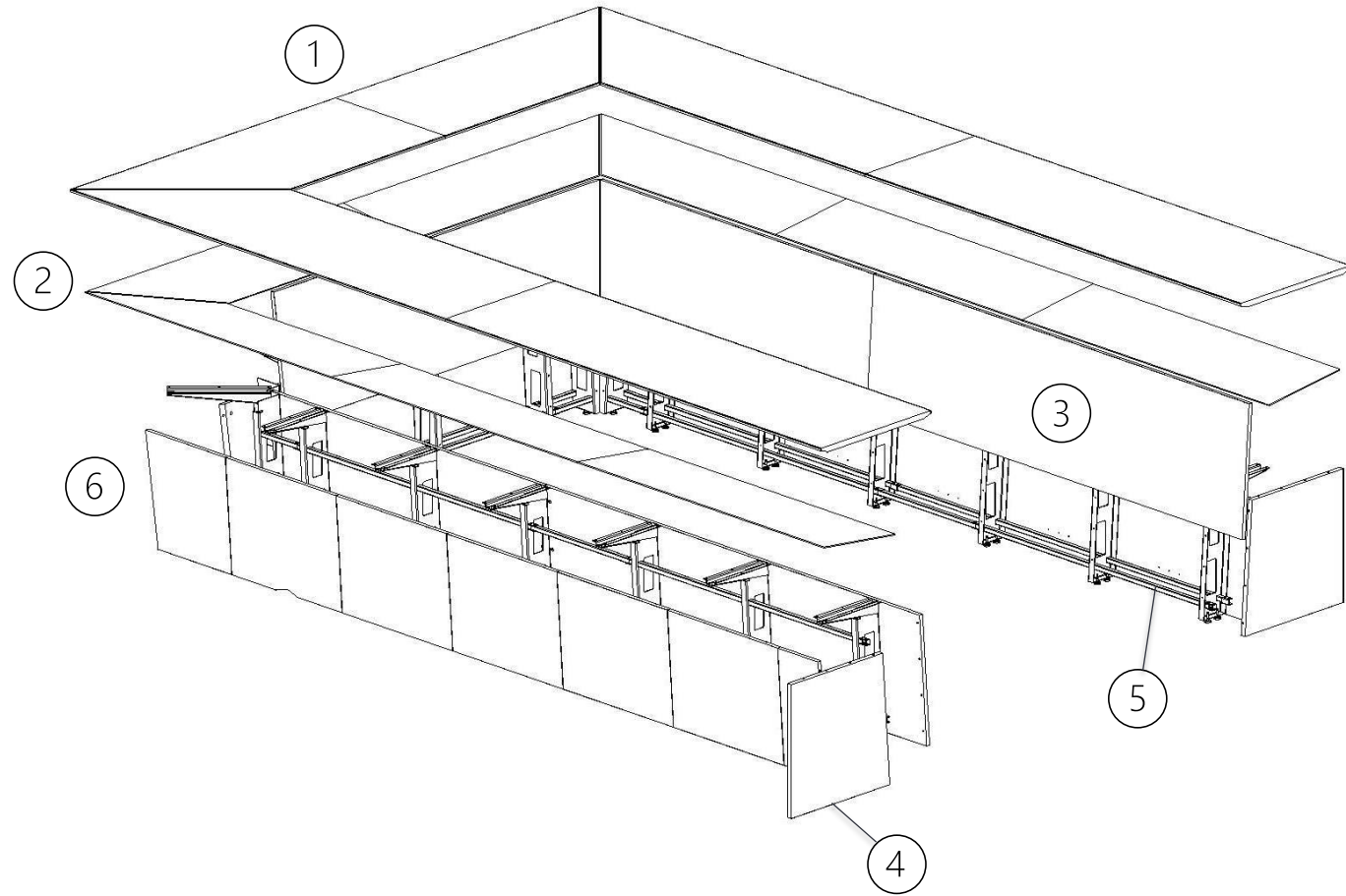

Step 1: Layout and Support Frame Installation

- Remove parts from packaging, using care to avoid any damage.
- Arrange support frame on a clear, stable surface.
 - Panels are labeled for proper alignment.
- NOTE: This is when the table should be placed in desired location and the frame leveled.
 - It is difficult to build table and then move to desired location; damaged will occur.

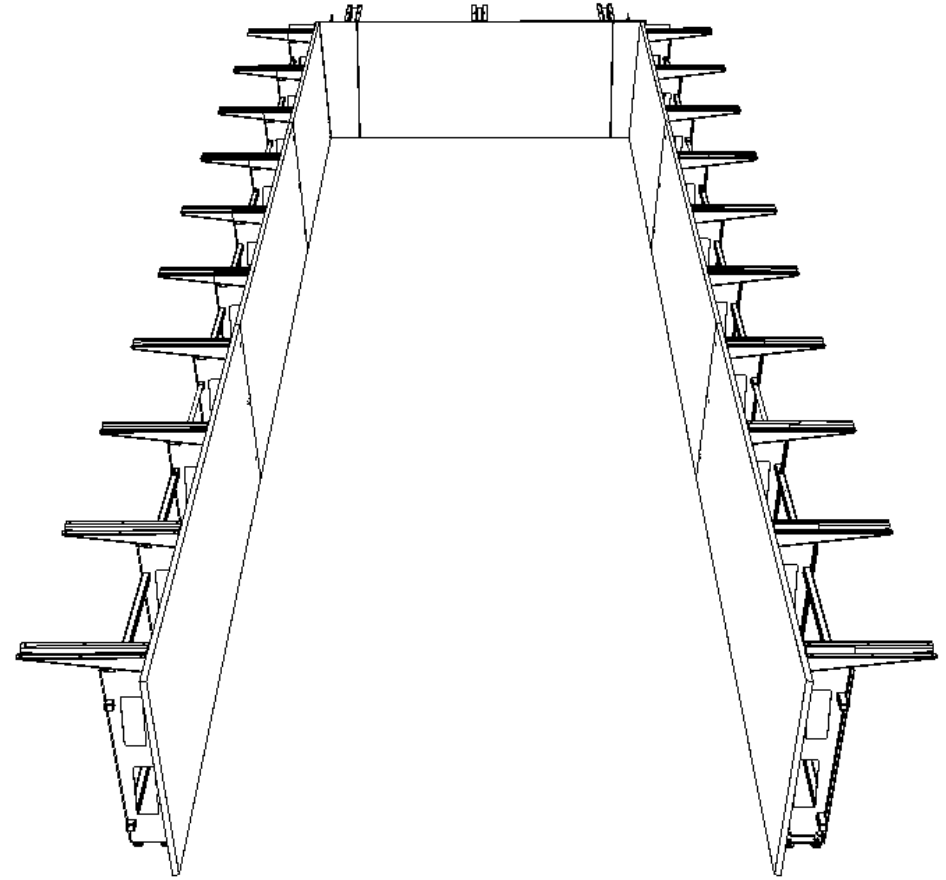

Step 2: Connecting Support Frame Panels

- Connect base sections by joining modesty panels together with cams using the double ended pins.
- Loosely insert Black Steel Rod into Square Tubes of Base Frame to join Frames together structurally.
- Level the top of each modesty panel to the next as they are joined.
- When the panels, shift the mending plates over to keep the seam closed tightly and the fronts flush.
- Align corners to trim piece and fasten with HW0817.
- Tighten bolts on the frame to secure black steel rods once all panels are connected.
- When base is level, ensure ALL glides are touching the floor.

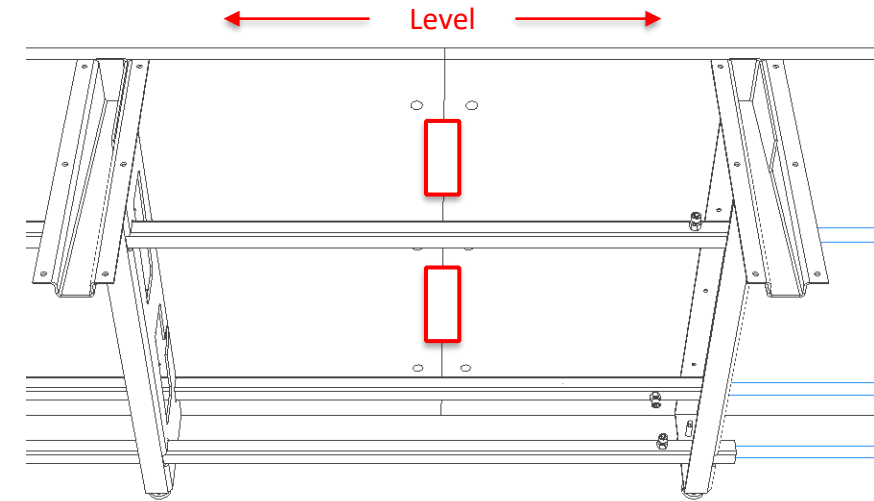
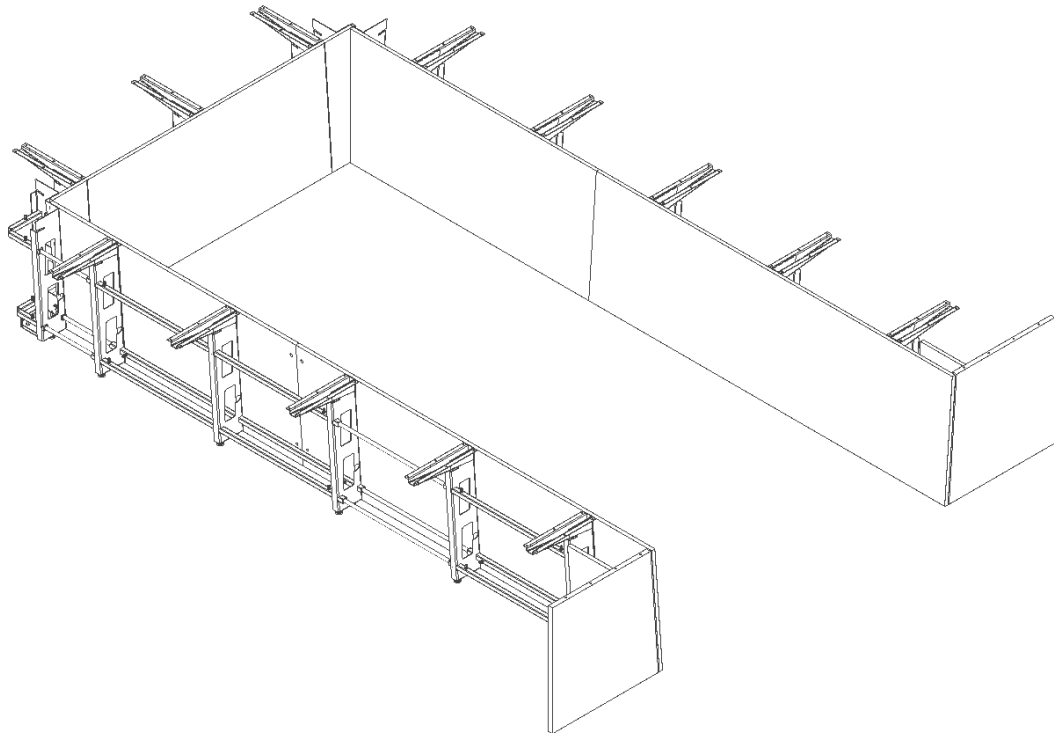

Shift Mending Plates to Close Gap and Flush Fronts

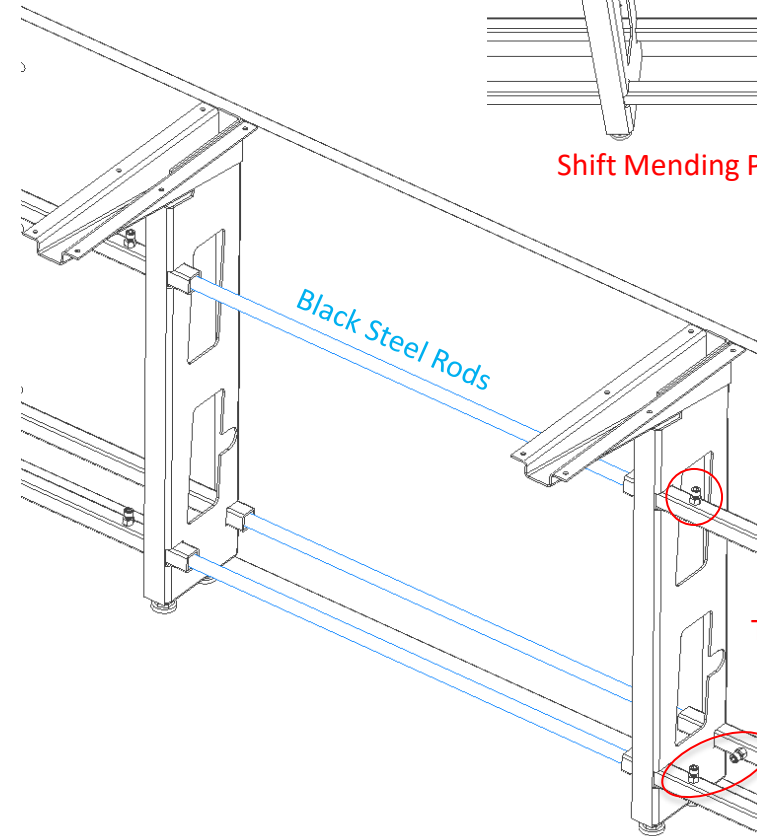

Step 3: Installing Tops

DO NOT install corner frames until top has been installed and tight jointed together.

- Place tops over the base frames.
 - Reference the trace marks on the underside of the tops to align with frame gussets.
- Place draw-tight fasteners in the grooves at each seam. Tighten with the provided draw-tight fastener tool.
- Fasten all tops to base frame with HW4640.

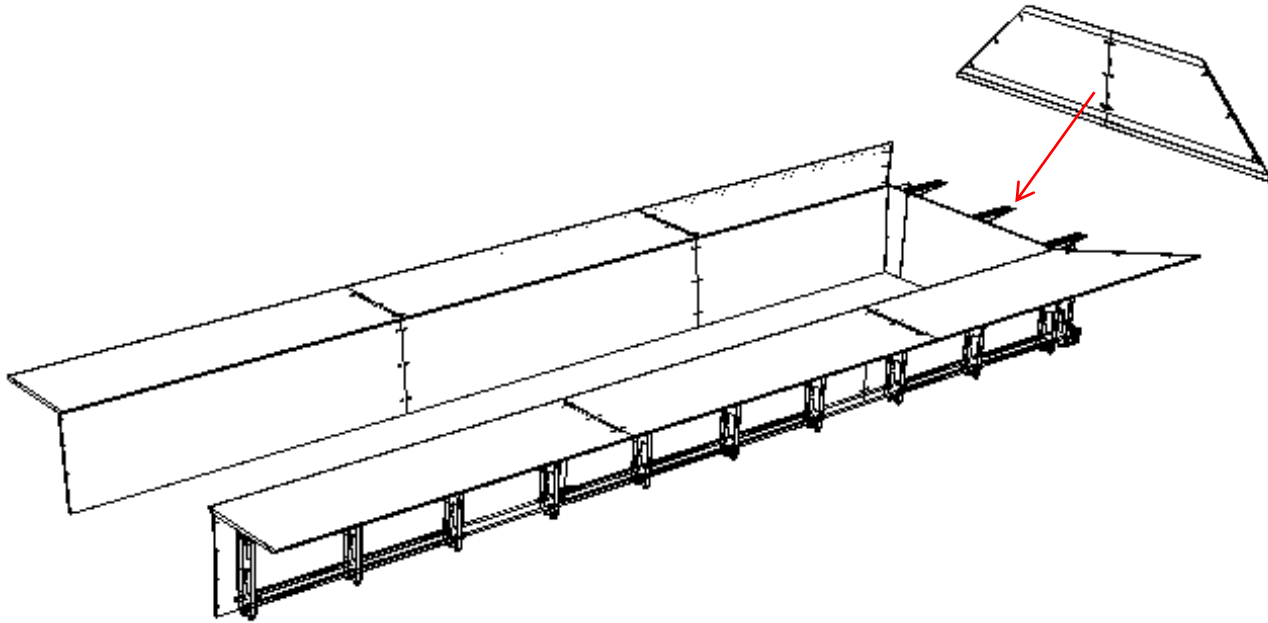

Draw Tight Fastener

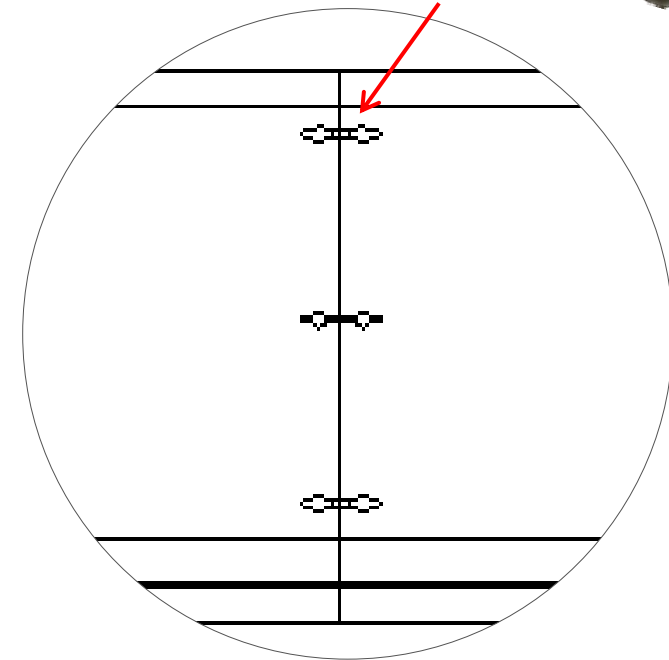

Step 4: Installing Corner Supports

- Place corner support in place.
- Attach connecting rods and tighten the ½" bolts once in place.
- Align the corner and fasten to modesty panels using HW0613.
- Lower glides to ensure corner is providing support.
- Attach to worksurface using HW4640.

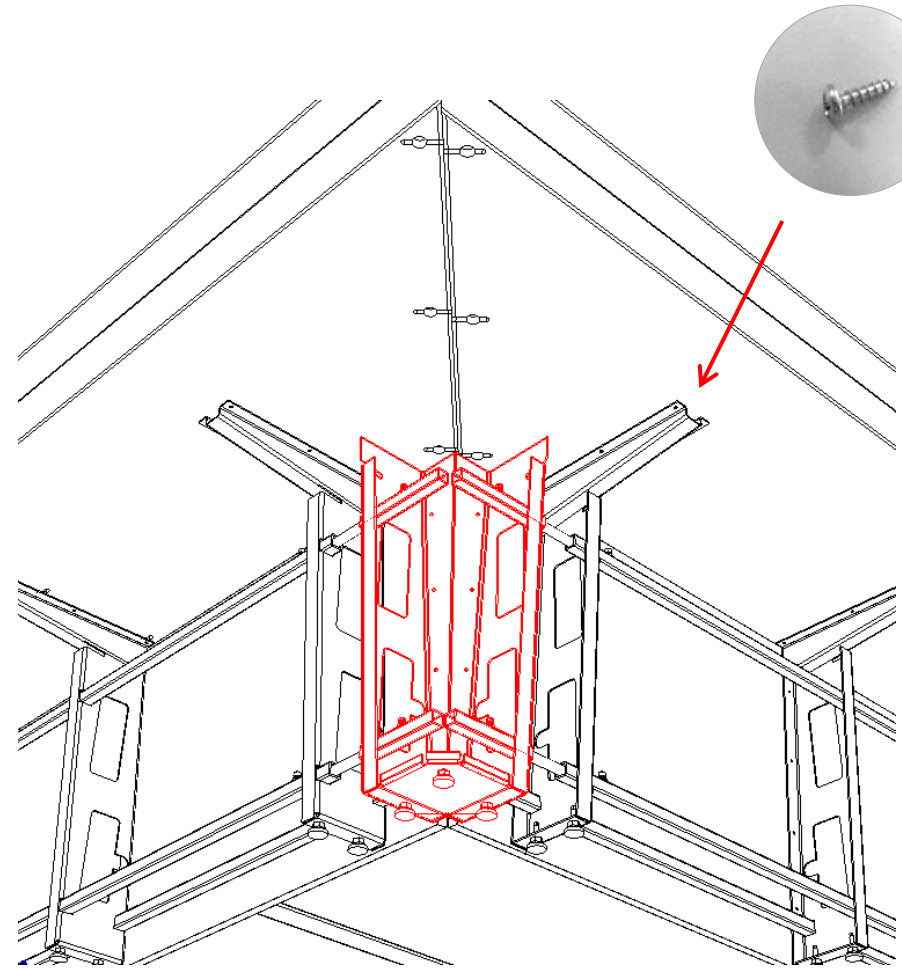
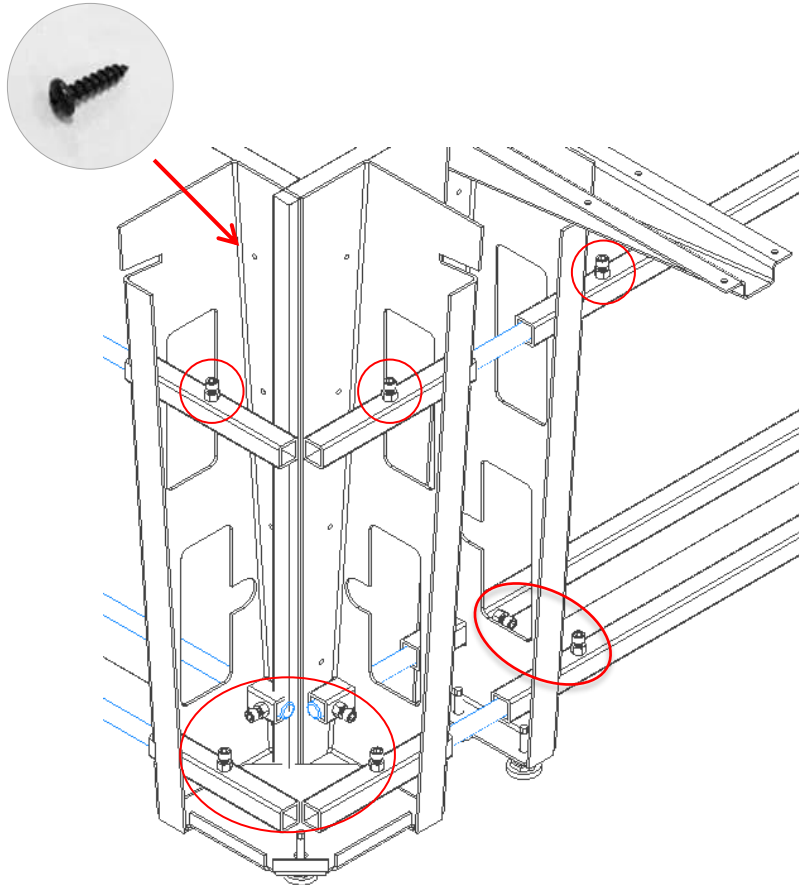

Step 5: Installing Wiring

Once all tops and base frames are set, feed electrical through the base frames.

NOTE: This can be done later with additional wiring.

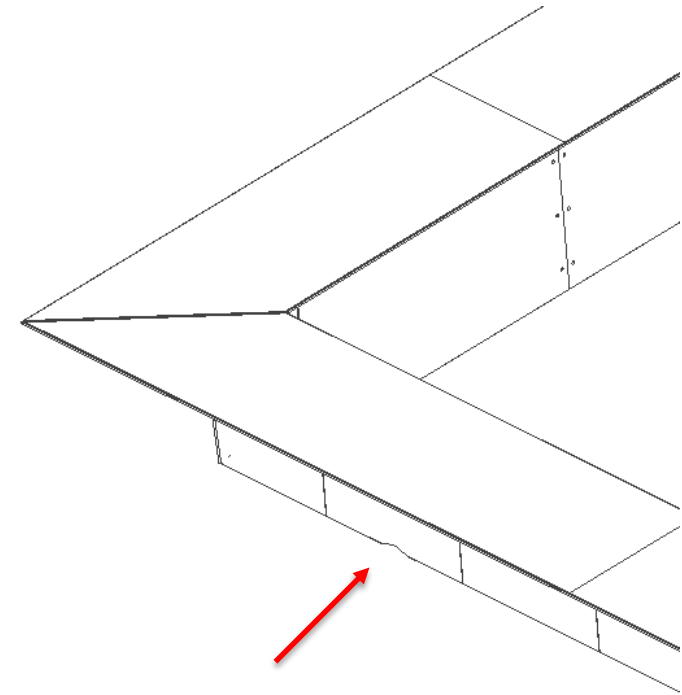
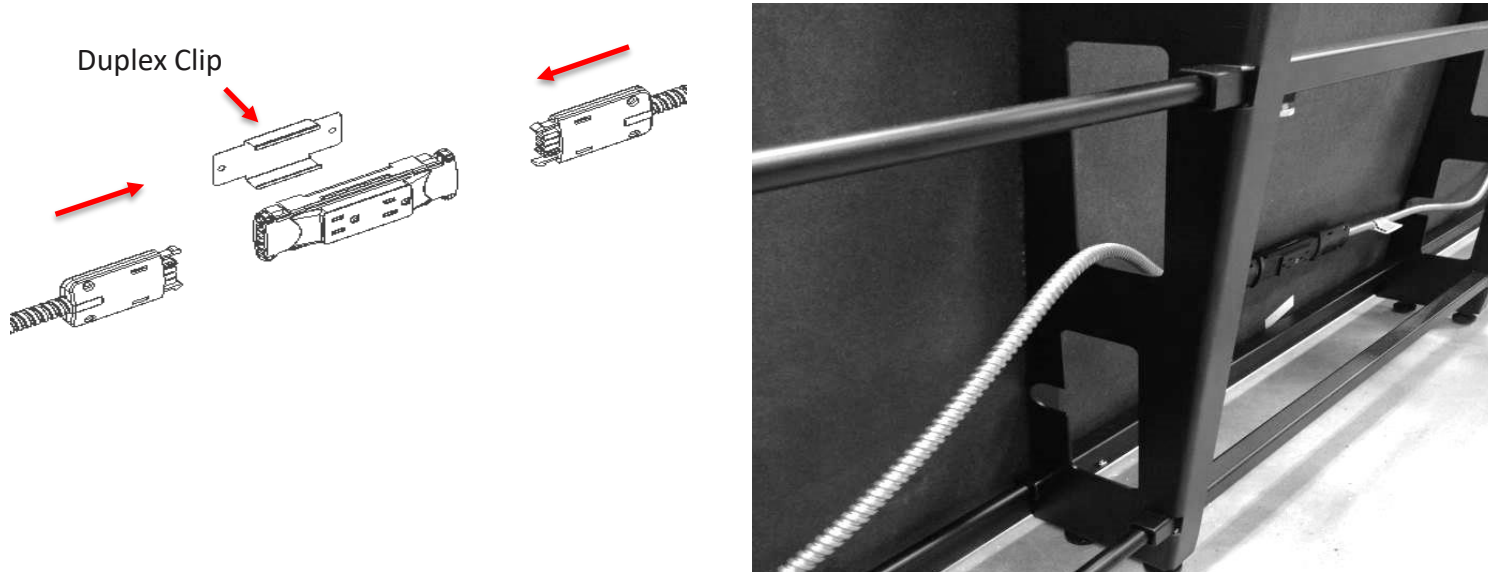

- Wire the power infeed as shown in the figure to the right.
- Run the power infeed through the table framework to the required location to supply power to the modular power system.

Note: If the floor core is outside the base, the access panel with the scallop can be repositioned to allow the infeed to exit the base.

Electrical Diagram — Hardwire Power Infeed Only

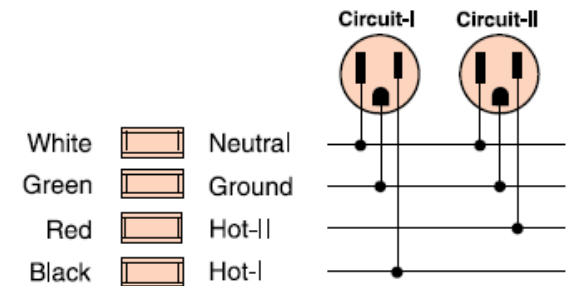

Step 6: Installing Access Doors (If Specified)

Enclosed tables only:

- Install access door once tops are in place.
 - NOTE: Tops may need minor adjustments for door to fit properly.
- Top door is fastened with the provided piston hinges.
 - Attach the hinge to the top door using HW0613.
- Bottom doors snap onto the hinge plates.



Step 7: Installing Shrouds

- Install shrouds onto underside of table. Shrouds are labeled in a numerical order.
- Shrouds ride in the channel on the underside of the top and held in place by the washer nut and bolt in base frame assembly.
- Loosen pre-installed Washer, Nut and Bolt. Slide hardware to contact shroud to secure in place.
- Where two shrouds meet, use clear trim piece to join.

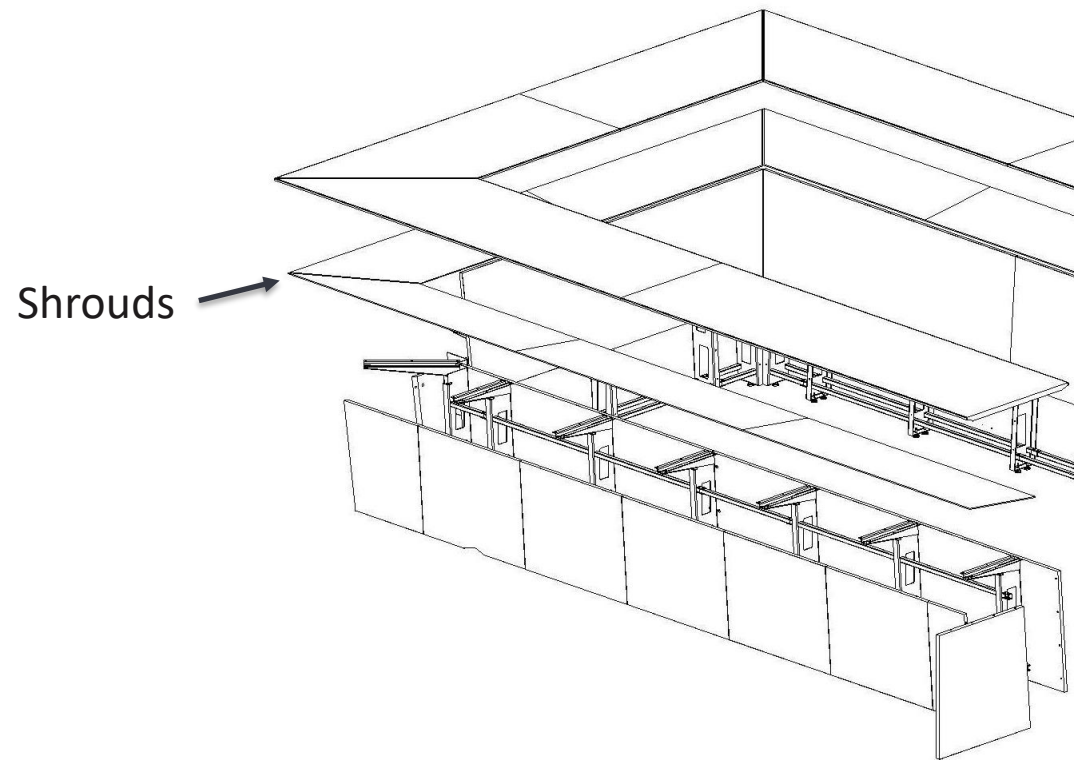
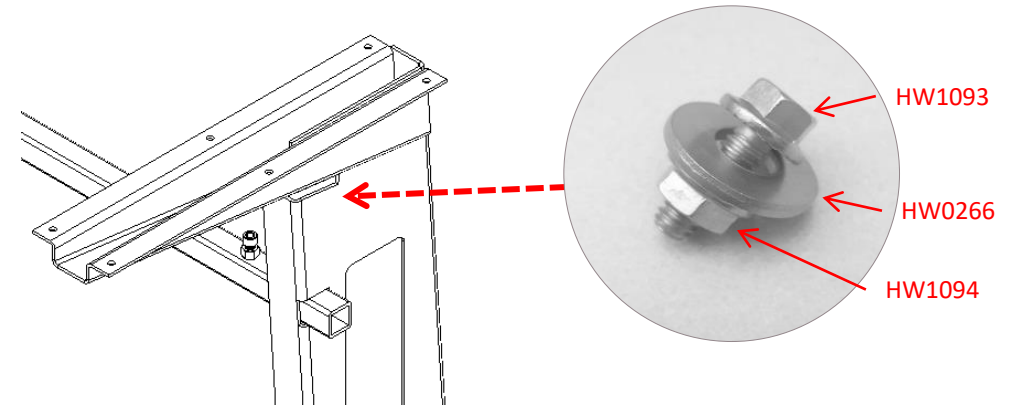

Step 8: Installing Access Panels

Attach access panels to the frame:

- Panels are labeled on the back side in numerical order.
- Panels attach with preinstalled z-hooks that hang on the frame.
- For Access Panels that hang on black steel rods, attach access panel shim to the z-hook. Peel the backer off the double-sided tape and press into the z-hook. Be sure the shim is pressed all the way to the front of the z-hook, and not towards the back by the panel.
- Hang panel by the z-hook.

