

# CAMBIUM™

## Planning Guide + Price List

---

### QUICK LINKS

[PLANNING GUIDE](#)[CAMBIUM TYPICALS](#)[CAMBIUM PRICING](#)[SMALL MEETING TABLES](#)[POWER AND DATA OPTIONS](#)[GENERAL INFORMATION](#)[FINISH INFORMATION](#)[SURFACE MATERIALS](#)



## TECHNOLOGY ACCOMMODATION

Cambium provides well-planned wire management for each component. Its standard technology accommodation offering meets most needs, and additional, scalable options are available to support even the most technology intensive environments.

### 1 WORK SURFACE GROMMETS.

Grommets can be specified on the work surfaces of desks, credenzas, bridges, and returns. Grommets can be specified in right, left, or center positions of desks, credenzas and returns, and in the center position on bridges.

### 2 J-CHANNEL.

J-Channel provides wire management beneath Cambium worksurfaces.

### 3 CONTINUOUS WIRE PASS THROUGH.

Tackboard extends 3" below the work surface creating a continuous slot for wire management. The pass-through has a larger opening at the ends and extends the entire length of the worksurface, allowing wire management anywhere the user requires it. Wire pass-through requires knee space and is not included when credenza is filled with storage components.

### 4 ACCESS PANELS.

Optional flip-down wire management Access Panel is available on back credenzas, returns, and bridges.

### 5 HEIGHT ADJUSTABLE BASE ENCLOSURE.

Includes a removable hinged access panel with a cutout in the back panel to access electrical or data ports. Base includes vertical wire management column to conceal loose cables.

### 6 Panel Leg with Access Door.

Aligns with adjacent height adjustable wall support. Includes a hinged access panel, wire management cavity, and 10.25"w x 20"h cutout in back panel to access electrical and data ports.

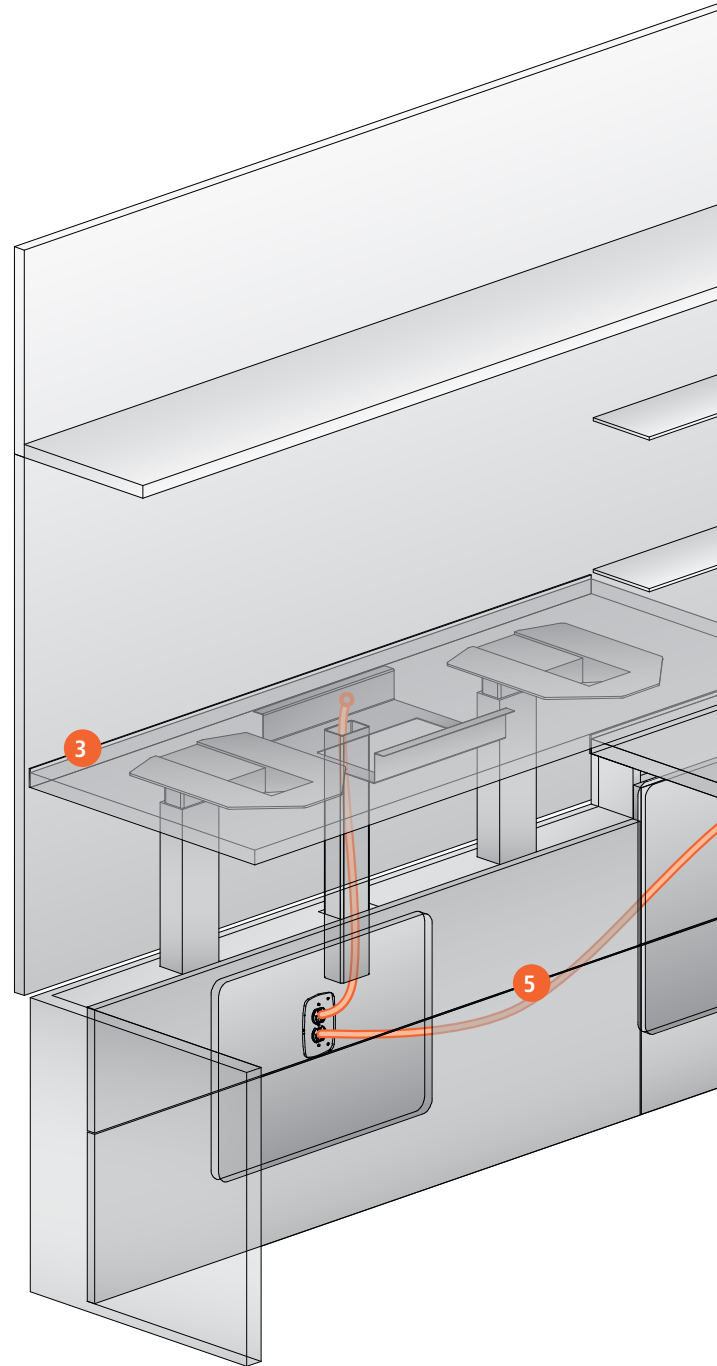

Adjustable Height Work Surface



# TECHNOLOGY ACCOMMODATION

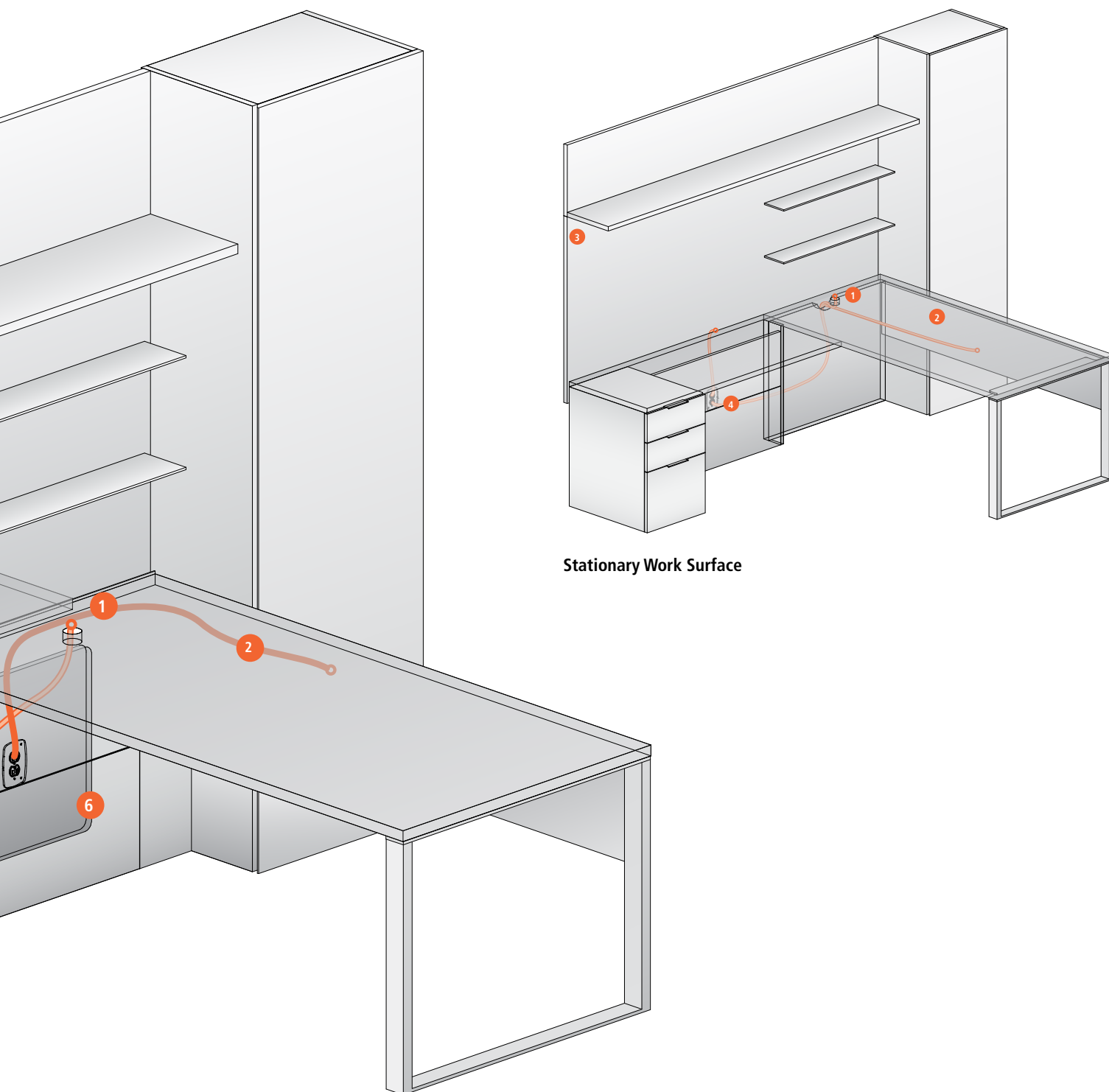



# WIRE MANAGEMENT

## FREESTANDING DESK WITH ADJUSTABLE HEIGHT PANEL BASE

The Freestanding Desk with Adjustable Height Panel Base includes a rectangle work surface, two panel bases, wire management trough and modesty panel.

- Adjustment range from 28" to 46"
- Features a wire management trough with a flexible wire manager
- See page 26 for available sizes and specification requirements

## CONFIGURATIONS

- Model Number CBAFD-3672-V
- Reference Typical CAM-01-FS, page 13

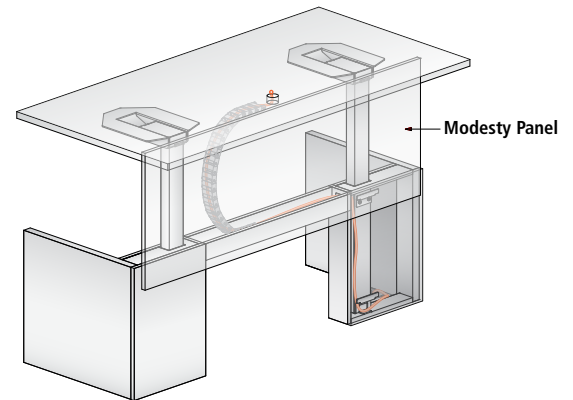

## DIMENSIONS

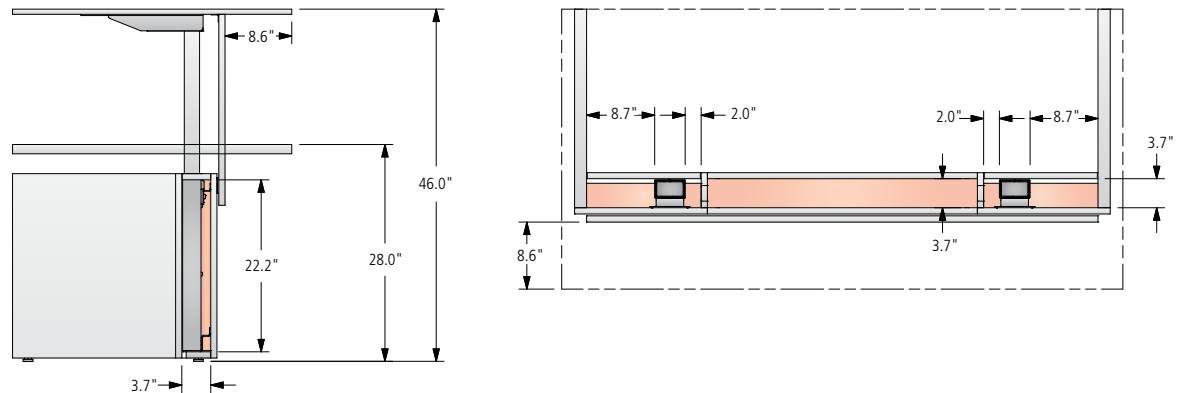

## PROGRAMMABLE CONTROLLER

The programmable controller features up/down buttons, four programmable preset stops, and a digital readout that displays the worksurface height.

## RECOMMENDED ACCESSORIES

- Freestanding Storage Pedestal (page 42)
- Plug Strip (page 43)
- Storage Drawer (page 43)

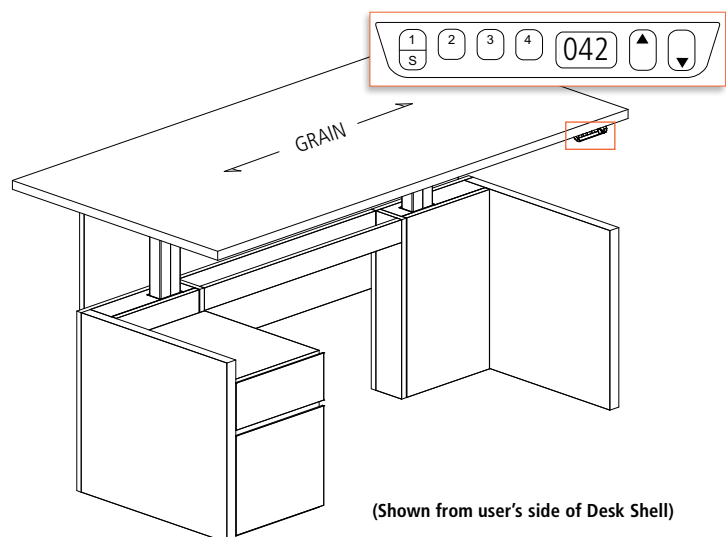



# WIRE MANAGEMENT

## RUN-OFF DESK WITH ADJUSTABLE HEIGHT PANEL BASE

The Run-Off Desk with Height Adjustable Panel Base includes a rectangle work surface, two panel bases, wire management trough and modesty panel.

- Adjustment range from 28" to 46"
- Features a wire management trough with a flexible wire manager
- See page 26 for available sizes and specification requirements

## CONFIGURATIONS

- Model Number CBARO-3672-V
- Reference Typical CAM-03-L and CAM-04-T, page 14

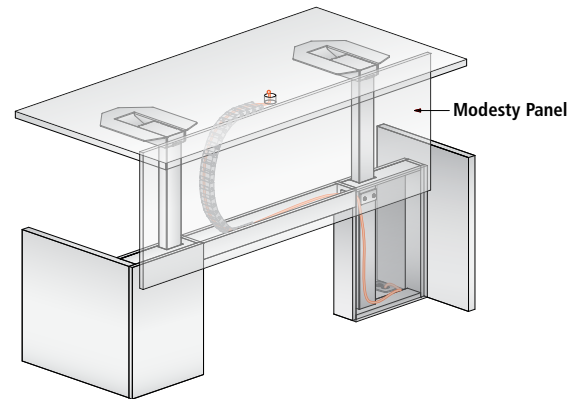

## DIMENSIONS

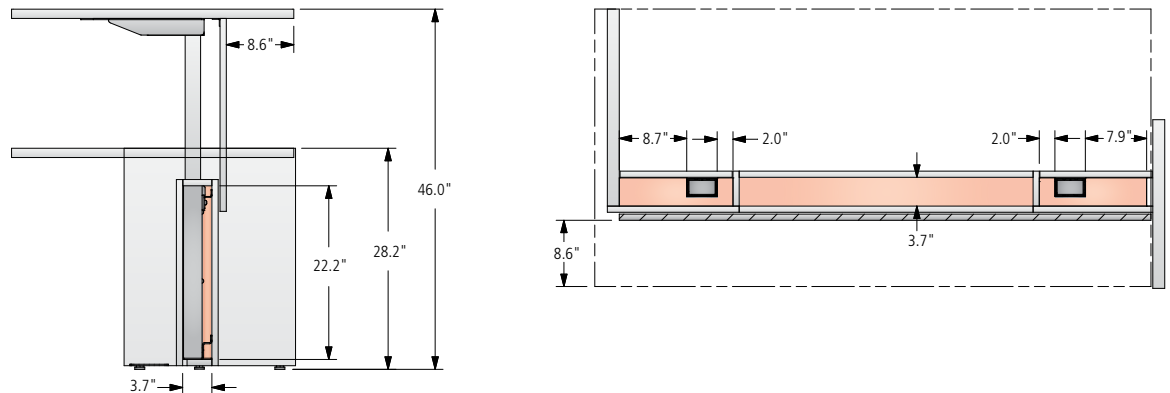

## PROGRAMMABLE CONTROLLER

The programmable controller features up/down buttons, four programmable preset stops, and a digital readout that displays the worksurface height.

## RECOMMENDED ACCESSORIES

- Freestanding Storage Pedestal (page 42)
- Plug Strip (page 43)
- Storage Drawer (page 43)

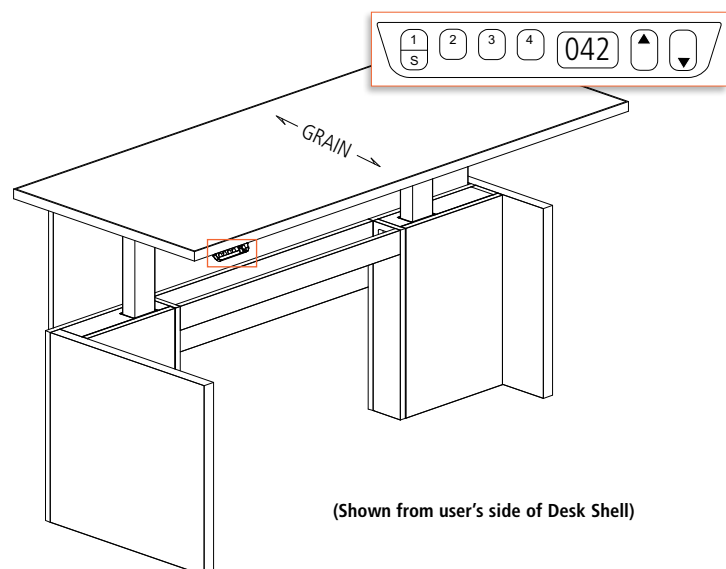

PLEASE NOTE: The grain direction of wood grain laminate runs opposite of image above. Grain direction for laminate always runs the length of the work surface.



# WIRE MANAGEMENT

## FREESTANDING DESK AND RUN-OFF DESK WITH ADJUSTABLE HEIGHT T-LEG BASE

The Freestanding Desk and Run-Off Desk with Adjustable Height T-Leg Base includes a rectangle work surface with a metal column base and modesty panel.

- Adjustment range from 28" to 46"
- See page 28 for available sizes and specification requirements

## CONFIGURATIONS

- Model Number CBAR-3072-V
- Reference Typical CAM-02-L, page 13

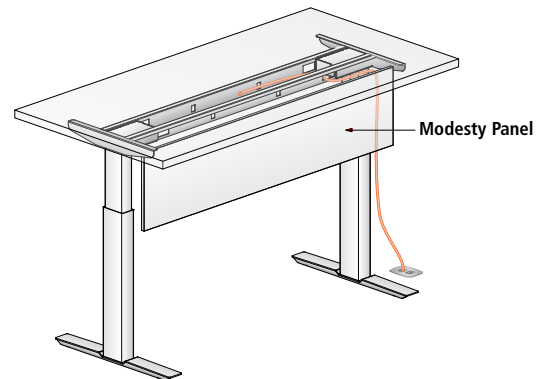

## DIMENSIONS

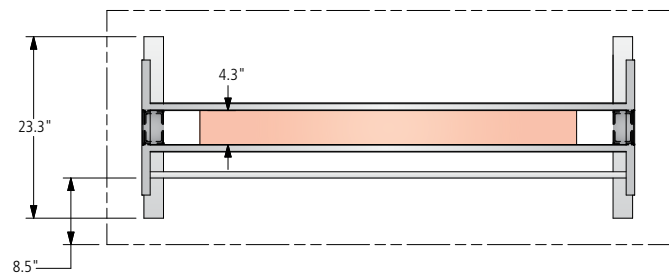
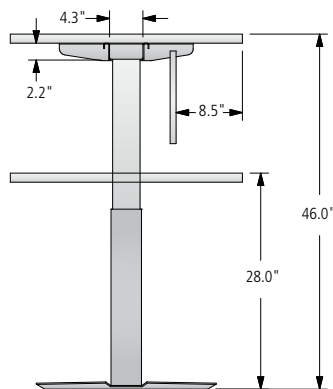

## PROGRAMMABLE CONTROLLER

The programmable controller features up/down buttons, four programmable preset stops, and a digital readout that displays the worksurface height.



## RECOMMENDED ACCESSORIES

- Freestanding Storage Pedestal (page 42)
- Plug Strip (page 43)
- Storage Drawer (page 43)

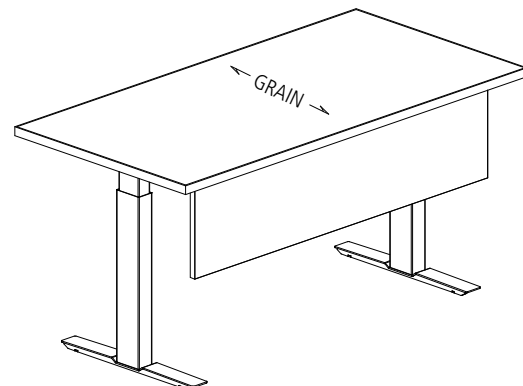

PLEASE NOTE: The grain direction of wood grain laminate runs opposite of image above. Grain direction for laminate always runs the length of the work surface.



# WIRE MANAGEMENT

## BRIDGE, RETURN AND RUN-OFF CREDENZA WITH ADJUSTABLE HEIGHT WALL SUPPORT AND ACCESS PANEL

The Bridge, Return and Run-Off Credenza with Adjustable Height Wall Support and Access Panel includes a metal column base .

- Adjustment range from 28" to 46"
- Controller features digital height readout and four programmable stops
- See page 30 for available sizes and specification requirements

## CONFIGURATIONS

### Bridge

- Model Number CBA-W-2472-V
- Wall support, must specify supports at each end
- Reference Typicals CAM-05-FS, CAM-07-U, CAM-08-U, pages 15-16

### Return or Run-Off Credenza

- Model Number CBA-P-2472-L-V
- End panel included, must specify single support
- Reference Typical CAM-06-L page 15

### Freestanding Credenza

- Model Number CBA-PP-2472
- Includes two end panel supports, freestanding unit

Bridge

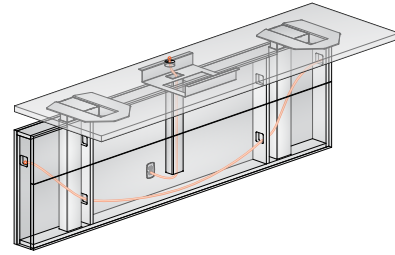

Return or Run-Off Credenza

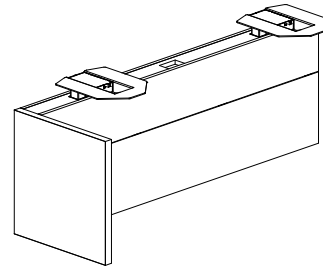

Freestanding Credenza

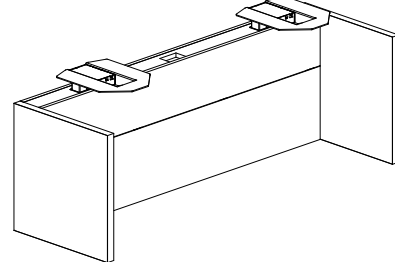

## DIMENSIONS

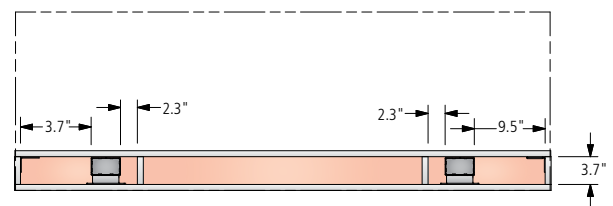
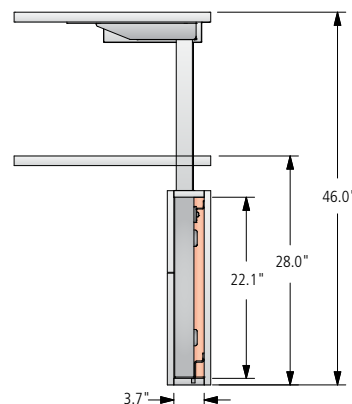

## PROGRAMMABLE CONTROLLER

The programmable controller features up/down buttons, four programmable preset stops, and a digital readout that displays the worksurface height.





# FREESTANDING POWER OPTION: TECH ZONE

## TECH ZONE

Simple, easy to use and portable, this freestanding table top power option allows you to easily charge all of your devices.

Available in two configurations with a variety of power and data connectivity options. Includes a 72"-long plug-in infeed cord.

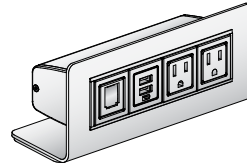

Tech Zone - Side View

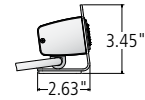

## ZONE-USB-C

Includes two simplex receptacles, one data port and one charging USB-A+C charging port

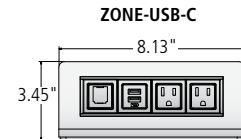

## ZONE-DATA

Includes two simplex receptacles and two open data ports

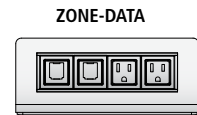





# TABLE TOP POWER OPTIONS

## GROMMET

- Grommet is 2" diameter
- Available in Powder coat, Clear Anodized and Polished
- Height adjustable Bridges, Returns, and Credenzas are available with center grommet location only
- Grommets are included as an option within each work surface
- Grommets may not be placed directly over the end panel of a support pedestal below
- Only one Grommet or Spec may be specified per work surface
- Grommet may not be specified in conjunction with Power Blotter

### Freestanding, Single Pedestal and Run-Off Desk

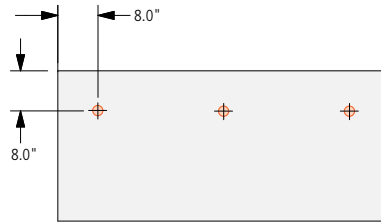

### Height Adjustable Desk

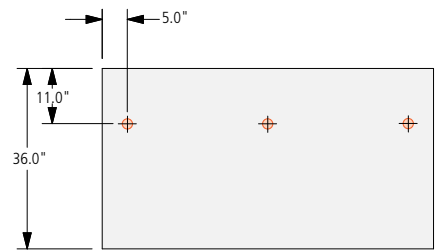
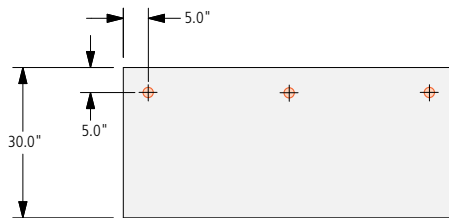

## POWER SPEC AND USB SPEC

This compact unit allows for the addition of power or data to a work surface in a discreet way. Available in round or square shapes, and multiple finish options.

- Power or USB Spec is a work surface accessory, specified in addition to the work surface.
- Only one Grommet or Spec may be specified per work surface
- Power or USB Spec may not be placed directly over the end panel of a support pedestal below
- Power or USB Spec may not be specified in conjunction with Power Blotter

### Run-Off Return / Credenza

(Work surfaces 42"-wide to 54"-wide have only one center grommet)

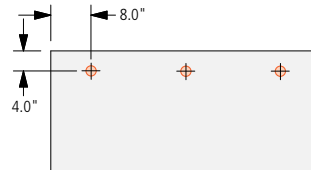

### Bridge



## Power Spec

- Spill-proof power simplex
- Compact design
- 1-3/4" cutout for installation
- UL Listed

### Power Spec

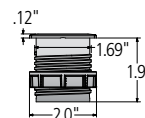

## USB Spec

- Used to charge devices or transfer data
- Compact design
- Offered with USB-A+C
- 1-3/4" cutout
- UL Listed

### USB Spec

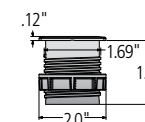

# SHALLOW-DEPTH TOWERS (ALIGNING WITH OVERHEAD)

## Single Door Wardrobe Tower:

- Hatshelf above wardrobe bar is fixed
- Wardrobe bar runs front to back behind valance
- Optional mirror does not ship installed

## Double Door Storage Tower:

- Lock option includes two locks, one per door, 35" High
- 70"h includes one fixed shelf, three adjustable shelves and can accept one additional set of adjustable shelves
- 84"h includes one fixed shelf, four adjustable shelves and can accept one additional set of adjustable shelves
- Side panels of tower are pre bored with 12 locations for optional shelf placement above and below the fixed shelf
- Optional mirror does not ship installed

## 70" and 84" Shallow-Depth Towers

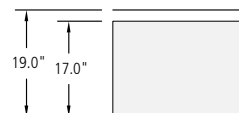

### 70" Single Door Wardrobe Tower

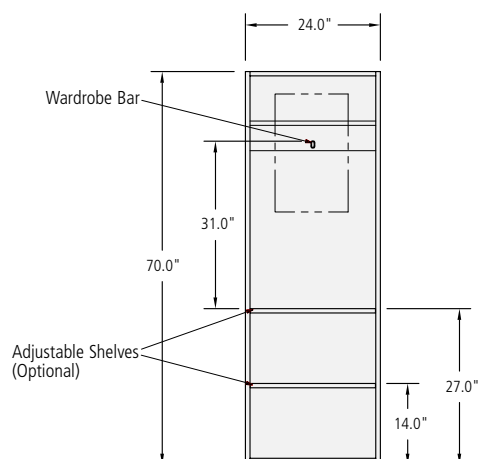

### 70" Double Door Storage Tower

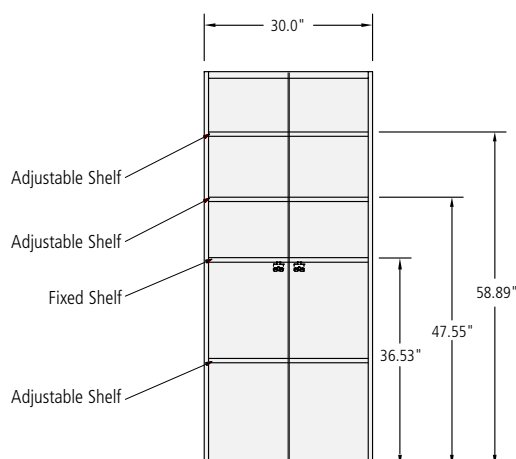

### 84" Single Door Wardrobe Tower

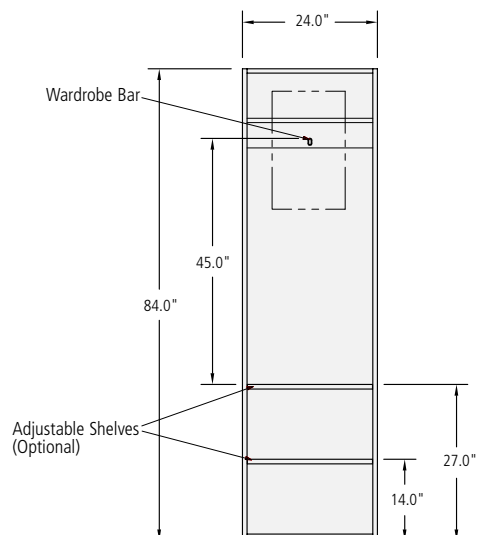

### 84" Double Door Storage Tower

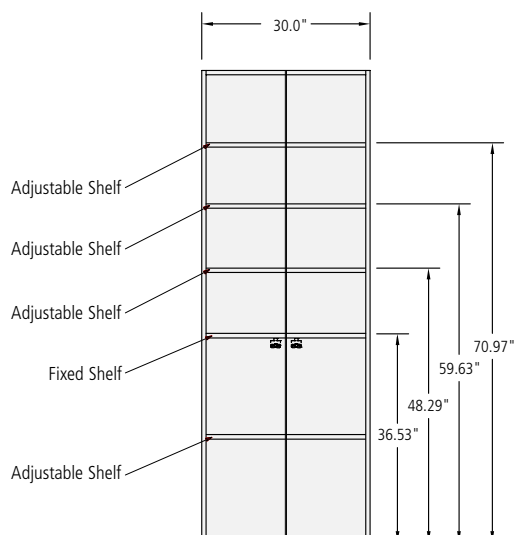

# FULL-DEPTH TOWERS (ALIGNING WITH WORK SURFACE DEPTH)

- Double Door Tower is field reversible
- Double Door Towers include 3 adjustable shelves
- Optional mirror does not ship installed
- Hatshelf above wardrobe bar is fixed
- Double Door Lock option includes two locks, one per door, 35" High

## 70" and 84" Full-Depth Towers

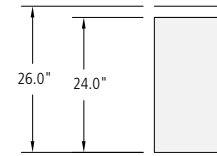

### 70" Single Door Tower

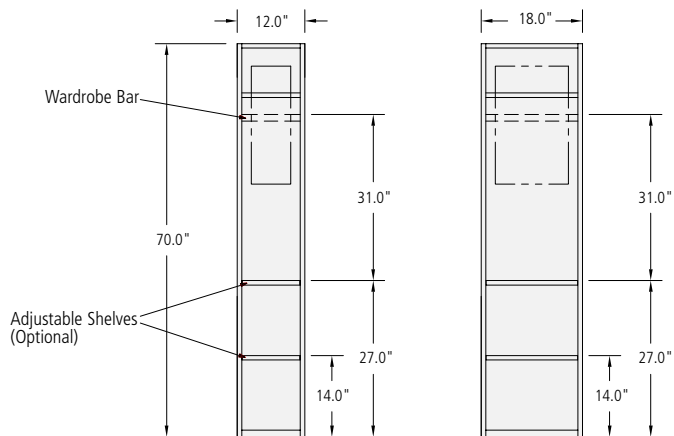

### 70" Double Door Tower

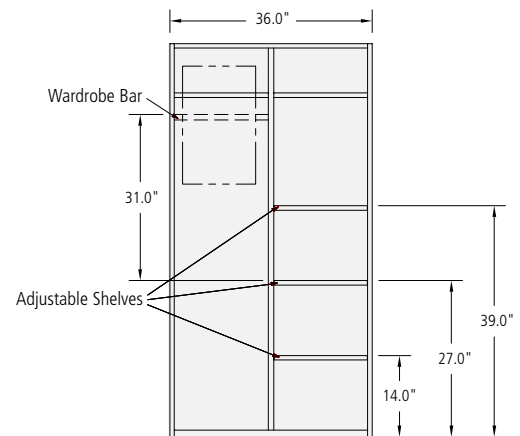

### 84" Single Door Tower

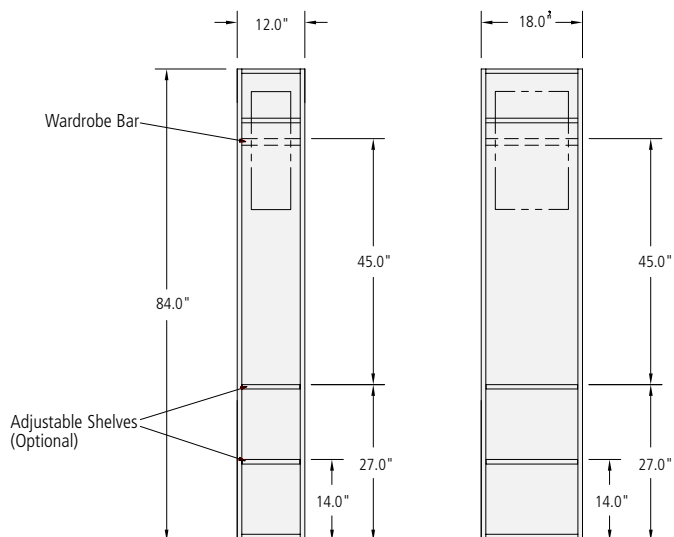

### 84" Double Door Tower

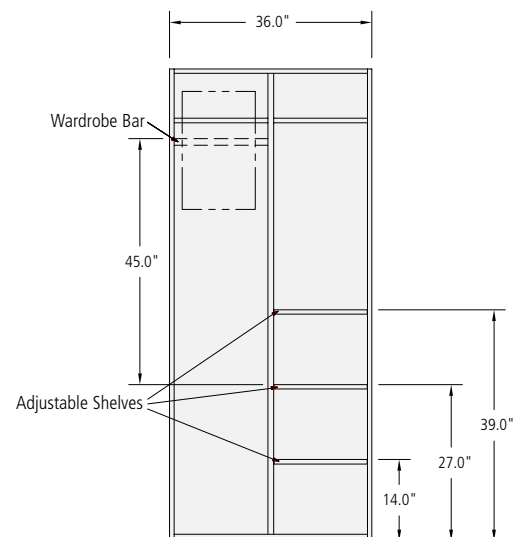



# CAMBIUM™ TYPICALS

---

# ADJUSTABLE HEIGHT PRIMARY WORK SURFACE

Cambium offers the flexibility to specify the primary work surface (desk) as height adjustable in multiple configurations.

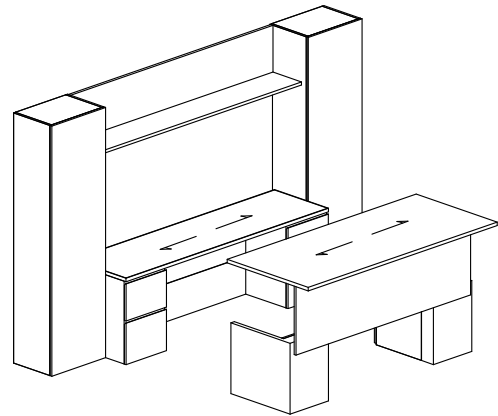
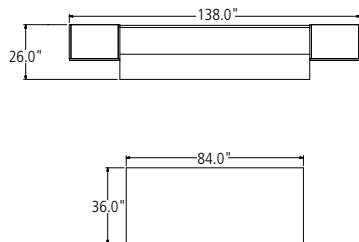

## TYPICAL CAM-01-FS // FREESTANDING STATION

COMPONENT	MODEL #	DIMENSIONS	DESCRIPTION	PRICE
Work surface Height Adj. Panel Leg- Desk	CBAFD-3684-V	36 x 84	Veneer Work surface, Panels w/ Lift Mechanism, and Modesty	10,771
Freestanding Pedestal	CBFP-BF-1521-V	15.5 x 21x 22	Freestanding Box File Pedestal	2,579
Tower	CBTW-24S-1784-L-V	24 x 17.5 x 84.5	Veneer Wardrobe Tower	4,926
Option: Shelves	-SH2		Optional: Additional Storage Shelves (2)	456
Work surface - Credenza	CBC-2490-V	24 x 90	Veneer Work surface	2,755
Work surface Support - Credenza	CBPS-FF-1824-V	18 x 24	Veneer File/ File Storage Pedestal	2,612
Access Panel - Credenza	CBAP-1S-V		Veneer Access Panel to Span Opening 49-66"	1,138
Work surface Support - Credenza	CBPS-BBF-1824-V	18 x 24	Veneer Box/ Box / File Storage Pedestal	2,612
Overhead	CBWW-9070-S	90 x 13	Single Wood Shelf w/ Painted Back Panel	3,307
Back Panel	CBMG-4390	90 x 43	Magnetic Glass Back Panel w/ Magnets	3,947
Tower	CBTW-24S-1784-R-V	24 x 17.5 x 84.5	Veneer Wardrobe Tower	4,926
Option: Tower	-MR		Optional: Mirror	310

Private Office List Price: \$40,339

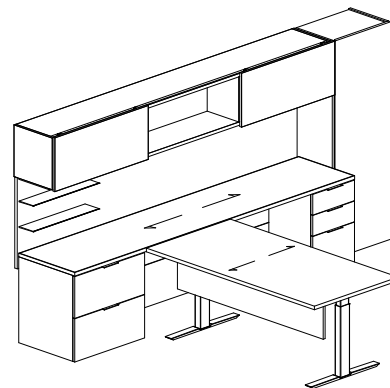
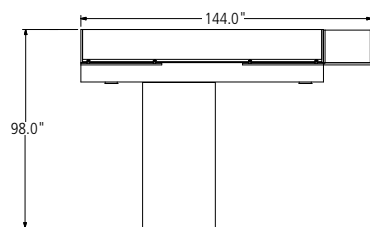

## TYPICAL CAM-02-L // LEFT-HAND STATION

COMPONENT	MODEL #	DIMENSIONS	DESCRIPTION	PRICE
Side Credenza	CBC-24120-V	24 x 120	Veneer Work surface	3,537
Work surface Support - Side Credenza	CBPS-LF-3024-V	30 x 24	Lateral File Storage Pedestal	2,883
Access Panel - Side Credenza	CBAP-2S-V		Veneer Access Panel to Span Opening 67-84"	1,252
Work surface Support - Side Credenza	CBPS-BBF-1824-V	18 x 24	Veneer Box/ Box / File Storage Pedestal	2,612
Work surface Height Adj. T-Leg - Desk	CBAR-3672-V	36 x 72	Veneer Work surface w/ Height Adj. Metal T Leg	5,638
Option: Modesty	-MPWH		Half Height Veneer Modesty Panel	1,095
Overhead	CBOW-2S-120S-VS	120 x 17.25	Single High Overhead w/ 2 Sliding Doors	9,132
Back Panel	CBPD-29120-L-S-30-MDS	120 x 29	Veneer Back Panel w/ Metal Display Shelves	3,105
Tower	CBTW-24S-1770-R-V	24 x 17.5 x 70	Veneer Wardrobe Tower	4,710
Option: Shelves	-SH2		Optional: Additional Storage Shelves (2)	456

Private Office List Price: \$34,420



# ADJUSTABLE HEIGHT PRIMARY WORK SURFACE

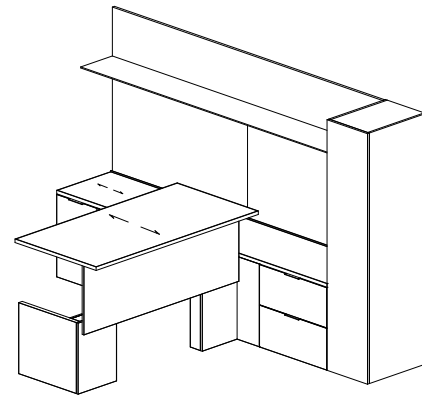
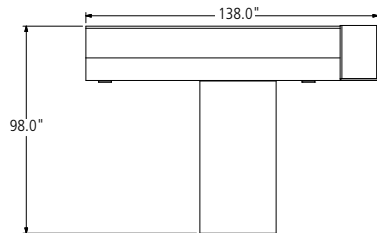

## TYPICAL CAM-04-T // RIGHT-HAND STATION

COMPONENT	MODEL #	DIMENSIONS	DESCRIPTION	PRICE
Side Credenza	CBC-24120-V	24 x 120	Veneer Work surface	3,537
Work surface Support - Side Credenza	CBPS-FF-1824-V	18 x 24	Veneer File / File Storage Pedestal	2,612
Access Panel- Side Credenza	CBAP-2S-V		Veneer Access Panel to Span Opening 67-84"	1,252
Work surface Support - Side Credenza	CBPS-LF-3024-V	30 x 24	Veneer Lateral File Storage Pedestal	2,883
Work surface Height Adj Panel Leg - Desk	CBARO-3672-R-V	36 x 72	Veneer Work surface, Panels w/ Lift Mechanism, and Modesty	10,348
Overhead	CBMM-12070-V	120 x 13	Single Metal Shelf w/ Veneer Back Panel	4,132
Back Panel	CBTF-43120-COM	120 x 43	Fabric Tackboard -COM	1,017
Tower	CBTW-18-2684-R-V	18 x 26 x 84.5	Veneer Wardrobe Tower	4,898

**Private Office List Price: \$30,679**



# ADJUSTABLE HEIGHT SECONDARY WORK SURFACE

Cambium offers the flexibility to specify the secondary work surfaces (bridge, return or credenza) as height adjustable in multiple configurations.

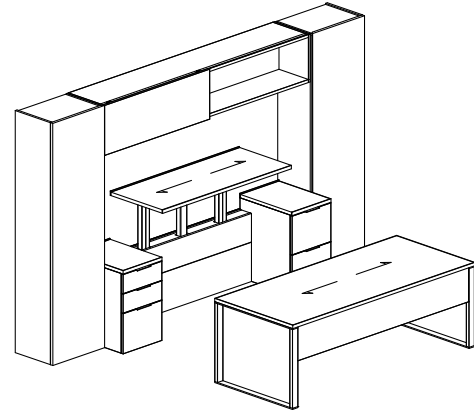
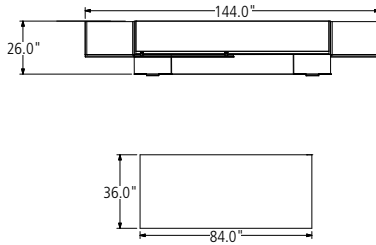

## TYPICAL CAM-05-FS // FREESTANDING STATION

COMPONENT	MODEL #	DIMENSIONS	DESCRIPTION	PRICE
Work surface - Desk	CBSD-3684-V	36 x 84	Veneer Work surface	3,574
Work surface Support - Desk	CBHL-36-R	2.5 x 36	Metal Hoop Leg	1,117
Option: Work surface Support	-PCHL		Polished Chrome	1,135
Work surface Support - Desk	CBHL-36-L	2.5 x 36	Metal Hoop Leg	1,117
Option: Work surface Support	-PCHL		Polished Chrome	1,135
Option: Modesty	-MPWH		Half Height Veneer Modesty Panel	1,095
Tower	CBTW-245-1784-L-V	24 x 17.5 x 84.5	Veneer Wardrobe Tower	4,926
Freestanding Credenza	CBC-2496-V	24 x 96	Veneer Work surface	2,918
Option: Credenza	PSL-PSPC	24 x 96	Optional: Polished Chrome Pencil Stop	238
Work surface Support - Credenza	CBPS-BBF-1824-V	18 x 24	Veneer Box / Box / File Storage Pedestal	2,612
Work surface Support - Credenza	CBA-P-60-L-V	60 x 5	Work surface Support Wall w/ Lift Mechanism	6,350
Work surface Support - Credenza	CBPS-FF-1824-V	18 x 24	Veneer File / File Storage Pedestal	2,612
Overhead	CBOW-15-965-V	96 x 17.25	Single High Overhead w/ 1 Sliding Door	7,917
Back Panel	CBMG-4396	96 x 43	Magnetic Glass Panel	4,112
Tower	CBTW-245-1784-R-V	24 x 17.5 x 84.5	Veneer Wardrobe Tower	4,926

Private Office List Price: \$45,784

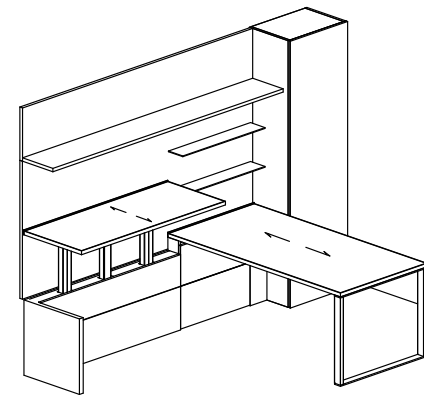
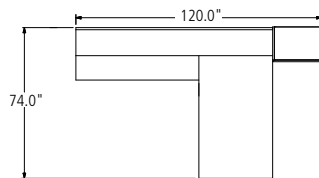

## TYPICAL CAM-06-L // RIGHT-HAND STATION

COMPONENT	MODEL #	DIMENSIONS	DESCRIPTION	PRICE
Work Surface - Run-Off	CBBR-2460-V	60 x 24	Veneer Work surface	1,910
Option: Pencil Stop	-PSL		Optional: Powder Coat Metal Pencil Stop	152
Work Surface Support - Return	CBA-P-60-L	60 x 5	Work surface Support Wall w/ Lift Mechanism	6,350
Desk Work surface	CBSD-3672-V	36 x 72	Veneer Work surface	3,135
Option: Pencil Stop	-PSD	36 x 72	Optional: Powder Coat Metal Pencil Stop	152
Work Surface Support - Desk	CBPLH-36-L-V	1.5 x 36	Veneer Panel Leg Adjacent Adjustable Height	1,921
Work Surface Support - Desk	CBHL-36-V	2.5 x 36	Metal Hoop Leg (Powdercoat)	1,117
Option: Modesty	-MPWH		Half Height Veneer Modesty Panel	1,095
Overhead	CBWW-9670-V	96 x 13	Single Wood Shelf w/ Veneer Back Panel	3,618
Back Panel	CBPD-4396-V-36-GDS	96 x 43	Veneer Back Panel w/ Glass Display Shelves	4,112
Tower	CBTW-245-1784-R-V	24 x 17.5 x 84.5	Veneer Wardrobe Tower	4,926
Option: Shelves	-SH2		Optional: Additional Storage Shelves (2)	456

Private Office List Price: \$28,944



# ADJUSTABLE HEIGHT SECONDARY WORK SURFACE

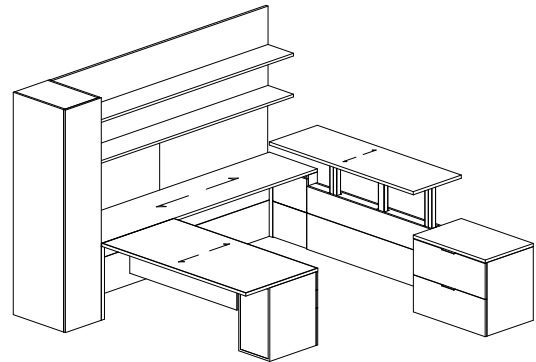
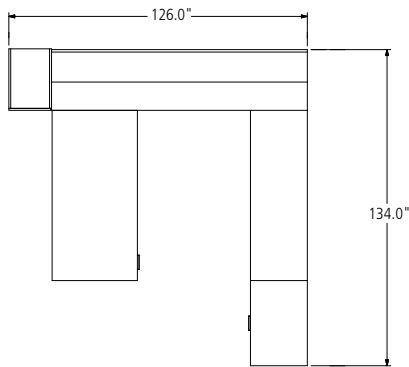

**TYPICAL CAM-07-U // LEFT-HAND STATION**

COMPONENT	MODEL #	DIMENSIONS	DESCRIPTION	PRICE
Tower	CBTW-18-2684-L-V	18 x 26 x 84.5	Veneer Wardrobe Tower	4,898
Desk Work Surface	CBRO-3672-V	36 x 72	Veneer Work surface	3,134
Work Surface Support - Desk	CBPS-BBF-1530-V	15.5 x 30	Veneer Box / Box/ File Storage Pedestal	2,599
Option: Modesty	-MPWH		Half Height Veneer Modesty Panel	1,095
Side Credenza	CBC-24108-V	24 x 108	Veneer Work surface	3,229
Work Surface Support - Side Credenza	CBPLK-24-V	1.5 x 24	Veneer Panel Support	1,026
Access Panel	CBAP-4S-V		Veneer Access Panel to Span Opening 103-120"	1,516
Work Surface Support - Side Credenza	CBPLH-24-V	5 x 24	Veneer Panel Support w/ Hinged Door	1,457
Run-Off Work Surface	CBBR-24108-V	108 x 24	Veneer Work surface	3,229
Work Surface Support - Run-Off	CBA-W-72-R-V	72 x 5	Work surface Support Wall w/ Lift Mechanism	6,473
Work Surface Support - Run-Off	CBPS-LF-3624-V	36 x 24	Veneer Lateral File Storage Pedestal	3,169
Overhead	CBWW-10884-V	108 x 13	Double Wood Shelf w/ Veneer Back Panel	4,921
Back Panel	CBTF-29108-COM	108 x 29	Fabric Tackboard -COM	934

**Private Office List Price: \$37,680**

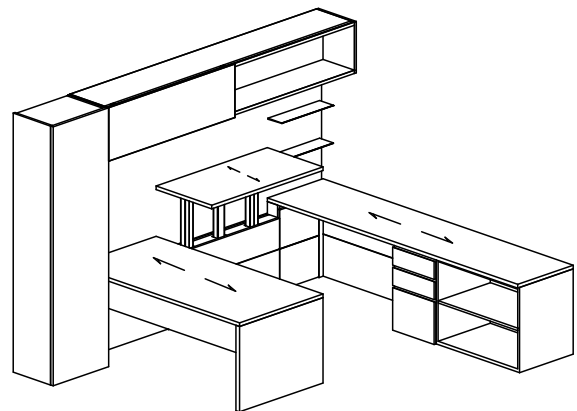
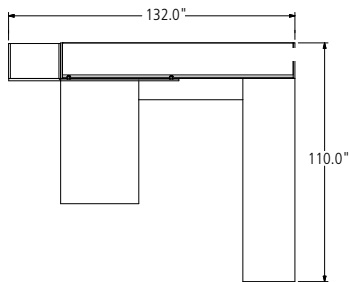

**TYPICAL CAM-08-U // LEFT-HAND STATION**

COMPONENT	MODEL #	DIMENSIONS	DESCRIPTION	PRICE
Tower	CBTW-24S-1784-L-V	24 x 17.5 x 84.5	Veneer Wardrobe Tower	4,926
Desk Work Surface	CBSD-3672-V	36 x 72	Veneer Work surface	3,135
Work Surface Support - Desk	CBPL-36-V	1.5 x 36	Work surface Support - Desk	1,186
Option: Modesty	-MPWH		Half Height Veneer Modesty Panel	1,095
Work Surface Support - Desk	CBPL-36-V	1.5 x 36	Veneer Panel Leg	1,264
Work Surface - Bridge	CBBR-2448-V	48 x 24	Veneer Work surface	1,503
Adj Height Work Surface Support - Bridge	CBA-W-48-V	48 x 5	Work surface Support Wall w/ Lift Mechanism	5,203
Work Surface Support - Side Credenza	CBPLH-24-V	5 x 24	Veneer Panel Support w/ Hinged Door	1,457
Work Surface - Credenza	CBC-24108-V	108 x 24	Veneer Work surface	3,229
Access Panel	CBAP-1S-V		Veneer Access Panel to Span Opening 49-66"	1,138
Work Surface Support - Run-Off Credenza	CBPS-BBF-1824-V	18 x 24	Veneer Box/ Box/ File Storage Pedestal	2,612
Work Surface Support - Run-Off Credenza	CBPS-LF-3624-V	36 x 24	Veneer Lateral File Storage Pedestal	3,169
Overhead	CBOW-1S-108S-V	108 x 17.25	Single High Overhead w/ 1 Sliding Door	8,524
Back Panel	CBPD-43108-V-24-MDS	108 x 43	Veneer Back Panel w/ Metal Display Shelves	4,462

**Private Office List Price: \$42,903**





# STATIONARY WORK SURFACE

Cambium is also available in a more conventional layout with a non-height adjustable work surface in multiple configurations to support all work styles and flow.

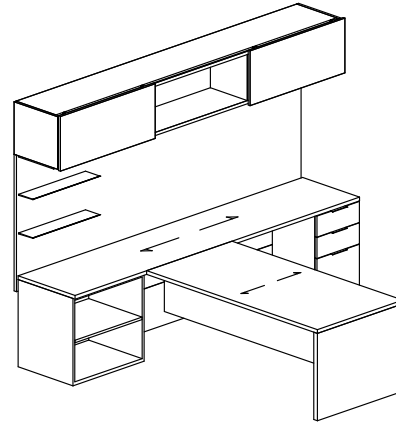
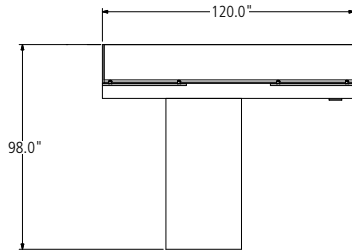

## TYPICAL CAM-09-T // LEFT-HAND STATION

COMPONENT	MODEL #	DIMENSIONS	DESCRIPTION	PRICE
Side Credenza	CBC-24120-V	24 x 120	Veneer Work surface	3,537
Work Surface Support - Side Credenza	CBPS-OS-3024-V	30 x 24	Veneer Open Shelf Storage Pedestal	2,532
Access Panel	CBAP-25-V		Access Panel for openings 67"-84"	1,252
Work Surface Support - Side Credenza	CBPS-BBF-1824-V	18 x 24	Veneer Box/ Box/ File Storage Pedestal	2,612
Desk Work surface	CBRO-3672-V	36 x 72	Veneer Work surface	3,134
Work Surface Support - Desk	CBPL-36-V	1.5 x 36	Veneer Panel Support	1,186
Option: Modesty	-MPWH		Half Height Veneer Modesty Panel	1,095
Overhead	CBOW-25-120S-V	120 x 17.25	Single High Overhead w/ 2 Sliding Doors	9,132
Back Panel	CBPD-43120-V-30-MDS	120 x 43	Veneer Back Panel w/ Metal Display Shelves	4,840

Private Office List Price: \$29,320

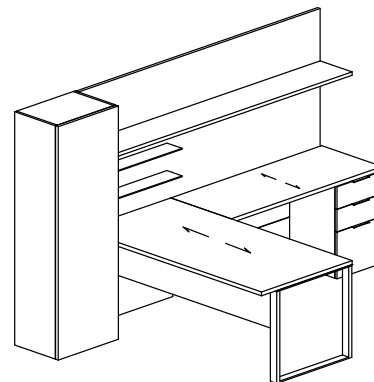
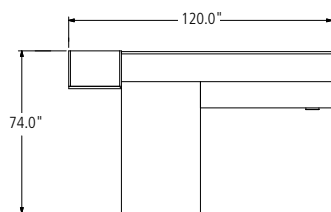

## TYPICAL CAM-10-L // LEFT-HAND STATION

COMPONENT	MODEL #	DIMENSIONS	DESCRIPTION	PRICE
Tower	CBTW-24S-1770-L-V	24 x 17.5 x 70	Veneer Wardrobe Tower	4,710
Desk Work Surface	CBSD-3672-V	36 x 72	Veneer Work surface	3,135
Work Surface Support - Desk	CBHL-30	2.5 x 30	Metal Hoop Leg (Powdercoat)	993
Option: Modesty	-MPWH		Half Height Veneer Modesty Panel	1,095
Work Surface Support - Desk	CBPLK-36-V	1.5 x 36	Veneer Panel Leg	1,263
Work Surface - Run-Off	CBBR-2460-V	60 x 24	Veneer Work surface	1,910
Access Panel	CBAP-OS-V		Veneer Access Panel to Span Opening 12-48"	1,022
Work Surface Support - Side Credenza	CBPS-BBF-1824-V	18 x 24	Veneer Box/ Box/ File Storage Pedestal	2,612
Overhead	CBWW-9670-V	96 x 13	Single Wood Shelf w/ Veneer Back Panel	3,618
Back Panel	CBPD-2996-V-36-GDS	96 x 29	Veneer Back Panel w/ Glass Display Shelves	2,777

Private Office List Price: \$23,135

# STATIONARY WORK SURFACE

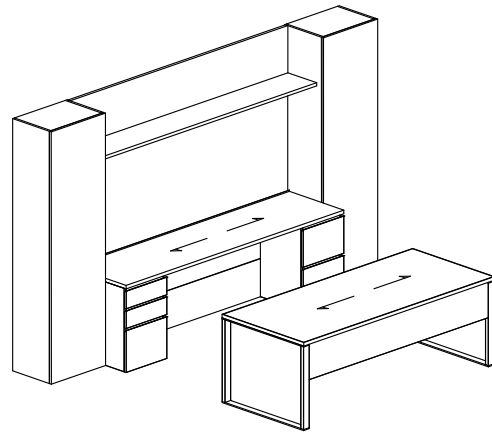
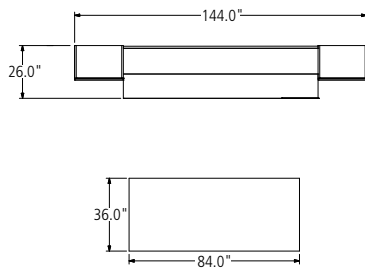

## TYPICAL CAM-11-FS // FREESTANDING STATION

COMPONENT	MODEL #	DIMENSIONS	DESCRIPTION	PRICE
Work Surface- Desk	CBSD-3684-V	36 x 84	Veneer Work surface	3,574
Work Surface Support - Desk	CBHL-36	2.5 x 36	Metal Hoop Leg	1,117
Option: Hoop Leg	-PCHL		Polished Chrome Hoop Leg	1,135
Work Surface Support - Desk	CBHL-36	2.5 x 36	Metal Hoop Leg	1,117
Option: Hoop Leg	-PCHL		Polished Chrome Hoop Leg	1,135
Option: Modesty	-MPWH		Half Height Veneer Modesty Panel	1,095
Tower	CBTW-24S-1784-L-V	24 x 17.5 x 84.5	Veneer Wardrobe Tower	4,926
Freestanding Credenza	CBC-2496-V	24 x 96	Veneer Work surface	2,918
Work Surface Support - Credenza	CBPS-BBF-1824-V	18 x 24	Veneer Box / Box/ File Storage Pedestal	2,612
Access Panel	CBAP-1S-V		Veneer Access Panel to Span Opening 49-66"	1,138
Work Surface Support - Credenza	CBPS-FF-1824-V	18 x 24	Veneer File / File Storage Pedestal	2,612
Overhead	CBWW-9670-V	96 x 13	Single Wood Shelf w/ Veneer Back Panel	3,618
Back Panel	CBTF-4396-COM	96 x 43	Fabric Tack Panel- COM	898
Tower	CBTW-24S-1784-R-V	24 x 17.5 x 84.5	Veneer Wardrobe Tower	4,926
Back Panel	CBTF-29108-COM	108 x 29	Fabric Tackboard -COM	934

Private Office List Price: \$33,755

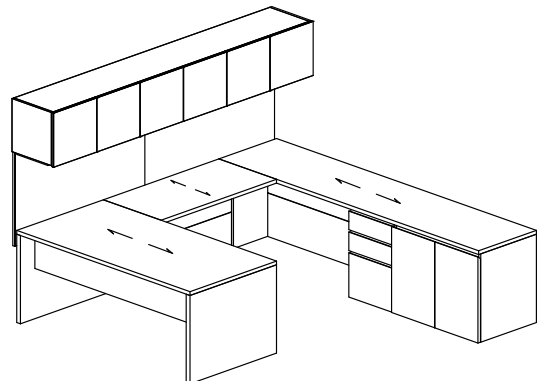
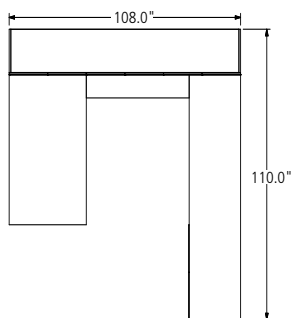

## TYPICAL CAM-12-U // LEFT-HAND STATION

COMPONENT	MODEL #	DIMENSIONS	DESCRIPTION	PRICE
Desk Work Surface	CBSD-3672-V	36 x 72	Veneer Work surface	3,135
Work Surface Support - Desk	CBPL-36-V	1.5 x 36	Veneer Panel Leg	1,186
Option: Modesty	-MPWH		Half Height Veneer Modesty Panel	1,095
Work Surface Support - Desk	CBPLK-36-V	1.5 x 36	Veneer Panel Leg	1,263
Work Surface - Bridge	CBBR-2448-V	48 x 24	Veneer Work surface	1,503
Access Panel	CBAP-0S-V		Veneer Access Panel to Span Opening 12-48"	1,022
Work Surface - Credenza	CBC-24108-V	108 x 24	Veneer Work surface	3,229
Work Surface Support - Side Credenza	CBPLK-24-V	1.5 x 24	Veneer Panel Leg	963
Access Panel	CBAP-1S-V		Veneer Access Panel to Span Opening 49-66"	1,138
Work Surface Support - Run-Off Credenza	CBPS-BBF-1824-V	18 x 24	Veneer Box/ Box/ File Storage Pedestal	2,612
Work Surface Support - Run-Off Credenza	CBPS-DD-3624-V	36 x 24	Double Door Storage Pedestal	3,122
Overhead	CBOW-F-108S-V	96 x 17.25	Single High Overhead w/ Full Door	7,000
Back Panel	CBMG-29108	108 x 29	Magnetic Glass Back Panel w/ Magnets	3,013

Private Office List Price: \$30,281



# CAMBIUM™ PRICE LIST

---



# WORK SURFACES

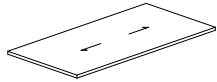

CBSD-3672

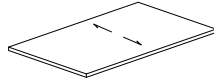

CBRO-3660

## SURFACE MATERIAL KEY

PE Laminate Work surface  
V Veneer Work surface

### DESK // FREESTANDING, SINGLE PEDESTAL DESK (FREESTANDING, L-SHAPE, U-SHAPE)

MODEL #	DEPTH	WIDTH	-PE	-V
CBSD-3060	30	60	2,044	2,273
CBSD-3066	30	66	2,225	2,473
CBSD-3072	30	72	2,406	2,675
CBSD-3078	30	78	2,565	2,850
CBSD-3084	30	84	2,749	3,053
CBSD-3660	36	60	2,406	2,675
CBSD-3666	36	66	2,616	2,907
CBSD-3672	36	72	2,822	3,135
CBSD-3678	36	78	3,025	3,360
CBSD-3684	36	84	3,218	3,574

### DESK // RUN-OFF DESK (T-SHAPE AND U-SHAPE)

MODEL #	DEPTH	WIDTH	-PE	-V
CBRO-3042	30	42	1,478	1,641
CBRO-3048	30	48	1,669	1,852
CBRO-3054	30	54	1,858	2,063
CBRO-3060	30	60	2,044	2,273
CBRO-3066	30	66	2,224	2,470
CBRO-3072	30	72	2,406	2,675
CBRO-3078	30	78	2,565	2,850
CBRO-3084	30	84	2,749	3,053
CBRO-3642	36	42	1,744	1,936
CBRO-3648	36	48	1,967	2,186
CBRO-3654	36	54	2,190	2,432
CBRO-3660	36	60	2,404	2,673
CBRO-3666	36	66	2,616	2,907
CBRO-3672	36	72	2,820	3,134
CBRO-3678	36	78	3,025	3,360
CBRO-3684	36	84	3,218	3,574



# WORK SURFACES

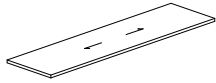

CBC-2490

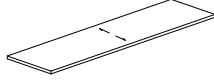

CBBR-2490

## SURFACE MATERIAL KEY

PE Laminate Work surface  
V Veneer Work surface

### CREDENZA/LATERAL FILE TOPS // FREESTANDING, SIDE, BACK CREDENZA

MODEL #	DEPTH	WIDTH	-PE	-V
CBC-2430	24	30	1,070	1,189
CBC-2436	24	36	1,171	1,301
CBC-2442	24	42	1,269	1,409
CBC-2448	24	48	1,354	1,503
CBC-2454	24	54	1,456	1,615
CBC-2460	24	60	1,717	1,910
CBC-2466	24	66	1,876	2,081
CBC-2472	24	72	2,030	2,255
CBC-2478	24	78	2,183	2,426
CBC-2484	24	84	2,334	2,592
CBC-2490	24	90	2,481	2,755
CBC-2496	24	96	2,625	2,918
CBC-24102	24	102	2,768	3,074
CBC-24108	24	108	2,910	3,229
CBC-24114	24	114	3,042	3,380
CBC-24120	24	120	3,184	3,537

### DESK // FREESTANDING, SINGLE PEDESTAL DESK (FREESTANDING, L-SHAPE, U-SHAPE)

MODEL #	DEPTH	WIDTH	-PE	-V
CBBR-2430	24	30	1,070	1,189
CBBR-2436	24	36	1,171	1,301
CBBR-2442	24	42	1,269	1,409
CBBR-2448	24	48	1,354	1,503
CBBR-2454	24	54	1,456	1,615
CBBR-2460	24	60	1,717	1,910
CBBR-2466	24	66	1,876	2,081
CBBR-2472	24	72	2,030	2,255
CBBR-2478	24	78	2,183	2,426
CBBR-2484	24	84	2,334	2,592
CBBR-2490	24	90	2,481	2,755
CBBR-2496	24	96	2,625	2,918
CBBR-24102	24	102	2,768	3,074
CBBR-24108	24	108	2,910	3,229
CBBR-24114	24	114	3,042	3,380
CBBR-24120	24	120	3,184	3,537



# WORK SURFACES

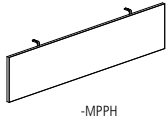

OPTIONS	CODE	PRICE	NOTES
<b>Modesty Panel Options (Required with Hoop or Panel Base):</b>			
Painted Modesty Panel Half Height	-MPPH	\$1,095	
Wood Modesty Panel Half Height	-MPWH	\$1,095	
Painted Modesty Panel Full Height	-MPPF	\$1,205	
Wood Modesty Panel Full Height	-MPWF	\$1,205	
<b>2"-Diameter Grommet Options:</b>			
Center Grommet	-WPRC	\$207	
Left Grommet	-WPRL	\$207	
Right Grommet	-WPRR	\$207	
Left and Right Grommet	-WPR2	\$413	
Polished Chrome Grommet	-PCG	\$86	Upcharge per Grommet
<b>Power Spec / USB Spec Options:</b>			
Center Power Spec or USB Spec	-SP-C		Power Spec / USB Spec specified separately. See page 44.
Left Power Spec or USB Spec	-SP-L		
Right Power Spec or USB Spec	-SP-R		
Left & Right Power Spec or USB Spec	-SP-LR		
<b>Pencil Stop Options (Specify per work surface):</b>			
Pencil Stop (along depth of work surface)	-PSD	\$152	
Pencil Stop (along length of work surface)	-PSL	\$152	
Polished Chrome Pencil Stop	-PSPC	\$86	Upcharger per Pencil Stop

## GENERAL INFORMATION

- Work surface height 29-1/2"
- Edge profile is square
- Half height modesty panels are 12"-high
- Grommet is 2" Diameter. Available in Powder Coat, Clear Anodized or Polished Chrome (upcharge applies).
- Work surface tops and storage fronts will be grain-matched sets based on configuration
- When specifying left and right, handedness is oriented to the user
- There will be 1/4" gap between height adjustable and static work surfaces, the lift controller is a dual switch system
- Desk modesty panel required on desks with 2 panel bases, 2 hoop bases, or a combination of hoop and panel bases
- Desk modesty panel with two hoop legs may be flush with the edge of the work surface or inset 6"
- Desk modesty panel will be inset from the edge of the work surface for both panel legs and pedestals
- Panel supports run full depth of the work surface
- Grain direction should always run parallel to a seam
- Pencil stop available in Powder coat, Clear Anodized, and Polished finishes
- Polished chrome pencil stop maximum length is 114"; 120" polished chrome pencil stop will have a seam at center
- Pencil stop not available on Run-Off Desks
- Grommets in height adjustable Bridges, Returns, and Credenzas available at center location only
- Grain direction on wood grain laminates will always run the length of the work surface
- Only one pencil stop may be specified per work surface
- Optional half height modesty panel available on run-off desk; full height modesty is not an option for run-off desks
- Work surface power available on page 44

### REQUIRED INFORMATION (ORDER CANNOT BE ENTERED WITHOUT THIS INFORMATION)

See appendix pages vi-vii for surface material options.

- Choose Veneer Finish, if applicable
- Choose Metal Finish, if applicable
- Choose Laminate, if applicable
- Choose ABS Edge Color



# STATIONARY WORK SURFACE SUPPORTS AND STORAGE

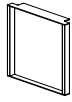

HOOP LEG

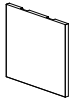

PANEL LEG

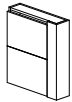
PANEL LEG  
ADJACENT  
ADJ HEIGHTBOX BOX FILE  
PEDESTALFILE FILE  
PEDESTALLATERAL FILE  
PEDESTAL

## SURFACE MATERIAL KEY

S	All Paint
VS	Veneer Case with Paint Front
V	All Veneer

### HOOP LEG

MODEL #	DEPTH	WIDTH	DESCRIPTION	PRICE	-S	-VS	-V
CBHL-24-[ ]	24	2.5	Metal Hoop Leg 24"D Work Surface	795	-	-	-
CBHL-30-[ ]	30	2.5	Metal Hoop Leg 30"D Work Surface	993	-	-	-
CBHL-36-[ ]	36	2.5	Metal Hoop Leg 36"D Work Surface	1,117	-	-	-

### PANEL LEG

MODEL #	DEPTH	WIDTH	DESCRIPTION	-S	-VS	-V
CBPL-24-[ ]	24	1.5	Panel Leg 24"D Work Surface	917	-	963
CBPL-30-[ ]	30	1.5	Panel Leg 30"D Work Surface	1,018	-	1,070
CBPL-36-[ ]	36	1.5	Panel Leg 36"D Work Surface	1,127	-	1,186

### PANEL LEG WITH KEEL // KEEL REQUIRED WITH PANEL LEG WHEN THE ADJACENT BRIDGE/RETURN HAS AN ACCESS PANEL

MODEL #	DEPTH	WIDTH	DESCRIPTION	-S	-VS	-V
CBPLK-24-[ ]	24	1.5	Panel Leg 24"D Work Surface with Keel	976	-	1,026
CBPLK-30-[ ]	30	1.5	Panel Leg 30"D Work Surface with Keel	1,083	-	1,140
CBPLK-36-[ ]	36	1.5	Panel Leg 36"D Work Surface with Keel	1,200	-	1,263

### PANEL LEG ADJACENT ADJUSTABLE HEIGHT

MODEL #	DEPTH	WIDTH	DESCRIPTION	-S	-VS	-V
CBPLH-24-[ ]	24	5	Panel Leg 24"D WS, Matches Adj Ht Wall Depth	1,382	1,457	1,457
CBPLH-30-[ ]	30	5	Panel Leg 30"D WS, Matches Adj Ht Wall Depth	1,589	1,672	1,672
CBPLH-36-[ ]	36	5	Panel Leg 36"D WS, Matches Adj Ht Wall Depth	1,826	1,921	1,921

### BOX/BOX/FILE PEDESTAL

MODEL #	DEPTH	WIDTH	DESCRIPTION	-S	-VS	-V
CBPS-BBF-1524	24	15.5	Box Box File Pedestal (Desk Support Only)	2,288	2,408	2,408
CBPS-BBF-1530	30	15.5	Box Box File Pedestal (Desk Support Only)	2,467	2,599	2,599
CBPS-BBF-1824	24	18	Box Box File Pedestal	2,483	2,612	2,612
CBPS-BBF-1830	30	18	Box Box File Pedestal	2,825	2,976	2,976

### FILE/FILE PEDESTAL

MODEL #	DEPTH	WIDTH	DESCRIPTION	-S	-VS	-V
CBPS-FF-1524	24	15.5	File File Pedestal (Desk Support Only)	2,288	2,408	2,408
CBPS-FF-1530	30	15.5	File File Pedestal (Desk Support Only)	2,467	2,599	2,599
CBPS-FF-1824	24	18	File File Pedestal	2,483	2,612	2,612
CBPS-FF-1830	30	18	File File Pedestal	2,825	2,976	2,976

### LATERAL FILE PEDESTAL

MODEL #	DEPTH	WIDTH	DESCRIPTION	-S	-VS	-V
CBPS-LF-3024	24	30	Lateral File Pedestal	2,740	2,883	2,883
CBPS-LF-3624	24	36	Lateral File Pedestal	3,012	3,169	3,169

[ ] Specify Left (-L) or Right (-R)



# STATIONARY WORK SURFACE SUPPORTS AND STORAGE



OPEN SHELF  
PEDESTAL



DOOR PEDESTAL

## SURFACE MATERIAL KEY

S	All Paint
VS	Veneer Case with Paint Front
V	All Veneer

### OPEN SHELF PEDESTAL

MODEL #	DEPTH	WIDTH	DESCRIPTION	-S	-VS	-V
CBPS-OS-1824	24	18	Open Shelf Pedestal	2,289	-	2,408
CBPS-OS-3024	24	30	Open Shelf Pedestal	2,405	-	2,532
CBPS-OS-3624	24	36	Open Shelf Pedestal	2,466	-	2,595

### DOOR PEDESTAL

MODEL #	DEPTH	WIDTH	DESCRIPTION	-S	-VS	-V
CBPS-D-1824-[ ]	24	18	Single Door Storage Pedestal	2,576	2,712	2,712
CBPS-DD-3024	24	30	Double Door Storage Pedestal	2,693	2,835	2,835
CBPS-DD-3624	24	36	Double Door Storage Pedestal	2,966	3,122	3,122

[ ] Specify Left (-L) or Right (-R)





# STATIONARY WORK SURFACE SUPPORTS AND STORAGE

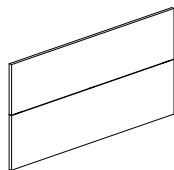

CBAP-1S

## SURFACE MATERIAL KEY

S	Painted
V	Veneer

## ACCESS PANEL

MODEL #	HEIGHT	DESCRIPTION	-S	-V
CBAP-0S	26	Access Panel for openings 12"-48"	973	1,022
CBAP-1S	26	Access Panel for openings 49"-66"	1,081	1,138
CBAP-2S	26	Access Panel for openings 67"-84"	1,192	1,252
CBAP-3S	26	Access Panel for openings 85"-102"	1,307	1,376
CBAP-4S	26	Access Panel for openings 103"-120"	1,439	1,516

## OPTIONS

### CODE

### PRICE

### NOTES

#### Polished Chrome Options:

Polished Chrome Hoop Leg

-PCHL

\$1,135

#### Pedestal Options:

No Locks

-NL

No Charge

Undermount Soft Close Drawer Slide

-US

\$152

#### Pull Options:

Integrated Pull

-IP

No Charge

Metal Tabl Pull

-MT

No Charge

Polished Chrome Pull

-PCP

\$194



-IP



-MT

## GENERAL INFORMATION

- Specify supports left to right
- Access modesty panels are not available in widths less than 10"; for an opening less than 10", it will be left open
- Grain direction is vertical
- Pencil trays standard within Box Drawers
- Work surface tops and storage fronts will be grain-matched sets based on configuration
- Face locking standard on all desk pedestals, locks are always located on the right
- When specifying left and right, handedness is oriented to the user
- Hoop and Panel legs require a modesty
- Pedestal is standard with white drawer boxes and sidemount self closing drawer slides; undermount soft close slides are optional
- Lateral file drawers are not available with undermount slides
- Lateral file drawers are not self closing
- Work surface height adjustable range of travel 28"-45"
- Access Panel required for openings greater than 60"
- 15"-wide Pedestals are for use as desk supports only
- Panel leg supports must run the full depth of the work surface
- Desk pedestals, when combined with a Panel leg, must run the full depth of the work surface
- 15.5"-wide pedestals accommodate side-to-side legal filing
- 18"-wide pedestals accommodate side-to-side and front-to-back letter filing and side-to-side legal filing
- 30"-wide and 36"-wide pedestals accommodate side-to-side and front-to-back letter and legal filing
- Wire Manager not included as standard on Hoop Leg

### REQUIRED INFORMATION (ORDER CANNOT BE ENTERED WITHOUT THIS INFORMATION)

See appendix pages vi-vii for surface material options.

- Choose Veneer Finish, if applicable
- Choose Metal Finish, if applicable
- Choose Paint Finish, if applicable



# ADJUSTABLE HEIGHT WORK SURFACE SUPPORTS

PRIMARY DESK AS ADJUSTABLE HEIGHT (WORK SURFACE AND BASE INCLUDED)

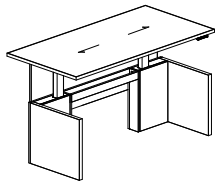

FREESTANDING DESK

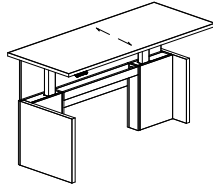

RUN-OFF DESK

## SURFACE MATERIAL KEY

PE Laminate Top with ABS Edge  
V All Veneer

### ADJUSTABLE HEIGHT FREESTANDING DESK

MODEL #	DEPTH	WIDTH	DESCRIPTION	-PE	-V
CBAFD-3060	30	60	Freestanding Adj. Ht Panel Bases w/ Full Height Modesty 30" x 60" Desk	8,945	9,415
CBAFD-3066	30	66	Freestanding Adj. Ht Panel Bases w/ Full Height Modesty 30" x 66" Desk	9,132	9,613
CBAFD-3072	30	72	Freestanding Adj. Ht Panel Bases w/ Full Height Modesty 30" x 72" Desk	9,316	9,804
CBAFD-3078	30	78	Freestanding Adj. Ht Panel Bases w/ Full Height Modesty 30" x 78" Desk	9,501	10,003
CBAFD-3084	30	84	Freestanding Adj. Ht Panel Bases w/ Full Height Modesty 30" x 84" Desk	9,693	10,203
CBAFD-3660	36	60	Freestanding Adj. Ht Panel Bases w/ Full Height Modesty 36" x 60" Desk	9,408	9,902
CBAFD-3666	36	66	Freestanding Adj. Ht Panel Bases w/ Full Height Modesty 36" x 66" Desk	9,622	10,128
CBAFD-3672	36	72	Freestanding Adj. Ht Panel Bases w/ Full Height Modesty 36" x 72" Desk	9,830	10,348
CBAFD-3678	36	78	Freestanding Adj. Ht Panel Bases w/ Full Height Modesty 36" x 78" Desk	10,027	10,554
CBAFD-3684	36	84	Freestanding Adj. Ht Panel Bases w/ Full Height Modesty 36" x 84" Desk	10,234	10,771

### ADJUSTABLE HEIGHT RUN-OFF DESK

MODEL #	DEPTH	WIDTH	DESCRIPTION	-PE	-V
CBARO-3060-[ ]	30	60	Run-Off Desk Adj. Ht Panel Bases w/ Full Height Modesty 30" x 60" Desk	8,945	9,415
CBARO-3066-[ ]	30	66	Run-Off Desk Adj. Ht Panel Bases w/ Full Height Modesty 30" x 66" Desk	9,132	9,613
CBARO-3072-[ ]	30	72	Run-Off Desk Adj. Ht Panel Bases w/ Full Height Modesty 30" x 72" Desk	9,316	9,804
CBARO-3078-[ ]	30	78	Run-Off Desk Adj. Ht Panel Bases w/ Full Height Modesty 30" x 78" Desk	9,501	10,003
CBARO-3084-[ ]	30	84	Run-Off Desk Adj. Ht Panel Bases w/ Full Height Modesty 30" x 84" Desk	9,693	10,203
CBARO-3660-[ ]	36	60	Run-Off Desk Adj. Ht Panel Bases w/ Full Height Modesty 36" x 60" Desk	9,408	9,902
CBARO-3666-[ ]	36	66	Run-Off Desk Adj. Ht Panel Bases w/ Full Height Modesty 36" x 66" Desk	9,622	10,128
CBARO-3672-[ ]	36	72	Run-Off Desk Adj. Ht Panel Bases w/ Full Height Modesty 36" x 72" Desk	9,830	10,348
CBARO-3678-[ ]	36	78	Run-Off Desk Adj. Ht Panel Bases w/ Full Height Modesty 36" x 78" Desk	10,027	10,554
CBARO-3684-[ ]	36	84	Run-Off Desk Adj. Ht Panel Bases w/ Full Height Modesty 36" x 84" Desk	10,234	10,771

[ ] Specify Left (-L) or Right (-R)

#### OPTIONS

##### Panel Base Finish Options:

Veneer	-VB	No Charge
Paint	-PB	No Charge

##### Modesty Panel Options:

Painted Modesty Panel Full Height	-MPPF	No Charge
Wood Modesty Panel Full Height	-MPWF	No Charge

##### 2"-Diameter Grommet Options:

Center Grommet	-WPRC	\$207	
Left Grommet	-WPRL	\$207	
Right Grommet	-WPRR	\$207	
Left and Right Grommet	-WPR2	\$413	
Polished Chrome Grommet	-PCG	\$86	Upcharge per Grommet

##### Power Spec / USB Spec Options:

Center Power Spec or USB Spec	-SP-C		
Left Power Spec or USB Spec	-SP-L		
Right Power Spec or USB Spec	-SP-R		
Left & Right Power Spec or USB Spec	-SP-LR		
			Power Spec / USB Spec specified separately. See page 44.



# ADJUSTABLE HEIGHT WORK SURFACE SUPPORTS

PRIMARY DESK AS ADJUSTABLE HEIGHT (WORK SURFACE AND BASE INCLUDED)

## GENERAL INFORMATION

- Grain direction is vertical
- Grommet is 2" Diameter. Available in Powder Coat, Clear Anodized or Polished Chrome (upcharge applies).
- Pencil trays standard within Box Drawer, runs depth of the drawer box
- Work surface tops and storage fronts will be grain-matched sets based on configuration
- Face locking standard on all desk pedestals, locks are always located on the right
- When specifying left and right, handedness is oriented to the user
- Adjustable height panel base requires a full height modesty, modesty included in model number above
- Pedestal is standard with white drawer boxes and sidemount self closing drawer slides
- Work surface height adjustable range of travel 28" -46"
- Lift mechanisms are designed to support all desk components, plus a maximum of 100lbs additional weight
- Height adjustable lift mechanism is warranted for 2 years
- Lift mechanisms for both wall and T leg applications are only available in powder coat finishes
- There will be 1/4" gap between height adjustable and static worksurfaces, the lift controller is a dual switch system
- Work surface power available on page 44
- Power Spec or USB Spec not available in individual work surfaces if Grommet option is selected

### REQUIRED INFORMATION (ORDER CANNOT BE ENTERED WITHOUT THIS INFORMATION)

See appendix pages vi-vii for surface material options.

- Choose Veneer Finish, if applicable
- Choose Metal Finish, if applicable
- Choose Paint Finish, if applicable

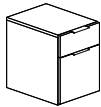

CBFP-BF-1521

### SURFACE MATERIAL KEY

S	All Paint
VS	Veneer Case with Paint Front
V	All Veneer

## FREESTANDING STORAGE PEDESTAL

MODEL #	DEPTH	WIDTH	DESCRIPTION	-S	-VS	-V
CBFP-BF-1521	21	15	Freestanding Box/File	2,451	2,579	2,579

### OPTIONS

#### Pedestal Options:

No Locks (Pedestals)	-NL	No Charge
Undermount Soft Close Drawer Slide	-US	\$152

#### Pull Options:

Integrated Pull	-IP	No Charge
Metal Tabl Pull	-MT	No Charge
Polished Chrome Pull	-PCP	\$194

#### Seat Cushion (1-1/2 yds)

COM Fabric	-SC-COM	\$404
Grade A	-SC-A	\$552
Grade B	-SC-B	\$599
Grade C	-SC-C	\$684
Grade D	-SC-D	\$766
Grade E	-SC-E	\$848
Grade F	-SC-F	\$903
Grade G	-SC-G	\$987
Grade H	-SC-H	\$1,029

## GENERAL INFORMATION

- Grain direction is vertical
- Pencil trays standard within Box Drawer, runs depth of the drawer box
- Face locking standard on all desk pedestals, locks are always located on the right
- Pedestal is standard with white drawer boxes and sidemount self closing drawer slides
- 15"-wide pedestals accommodate side-to-side legal filing

### REQUIRED INFORMATION (ORDER CANNOT BE ENTERED WITHOUT THIS INFORMATION)

See appendix pages vi-vii for surface material options.

- Choose Veneer Finish, if applicable
- Choose Metal Finish, if applicable (Options include Chrome, Clear Anodized, and Powder Coat finishes)
- Choose Paint Finish, if applicable



# ADJUSTABLE HEIGHT WORK SURFACE SUPPORTS

PRIMARY DESK AS ADJUSTABLE HEIGHT (WORK SURFACE AND BASE INCLUDED)

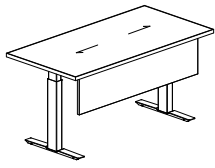

T-LEG FREESTANDING DESK

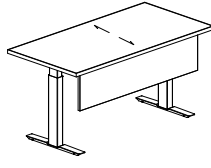

T-LEG RUN-OFF DESK

## SURFACE MATERIAL KEY

PE Laminate Top with ABS Edge Top  
V Veneer Top

### T-LEG ADJUSTABLE HEIGHT FREESTANDING DESK

MODEL #	DEPTH	WIDTH	-PE	-V
CBAD-2442	24	42	3,717	3,914
CBAD-2448	24	48	3,802	4,002
CBAD-2454	24	54	3,876	4,080
CBAD-3048	30	48	4,125	4,341
CBAD-3054	30	54	4,330	4,556
CBAD-3060	30	60	4,542	4,779
CBAD-3066	30	66	4,721	4,971
CBAD-3072	30	72	4,893	5,151
CBAD-3648	36	48	4,454	4,689
CBAD-3654	36	54	4,695	4,941
CBAD-3660	36	60	4,935	5,192
CBAD-3666	36	66	5,147	5,415
CBAD-3672	36	72	5,355	5,638

### T-LEG ADJUSTABLE HEIGHT RUN-OFF DESK

MODEL #	DEPTH	WIDTH	-PE	-V
CBAR-2442	24	42	3,717	3,914
CBAR-2448	24	48	3,802	4,002
CBAR-2454	24	54	3,876	4,080
CBAR-3048	30	48	4,125	4,341
CBAR-3054	30	54	4,330	4,556
CBAR-3060	30	60	4,542	4,779
CBAR-3066	30	66	4,721	4,971
CBAR-3072	30	72	4,893	5,151
CBAR-3648	36	48	4,454	4,689
CBAR-3654	36	54	4,695	4,941
CBAR-3660	36	60	4,935	5,192
CBAR-3666	36	66	5,147	5,415
CBAR-3672	36	72	5,355	5,638

## OPTIONS

### Modesty Panel Options:

Painted Modesty Panel Half Height  
Wood Modesty Panel Half Height

## CODE

-MPPH  
-MPWH

## PRICE

\$1,095  
\$1,095

## NOTES

### 2"-Diameter Grommet Options:

Center Grommet

-WPRC

\$207

Polished Chrome Grommet

-PCG

\$86

Upcharge per Grommet

### Power Spec / USB Spec Options:

Center Power Spec or USB Spec

-SP-C

Power Spec / USB Spec specified separately.  
See page 44.



# ADJUSTABLE HEIGHT WORK SURFACE SUPPORTS

PRIMARY DESK AS ADJUSTABLE HEIGHT (WORK SURFACE AND BASE INCLUDED)

## GENERAL INFORMATION

- Grain direction is vertical
- Grommet is 2" Diameter. Available in Powder Coat, Clear Anodized or Polished Chrome (upcharge applies).
- Pencil trays standard within Box Drawer, runs depth of the drawer box
- Work surface tops and storage fronts will be grain-matched sets based on configuration
- Face locking standard on all desk pedestals, locks are always located on the right
- When specifying left and right, handedness is oriented to the user
- Adjustable height panel base requires a full height modesty, modesty included in model number above
- Pedestal is standard with white drawer boxes and sidemount self closing drawer slides
- Work surface height adjustable range of travel 28" -46"
- Lift mechanisms are designed to support all desk components, plus a maximum of 100lbs additional weight
- Height adjustable lift mechanism is warranted for 2 years
- Lift mechanisms for both wall and T leg applications are only available in powder coat finishes
- There will be 1/4" gap between height adjustable and static worksurfaces, the lift controller is a dual switch system
- Work surface power available on page 44
- Power Spec or USB Spec not available in individual work surfaces if Grommet option is selected

### REQUIRED INFORMATION (ORDER CANNOT BE ENTERED WITHOUT THIS INFORMATION)

See appendix pages vi-vii for surface material options.

- Choose Veneer Finish, if applicable
- Choose Metal Finish, if applicable
- Choose Paint Finish, if applicable

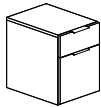

CBFP-BF-1521

### SURFACE MATERIAL KEY

S	All Paint
VS	Veneer Case with Paint Front
V	All Veneer

## FREESTANDING STORAGE PEDESTAL

MODEL #	DEPTH	WIDTH	DESCRIPTION	-S	-VS	-V
CBFP-BF-1521	21	15	Freestanding Box/File	2,451	2,579	2,579

### OPTIONS

#### Pedestal Options:

No Locks (Pedestals)	-NL	No Charge
Undermount Soft Close Drawer Slide	-US	\$152

#### Pull Options:

Integrated Pull	-IP	No Charge
Metal Tabl Pull	-MT	No Charge
Polished Chrome Pull	-PCP	\$194

#### Seat Cushion (1-1/2 yds)

COM Fabric	-SC-COM	\$404
Grade A	-SC-A	\$552
Grade B	-SC-B	\$599
Grade C	-SC-C	\$684
Grade D	-SC-D	\$766
Grade E	-SC-E	\$848
Grade F	-SC-F	\$903
Grade G	-SC-G	\$987
Grade H	-SC-H	\$1,029

## GENERAL INFORMATION

- Grain direction is vertical
- Pencil trays standard within Box Drawer, runs depth of the drawer box
- Face locking standard on all desk pedestals, locks are always located on the right
- Pedestal is standard with white drawer boxes and sidemount self closing drawer slides
- 15"-wide pedestals accommodate side-to-side legal filing

### REQUIRED INFORMATION (ORDER CANNOT BE ENTERED WITHOUT THIS INFORMATION)

See appendix pages vi-vii for surface material options.

- Choose Veneer Finish, if applicable
- Choose Metal Finish, if applicable (Options include Chrome, Clear Anodized, and Powder Coat finishes)
- Choose Paint Finish, if applicable



# ADJUSTABLE HEIGHT WORK SURFACE SUPPORTS

FOR SECONDARY WORK SURFACES (BRIDGES, RETURNS AND CREDENZAS)

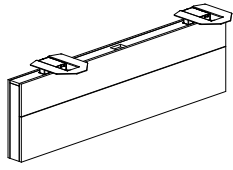

CBA-W-84

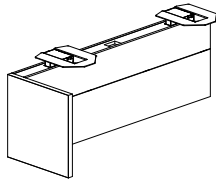

CBA-P-72

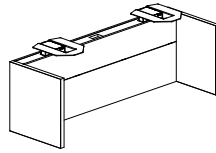

CBA-PP-72

## SURFACE MATERIAL KEY

S	All Paint
VS	Veneer Case with Paint Front
V	All Veneer

## ADJUSTABLE HEIGHT

MODEL #	DEPTH	WIDTH	DESCRIPTION	-S	-VS	-V
CBA-W-42	5	42	Wall Support w/ Lifts, Access Panel	4,671	4,916	4,916
CBA-W-48	5	48	Wall Support w/ Lifts, Access Panel	4,944	5,203	5,203
CBA-W-54	5	54	Wall Support w/ Lifts, Access Panel	5,231	5,507	5,507
CBA-W-60	5	60	Wall Support w/ Lifts, Access Panel	5,532	5,821	5,821
CBA-W-66	5	66	Wall Support w/ Lifts, Access Panel	5,834	6,139	6,139
CBA-W-72	5	72	Wall Support w/ Lifts, Access Panel	6,148	6,473	6,473
CBA-W-78	5	78	Wall Support w/ Lifts, Access Panel	6,482	6,822	6,822
CBA-W-84	5	84	Wall Support w/ Lifts, Access Panel	6,832	7,192	7,192
CBA-P-42-[ ]	5	42	Wall Support w/ Lifts, Access Panel, and One End Panel	5,172	5,446	5,446
CBA-P-48-[ ]	5	48	Wall Support w/ Lifts, Access Panel, and One End Panel	5,446	5,732	5,732
CBA-P-54-[ ]	5	54	Wall Support w/ Lifts, Access Panel, and One End Panel	5,732	6,033	6,033
CBA-P-60-[ ]	5	60	Wall Support w/ Lifts, Access Panel, and One End Panel	6,033	6,350	6,350
CBA-P-66-[ ]	5	66	Wall Support w/ Lifts, Access Panel, and One End Panel	6,334	6,667	6,667
CBA-P-72-[ ]	5	72	Wall Support w/ Lifts, Access Panel, and One End Panel	6,653	7,000	7,000
CBA-P-78-[ ]	5	78	Wall Support w/ Lifts, Access Panel, and One End Panel	6,985	7,352	7,352
CBA-P-84-[ ]	5	84	Wall Support w/ Lifts, Access Panel, and One End Panel	7,331	7,717	7,717
CBA-PP-60	5	60	Wall Support w/ Lifts, Access Panel, and Two End Panels	6,534	6,880	6,880
CBA-PP-66	5	66	Wall Support w/ Lifts, Access Panel, and Two End Panels	6,836	7,196	7,196
CBA-PP-72	5	72	Wall Support w/ Lifts, Access Panel, and Two End Panels	7,151	7,530	7,530
CBA-PP-78	5	78	Wall Support w/ Lifts, Access Panel, and Two End Panels	7,485	7,878	7,878
CBA-PP-84	5	84	Wall Support w/ Lifts, Access Panel, and Two End Panels	7,833	8,246	8,246

[ ] Specify Left (-L) or Right (-R) End Panel

## GENERAL INFORMATION

- Grain direction is vertical
- Work surface is specified separately
- Work surface tops and storage fronts will be grain-matched sets based on configuration
- When specifying left and right, handedness is oriented to the user
- Height adjustable lift mechanism is warranted for 2 years
- Lift mechanisms for both wall and T leg applications are only available in powdercoat finishes
- There will be 1/4" gap between height adjustable and static worksurfaces, the lift controller is a dual switch system
- Work surface travel range 28"-46"
- Adjustable height wall enclosures include a cutout in the back panel to access electrical or data ports

### REQUIRED INFORMATION (ORDER CANNOT BE ENTERED WITHOUT THIS INFORMATION)

See appendix pages vi-vii for surface material options.

- Choose Veneer Finish, if applicable
- Choose Metal Finish, if applicable
- Choose Paint Finish, if applicable

# WALL-MOUNT OPEN SHELF OVERHEADS

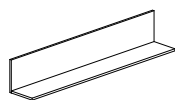

SINGLE WOOD SHELF  
WITH BACK PANEL

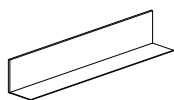

SINGLE METAL SHELF  
WITH BACK PANEL

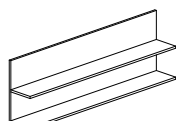

DOUBLE WOOD SHELF  
WITH BACK PANEL

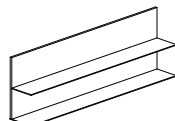

DOUBLE METAL SHELF  
WITH BACK PANEL

## SURFACE MATERIAL KEY

S	Painted Back Panel and Shelf
VS	Veneer Back Panel and Painted Shelf
V	Veneer Back Panel and Shelf

### SINGLE WOOD SHELF WITH BACK PANEL

MODEL #	HEIGHT	WIDTH	DEPTH	DESCRIPTION	-S	-VS	-V
CBWW-6070	16.75	60	13.7	Single Wood Shelf w/ Back Panel	2,647	2,788	2,788
CBWW-6670	16.75	66	13.7	Single Wood Shelf w/ Back Panel	2,780	2,927	2,927
CBWW-7270	16.75	72	13.7	Single Wood Shelf w/ Back Panel	2,913	3,065	3,065
CBWW-7870	16.75	78	13.7	Single Wood Shelf w/ Back Panel	3,044	3,205	3,205
CBWW-8470	16.75	84	13.7	Single Wood Shelf w/ Back Panel	3,177	3,343	3,343
CBWW-9070	16.75	90	13.7	Single Wood Shelf w/ Back Panel	3,307	3,484	3,484
CBWW-9670	16.75	96	13.7	Single Wood Shelf w/ Back Panel	3,440	3,618	3,618
CBWW-10270	16.75	102	13.7	Single Wood Shelf w/ Back Panel	3,575	3,760	3,760
CBWW-10870	16.75	108	13.7	Single Wood Shelf w/ Back Panel	3,706	3,900	3,900
CBWW-11470	16.75	114	13.7	Single Wood Shelf w/ Back Panel	3,836	4,038	4,038
CBWW-12070	16.75	120	13.7	Single Wood Shelf w/ Back Panel	3,925	4,132	4,132

### SINGLE METAL SHELF WITH BACK PANEL

MODEL #	HEIGHT	WIDTH	DEPTH	DESCRIPTION	-S	-VS	-V
CBMM-6070	16.75	60	13.7	Single Metal Shelf w/ Back Panel	2,647	-	2,788
CBMM-6670	16.75	66	13.7	Single Metal Shelf w/ Back Panel	2,780	-	2,927
CBMM-7270	16.75	72	13.7	Single Metal Shelf w/ Back Panel	2,913	-	3,065
CBMM-7870	16.75	78	13.7	Single Metal Shelf w/ Back Panel	3,044	-	3,205
CBMM-8470	16.75	84	13.7	Single Metal Shelf w/ Back Panel	3,177	-	3,343
CBMM-9070	16.75	90	13.7	Single Metal Shelf w/ Back Panel	3,307	-	3,484
CBMM-9670	16.75	96	13.7	Single Metal Shelf w/ Back Panel	3,440	-	3,618
CBMM-10270	16.75	102	13.7	Single Metal Shelf w/ Back Panel	3,575	-	3,760
CBMM-10870	16.75	108	13.7	Single Metal Shelf w/ Back Panel	3,706	-	3,900
CBMM-11470	16.75	114	13.7	Single Metal Shelf w/ Back Panel	3,836	-	4,038
CBMM-12070	16.75	120	13.7	Single Metal Shelf w/ Back Panel	3,925	-	4,132

### DOUBLE WOOD SHELF WITH BACK PANEL

MODEL #	HEIGHT	WIDTH	DEPTH	DESCRIPTION	-S	-VS	-V
CBWW-6084	31	60	13.7	Double Wood Shelf w/ Back Panel	3,341	3,515	3,515
CBWW-6684	31	66	13.7	Double Wood Shelf w/ Back Panel	3,509	3,691	3,691
CBWW-7284	31	72	13.7	Double Wood Shelf w/ Back Panel	3,676	3,868	3,868
CBWW-7884	31	78	13.7	Double Wood Shelf w/ Back Panel	3,841	4,041	4,041
CBWW-8484	31	84	13.7	Double Wood Shelf w/ Back Panel	4,007	4,220	4,220
CBWW-9084	31	90	13.7	Double Wood Shelf w/ Back Panel	4,176	4,395	4,395
CBWW-9684	31	96	13.7	Double Wood Shelf w/ Back Panel	4,341	4,571	4,571
CBWW-10284	31	102	13.7	Double Wood Shelf w/ Back Panel	4,509	4,746	4,746
CBWW-10884	31	108	13.7	Double Wood Shelf w/ Back Panel	4,676	4,921	4,921
CBWW-11484	31	114	13.7	Double Wood Shelf w/ Back Panel	4,842	5,097	5,097
CBWW-12084	31	120	13.7	Double Wood Shelf w/ Back Panel	5,008	5,272	5,272

### DOUBLE METAL SHELF WITH BACK PANEL

MODEL #	HEIGHT	WIDTH	DEPTH	DESCRIPTION	-S	-VS	-V
CBMM-6084	31	60	13.7	Double Metal Shelf w/ Back Panel	3,341	-	3,515
CBMM-6684	31	66	13.7	Double Metal Shelf w/ Back Panel	3,509	-	3,691
CBMM-7284	31	72	13.7	Double Metal Shelf w/ Back Panel	3,676	-	3,868
CBMM-7884	31	78	13.7	Double Metal Shelf w/ Back Panel	3,841	-	4,041
CBMM-8484	31	84	13.7	Double Metal Shelf w/ Back Panel	4,007	-	4,220
CBMM-9084	31	90	13.7	Double Metal Shelf w/ Back Panel	4,176	-	4,395
CBMM-9684	31	96	13.7	Double Metal Shelf w/ Back Panel	4,341	-	4,571
CBMM-10284	31	102	13.7	Double Metal Shelf w/ Back Panel	4,509	-	4,746
CBMM-10884	31	108	13.7	Double Metal Shelf w/ Back Panel	4,676	-	4,921
CBMM-11484	31	114	13.7	Double Metal Shelf w/ Back Panel	4,842	-	5,097
CBMM-12084	31	120	13.7	Double Metal Shelf w/ Back Panel	5,008	-	5,272



# WALL-MOUNT OPEN SHELF OVERHEADS

OPTIONS	CODE	PRICE	NOTES
ADD Tasklight (Wood Shelf Only)	-TL	\$802	

## GENERAL INFORMATION

- All overhead storage is wall-mounted
- Grain direction is vertical
- Shelf depth is 12.7"
- Wood shelves are 1"-thick with a square edge profile
- Metal shelves are 5/16"-thick with a square edge profile
- Single height overheads can be mounted at the 84" height, there is 21" clearance from the bottom of the overhead to the top of the work surface when work surface is raised to its highest position
- Double shelves cannot be above a height adjustable work surface
- Wood shelves available with an optional integrated LED tasklight
- Metal shelves do not have the option for a tasklight
- Metal storage shelves are available in Clear Anodized only
- Tackboard and glass magnetic board option available. See pages 35-38.
- Wall-Mount Overhead shelves require a back panel below to conceal mounting hardware

### REQUIRED INFORMATION (ORDER CANNOT BE ENTERED WITHOUT THIS INFORMATION)

See appendix pages vi-vii for surface material options.

- Choose Veneer Finish, if applicable
- Choose Paint Finish for wood shelf, if applicable





# WALL-MOUNT SLIDING DOOR OVERHEADS

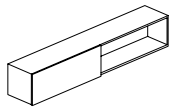

CBOW-1S-96S

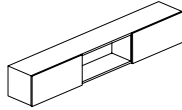

CBOW-2S-120S

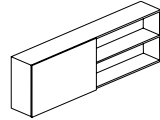

CBOW-1S-84D

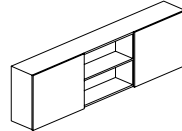

CBOW-2S-120D

## SURFACE MATERIAL KEY

S	All Paint
VS	Veneer Case with Paint Door
V	All Veneer
SG	Painted Case with Glass Door
VG	Veneer Case with Glass Door

## SLIDING DOOR // SINGLE HEIGHT

MODEL #	HEIGHT	WIDTH	DEPTH	DESCRIPTION	-S	-VS	-V	-SG	-VG
CBOW-1S-60S	17	60	17.3	30" Sliding Door	5,784	6,089	6,089	6,478	6,818
CBOW-1S-66S	17	66	17.3	33" Sliding Door	6,074	6,393	6,393	6,804	7,162
CBOW-1S-72S	17	72	17.3	36" Sliding Door	6,363	6,697	6,697	7,127	7,501
CBOW-1S-78S	17	78	17.3	39" Sliding Door	6,655	7,003	7,003	7,448	7,840
CBOW-1S-84S	17	84	17.3	42" Sliding Door	6,940	7,306	7,306	7,772	8,181
CBOW-1S-90S	17	90	17.3	45" Sliding Door	7,231	7,611	7,611	8,098	8,522
CBOW-1S-96S	17	96	17.3	48" Sliding Door	7,518	7,917	7,917	8,419	8,863
CBOW-1S-102S	17	102	17.3	51" Sliding Door	7,807	8,218	8,218	8,741	9,203
CBOW-1S-108S	17	108	17.3	54" Sliding Door	8,100	8,524	8,524	9,069	9,545
CBOW-2S-114S	17	114	17	38" Sliding Door Left/ Open Center/ 38" Sliding Door Right	8,388	8,828	8,828	9,392	9,886
CBOW-2S-120S	17	120	17	40" Sliding Door Left/ Open Center/ 40" Sliding Door Right	8,678	9,132	9,132	9,069	9,545
CBOW-1SD-60S	17	60	19.25	30" Sliding Door	5,784	6,089	6,089	6,478	6,818
CBOW-1SD-66S	17	66	19.25	33" Sliding Door	6,074	6,393	6,393	6,804	7,131
CBOW-1SD-72S	17	72	19.25	36" Sliding Door	6,363	6,697	6,697	7,127	7,501
CBOW-1SD-78S	17	78	19.25	39" Sliding Door	6,655	7,003	7,003	7,448	7,840
CBOW-1SD-84S	17	84	19.25	42" Sliding Door	6,940	7,306	7,306	7,772	8,181
CBOW-1SD-90S	17	90	19.25	45" Sliding Door	7,231	7,611	7,611	8,098	8,522
CBOW-1SD-96S	17	96	19.25	48" Sliding Door	7,518	7,917	7,917	8,419	8,863
CBOW-1SD-102S	17	102	19.25	51" Sliding Door	7,807	8,218	8,218	8,741	9,203
CBOW-1SD-108S	17	108	19.25	54" Sliding Door	8,100	8,524	8,524	9,069	9,545
CBOW-2SD-114S	17	114	19.25	38" Sliding Door Left/ Open Center/ 38" Sliding Door Right	8,388	8,828	8,828	9,392	9,886
CBOW-2SD-120S	17	120	19.25	40" Sliding Door Left/ Open Center/ 40" Sliding Door Right	8,678	9,132	9,132	9,069	9,545

## SLIDING DOOR // DOUBLE HEIGHT

MODEL #	HEIGHT	WIDTH	DEPTH	DESCRIPTION	-S	-VS	-V	-SG	-VG
CBOW-1S-60D	31.25	60	17.25	30" Sliding Door	7,231	7,611	7,611	8,530	8,979
CBOW-1S-66D	31.25	66	17.25	33" Sliding Door	7,592	7,991	7,991	8,957	9,428
CBOW-1S-72D	31.25	72	17.25	36" Sliding Door	7,956	8,372	8,372	9,381	9,875
CBOW-1S-78D	31.25	78	17.25	39" Sliding Door	8,314	8,752	8,752	9,807	10,324
CBOW-1S-84D	31.25	84	17.25	42" Sliding Door	8,678	9,132	9,132	10,234	10,771
CBOW-2S-90D	31.25	90	17.25	30" Sliding Door Left/30" Center Open/30" Sliding Door Right	9,037	9,513	9,513	10,661	11,222
CBOW-2S-96D	31.25	96	17.25	32" Sliding Door Left/32" Center Open/32" Sliding Door Right	9,397	9,891	9,891	11,086	11,669
CBOW-2S-102D	31.25	102	17.25	34" Sliding Door Left/34" Center Open/34" Sliding Door Right	9,761	10,274	10,274	11,514	12,118
CBOW-2S-108D	31.25	108	17.25	36" Sliding Door Left/36" Center Open/36" Sliding Door Right	10,118	10,652	10,652	11,938	12,567
CBOW-2S-114D	31.25	114	17.25	38" Sliding Door Left/38" Center Open/38" Sliding Door Right	10,481	11,032	11,032	12,364	13,016
CBOW-2S-120D	31.25	120	17.25	40" Sliding Door Left/40" Center Open/40" Sliding Door Right	10,844	11,415	11,415	12,792	13,466
CBOW-1SD-60D	31.25	60	19.25	30" Sliding Door	7,231	7,611	7,611	8,530	8,979
CBOW-1SD-66D	31.25	66	19.25	33" Sliding Door	7,592	7,991	7,991	8,957	9,428
CBOW-1SD-72D	31.25	72	19.25	36" Sliding Door	7,956	8,372	8,372	9,381	9,875
CBOW-1SD-78D	31.25	78	19.25	39" Sliding Door	8,314	8,752	8,752	9,807	10,324
CBOW-1SD-84D	31.25	84	19.25	42" Sliding Door	8,678	9,132	9,132	10,234	10,771
CBOW-2SD-90D	31.25	90	19.25	30" Sliding Door Left/30" Center Open/30" Sliding Door Right	9,037	9,513	9,513	10,661	11,222
CBOW-2SD-96D	31.25	96	19.25	32" Sliding Door Left/32" Center Open/32" Sliding Door Right	9,397	9,891	9,891	11,086	11,669
CBOW-2SD-102D	31.25	102	19.25	34" Sliding Door Left/34" Center Open/34" Sliding Door Right	9,761	10,274	10,274	11,514	12,118
CBOW-2SD-108D	31.25	108	19.25	36" Sliding Door Left/36" Center Open/36" Sliding Door Right	10,118	10,652	10,652	11,938	12,567
CBOW-2SD-114D	31.25	114	19.25	38" Sliding Door Left/38" Center Open/38" Sliding Door Right	10,481	11,032	11,032	12,364	13,016
CBOW-2SD-120D	31.25	120	19.25	40" Sliding Door Left/40" Center Open/40" Sliding Door Right	10,844	11,415	11,415	12,792	13,466



# WALL-MOUNT FULL DOOR OVERHEADS

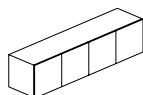

CBOW-F-72S

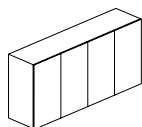

CBOW-F-72D

## SURFACE MATERIAL KEY

S	All Paint
VS	Veneer Case with Paint Door
V	All Veneer
SG	Painted Case with Glass Door
VG	Veneer Case with Glass Door

## FULL DOOR

MODEL #	HEIGHT	WIDTH	DEPTH	DESCRIPTION	-S	-VS	-V	-SG	-VG
CBOW-F-72S	17	72	17.25	4 Doors	5,237	5,512	5,512	6,440	6,778
CBOW-F-90S	17	90	17.25	5 Doors	6,022	6,337	6,337	7,407	7,795
CBOW-F-108S	17	108	17.25	6 Doors	6,653	7,000	7,000	8,176	8,608
CBOW-FD-72S	17	72	19.25	4 Doors	5,237	5,512	5,512	6,440	6,778
CBOW-FD-90S	17	90	19.25	5 Doors	6,022	6,337	6,337	7,407	7,795
CBOW-FD-108S	17	108	19.25	6 Doors	6,653	7,000	7,000	8,176	8,608
CBOW-F-72D	31.25	72	17.25	4 Doors	8,098	8,522	8,522	9,960	10,483
CBOW-F-90D	31.25	90	17.25	5 Doors	9,312	9,800	9,800	11,452	12,053
CBOW-F-108D	31.25	108	17.25	6 Doors	10,280	10,823	10,823	12,643	13,310
CBOW-FD-72D	31.25	72	19.25	4 Doors	8,098	8,522	8,522	9,960	10,483
CBOW-FD-90D	31.25	90	19.25	5 Doors	9,312	9,800	9,800	11,452	12,053
CBOW-FD-108D	31.25	108	19.25	6 Doors	10,280	10,823	10,823	12,643	13,310

## OPTIONS

OPTIONS	CODE	PRICE	NOTES
Remove Task Light	-NTL	Deduct \$802	
<b>Satin Glass Options:</b>			
Satin glass for Single Height Overheads	-SGS	\$464	
Satin glass for Double Height Overheads	-SGD	\$618	

## GENERAL INFORMATION

- All overhead storage is wall-mounted
- Grain direction is vertical
- Overhead depth is 17.25" or 19.25", interior depth is 13-1/2" or 15-1/2"
- Overheads are shipped with mounting hardware for attachment to structural wall
- Single Height Overheads can be mounted at the 84" height, there is 21" clearance from the bottom of the overhead to the top of the work surface when work surface is raised to its highest position
- Double Height Overheads cannot be mounted above a height adjustable work surface
- Task lights included but may be removed as an option
- Task lights can dim
- Customers are responsible for ensuring that the structural wall has adequate strength to support the overhead and its contents
- Glass overhead doors are tempered, interior frame on all glass doors is anodized
- Back panel options consist of tackable fabric, magnetic glass, and veneer/paint panel with display shelves. See pages 35-38.
- Wall-Mount Overhead is recommended to be paired with a back panel to conceal gap between overhead and architectural wall
- Shelves within double high overheads are adjustable.

### REQUIRED INFORMATION (ORDER CANNOT BE ENTERED WITHOUT THIS INFORMATION)

See appendix pages vi-vii for surface material options.

- Choose Veneer Finish
- Choose Paint Finish, if applicable
- Choose Glass Finish, if applicable



# 29"-HIGH WALL PANELS

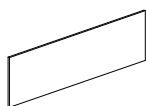

CBTF-2996

## FABRIC TACK PANEL

MODEL #	W X H	PANEL SECTIONS	YARDAGE	COM	A	B	C	D	E	F	G	H
CBTF-2960	60 x 29	1	2	659	836	918	1,016	1,103	1,195	1,282	1,372	1,415
CBTF-2966	66 x 29	1	2.25	702	898	1,002	1,103	1,203	1,306	1,407	1,507	1,550
CBTF-2972	72 x 29	1	2.5	740	958	1,076	1,186	1,300	1,409	1,525	1,633	1,675
CBTF-2978	78 x 29	1	2.75	777	1,026	1,147	1,269	1,395	1,521	1,643	1,763	1,808
CBTF-2984	84 x 29	1	3	815	1,081	1,217	1,355	1,481	1,618	1,752	1,889	1,930
CBTF-2990	90 x 29	1	3.25	846	1,136	1,283	1,429	1,570	1,720	1,866	2,013	2,058
CBTF-2996	96 x 29	1	3.5	876	1,194	1,348	1,506	1,659	1,816	1,974	2,133	2,140
CBTF-29102	102 x 29	2	3.75	908	1,247	1,415	1,579	1,749	1,916	2,081	2,255	2,296
CBTF-29108	108 x 29	2	4	934	1,295	1,472	1,652	1,830	2,012	2,188	2,367	2,409
CBTF-29114	114 x 29	2	4.25	957	1,344	1,529	1,721	1,912	2,104	2,289	2,486	2,529
CBTF-29120	120 x 29	2	4.5	988	1,389	1,594	1,793	1,992	2,194	2,398	2,599	2,642



CBMG-2996

## MAGNETIC GLASS PANEL

MODEL #	W X H	PANEL SECTIONS	GLASS PANEL
CBMG-2960	60 x 29	1	2,175
CBMG-2966	66 x 29	1	2,265
CBMG-2972	72 x 29	1	2,361
CBMG-2978	78 x 29	1	2,459
CBMG-2984	84 x 29	1	2,561
CBMG-2990	90 x 29	1	2,667
CBMG-2996	96 x 29	1	2,777
CBMG-29102	102 x 29	2	2,893
CBMG-29108	108 x 29	2	3,013
CBMG-29114	114 x 29	2	3,138
CBMG-29120	120 x 29	2	3,268

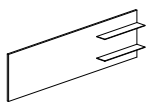

CBPD-2996

### SURFACE MATERIAL KEY

S Painted Panel  
V Veneer Panel

## PANEL WITH DISPLAY SHELVES

MODEL #	W X H	PANEL SECTIONS	-S	-V
CBPD-2960-[ ]	60 x 29	1	2,067	2,175
CBPD-2966-[ ]	66 x 29	1	2,153	2,265
CBPD-2972-[ ]	72 x 29	1	2,241	2,361
CBPD-2978-[ ]	78 x 29	1	2,336	2,459
CBPD-2984-[ ]	84 x 29	1	2,431	2,561
CBPD-2990-[ ]	90 x 29	1	2,532	2,667
CBPD-2996-[ ]	96 x 29	1	2,640	2,777
CBPD-29102-[ ]	102 x 29	1	2,749	2,893
CBPD-29108-[ ]	108 x 29	1	2,862	3,013
CBPD-29114-[ ]	114 x 29	1	2,981	3,138
CBPD-29120-[ ]	120 x 29	1	3,105	3,268

[ ] Specify Display Shelves Left (-L) or Right (-R)



## 29"-HIGH WALL PANELS

OPTIONS	CODE	NOTES
<b>Display Shelf Width Options:</b>		
24"	-24	Includes two Display Shelves
30"	-30	Includes two Display Shelves
36"	-36	Includes two Display Shelves
<b>Display Shelf Material Options:</b>		
Metal	-MDS	
Glass	-GDS	

### GENERAL INFORMATION

- Fabric tackboards 102" and greater will have an even split two-piece construction
- Glass magnetic boards 102" and greater will have an even split two-piece construction
- Glass magnetic boards are only available in gloss finish options
- Back-painted glass is low-iron glass
- Magnets are included with glass magnetic panels
- 43"-H Tackboard or glass magnetic board should be specified for a single height overhead mounted at 84" height
- 29"-H Tackboard or glass magnetic board should be specified for a double height overhead mounted at 70" height
- See page ix for fabric restrictions
- Metal display shelves are available in clear anodized or powder coat metal finishes
- Display shelves are low-iron glass and available in gloss or satin; no additional upcharge for satin glass display shelf
- Black back-painted glass is only available in satin finish

#### REQUIRED INFORMATION (ORDER CANNOT BE ENTERED WITHOUT THIS INFORMATION)

See appendix pages vi-vii for surface material options.

- Choose Fabric, if applicable
- Choose Glass Finish, if applicable
- Choose Veneer Finish
- Choose Paint Finish, if applicable
- Choose Metal Finish, if applicable



# 43" -HIGH WALL PANELS

BACK PANELS FOR USE WITH SINGLE HIGH OVERHEAD OR SHELF MOUNTED AT 84" HEIGHT

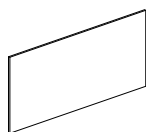

CBTF-4396

## FABRIC TACK PANEL

MODEL #	W X H	PANEL SECTIONS	YARDAGE	COM	A	B	C	D	E	F	G	H
CBTF-4360	60 x 43	1	2	678	858	945	1,042	1,135	1,230	1,318	1,410	1,457
CBTF-4366	66 x 43	1	2	720	928	1,033	1,135	1,238	1,344	1,446	1,552	1,594
CBTF-4372	72 x 43	1	3	761	988	1,106	1,221	1,339	1,450	1,568	1,682	1,725
CBTF-4378	78 x 43	1	2.8	802	1,054	1,180	1,307	1,436	1,566	1,689	1,814	1,859
CBTF-4384	84 x 43	1	3.0	839	1,113	1,253	1,394	1,526	1,667	1,805	1,946	1,988
CBTF-4390	90 x 43	1	3.3	873	1,170	1,319	1,470	1,618	1,771	1,921	2,072	2,116
CBTF-4396	96 x 43	1	3.5	898	1,228	1,389	1,551	1,708	1,867	2,030	2,194	2,203
CBTF-43102	102 x 43	2	3.8	933	1,283	1,457	1,625	1,797	1,971	2,142	2,321	2,365
CBTF-43108	108 x 43	2	4.0	961	1,334	1,518	1,703	1,886	2,071	2,253	2,436	2,481
CBTF-43114	114 x 43	2	4.3	986	1,382	1,575	1,772	1,965	2,165	2,356	2,558	2,603
CBTF-43120	120 x 43	2	4.5	1,017	1,428	1,640	1,845	2,052	2,258	2,466	2,674	2,717

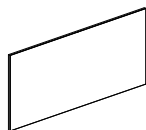

CBMG-4396

## MAGNETIC GLASS PANEL

MODEL #	W X H	PANEL SECTIONS	GLASS PANEL
CBMG-4360	60 x 43	1	3,220
CBMG-4366	66 x 43	1	3,351
CBMG-4372	72 x 43	1	3,493
CBMG-4378	78 x 43	1	3,637
CBMG-4384	84 x 43	1	3,790
CBMG-4390	90 x 43	1	3,947
CBMG-4396	96 x 43	1	4,112
CBMG-43102	102 x 43	2	4,282
CBMG-43108	108 x 43	2	4,462
CBMG-43114	114 x 43	2	4,648
CBMG-43120	120 x 43	2	4,840

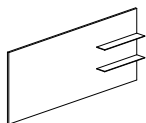

CBPD-4396

## SURFACE MATERIAL KEY

S Painted Panel  
V Veneer Panel

## PANEL WITH DISPLAY SHELVES

MODEL #	W X H	PANEL SECTIONS	-S	-V
CBPD-4360-[ ]	60 x 43	1	3,060	3,220
CBPD-4366-[ ]	66 x 43	1	3,186	3,351
CBPD-4372-[ ]	72 x 43	1	3,317	3,493
CBPD-4378-[ ]	78 x 43	1	3,455	3,637
CBPD-4384-[ ]	84 x 43	1	3,601	3,790
CBPD-4390-[ ]	90 x 43	1	3,750	3,947
CBPD-4396-[ ]	96 x 43	1	3,904	4,112
CBPD-43102-[ ]	102 x 43	1	4,068	4,282
CBPD-43108-[ ]	108 x 43	1	4,238	4,462
CBPD-43114-[ ]	114 x 43	1	4,413	4,648
CBPD-43120-[ ]	120 x 43	1	4,599	4,840

[ ] Specify Display Shelves Left (-L) or Right (-R)



# 43"-HIGH WALL PANELS

OPTIONS	CODE	NOTES
<b>Display Shelf Width Options:</b>		
24"	-24	Includes two Display Shelves
30"	-30	Includes two Display Shelves
36"	-36	Includes two Display Shelves
<b>Display Shelf Material Options:</b>		
Metal	-MDS	
Glass	-GDS	

## GENERAL INFORMATION

- Fabric tackboards 102" and greater will have an even split two-piece construction
- Glass magnetic boards 102" and greater will have an even split two-piece construction
- Glass magnetic boards are only available in gloss finish options
- Back-painted glass is low-iron glass
- Magnets are included with glass magnetic panels
- 43"-H Tackboard or glass magnetic board should be specified for a single height overhead mounted at 84" height
- 29"-H Tackboard or glass magnetic board should be specified for a double height overhead mounted at 70" height
- See page ix for fabric restrictions
- Metal display shelves are available in clear anodized or powder coat metal finishes
- Display shelves are low-iron glass and available in gloss or satin; no additional upcharge for satin glass display shelf
- Black back-painted glass is only available in satin finish

### REQUIRED INFORMATION (ORDER CANNOT BE ENTERED WITHOUT THIS INFORMATION)

See appendix pages vi-vii for surface material options.

- Choose Fabric, if applicable
- Choose Glass Finish, if applicable
- Choose Veneer Finish
- Choose Paint Finish, if applicable
- Choose Metal Finish, if applicable



# TOWERS



CBTW-18-2470



CBTW-30-1770



CTTW-18-2484



CTTW-36-2484

## SURFACE MATERIAL KEY

S	All Paint
VS	Veneer Case with Paint Front
V	All Veneer

## 70"-HIGH TOWERS

MODEL #	WIDTH	DEPTH	HEIGHT	DESCRIPTION	-S	-VS	-V
<b>WORK SURFACE DEPTH ALIGNED TOWERS</b>							
<b>26"D (flush with worksurface edge with tack / overhead)</b>							
CBTW-12-2670-[ ]	12	26	70	Wardrobe	3,708	3,901	3,901
CBTW-18-2670-[ ]	18	26	70	Wardrobe	4,447	4,681	4,681
CBTW-36-2670	36	26	70	Double Door Wardrobe w/ 1 Fixed Shelf and 3 Adj Shelves	6,670	7,021	7,021
<b>24"D (flush with worksurface edge without tack / overhead)</b>							
CBTW-12-2470-[ ]	12	24	70	Wardrobe	3,708	3,901	3,901
CBTW-18-2470-[ ]	18	24	70	Wardrobe	4,447	4,681	4,681
CBTW-36-2470	36	24	70	Double Door Wardrobe w/ 1 Fixed Shelf and 3 Adj Shelves	6,670	7,021	7,021
<b>OVERHEAD DEPTH ALIGNED TOWERS</b>							
<b>17"D (For use with adjacent 17"D overhead with sliding door)</b>							
CBTW-24S-1770[ ]	24	17	70	Wardrobe	4,475	4,710	4,710
CBTS-30S-1770[ ]	30	17	70	Double Door Storage w/ 1 Fixed Shelf and 3 Adj Shelves	5,368	5,651	5,651
<b>19"D (For use with adjacent 19" legal depth overhead with sliding door)</b>							
CBTW-24S-1970[ ]	24	19	70	Wardrobe	4,475	4,710	4,710
CBTS-30S-1970[ ]	30	19	70	Double Door Storage w/ 1 Fixed Shelf and 3 Adj Shelves	5,368	5,651	5,651
<b>17"D (For use with adjacent 17"D overhead with hinged doors or open shelves)</b>							
CBTW-24H-1770[ ]	24	17	70	Wardrobe	4,475	4,710	4,710
CBTS-30H-1770[ ]	30	17	70	Double Door Storage w/ 1 Fixed Shelf and 3 Adj Shelves	5,368	5,651	5,651
<b>19"D (For use with adjacent 19" legal depth overhead with hinged doors or open shelves)</b>							
CBTW-24H-1970[ ]	24	19	70	Wardrobe	4,475	4,710	4,710
CBTS-30H-1970[ ]	30	19	70	Double Door Storage w/ 1 Fixed Shelf and 3 Adj Shelves	5,368	5,651	5,651

[ ] Specify Left (-L) and Right (-R) support

## 84"-HIGH TOWERS

MODEL #	WIDTH	DEPTH	HEIGHT	DESCRIPTION	-S	-VS	-V
<b>WORK SURFACE DEPTH ALIGNED TOWERS</b>							
<b>26"D (flush with worksurface edge with tack / overhead)</b>							
CBTW-12-2684[ ]	12	26	84	Wardrobe	3,876	4,083	4,083
CBTW-18-2684[ ]	18	26	84	Wardrobe	4,653	4,898	4,898
CBTW-36-2684	36	26	84	Double Door Wardrobe w/ 1 Fixed and 3 Adj Shelves	6,978	7,344	7,344
<b>24"D (flush with worksurface edge without tack / overhead)</b>							
CBTW-12-2484[ ]	12	24	84	Wardrobe	3,876	4,083	4,083
CBTW-18-2484[ ]	18	24	84	Wardrobe	4,653	4,898	4,898
CBTW-36-2484	36	24	84	Double Door Wardrobe w/ 1 Fixed and 3 Adj Shelves	6,978	7,344	7,344
<b>OVERHEAD DEPTH ALIGNED TOWERS</b>							
<b>17"D (For use with adjacent 17"D overhead with sliding door)</b>							
CBTW-24S-1784[ ]	24	17	84	Wardrobe	4,679	4,926	4,926
CBTS-30S-1784[ ]	30	17	84	Double Door Storage w/ 1 Fixed Shelf and 4 Adj Shelves	5,615	5,912	5,912
<b>19"D (For use with adjacent 19" legal depth overhead with sliding door)</b>							
CBTW-24S-1984[ ]	24	19	84	Wardrobe	4,679	4,926	4,926
CBTS-30S-1984[ ]	30	19	84	Double Door Storage w/ 1 Fixed Shelf and 4 Adj Shelves	5,615	5,912	5,912
<b>17"D (For use with adjacent 17"D overhead with hinged doors or open shelves)</b>							
CBTW-24H-1784[ ]	24	19	84	Wardrobe	4,679	4,926	4,926
CBTS-30H-1784[ ]	30	19	84	Double Door Storage w/ 1 Fixed Shelf and 4 Adj Shelves	5,615	5,912	5,912
<b>19"D (For use with adjacent 19" legal depth overhead with hinged doors or open shelves)</b>							
CBTW-24H-1984[ ]	24	19	84	Wardrobe	4,679	4,926	4,926
CBTS-30H-1984[ ]	30	19	84	Double Door Storage w/ 1 Fixed Shelf and 4 Adj Shelves	5,615	5,912	5,912

[ ] Specify Left (-L) and Right (-R) support



# TOWERS

OPTIONS	CODE	PRICE	NOTES
Tower Locks	-LO	\$269	
Mirror	-MR	\$310	
Additional Storage Shelves (2)	-SH2	\$456	

## GENERAL INFORMATION

- Grain direction is vertical
- Towers are standard without locks
- Single Door Towers will have a full height integral pull
- Double Door Towers will have touch latch
- Optional mirror ships uninstalled, with a mounting template
- Freestanding 12"-wide Towers must be fastened to the adjacent case
- Shallow depth 24"-wide Wardrobe Tower 17" and 19" depth include:
  - 1 fixed shelf above wardrobe bar
  - Can accept two sets of optional adjustable shelves
  - Optional adjustable shelves are located at 14" and 27" above bottom panel, with three pre bored holes for adjustment
- Shallow depth 30"-wide Double Door Tower 17" and 19" depth include:
  - 1 fixed shelf 36" above the bottom panel
  - 70"H tower includes three adjustable shelves and can accept one set of optional adjustable shelf
  - 84"H tower includes four adjustable shelves and can accept one set of optional adjustable shelves
  - Side panels of tower are pre bored with 12 locations for optional shelf placement both above and below the fixed shelf
  - Lock option on Double Door Towers includes two locks, one on each door
- Towers 24" and 26" deep include the following:
  - 1 fixed shelf - a hat shelf above the wardrobe bar
  - The 70"H tower has 58" clearance from the wardrobe bar to the bottom panel
  - The 84"H tower has 72" clearance from the wardrobe bar to the bottom panel
  - Double Door Towers will have a center vertical divider panel and include three adjustable shelves located at 41", 28", and 14" above bottom panel, with three pre-bored holes for adjustment
  - Lock option on Double Door Towers includes two locks, one on each door
  - Double Door Tower is universal. The wardrobe and storage shelves are field reversible.

### REQUIRED INFORMATION (ORDER CANNOT BE ENTERED WITHOUT THIS INFORMATION)

See appendix pages vi-vii for surface material options.

- Choose Veneer Finish
- Choose Paint Finish, if applicable





# MEETING TABLES



ROUND

## SURFACE MATERIAL KEY

PE	Laminate Top with ABS Square Edge
V	Veneer
G	Glass

## ROUND TABLE

MODEL #	DIAMETER	BASE QTY.	TOP SECTIONS	SEATING CAPACITY	-PE	-V	-G
CBRO-36	36	1	1	3	2,752	3,072	4,754
CBRO-42	42	1	1	4	3,053	3,418	5,338
CBRO-48	48	1	1	5	3,775	4,236	6,670
CBRO-54	54	1	1	6	4,652	5,236	8,303

## OPTIONS

### CODE

### PRICE

### NOTES

#### Polished Chrome Options:

Polished Chrome Base

-PCX

\$569

#### Satin Glass

-RSG

\$382

## EDGE PROFILE



Laminate with ABS Square Edge



Wood Edge



Glass Edge

## GENERAL INFORMATION

- Veneer tops are 1-1/8" thick with 3/16"-deep hardwood edge band
- Overall table height 29-1/2"
- No power options are available
- Laminate tops are 1-1/8"-thick with 2mm ABS edge
- Tops include a 1-1/8"-thick sub-top with 3/16"-deep hardwood edge band and 1/4"-thick back painted glass
- Metal X base not available in CA clear anodized
- Subtop material on glass tops can be either paint or veneer

### REQUIRED INFORMATION (ORDER CANNOT BE ENTERED WITHOUT THIS INFORMATION)

See appendix pages vi-vii for surface material options.

- Choose Veneer Finish, if applicable
- Choose Metal Finish
- Choose Laminate Finish, if applicable
- Choose ABS Finish, if applicable
- Choose Glass Finish, if applicable
- Choose Subtop Finish, if applicable (Paint Finish or Veneer Species)



# ACCESSORIES

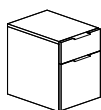

CBFP-BF-1521

## SURFACE MATERIAL KEY

S	All Paint
VS	Veneer Case with Paint Front
V	All Veneer

## FREESTANDING STORAGE PEDESTAL

MODEL #	DEPTH	WIDTH	DESCRIPTION	-S	-VS	-V
CBFP-BF-1521	21	15	Freestanding Box/File	2,451	2,579	2,579

## OPTIONS

### Pedestal Options:

No Locks (Pedestals)

**-NL**

No Charge

Undermount Soft Close Drawer Slide

**-US**

\$152

### Pull Options:

Integrated Pull

**-IP**

No Charge

Metal Tabl Pull

**-MT**

No Charge

Polished Chrome Pull

**-PCP**

\$194

### Seat Cushion (1-1/2 yds)

COM Fabric

**-SC-COM**

\$404

Grade A

**-SC-A**

\$552

Grade B

**-SC-B**

\$599

Grade C

**-SC-C**

\$684

Grade D

**-SC-D**

\$766

Grade E

**-SC-E**

\$848

Grade F

**-SC-F**

\$903

Grade G

**-SC-G**

\$987

Grade H

**-SC-H**

\$1,029

## GENERAL INFORMATION

- Grain direction is vertical
- Pencil trays standard within Box Drawer, runs depth of the drawer box
- Face locking standard on all desk pedestals, locks are always located on the right
- Pedestal is standard with white drawer boxes and sidemount self closing drawer slides
- 15"-wide pedestals accommodate side-to-side legal filing

### REQUIRED INFORMATION (ORDER CANNOT BE ENTERED WITHOUT THIS INFORMATION)

See appendix pages vi-vii for surface material options.

- Choose Veneer Finish, if applicable
- Choose Metal Finish, if applicable (Options include Chrome, Clear Anodized, and Powder Coat finishes)
- Choose Paint Finish, if applicable



# ACCESSORIES

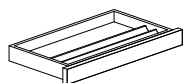

CENTER DRAWER

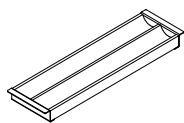

PENCIL TRAY AND DIVIDERS

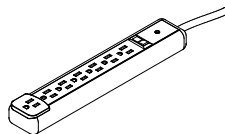

PLUG STRIP

## SURFACE MATERIAL KEY

V Veneer  
P Paint

### CENTER DRAWER

MODEL #	W x D x H	-V	-P
CD-200	20 x 12 x 2	868	825

#### GENERAL INFORMATION

- The drawer box is white melamine.

### PENCIL TRAY AND DIVIDERS

MODEL #	W x D x H	DESCRIPTION	PRICE
PT-15	13 x 4.25 x 1	For use with Freestanding Pedestal	131
PT-18	16 x 4.25 x 1	For use with Pedestals supporting a work surface	151

#### GENERAL INFORMATION

- Pencil Trays rest on the edge of the drawer box and are positioned front to back

### PLUG STRIP

MODEL #	W x D x H	DESCRIPTION	PRICE
MOA-10	2.05 x 11.69 x 1.32	Black Power Plug Strip	182

#### GENERAL INFORMATION

- 15 amps - Mounts into Wire Trough
- Includes (7) outlets, surge protection and 12' electrical cord



# POWER AND DATA OPTIONS

POWER SPEC	MODEL #	DESCRIPTION	PRICE
 PWR-R-W	PWR-R-B	Round Power Spec with Black Faceplate	116
	PWR-R-W	Round Power Spec with White Faceplate	116
	PWR-SQ-B	Square Power Spec with Black Faceplate	116
	PWR-SQ-W	Square Power Spec with White Faceplate	116



PWR-SQ-W

## GENERAL INFORMATION

- Includes one simplex receptable
- 12' cord

### REQUIRED INFORMATION: (ORDER CANNOT BE ENTERED WITHOUT THIS INFORMATION)

See appendix pages vi-vii for surface material options.

- Choose Metal Finish: Satin Nickel (SNB) or Chrome (CB)
- Work surface must be specified with Spec location code to include cutout that accepts Spec unit

USB SPEC	MODEL #	DESCRIPTION	PRICE
 USBC-R-W	USBC-R-B	Round Data Spec with Black Faceplate	243
	USBC-R-W	Round Data Spec with White Faceplate	243
	USBC-SQ-B	Square Data Spec with Black Faceplate	243
	USBC-SQ-W	Square Data Spec with White Faceplate	243



USBC-SQ-W

## GENERAL INFORMATION

- Includes one charging USB-A+C
- 12' cord

### REQUIRED INFORMATION: (ORDER CANNOT BE ENTERED WITHOUT THIS INFORMATION)

See appendix pages vi-vii for surface material options.

- Choose Metal Finish: Satin Nickel (SNB) or Chrome (CB)
- Work surface must be specified with Spec location code to include cutout that accepts Spec unit

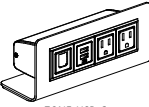
TECH ZONE	MODEL #	DESCRIPTION	SIMPLEX OUTLETS	OPEN DATA PORTS	CHARGING USB-A+C	PRICE
 ZONE-USB-C	ZONE-DATA	(2) Simplex receptacles, (2) Open data ports	2	2	-	341
	ZONE-USB-C	(2) Simplex receptacles, (1) Charging USB-A+C, (1) Open data port	2	1	1	408

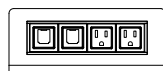

ZONE-DATA

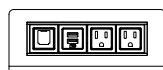

ZONE-USB-C

## GENERAL INFORMATION

- 72" long plug-in infeed cord
- Finish is black
- Includes a Voice/Data Adapter Kit to accept couplers and jacks when required



# Appendix

---



# GENERAL INFORMATION

This price book supercedes all previous versions.

**Before placing your order, confirm you have all required information necessary. Lead times for orders begin after all required information is included and correct.**

## Delivery Information

We know lead times are important and sticking to them even more so. We work to maintain a 6-8 week lead time on all standard products in this book from receipt of a clean order. All orders are acknowledged with an approximate shipping date and will be invoiced with the price in effect at the date the purchase order is received.

Shipping charges are prepaid (within the continental U.S.). Therefore, pricing is a delivered price based on normal ground transportation. If you have special instructions, need to ship by air, or are shipping to Alaska or Hawaii, contact NuCraft Customer Service. NuCraft can also help arrange to have products blanket wrapped for an additional charge. Contact the NuCraft Customer Service team or specify it on your purchase order.

**Minimum Freight Charge: Any order below \$2,800 net will be assessed a \$450 net minimum freight charge (one per order).**

Orders are subject to acquiring the materials required for manufacturing. Fulfillment can be affected by strikes, fires, embargoes and acts of government. These elements are beyond our control.

NuCraft offers a variety of services to accommodate a wide range of delivery requirements. Availability of these services is dependent on a number of factors and may not be offered with all shipments. Examples of delivery services that have additional fees include:

- Specific date within our standard 3-5 day delivery window (for orders under \$50,000 net)
- Specific time of day, morning or afternoon (for orders under \$50,000 net)
- Delivery to a warehouse before delivery to its final destination (unless product is picked up at the warehouse)

Contact the NuCraft Customer Service team for availability and pricing on these services.

## Freight Terms

Shipping charges for NuCraft products are prepaid for standard delivery in the continental United States. Standard delivery is defined as follows: Product is delivered on a 53' trailer being pulled by a long-haul tractor (total length of 85'). Facility will receive delivery Monday through Friday between the hours of 8:00 AM and 4:00 PM. Facility has docks with levelers and a fork truck for unloading. Product will be loaded on load bars two levels high. Receiving facility is responsible to have personnel on hand to unload the truck upon arrival, drivers do not unload. Delivery sites or times that do not meet this criteria will be accommodated, but will typically incur a charge to cover additional shipping costs. Please notify NuCraft in advance of the shipment if this is the case and the additional charge (if any) will be determined by NuCraft.

Product ships FOB dock. The customer obtains title to their product and materials, and assumes the risk of loss for them, upon shipment from NuCraft's facilities.

## Storage

NuCraft has no storage facilities for finished product. If a customer cannot accept an order when it is ready for shipment, the customer must designate an alternative shipping address. If no address is provided, NuCraft may, at its discretion, transfer the product to storage. If product is transferred to an off-site storage facility, the customer may be charged for transportation to the facility and for any associated storage fees. NuCraft considers transfer of the product to a storage facility the equivalent of shipment, including invoicing and payment. Customers assume the risk of damage or loss during storage.

## Transportation Times and Delays

Third party carriers that NuCraft contracts with will make reasonable efforts to accommodate requested delivery times and dates. Scheduled delivery appointments may, however, be delayed for a variety of reasons, including inclement weather, traffic, transportation equipment problems, and delays encountered at other delivery locations along the delivery route. NuCraft does not recommend scheduling activities that depend on the delivery appointment (for example, scheduling furniture installers to install furniture the day of the delivery appointment). NuCraft shall not be liable for any costs incurred as a result of a missed delivery appointment.

## Shipment Damage Claims

Legal title to merchandise passes to the buyer upon acceptance by the carrier. **Inspect all cartons upon delivery.** Details of visible damage should be noted on the delivery receipt. Do not install product if damage is found upon inspection. The carrier should be notified by the buyer to inspect the merchandise, and file a claim immediately. If visible damage is not apparent, sign the delivery receipt "No visible damage." This will allow recourse for a concealed damage claim. Although most claims for transportation damages must be filed against the carrier within nine months of the date of delivery, concealed damage claims must be filed within 15 days of receipt.

Do not destroy packing materials until shipment has been inspected. Then proceed to file a claim with the carrier.

**Failure to make any claims against NuCraft within 10 days shall constitute acceptance of the merchandise and a waiver of any defects, errors or shortages discovered upon inspection.**

## Cancellations

Cancellations must be reviewed by our Customer Service team. Because we build your products to order, orders cannot be cancelled once processing has begun. Processing includes but is not limited to development of shop drawings and other engineering drawings. If cancellation is approved, a processing fee of 20-100% will be assessed based on the status of the order.

## Change Order Policy

NuCraft will make every attempt to honor any reasonable change request to product provided that the request is received prior to start of production. Change orders will be accepted only if the request is made in writing and received in time to make the change. NuCraft reserves the right to increase our acknowledged price and ship date if necessary to make the requested changes. Please submit any change order request to our Customer Service team. NuCraft will assess charges to the customer as stipulated in the following:

- Standard Orders: Change orders received prior to production will be charged \$400 net to cover administrative costs.
- Special Orders: Change orders received prior to production will be charged \$400 net to cover administrative costs. There may be additional costs associated with engineering labor required for the change order.
- Change orders received after production must be evaluated by NuCraft. If approved, the charge will be \$400 net plus any restocking charges accumulated. There may be additional costs associated with engineering and/or manufacturing labor, as well as material costs, required for the change order.



# GENERAL INFORMATION

## Repair Authorization

Prior written approval is required for repairs of merchandise charged to Nucraft. Failure to do so will result in customer funded repairs.

## Payment Terms

Deposits are required at the time of order due to the custom nature of our products. See information regarding Cancellations above.

Credit terms are available to qualified customers. Please contact AR@Nucraft.com to start the application process. Note that the credit application process requires a valid sales tax exemption or resale tax certificate, Form W-9, and three current trade references.

Credit Card Payments are accepted via web portal. Please contact AR@Nucraft.com for payment instructions. Note that a 2% convenience fee will be added for using this payment method and no early pay discounts are allowed on credit card payments.

## Warranty

Nucraft Furniture is warranted to be free from defects in materials and workmanship for a period of ten years of single shift use. Limitations include:

- Mechanical Devices such as latches, casters, and other moving components are warranted for five years of the date of original delivery.
- Height adjustable components are warranted for two years of the date of original delivery.
- The following are warranted for one year of the date of original delivery:
  - Textiles
  - Electrical Components
  - Refrigeration Units
  - Custom Products not described in Nucraft's Catalogue

This warranty is applicable only if furniture is properly installed and maintained in an office environment. This warranty extends only to products manufactured and sold in North America and only to original purchasers acquiring new Nucraft product through authorized dealers or approved sellers.

During this warranty period, Nucraft's sole obligation is to repair or replace, at Nucraft's discretion, products which prove to be defective during the warranty period.

This warranty does not cover:

- Damage caused by a carrier.
- Damage from user modification, misuse, abuse, accident, or negligence.
- Customer's Own Material (COM) specified by the customer that is not a standard product offering.
- Color, grain, or texture of wood and other covering material.

**Nucraft extends no other warranties, expressed or implied, including warranty of merchantability or fitness for a particular purpose. Nucraft shall not be liable for loss of time, inconvenience, commercial loss, incidental or consequential damages.**

## Environmental Statement

Nucraft is committed to supporting responsible environmental policies and practices in all that we do. We strive for sustainability, weighing our business decisions against the costs to the ecological, social and economic systems they affect.

Our products are manufactured to meet the credit requirements of the U.S. Green Building Council's LEED rating systems in one or more of the following categories:

- Recycled Content
- Certified Wood
- Low-Emitting Materials

## Computer Aided Planning

Nucraft products and pricing are available on CD via 2020 Cap, an AutoCAD®-based space planning tool.

2020 Cap is an integrated software system developed specifically for interior designers and facility planners to enhance workplace performance. This modern suite of applications works together seamlessly, in concert. Navigate catalogs, select products, design in plan view and 3D, assign options, create worksheets and build a project where you want, when you want. Take your pick. It's dynamic and interactive. Design projects are a work in progress. And now you can perform any of the many discrete tasks that go into a project any time, any place.

For additional information, you may contact 2020 Cap direct at 800-227-0038.

## iSpec®

Nucraft offers a free online product configuration and specification service that saves you time and allows you to be creative while leaving the nuts and bolts to someone else. No specific software is required, nor is there any learning curve. This service applies to all Nucraft products. For additional information, call 1-877-NUCRAFT and ask for the iSpec Team or log on to [www.nucraft.com/ispec](http://www.nucraft.com/ispec).



# FINISH INFORMATION

## Surface Materials Palette

We crafted our materials palette using the same demanding standards that distinguish our furniture. Thoughtful design and attention to every detail elevate your possibilities.

Anchored by Nucraft veneers, unrivaled for clarity, quality, and depth of finish, our collection of surface materials comprises a sophisticated set of balanced elements that supports your design vision.

Some elements have their roots in Nucraft's rich heritage. Others are new materials and reflect current trends and taste. Together, they ensure that you're ready for today and positioned well for the future. Beautifully.

## Custom Finishes

Nucraft specializes in expert custom finish matching. For a nominal upcharge we can provide custom finishes, and we are frequently asked to match the finishes of other furniture manufacturers. For finishes that appear unusual to match or for customers directly requesting a sample, a finish sample will be sent for approval prior to entering the order.

Custom finishes requiring colored varnishes to create a painted look can only be applied to Maple veneer and require one extra week in addition to the standard lead time. Nucraft's standard black finish (G82) can be applied to all Nucraft standard veneers. Walnut is the standard black veneer. Other species must be specified when ordering.

Clear coat on a special veneer requires an approved sample.

Custom finishes carry a 10% upcharge per item, per finish, capped at \$1,975 List.

Custom finish upcharges are not applied to any item that is not wood. Example: casters, ganging connectors, power options..

## Treatments

**Note: Default veneer sheen will vary per finish and product. Default finish is bolded on pages vi-vii. If no direction is provided on incoming orders, default sheen will be selected. In addition, default veneer cut is noted in the price list. If no direction is provided on incoming orders, default cut will be selected.**

**Gloss:** Gloss is a durable finish that tends to nicely mask normal wear and leaves wood grain visible to the eye. It achieves a medium gloss open pore appearance (40 – 50 sheen range). Finish numbers preceded by the letter "G" indicate a Gloss finish.

**Matte:** Like Gloss, Matte is durable, tends to nicely mask normal wear and leaves wood grain visible to the eye. It achieves a low luster, open pore appearance (10 – 20 sheen range). Finish numbers preceded by the letter "M" indicate a Matte finish.

Since each veneer type responds differently to both types of treatment, all will have a distinctive look and feel when finished. For example, a Walnut veneer with a Gloss treatment will remain much more textured than a Cherry veneer with the same treatment.

## About the Wood

All Nucraft veneers are carefully selected for uniformity of color and grain. Still, wood is a natural substance and minor variations may occur due to its own uniqueness. Because of this, the furniture you receive may not be an exact match to our samples.

Nucraft takes great pride in our finish color consistency. However, wood is a natural product that will have color variation within a single piece of furniture, as well as from one piece to the next. Other factors also affect color over time, such as exposure to light (both intensity and duration). For example, lighter finishes cause more variation in colors over time.

In cases where a returning customer wants a precise match with existing furniture, we recommend sending a sample of the existing furniture finish. Please contact Nucraft Customer Service to determine an appropriate sample. This will ensure a finish match between old and new orders. This type of order is considered a control sample. There will be a 10% upcharge on an order of this type. Due to natural aging of veneers, natural finishes may vary.

## Care and Maintenance of Wood Finishes

Our finish material is a crystal clear, urethane acrylic blend. This type of finish may be repaired in the field by a qualified refinisher.

Nucraft recommends using a damp cloth to clean your fine wood furniture. Always wipe with the grain of the wood. Should your wood furniture require a more thorough cleaning, we recommend using a mild cleaner such as Joy dish soap or Murphy's oil soap, thoroughly diluted in water (one part soap to thirty parts water). Water will not damage Nucraft's finish, but it may leave surface spots when it dries. To avoid this, dry the surface with a soft cloth after it is cleaned. Marks that cannot be removed with the cleaning methods above may be able to be removed using naphtha, a mild degreasing solvent.

Caution: while the use of polishes that contain wax, petroleum solvents or silicones may immediately enhance the "shine" of a product, it may also eventually remove the fine original finish applied in our factory. Silicone on the surface of wood may also make it very difficult to respray or refinish.

All Nucraft furniture is inspected and polished before it leaves our factory. In some instances, the packing materials may imprint on the factory polish. Cleaning and polishing the furniture once it is unpacked will normally restore the furniture to its original beauty.

In some cases, the rubber support feet used on the bottom of common office equipment (teleconferencing phones, laptops, microphones, copiers, etc.) can create unsightly marks in the surface of wood tops, due to oxidation of the lacquer finish. We suggest these machines be placed on a protective type of padding, such as felt.

Wood will fade as a result of exposure to UV light. This is particularly prevalent with light finishes. If color changes due to fading are a concern for your application, the impact can be minimized by selecting medium to dark stains for your wood surfaces. Our top coat includes a UV inhibitor which makes the finishes less prone to fading.





# FINISH INFORMATION

## Laminates

Selected Formica® and Nevamar® laminates are available on Training Tables, Conference Tables, Conference Room Furniture and select Occasional Tables. For standard laminate and wood pricing, refer to individual item pricing columns.

## Non-Standard Laminates and Linoleums

To order a color other than those on our list (see pages vi-vii), refer to Nevamar or Formica standard grade, matte texture laminate offerings and Forbo Furniture Linoleums (excluding manufacturers' non-standard matte offering).

- For approved non-standard laminates with a hardwood edge, the upcharge is 10% of the base price per laminate color with a minimum of \$500 and capped at \$1975.
- For approved non-standard laminate with a standard ABS edge, the upcharge is \$175 per laminate color.
- For approved non-standard laminates with a non standard ABS edge, please contact customer service.

To ensure your non standard laminate is on our approved list, please contact customer service. Add one week to the lead-time for all non-standard laminate and linoleum orders. Call the NuCraft Customer Service team for quotes on premium grades and laminates. Mirror and metal laminates are not available.

## Care and Maintenance of Laminate and Novawrap

Laminate and Novawrap surfaces may be cleaned with a damp cloth and ordinary soap or non-abrasive household liquid detergent. Dry the surface with a clean cloth or soft paper towel to prevent streaks from appearing.

## Care and Maintenance of Metal

Metal surfaces can be wiped with a damp cloth and rubbed dry. A mild non-abrasive household liquid detergent can be used if necessary. Regular maintenance of metal components, including tightening of fasteners and light lubrication of moving parts, will extend the life of your furniture.

## Satin Etched Glass

Glass color may vary slightly on multi-piece conference table tops over 180" x 60" when satin etched glass is specified due to the iron content and etching process of the glass.

## Care and Maintenance of Glass

Clear or frosted glass may be cleaned with commercial glass cleaner. Be sure to use a lint-free cloth if cleaning the frosted side of the glass.

## Stone and Solid Surface Material

Despite its reputation for durability, natural stone can easily be broken during handling and/or installation if proper techniques are not followed. In addition, NuCraft is not responsible for the installation of natural stone or solid surface materials on its products. Therefore, installers specifically trained in the installation of these materials must be utilized to ensure a quality installation. NuCraft shall not be liable for any damages incurred during the handling and/or installation of natural stone or solid surface materials on its products.

## Care and Maintenance of Granite

Granite surfaces may be cleaned with a damp cloth and ordinary soap or non-abrasive household liquid detergent. Dry the surface with a clean cloth or soft paper towel to prevent streaks from appearing.

## Care and Maintenance of Leather

Genuine leather requires very little care. NuCraft recommends that leather be dusted regularly. If a more thorough cleaning is needed, use lukewarm water and a mild, non-abrasive soap. Generate some lather and lightly rub the surface with cheesecloth. Rinse off any soap film with clean water and towel dry. The leather may dry dull. To restore the leather to a normal gloss, rub it with a clean towel. Never use furniture polish, oil, varnish or ammonia. Saddle soap may be used to prevent the leather from becoming brittle or cracked and to maintain the original supple finish.

## Touch Up Finish Kits

Model #	Description	Price
KIT-M	Metal Kit	80
KIT-P	Paint Kit	80
KIT-S	Stain Kit	80

## REQUIRED INFORMATION:

### (ORDER CANNOT BE ENTERED WITHOUT THIS INFORMATION)

- Kit model number
- Quantity of kits
- Specify finish (See pages vi-vii)

## General Information:

- Touch-up kits must be ordered on a purchase order separate from NuCraft product due to Hazmat shipping



## WOOD FINISHES

### STANDARD

Default veneer sheen will vary per finish and were determined by a team of experts who reviewed the colorways to determine if gloss or matte best highlighted the natural characteristics of the species of wood and the color of the stain. Default finish is bolded. If no direction is provided, default sheen will be selected.

	Matte	Gloss
<b>Ash</b>		
Blanco	<b>M44</b>	G44
Char	<b>M50</b>	G50
<b>Rift Cut Oak</b>		
Carbon	M03	<b>G03</b>
<b>Flat Cut Oak</b>		
Dune	<b>M05</b>	G05
Portobello	<b>M7413</b>	G7413
<b>Flaky Oak</b>		
Sahara	<b>M61</b>	G61
<b>Cherry</b>		
Cognac	M21	<b>G21</b>
Auburn	M93	<b>G93</b>
<b>Walnut</b>		
Marron	<b>M35</b>	G35
Mocha	<b>M33</b>	G33
Zinc	M30	<b>G30</b>
Onyx	M82	<b>G82</b>
Otter	M31	<b>G31</b>
<b>Maple</b>		
Natural Maple	M60	<b>G60</b>
<b>Linea</b>		
Oak Linea	<b>M08</b>	G08
Walnut Linea	<b>M27</b>	G27
Euro Birch Linea	<b>M09</b>	G09
Silver Birch Linea	M10	<b>G10</b>
<b>Paldao</b>		
Thicket	<b>M75</b>	G75
Paldao	<b>M76</b>	G76
Canyon	M77	<b>G77</b>

## METAL FINISHES

### Powder Coat

Aged Bronze	A8010
Black	A44
Burnished	A8009
Cloud	A8004
Foil	A8006
Galaxy	A8007
Satin Bronze	A8011
Shadow	A8005
Storm	A8012

### Metal

Clear Anodized*	CA
-----------------	----

\*Overhead metal shelf only available in clear anodized

## PAINTS

Aged Bronze	S8010
Black	S44
Burnished	S88
Cloud	S8004
Foil	S8006
Galaxy	S8007
Moonlight	S87
Satin Bronze	S8011
Shadow	S8005
Storm	S8012

### Paint to Match

To request a custom paint color, contact Nucraft Customer Service. A paint sample must be matched and approved prior to order.

## GLASS (SATIN OR GLOSS)

	Satin	Gloss
Black	BS	-
Clove	VS	VG
Meringue	MS	MG
Quill	QS	QG
White	WS	WG



## LAMINATES

	Code	Coordinating Wood Finish	Suggested ABS Edgeband Coordinate
<b>Wood Grain Laminates</b>			
Formica White Ash	8841-58	M8841	R02, R01
Formica Natural Ash	8843-58	M8843	R02
Formica Aged Ash	8844-58	M8844	R04
Formica Weathered Ash	8842-58	M8842	R05
Formica Oiled Legno	8846-58	M8846	R05
Formica Bleached Legno	8845-58	M8845	R04
Formica Blackened Legno	8848-58	M8848	R05
Formica Pecan Woodline	5883-58	M5883	R04
Formica Chestnut Woodline	5884-58	M5884	R05
Formica Urban Planked Oak	9312-58	M9312	R04
Formica Thermo Walnut	6402-58	M6402	R04
Formica Smoky Brown Pear	5488-58	M5488	R05
Formica Espresso Pear	5489-58	M5489	R05
Formica White Knotty Maple	7410-58	M7410	R02
Formica Sand Maple	9237-58	G60	R02
Formica Planked Coffee Oak	7413-58	M7413	R05

### Solid Laminates

Formica Brite White	459-58	R01
Formica Dover White	7197-58	R01
Formica Pearl	934-58	R02
Formica Graystone	464-58	R02
Formica Folkstone	927-58	R03
Formica Graphite	837-58	R05

### Patterned Laminates

Nevamar Cool Chic	VA7002T	R02
Nevamar Serene Stardom	VA5001T	R05
Nevamar Calm Distinction	VA6001T	R05
Nevamar Easy Elegance	VA5002T	R05
Wilsonart Sheer Mesh	4876-38	R02
Wilsonart Grey Mesh	4877-38	R02
Wilsonart Pewter Mesh	4878-38	R05

## ABS FINISHES

Ashen	R04
Parchment	R02
Shale	R05
Stone	R03
Whitecap	R01



# UPHOLSTERY FABRIC

## Applies to Pedestal Cushions

Nucraft is pleased to have partnered with KnollTextiles, Spinneybeck, and UltraFabrics to offer a concise selection of standard upholstery fabrics pre-approved for use on our products, with prices that are figured into our graded-in system. We've carefully curated a selection of each of the textile's color lines to coordinate with our materials offering. However, all colorways are approved and available as standard. Please contact fabric manufacturer for sampling support.

### Knoll Felt\* | K1207 | Grade C

Ivory	1
Apple	3
Canary	5
Poppy	7
Cadet	11
Mocha	15
Pewter	17
Tar	20

### Knoll Hopsack\* | K1206 | Grade C

Buff	1
Stucco	2
Lime	4
Magenta	9
Red	10
Admiral	11
Putty	13
Black	16

### Knoll Hourglass\* | K1523 | Grade A

Gull	2
Sandbar	3
Flax	5
Beeswax	6
Sizzle	9
Tart	11
Bluebird	13
Spring	16
Bark	21
Misty	24
Alley	27

\*In addition to being available on all of our Pedestal cushion applications, these upholstery fabrics are approved for tackzone application on Nucraft products.

### Spinneybeck Volo | VO | Grade F

Lichen	902
Rust	905
Talc	939
Mauve Beige	954
Oatmeal	957
Parchment	960
Petroglyph	962
Tuscany	963
Casablanca	975
Dromedary	977
Black	BLCK

### Spinneybeck Vincenza | VZ | Grade E

Salvi	2101
Ponte Furo	2102
Villabalzana	2108
Castello di Bellaguardia	2112
Scamozzi	2114
Peralolo	2115
Costozza	2116
Nocciola	2117
Appia Antica	2120
Cinque Terre	2122
Black	BLCK

### UltraFabrics Brisa Original | 533 | Grade B

French Vanilla	3866
Birch	3019
White	5747
Bone	3822
Shiitake	3022
New Sand	3946
Bark	3914
Peat	3200
Canyon	3825
Coffee Bean	3023
Black Onyx	5749

### GRADED-IN FABRIC PROGRAM

Top quality upholstery and fabrics from some of the biggest names in the textile industry have been graded into this price list. For a current list of graded-in manufacturers and additional information on our graded-in fabrics program, please go to [www.nucraft.com](http://www.nucraft.com).

NET PRICE PER YARD	NUCRAFT GRADE
\$0 - \$25.00	A
\$25.01 - \$40.00	B
\$40.01 - \$55.00	C
\$55.01 - \$70.00	D
\$70.01 - \$85.00	E
\$85.01 - \$100.00	F
\$100.01 - \$115.00	G
\$115.01 - \$130.00	H



## KNOLLTEXTILES

Nucraft is pleased to have partnered with KnollTextiles to offer a concise selection of standard fabrics pre-approved for use on our products, with prices that are figured into our graded-in system. We've carefully curated a selection of each of the textile's color lines to coordinate with our materials offering. However, all colorways are approved and available as standard. Please contact fabric manufacturer for sampling support.

All tackzone fabrics are applied railroaded

### KnollTextiles Beacon | W1597 | Grade A

Spotlight	1
Tusk	2
Fossil	3
Marsh	4
Saffron	5
Hotshot	6
Bonfire	7
Reef	8
Nile	9
Putty	10
Cool Gray	11
Dust	12

### KnollTextiles Reflect | W884 | Grade B

Ice	1A
Titanium	2A
Sterling*	3A
Ecru	5A
Ember	9A
Target	10A
Sharkskin	13A
Lagoon	14A

\*Default Fabric

## GRADED-IN FABRIC PROGRAM

Top quality upholstery and fabrics have been graded into the price list. We work with various distributors and now offer a larger selection of fabrics. For a current list of graded-in manufacturers, check our website at [www.nucraft.com](http://www.nucraft.com)

### NET PRICE PER YARD      N U C R A F T   G R A D E

\$0 - \$25.00	A
\$25.01 - \$40.00	B
\$40.01 - \$55.00	C
\$55.01 - \$70.00	D
\$70.01 - \$85.00	E
\$85.01 - \$100.00	F
\$100.01 - \$115.00	G
\$115.01 - \$130.00	H

For additional information on our graded-in fabrics program, please go to [www.nucraft.com](http://www.nucraft.com).



# COM SPECIFICATION

## For COM orders please include the following:

- Name of customer
- Customer's purchase order number
- Model number and quantity of piece(s) to be covered
- Specify right-way or railroad application (railroad is the default if no selection is made)
- If fabric is a stripe or pattern, specify vertical or horizontal application
- Supplier's name, material number and description

## YARDAGE ESTIMATING

All yardages in the price list are based on 54" wide plain (no match) fabric. The following is a guide for fabrics that are less than 54" wide or have a pattern match.

### Fabric Less Than 54" Wide

For 50" wide fabrics allow 10% additional fabric  
For 48" wide fabrics allow 15% additional fabric  
For 45" wide fabrics allow 20% additional fabric  
For 36" wide fabrics allow 50% additional fabric

### For Pattern Match Fabrics

3" to 14" repeat allow 15% additional fabric  
15" to 19" repeat allow 20% additional fabric  
20" to 27" repeat allow 25% additional fabric  
28" to 36" repeat allow 30% additional fabric

Nucraft may add a charge for sewing, cutting and matching unusual COM or COL materials to cover additional costs. Call customer service for pricing.

### It is the sole responsibility of the customer to determine that the fabric is appropriate for the application in which it will be used.

Once COM/COL is accepted, Nucraft assumes no responsibility for its overall appearance, flammability, normal durability, color fastness or any other quality after upholstered on a Nucraft product beyond our normal quality standards.

## FIRE RESISTANCE

Nucraft will only work with textiles that meet the ACT Voluntary Performance Guidelines:

- Nucraft fabric tack panels incorporate fabrics that meet the ASTM E 84 standard US flammability test for wrapped panels.
- Nucraft upholstery fabrics for benches and cushions must meet one or more of the following flammability tests; NFPA 260, NFPA 701, or CAL 117.
- All COM fabrics must meet the required flammability standards per fabric application.
- Nucraft reserves the right to decline any fabrics that do not meet ACT standard flammability requirements.

## COM LEATHER SPECIFICS

The following is a guide for specifying leather requirements. The guide is based on the following general information.

A full "domestic" hide is approximately 50-60 square feet. A specialty or calf hide is approximately 35 square feet. Of this footage there are various non-usable areas included in the hide's size. Conversion of fabric yardage to leather is approximately 1 yard = 18 square feet.

### Bench Requirements

48" benches will require 1/2 domestic hide or 1 full calf hide.

60" benches will require 1 domestic hide or 2 calf hides.

72" benches will require approximately 1 full domestic hide or 3 calf hides.

The boxing around the seat, if required, will have 4-6 seams that will be placed aesthetically based on the yield and usable remains of the hides.