

# CAMBIUM™

## Planning Guide + Price List

---

### QUICK LINKS

[PLANNING GUIDE](#)[CAMBIUM TYPICALS](#)[CAMBIUM PRICING](#)[SMALL MEETING TABLES](#)[POWER AND DATA OPTIONS](#)[GENERAL INFORMATION](#)[FINISH INFORMATION](#)[SURFACE MATERIALS](#)



## TECHNOLOGY ACCOMMODATION

Cambium provides well-planned wire management for each component. Its standard technology accommodation offering meets most needs, and additional, scalable options are available to support even the most technology intensive environments.

### 1 WORK SURFACE GROMMETS.

Grommets can be specified on the work surfaces of desks, credenzas, bridges, and returns. Grommets can be specified in right, left, or center positions of desks, credenzas and returns, and in the center position on bridges.

### 2 J-CHANNEL.

J-Channel provides wire management beneath Cambium worksurfaces.

### 3 CONTINUOUS WIRE PASS THROUGH.

Tackboard extends 3" below the work surface creating a continuous slot for wire management. The pass-through has a larger opening at the ends and extends the entire length of the worksurface, allowing wire management anywhere the user requires it. Wire pass-through requires knee space and is not included when credenza is filled with storage components.

### 4 ACCESS PANELS.

Optional flip-down wire management Access Panel is available on back credenzas, returns, and bridges.

### 5 HEIGHT ADJUSTABLE BASE ENCLOSURE.

Includes a removable hinged access panel with a cutout in the back panel to access electrical or data ports. Base includes vertical wire management column to conceal loose cables.

### 6 Panel Leg with Access Door.

Aligns with adjacent height adjustable wall support. Includes a hinged access panel, wire management cavity, and 10.25"w x 20"h cutout in back panel to access electrical and data ports.

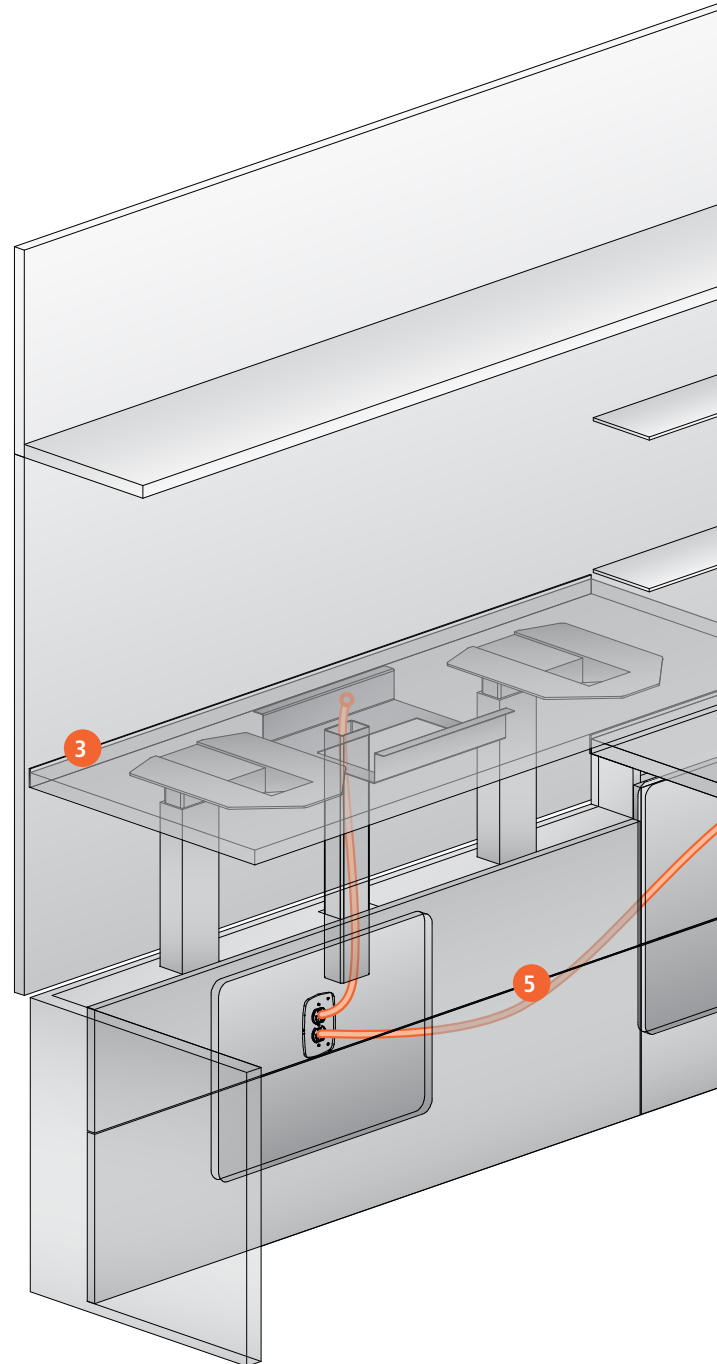

Adjustable Height Work Surface



# TECHNOLOGY ACCOMMODATION

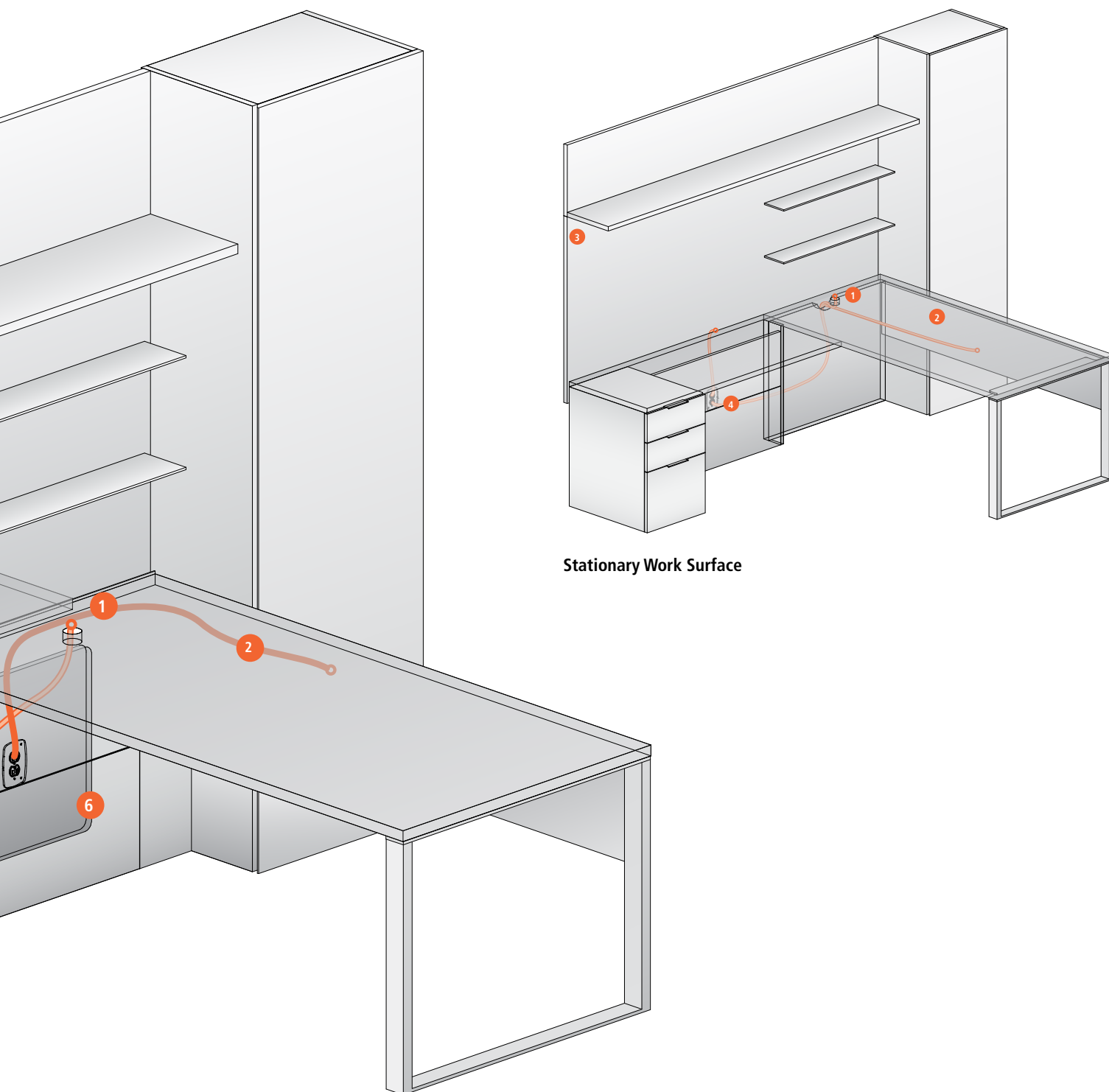



# WIRE MANAGEMENT

## FREESTANDING DESK WITH ADJUSTABLE HEIGHT PANEL BASE

The Freestanding Desk with Adjustable Height Panel Base includes a rectangle work surface, two panel bases, wire management trough and modesty panel.

- Adjustment range from 28" to 46"
- Features a wire management trough with a flexible wire manager
- See page 26 for available sizes and specification requirements

## CONFIGURATIONS

- Model Number CBAFD-3672-V
- Reference Typical CAM-01-FS, page 13

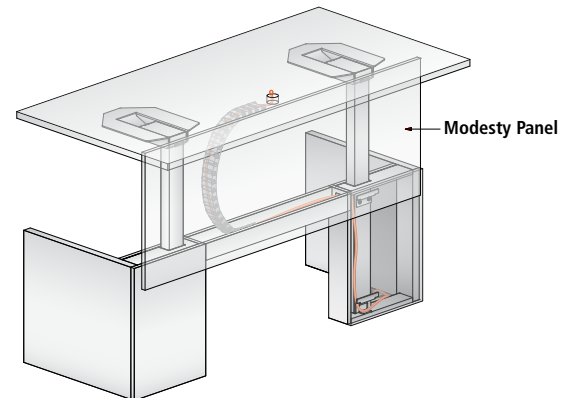

## DIMENSIONS

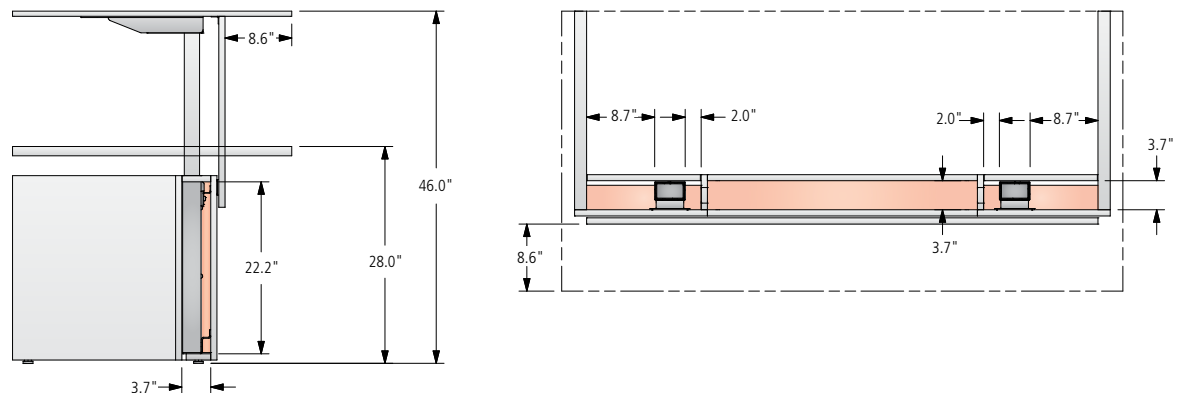

## PROGRAMMABLE CONTROLLER

The programmable controller features up/down buttons, four programmable preset stops, and a digital readout that displays the worksurface height.

## RECOMMENDED ACCESSORIES

- Freestanding Storage Pedestal (page 42)
- Plug Strip (page 43)
- Storage Drawer (page 43)

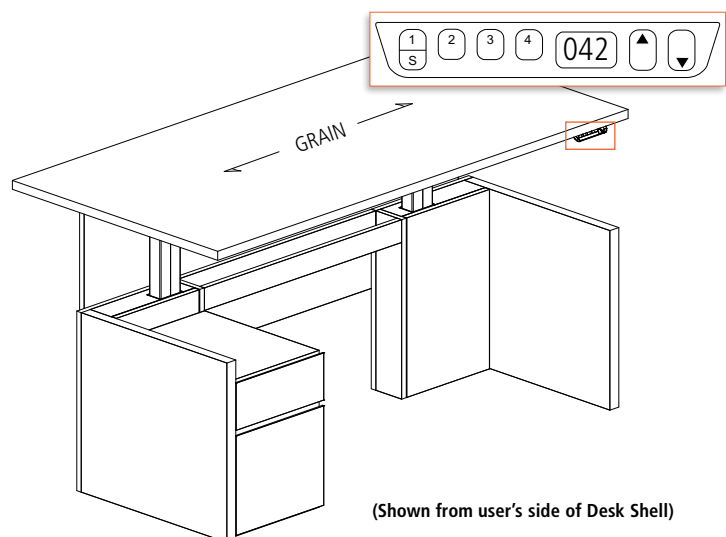



# WIRE MANAGEMENT

## RUN-OFF DESK WITH ADJUSTABLE HEIGHT PANEL BASE

The Run-Off Desk with Height Adjustable Panel Base includes a rectangle work surface, two panel bases, wire management trough and modesty panel.

- Adjustment range from 28" to 46"
- Features a wire management trough with a flexible wire manager
- See page 26 for available sizes and specification requirements

## CONFIGURATIONS

- Model Number CBARO-3672-V
- Reference Typical CAM-03-L and CAM-04-T, page 14

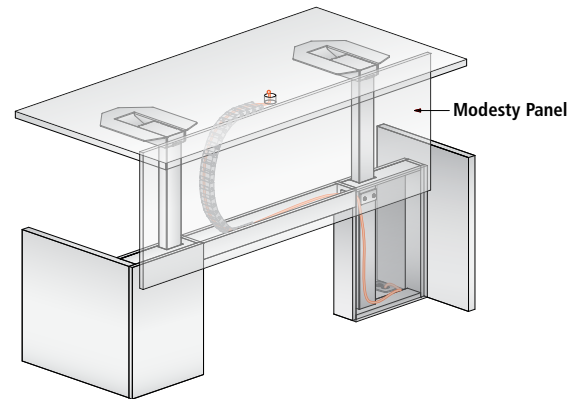

## DIMENSIONS

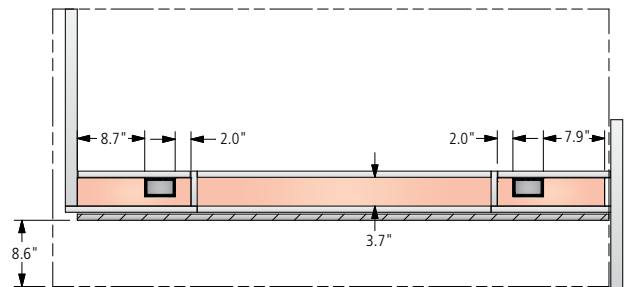
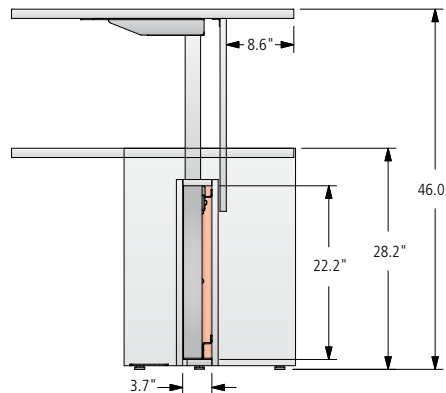

## PROGRAMMABLE CONTROLLER

The programmable controller features up/down buttons, four programmable preset stops, and a digital readout that displays the worksurface height.

## RECOMMENDED ACCESSORIES

- Freestanding Storage Pedestal (page 42)
- Plug Strip (page 43)
- Storage Drawer (page 43)

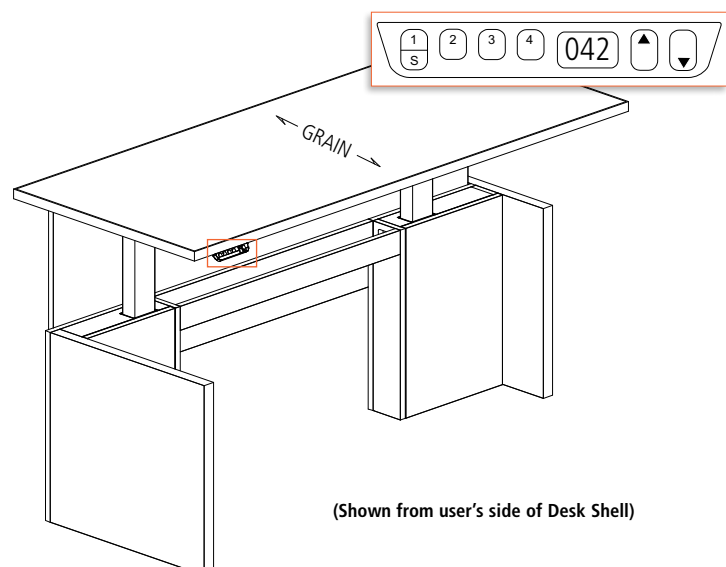

PLEASE NOTE: The grain direction of wood grain laminate runs opposite of image above. Grain direction for laminate always runs the length of the work surface.



# WIRE MANAGEMENT

## FREESTANDING DESK AND RUN-OFF DESK WITH ADJUSTABLE HEIGHT T-LEG BASE

The Freestanding Desk and Run-Off Desk with Adjustable Height T-Leg Base includes a rectangle work surface with a metal column base and modesty panel.

- Adjustment range from 28" to 46"
- See page 28 for available sizes and specification requirements

## CONFIGURATIONS

- Model Number CBAR-3072-V
- Reference Typical CAM-02-L, page 13

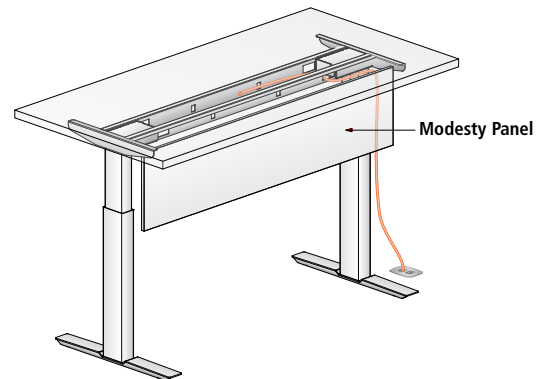

## DIMENSIONS

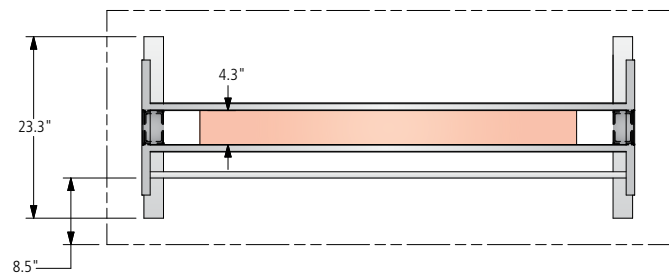
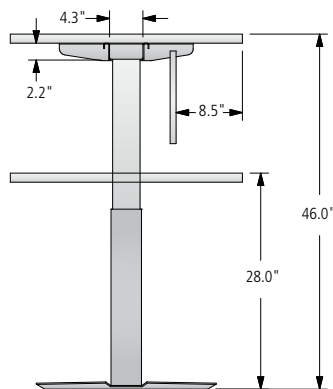

## PROGRAMMABLE CONTROLLER

The programmable controller features up/down buttons, four programmable preset stops, and a digital readout that displays the worksurface height.

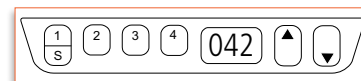

## RECOMMENDED ACCESSORIES

- Freestanding Storage Pedestal (page 42)
- Plug Strip (page 43)
- Storage Drawer (page 43)

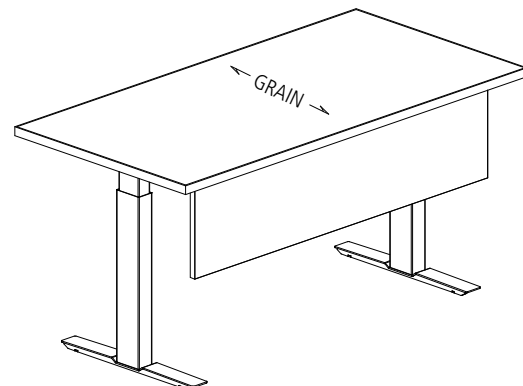

PLEASE NOTE: The grain direction of wood grain laminate runs opposite of image above. Grain direction for laminate always runs the length of the work surface.



# WIRE MANAGEMENT

## BRIDGE, RETURN AND RUN-OFF CREDENZA WITH ADJUSTABLE HEIGHT WALL SUPPORT AND ACCESS PANEL

The Bridge, Return and Run-Off Credenza with Adjustable Height Wall Support and Access Panel includes a metal column base .

- Adjustment range from 28" to 46"
- Controller features digital height readout and four programmable stops
- See page 30 for available sizes and specification requirements

### CONFIGURATIONS

#### Bridge

- Model Number CBA-W-2472-V
- Wall support, must specify supports at each end
- Reference Typicals CAM-05-FS, CAM-07-U, CAM-08-U, pages 15-16

#### Return or Run-Off Credenza

- Model Number CBA-P-2472-L-V
- End panel included, must specify single support
- Reference Typical CAM-06-L page 15

#### Freestanding Credenza

- Model Number CBA-PP-2472
- Includes two end panel supports, freestanding unit

Bridge

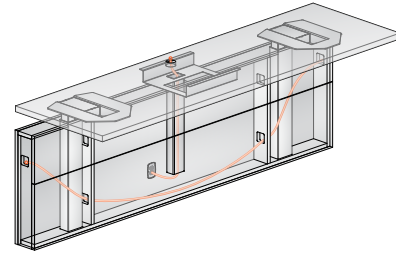

Return or Run-Off Credenza

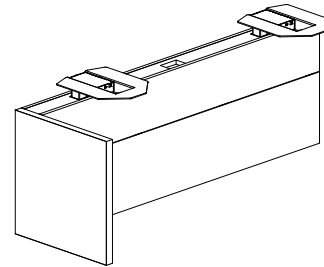

Freestanding Credenza

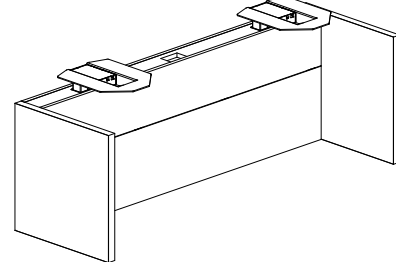

### DIMENSIONS

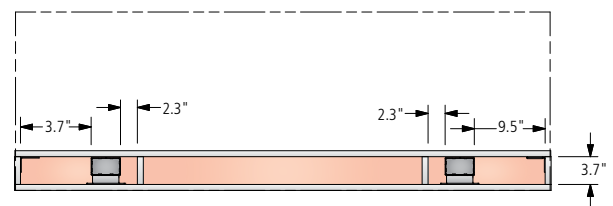
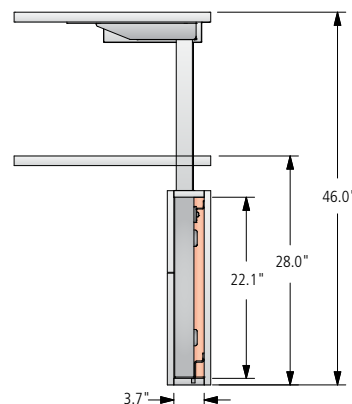

### PROGRAMMABLE CONTROLLER

The programmable controller features up/down buttons, four programmable preset stops, and a digital readout that displays the worksurface height.





# FREESTANDING POWER OPTION: TECH ZONE

## TECH ZONE

Simple, easy to use and portable, this freestanding table top power option allows you to easily charge all of your devices.

Available in two configurations with a variety of power and data connectivity options. Includes a 72"-long plug-in infeed cord.

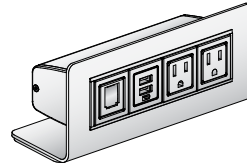

Tech Zone - Side View

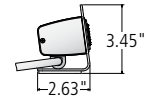

## ZONE-USB-C

Includes two simplex receptacles, one data port and one charging USB-A+C charging port

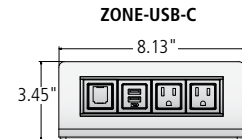

## ZONE-DATA

Includes two simplex receptacles and two open data ports

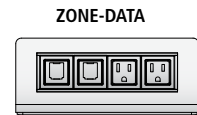





# TABLE TOP POWER OPTIONS

## GROMMET

- Grommet is 2" diameter
- Available in Powder coat, Clear Anodized and Polished
- Height adjustable Bridges, Returns, and Credenzas are available with center grommet location only
- Grommets are included as an option within each work surface
- Grommets may not be placed directly over the end panel of a support pedestal below
- Only one Grommet or Spec may be specified per work surface
- Grommet may not be specified in conjunction with Power Blotter

### Freestanding, Single Pedestal and Run-Off Desk

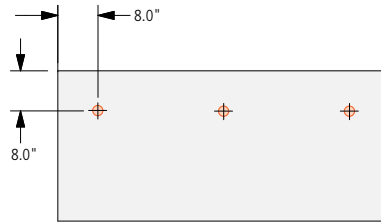

### Height Adjustable Desk

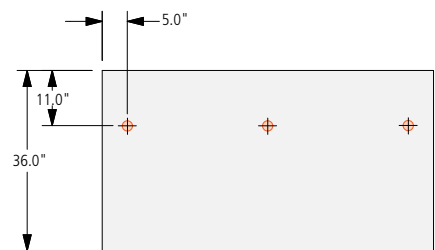
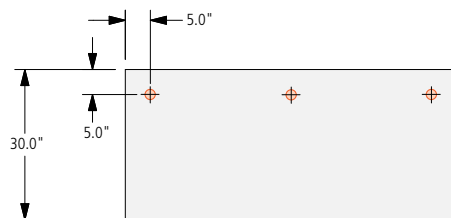

## POWER SPEC AND USB SPEC

This compact unit allows for the addition of power or data to a work surface in a discreet way. Available in round or square shapes, and multiple finish options.

- Power or USB Spec is a work surface accessory, specified in addition to the work surface.
- Only one Grommet or Spec may be specified per work surface
- Power or USB Spec may not be placed directly over the end panel of a support pedestal below
- Power or USB Spec may not be specified in conjunction with Power Blotter

### Run-Off Return / Credenza

(Work surfaces 42"-wide to 54"-wide have only one center grommet)

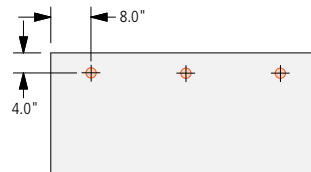

### Bridge



## Power Spec

- Spill-proof power simplex
- Compact design
- 1-3/4" cutout for installation
- UL Listed

### Power Spec

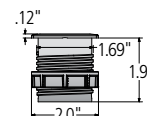

## USB Spec

- Used to charge devices or transfer data
- Compact design
- Offered with USB-A+C
- 1-3/4" cutout
- UL Listed

### USB Spec

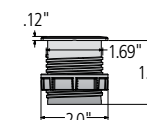

# SHALLOW-DEPTH TOWERS (ALIGNING WITH OVERHEAD)

## Single Door Wardrobe Tower:

- Hatshelf above wardrobe bar is fixed
- Wardrobe bar runs front to back behind valance
- Optional mirror does not ship installed

## Double Door Storage Tower:

- Lock option includes two locks, one per door, 35" High
- 70"h includes one fixed shelf, three adjustable shelves and can accept one additional set of adjustable shelves
- 84"h includes one fixed shelf, four adjustable shelves and can accept one additional set of adjustable shelves
- Side panels of tower are pre bored with 12 locations for optional shelf placement above and below the fixed shelf
- Optional mirror does not ship installed

## 70" and 84" Shallow-Depth Towers

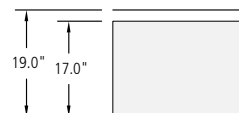

### 70" Single Door Wardrobe Tower

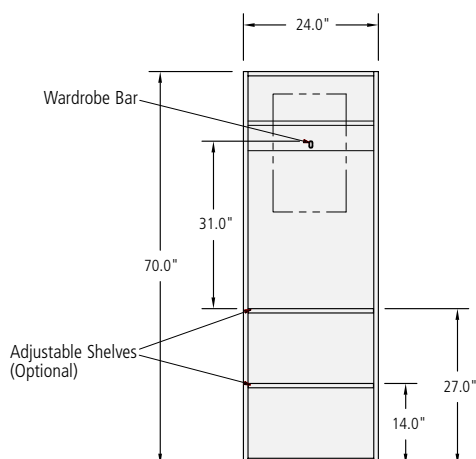

### 70" Double Door Storage Tower

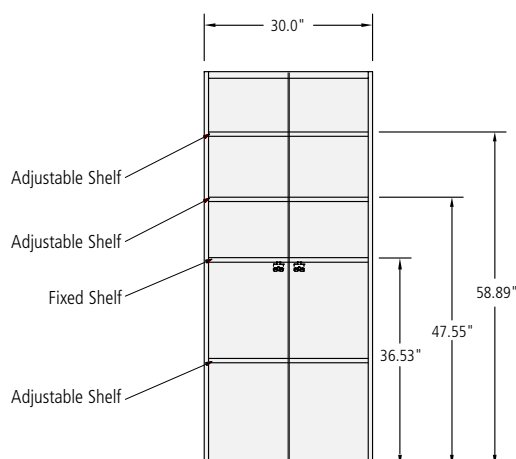

### 84" Single Door Wardrobe Tower

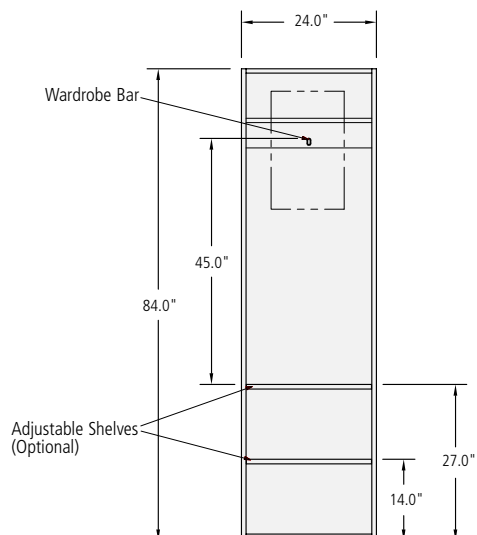

### 84" Double Door Storage Tower

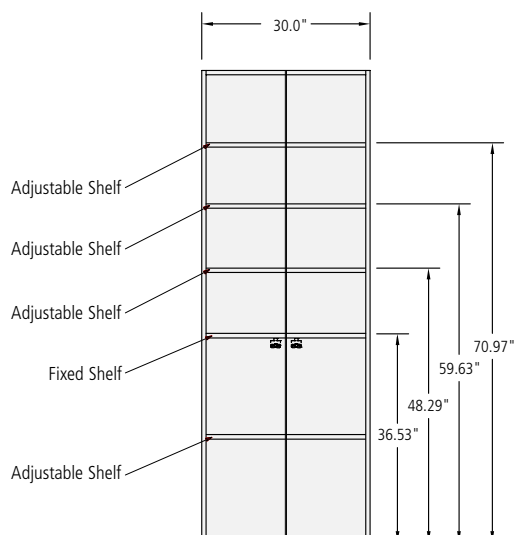

# FULL-DEPTH TOWERS (ALIGNING WITH WORK SURFACE DEPTH)

- Double Door Tower is field reversible
- Double Door Towers include 3 adjustable shelves
- Optional mirror does not ship installed
- Hatshelf above wardrobe bar is fixed
- Double Door Lock option includes two locks, one per door, 35" High

## 70" and 84" Full-Depth Towers

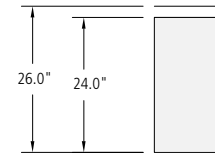

### 70" Single Door Tower

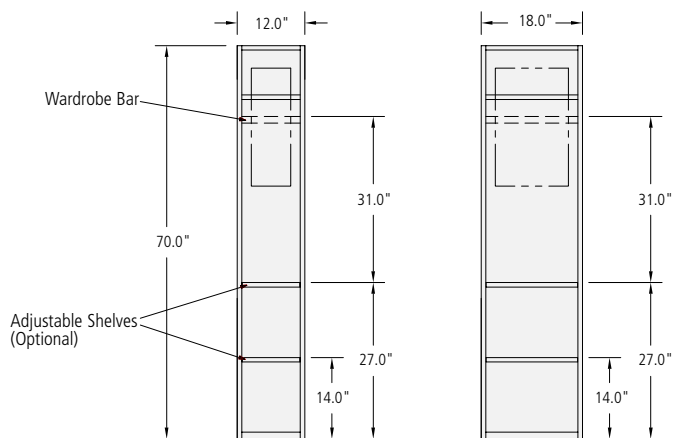

### 70" Double Door Tower

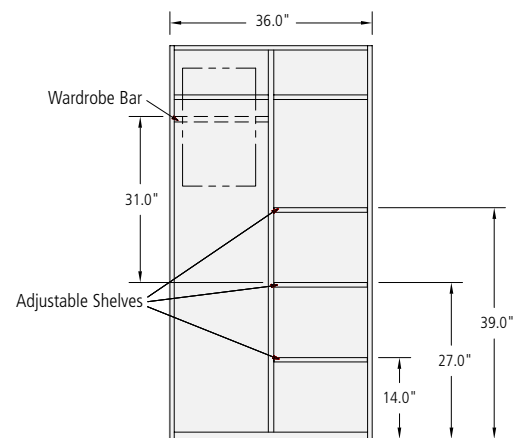

### 84" Single Door Tower

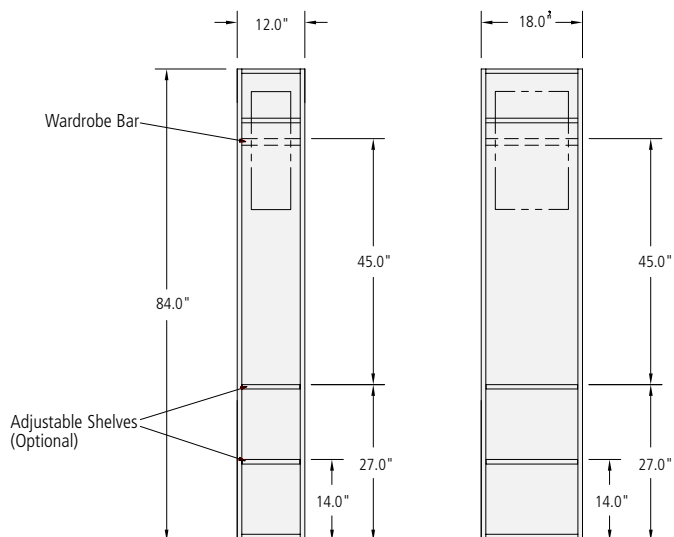

### 84" Double Door Tower

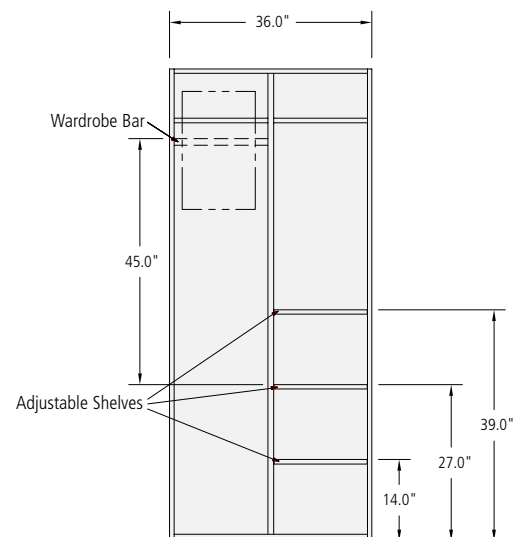



# CAMBIUM™ TYPICALS

---

# ADJUSTABLE HEIGHT PRIMARY WORK SURFACE

Cambium offers the flexibility to specify the primary work surface (desk) as height adjustable in multiple configurations.

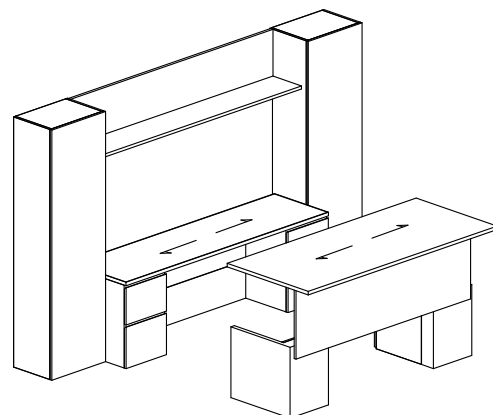
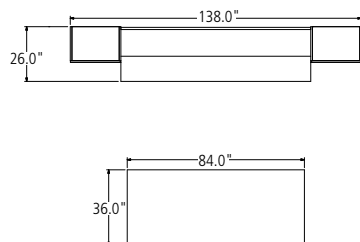

## TYPICAL CAM-01-FS // FREESTANDING STATION

| COMPONENT                                | MODEL #           | DIMENSIONS       | DESCRIPTION  | PRICE  |
|--|-------------------|------------------|--|--------|
| Work surface Height Adj. Panel Leg- Desk | CBAFD-3684-V      | 36 x 84          | Veneer Work surface, Panels w/ Lift Mechanism, and Modesty | 12,099 |
| Freestanding Pedestal                    | CBFP-BF-1521-V    | 15.5 x 21x 22    | Freestanding Box File Pedestal                             | 2,898  |
| Tower                                    | CBTW-24S-1784-L-V | 24 x 17.5 x 84.5 | Veneer Wardrobe Tower                                      | 5,534  |
| Option: Shelves                          | -SH2              |                  | Optional: Additional Storage Shelves (2)                   | 513    |
| Work surface - Credenza                  | CBC-2490-V        | 24 x 90          | Veneer Work surface  | 3,096  |
| Work surface Support - Credenza          | CBPS-FF-1824-V    | 18 x 24          | Veneer File/ File Storage Pedestal                         | 2,935  |
| Access Panel - Credenza                  | CBAP-1S-V         |                  | Veneer Access Panel to Span Opening 49-66"                 | 1,279  |
| Work surface Support - Credenza          | CBPS-BBF-1824-V   | 18 x 24          | Veneer Box/ Box / File Storage Pedestal                    | 2,935  |
| Overhead                                 | CBWW-9070-S       | 90 x 13          | Single Wood Shelf w/ Painted Back Panel                    | 3,716  |
| Back Panel                               | CBMG-4390         | 90 x 43          | Magnetic Glass Back Panel w/ Magnets                       | 4,434  |
| Tower                                    | CBTW-24S-1784-R-V | 24 x 17.5 x 84.5 | Veneer Wardrobe Tower                                      | 5,534  |
| Option: Tower                            | -MR               |                  | Optional: Mirror   | 349    |

Private Office List Price: \$45,322

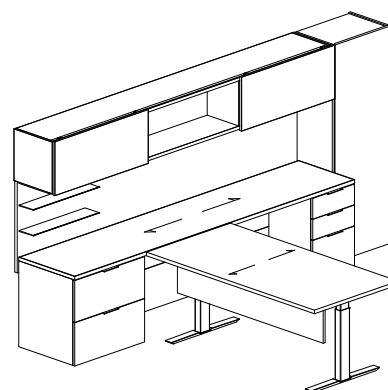
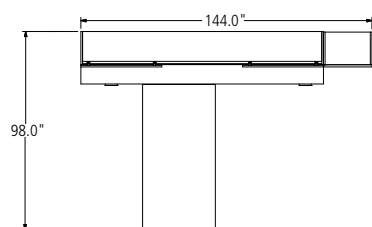

## TYPICAL CAM-02-L // LEFT-HAND STATION

| COMPONENT                             | MODEL #               | DIMENSIONS     | DESCRIPTION                                    | PRICE  |
|---------------------------------------|-----------------------|----------------|--|--------|
| Side Credenza                         | CBC-24120-V           | 24 x 120       | Veneer Work surface                            | 3,974  |
| Work surface Support - Side Credenza  | CBPS-LF-3024-V        | 30 x 24        | Lateral File Storage Pedestal                  | 3,239  |
| Access Panel - Side Credenza          | CBAP-2S-V             |                | Veneer Access Panel to Span Opening 67-84"     | 1,408  |
| Work surface Support - Side Credenza  | CBPS-BBF-1824-V       | 18 x 24        | Veneer Box/ Box / File Storage Pedestal        | 2,935  |
| Work surface Height Adj. T-Leg - Desk | CBAR-3672-V           | 36 x 72        | Veneer Work surface w/ Height Adj. Metal T Leg | 6,334  |
| Option: Modesty                       | -MPWH                 |                | Half Height Veneer Modesty Panel               | 1,231  |
| Overhead                              | CBOW-2S-120S-VS       | 120 x 17.25    | Single High Overhead w/ 2 Sliding Doors        | 10,258 |
| Back Panel                            | CBPD-29120-L-S-30-MDS | 120 x 29       | Veneer Back Panel w/ Metal Display Shelves     | 3,489  |
| Tower                                 | CBTW-24S-1770-R-V     | 24 x 17.5 x 70 | Veneer Wardrobe Tower                          | 5,291  |
| Option: Shelves                       | -SH2                  |                | Optional: Additional Storage Shelves (2)       | 513    |

Private Office List Price: \$38,672



# ADJUSTABLE HEIGHT PRIMARY WORK SURFACE

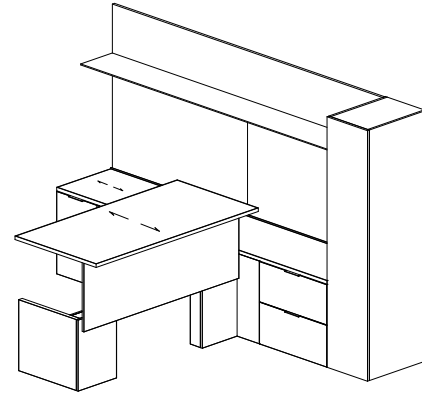
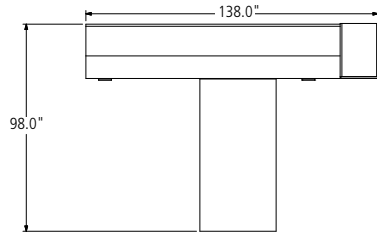

## TYPICAL CAM-04-T // RIGHT-HAND STATION

| COMPONENT                                | MODEL #          | DIMENSIONS     | DESCRIPTION  | PRICE  |
|--|------------------|----------------|--|--------|
| Side Credenza                            | CBC-24120-V      | 24 x 120       | Veneer Work surface  | 3,974  |
| Work surface Support - Side Credenza     | CBPS-FF-1824-V   | 18 x 24        | Veneer File / File Storage Pedestal                        | 2,935  |
| Access Panel- Side Credenza              | CBAP-2S-V        |                | Veneer Access Panel to Span Opening 67-84"                 | 1,408  |
| Work surface Support - Side Credenza     | CBPS-LF-3024-V   | 30 x 24        | Veneer Lateral File Storage Pedestal                       | 3,239  |
| Work surface Height Adj Panel Leg - Desk | CBARO-3672-R-V   | 36 x 72        | Veneer Work surface, Panels w/ Lift Mechanism, and Modesty | 11,623 |
| Overhead                                 | CBMM-12070-V     | 120 x 13       | Single Metal Shelf w/ Veneer Back Panel                    | 4,642  |
| Back Panel                               | CBTF-43120-COM   | 120 x 43       | Fabric Tackboard -COM                                      | 1,143  |
| Tower                                    | CBTW-18-2684-R-V | 18 x 26 x 84.5 | Veneer Wardrobe Tower                                      | 5,502  |

Private Office List Price: \$34,466

# ADJUSTABLE HEIGHT SECONDARY WORK SURFACE

Cambium offers the flexibility to specify the secondary work surfaces (bridge, return or credenza) as height adjustable in multiple configurations.

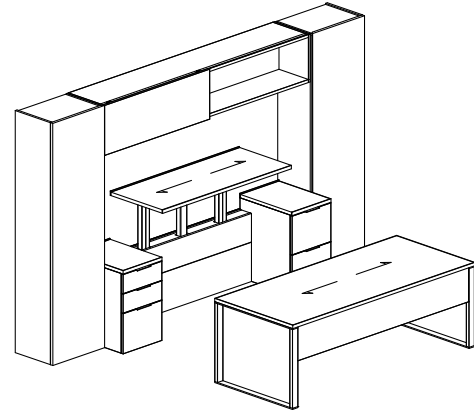
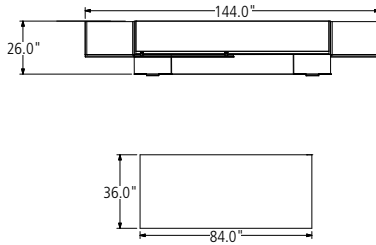

## TYPICAL CAM-05-FS // FREESTANDING STATION

| COMPONENT                       | MODEL #           | DIMENSIONS       | DESCRIPTION                                 | PRICE |
|---------------------------------|-------------------|------------------|---|-------|
| Work surface - Desk             | CBSD-3684-V       | 36 x 84          | Veneer Work surface                         | 4,015 |
| Work surface Support - Desk     | CBHL-36-R         | 2.5 x 36         | Metal Hoop Leg                              | 1,255 |
| Option: Work surface Support    | -PCHL             |                  | Polished Chrome                             | 1,276 |
| Work surface Support - Desk     | CBHL-36-L         | 2.5 x 36         | Metal Hoop Leg                              | 1,255 |
| Option: Work surface Support    | -PCHL             |                  | Polished Chrome                             | 1,276 |
| Option: Modesty                 | -MPWH             |                  | Half Height Veneer Modesty Panel            | 1,231 |
| Tower                           | CBTW-245-1784-L-V | 24 x 17.5 x 84.5 | Veneer Wardrobe Tower                       | 5,534 |
| Freestanding Credenza           | CBC-2496-V        | 24 x 96          | Veneer Work surface                         | 3,278 |
| Option: Credenza                | PSL-PSPC          | 24 x 96          | Optional: Polished Chrome Pencil Stop       | 270   |
| Work surface Support - Credenza | CBPS-BBF-1824-V   | 18 x 24          | Veneer Box / Box / File Storage Pedestal    | 2,935 |
| Work surface Support - Credenza | CBA-P-60-L-V      | 60 x 5           | Work surface Support Wall w/ Lift Mechanism | 7,133 |
| Work surface Support - Credenza | CBPS-FF-1824-V    | 18 x 24          | Veneer File / File Storage Pedestal         | 2,935 |
| Overhead                        | CBOW-15-96S-V     | 96 x 17.25       | Single High Overhead w/ 1 Sliding Door      | 8,893 |
| Back Panel                      | CBMG-4396         | 96 x 43          | Magnetic Glass Panel                        | 4,620 |
| Tower                           | CBTW-245-1784-R-V | 24 x 17.5 x 84.5 | Veneer Wardrobe Tower                       | 5,534 |

Private Office List Price: \$51,440

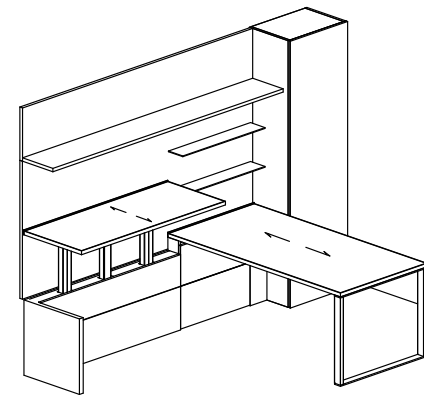
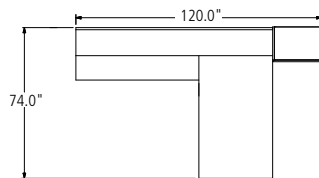

## TYPICAL CAM-06-L // RIGHT-HAND STATION

| COMPONENT                     | MODEL #            | DIMENSIONS       | DESCRIPTION                                 | PRICE |
|-------------------------------|--------------------|------------------|---|-------|
| Work Surface - Run-Off        | CBBR-2460-V        | 60 x 24          | Veneer Work surface                         | 2,146 |
| Option: Pencil Stop           | -PSL               |                  | Optional: Powder Coat Metal Pencil Stop     | 172   |
| Work Surface Support - Return | CBA-P-60-L         | 60 x 5           | Work surface Support Wall w/ Lift Mechanism | 7,133 |
| Desk Work surface             | CBSD-3672-V        | 36 x 72          | Veneer Work surface                         | 3,522 |
| Option: Pencil Stop           | -PSD               | 36 x 72          | Optional: Powder Coat Metal Pencil Stop     | 172   |
| Work Surface Support - Desk   | CBPLH-36-L-V       | 1.5 x 36         | Veneer Panel Leg Adjacent Adjustable Height | 2,158 |
| Work Surface Support - Desk   | CBHL-36-V          | 2.5 x 36         | Metal Hoop Leg (Powdercoat)                 | 1,255 |
| Option: Modesty               | -MPWH              |                  | Half Height Veneer Modesty Panel            | 1,231 |
| Overhead                      | CBWW-9670-V        | 96 x 13          | Single Wood Shelf w/ Veneer Back Panel      | 4,065 |
| Back Panel                    | CBPD-4396-V-36-GDS | 96 x 43          | Veneer Back Panel w/ Glass Display Shelves  | 4,620 |
| Tower                         | CBTW-245-1784-R-V  | 24 x 17.5 x 84.5 | Veneer Wardrobe Tower                       | 5,534 |
| Option: Shelves               | -SH2               |                  | Optional: Additional Storage Shelves (2)    | 513   |

Private Office List Price: \$32,521



# ADJUSTABLE HEIGHT SECONDARY WORK SURFACE

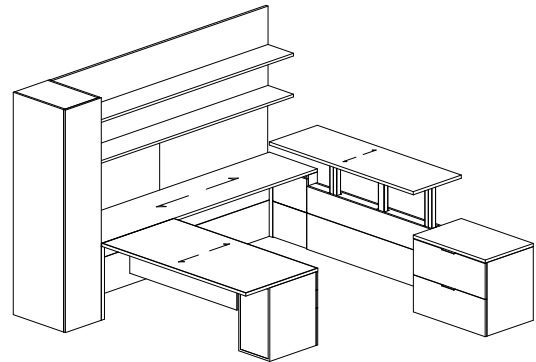
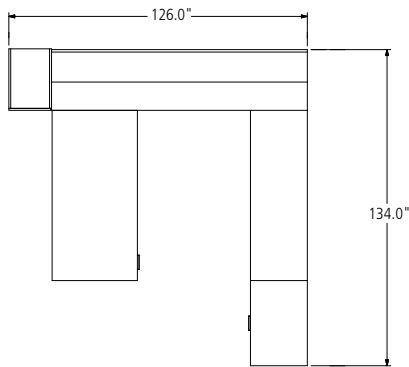

**TYPICAL CAM-07-U // LEFT-HAND STATION**

| COMPONENT                            | MODEL #          | DIMENSIONS     | DESCRIPTION                                  | PRICE |
|--------------------------------------|------------------|----------------|--|-------|
| Tower                                | CBTW-18-2684-L-V | 18 x 26 x 84.5 | Veneer Wardrobe Tower                        | 5,502 |
| Desk Work Surface                    | CBRO-3672-V      | 36 x 72        | Veneer Work surface                          | 3,521 |
| Work Surface Support - Desk          | CBPS-BBF-1530-V  | 15.5 x 30      | Veneer Box / Box/ File Storage Pedestal      | 2,920 |
| Option: Modesty                      | -MPWH            |                | Half Height Veneer Modesty Panel             | 1,231 |
| Side Credenza                        | CBC-24108-V      | 24 x 108       | Veneer Work surface                          | 3,628 |
| Work Surface Support - Side Credenza | CBPLK-24-V       | 1.5 x 24       | Veneer Panel Support                         | 1,154 |
| Access Panel                         | CBAP-4S-V        |                | Veneer Access Panel to Span Opening 103-120" | 1,704 |
| Work Surface Support - Side Credenza | CBPLH-24-V       | 5 x 24         | Veneer Panel Support w/ Hinged Door          | 1,638 |
| Run-Off Work Surface                 | CBBR-24108-V     | 108 x 24       | Veneer Work surface                          | 3,628 |
| Work Surface Support - Run-Off       | CBA-W-72-R-V     | 72 x 5         | Work surface Support Wall w/ Lift Mechanism  | 7,271 |
| Work Surface Support - Run-Off       | CBPS-LF-3624-V   | 36 x 24        | Veneer LateralFile Storage Pedestal          | 3,560 |
| Overhead                             | CBWW-10884-V     | 108 x 13       | Double Wood Shelf w/ Veneer Back Panel       | 5,528 |
| Back Panel                           | CBTF-29108-COM   | 108 x 29       | Fabric Tackboard -COM                        | 1,050 |

**Private Office List Price: \$42,335**

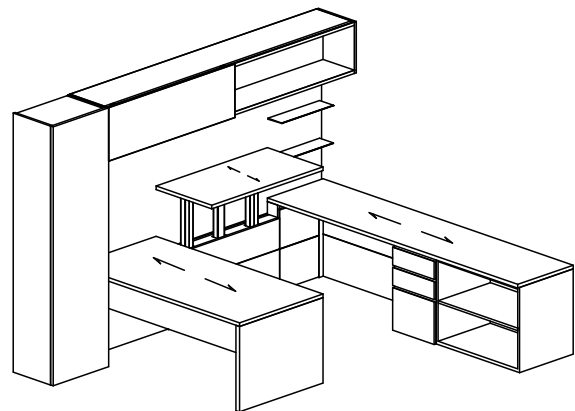
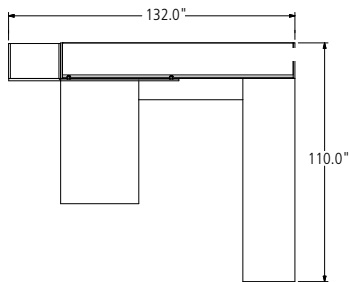

**TYPICAL CAM-08-U // LEFT-HAND STATION**

| COMPONENT                                | MODEL #             | DIMENSIONS       | DESCRIPTION                                 | PRICE |
|--|---------------------|------------------|---|-------|
| Tower                                    | CBTW-24S-1784-L-V   | 24 x 17.5 x 84.5 | Veneer Wardrobe Tower                       | 5,534 |
| Desk Work Surface                        | CBSD-3672-V         | 36 x 72          | Veneer Work surface                         | 3,522 |
| Work Surface Support - Desk              | CBPL-36-V           | 1.5 x 36         | Work surface Support - Desk                 | 1,421 |
| Option: Modesty                          | -MPWH               |                  | Half Height Veneer Modesty Panel            | 1,231 |
| Work Surface Support - Desk              | CBPL-36-V           | 1.5 x 36         | Veneer Panel Leg                            | 1,421 |
| Work Surface - Bridge                    | CBBR-2448-V         | 48 x 24          | Veneer Work surface                         | 1,690 |
| Adj Height Work Surface Support - Bridge | CBA-W-48-V          | 48 x 5           | Work surface Support Wall w/ Lift Mechanism | 5,845 |
| Work Surface Support - Side Credenza     | CBPLH-24-V          | 5 x 24           | Veneer Panel Support w/ Hinged Door         | 1,638 |
| Work Surface - Credenza                  | CBC-24108-V         | 108 x 24         | Veneer Work surface                         | 3,628 |
| Access Panel                             | CBAP-1S-V           |                  | Veneer Access Panel to Span Opening 49-66"  | 1,279 |
| Work Surface Support - Run-Off Credenza  | CBPS-BBF-1824-V     | 18 x 24          | Veneer Box/ Box/ File Storage Pedestal      | 2,935 |
| Work Surface Support - Run-Off Credenza  | CBPS-LF-3624-V      | 36 x 24          | Veneer LateralFile Storage Pedestal         | 3,560 |
| Overhead                                 | CBOW-1S-108S-V      | 108 x 17.25      | Single High Overhead w/ 1 Sliding Door      | 9,575 |
| Back Panel                               | CBPD-43108-V-24-MDS | 108 x 43         | Veneer Back Panel w/ Metal Display Shelves  | 5,013 |

**Private Office List Price: \$48,292**





# STATIONARY WORK SURFACE

Cambium is also available in a more conventional layout with a non-height adjustable work surface in multiple configurations to support all work styles and flow.

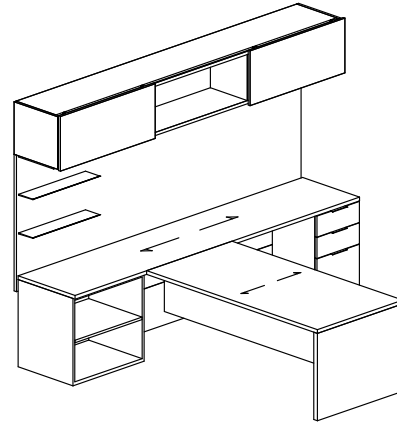
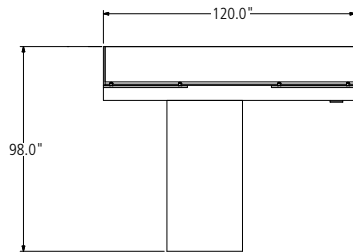

**TYPICAL CAM-09-T // LEFT-HAND STATION**

| COMPONENT                            | MODEL #             | DIMENSIONS  | DESCRIPTION                                | PRICE  |
|--------------------------------------|---------------------|-------------|--|--------|
| Side Credenza                        | CBC-24120-V         | 24 x 120    | Veneer Work surface                        | 3,974  |
| Work Surface Support - Side Credenza | CBPS-OS-3024-V      | 30 x 24     | Veneer Open Shelf Storage Pedestal         | 2,845  |
| Access Panel                         | CBAP-25-V           |             | Access Panel for openings 67"-84"          | 1,408  |
| Work Surface Support - Side Credenza | CBPS-BBF-1824-V     | 18 x 24     | Veneer Box/ Box/ File Storage Pedestal     | 2,935  |
| Desk Work surface                    | CBRO-3672-V         | 36 x 72     | Veneer Work surface                        | 3,521  |
| Work Surface Support - Desk          | CBPL-36-V           | 1.5 x 36    | Veneer Panel Support                       | 1,421  |
| Option: Modesty                      | -MPWH               |             | Half Height Veneer Modesty Panel           | 1,231  |
| Overhead                             | CBOW-25-120S-V      | 120 x 17.25 | Single High Overhead w/ 2 Sliding Doors    | 10,258 |
| Back Panel                           | CBPD-43120-V-30-MDS | 120 x 43    | Veneer Back Panel w/ Metal Display Shelves | 5,437  |

**Private Office List Price: \$33,030**

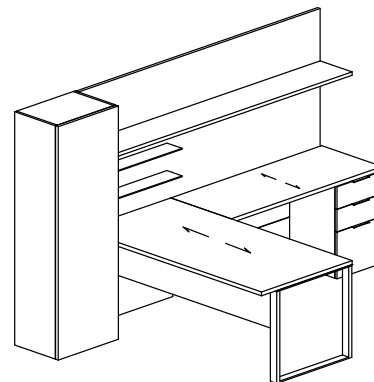
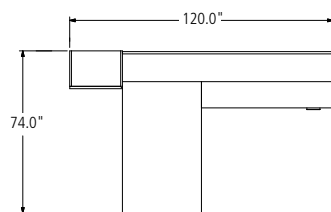

**TYPICAL CAM-10-L // LEFT-HAND STATION**

| COMPONENT                            | MODEL #            | DIMENSIONS     | DESCRIPTION                                | PRICE |
|--------------------------------------|--------------------|----------------|--|-------|
| Tower                                | CBTW-24S-1770-L-V  | 24 x 17.5 x 70 | Veneer Wardrobe Tower                      | 5,291 |
| Desk Work Surface                    | CBSD-3672-V        | 36 x 72        | Veneer Work surface                        | 3,522 |
| Work Surface Support - Desk          | CBHL-30            | 2.5 x 30       | Metal Hoop Leg (Powdercoat)                | 1,116 |
| Option: Modesty                      | -MPWH              |                | Half Height Veneer Modesty Panel           | 1,231 |
| Work Surface Support - Desk          | CBPLK-36-V         | 1.5 x 36       | Veneer Panel Leg                           | 1,333 |
| Work Surface - Run-Off               | CBBR-2460-V        | 60 x 24        | Veneer Work surface                        | 2,146 |
| Access Panel                         | CBAP-OS-V          |                | Veneer Access Panel to Span Opening 12-48" | 1,149 |
| Work Surface Support - Side Credenza | CBPS-BBF-1824-V    | 18 x 24        | Veneer Box/ Box/ File Storage Pedestal     | 2,935 |
| Overhead                             | CBWW-9670-V        | 96 x 13        | Single Wood Shelf w/ Veneer Back Panel     | 4,065 |
| Back Panel                           | CBPD-2996-V-36-GDS | 96 x 29        | Veneer Back Panel w/ Glass Display Shelves | 3,121 |

**Private Office List Price: \$25,909**

# STATIONARY WORK SURFACE

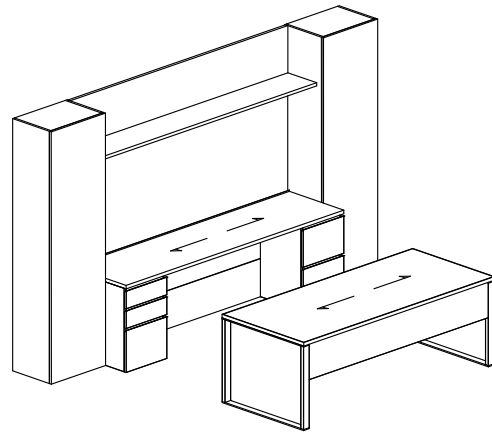
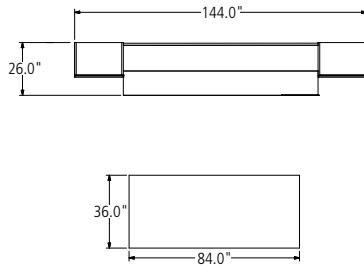

## TYPICAL CAM-11-FS // FREESTANDING STATION

| COMPONENT                       | MODEL #           | DIMENSIONS       | DESCRIPTION                                | PRICE |
|---------------------------------|-------------------|------------------|--|-------|
| Work Surface- Desk              | CBSD-3684-V       | 36 x 84          | Veneer Work surface                        | 4,015 |
| Work Surface Support - Desk     | CBHL-36           | 2.5 x 36         | Metal Hoop Leg                             | 1,255 |
| Option: Hoop Leg                | -PCHL             |                  | Polished Chrome Hoop Leg                   | 1,276 |
| Work Surface Support - Desk     | CBHL-36           | 2.5 x 36         | Metal Hoop Leg                             | 1,255 |
| Option: Hoop Leg                | -PCHL             |                  | Polished Chrome Hoop Leg                   | 1,276 |
| Option: Modesty                 | -MPWH             |                  | Half Height Veneer Modesty Panel           | 1,231 |
| Tower                           | CBTW-24S-1784-L-V | 24 x 17.5 x 84.5 | Veneer Wardrobe Tower                      | 5,534 |
| Freestanding Credenza           | CBC-2496-V        | 24 x 96          | Veneer Work surface                        | 3,278 |
| Work Surface Support - Credenza | CBPS-BBF-1824-V   | 18 x 24          | Veneer Box / Box/ File Storage Pedestal    | 2,935 |
| Access Panel                    | CBAP-1S-V         |                  | Veneer Access Panel to Span Opening 49-66" | 1,279 |
| Work Surface Support - Credenza | CBPS-FF-1824-V    | 18 x 24          | Veneer File / File Storage Pedestal        | 2,935 |
| Overhead                        | CBWW-9670-V       | 96 x 13          | Single Wood Shelf w/ Veneer Back Panel     | 4,065 |
| Back Panel                      | CBTF-4396-COM     | 96 x 43          | Fabric Tack Panel- COM                     | 1,009 |
| Tower                           | CBTW-24S-1784-R-V | 24 x 17.5 x 84.5 | Veneer Wardrobe Tower                      | 5,534 |
| Back Panel                      | CBTF-29108-COM    | 108 x 29         | Fabric Tackboard -COM                      | 1,050 |

Private Office List Price: \$37,927

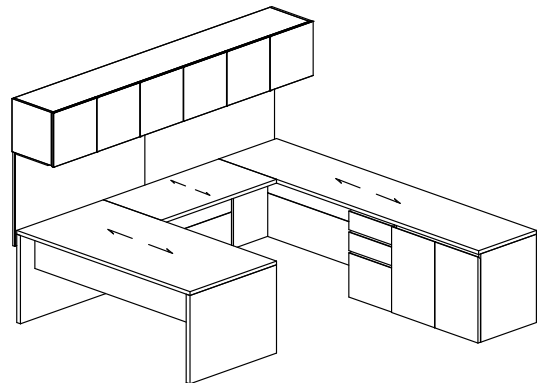
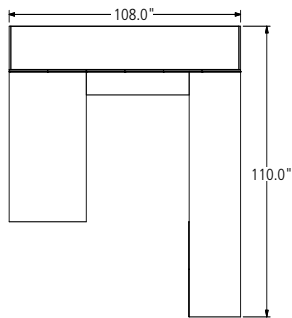

## TYPICAL CAM-12-U // LEFT-HAND STATION

| COMPONENT                               | MODEL #         | DIMENSIONS | DESCRIPTION                                | PRICE |
|---|-----------------|------------|--|-------|
| Desk Work Surface                       | CBSD-3672-V     | 36 x 72    | Veneer Work surface                        | 3,522 |
| Work Surface Support - Desk             | CBPL-36-V       | 1.5 x 36   | Veneer Panel Leg                           | 1,421 |
| Option: Modesty                         | -MPWH           |            | Half Height Veneer Modesty Panel           | 1,231 |
| Work Surface Support - Desk             | CBPLK-36-V      | 1.5 x 36   | Veneer Panel Leg                           | 1,333 |
| Work Surface - Bridge                   | CBBR-2448-V     | 48 x 24    | Veneer Work surface                        | 1,690 |
| Access Panel                            | CBAP-0S-V       |            | Veneer Access Panel to Span Opening 12-48" | 1,149 |
| Work Surface - Credenza                 | CBC-24108-V     | 108 x 24   | Veneer Work surface                        | 3,628 |
| Work Surface Support - Side Credenza    | CBPLK-24-V      | 1.5 x 24   | Veneer Panel Leg                           | 1,083 |
| Access Panel                            | CBAP-1S-V       |            | Veneer Access Panel to Span Opening 49-66" | 1,279 |
| Work Surface Support - Run-Off Credenza | CBPS-BBF-1824-V | 18 x 24    | Veneer Box/ Box/ File Storage Pedestal     | 2,935 |
| Work Surface Support - Run-Off Credenza | CBPS-DD-3624-V  | 36 x 24    | Double Door Storage Pedestal               | 3,507 |
| Overhead                                | CBOW-F-108S-V   | 96 x 17.25 | Single High Overhead w/ Full Door          | 7,863 |
| Back Panel                              | CBMG-29108      | 108 x 29   | Magnetic Glass Back Panel w/ Magnets       | 3,385 |

Private Office List Price: \$34,026



# CAMBIUM™ PRICE LIST

---



# WORK SURFACES

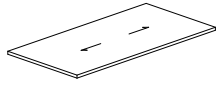

CBSD-3672

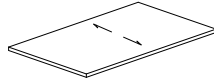

CBRO-3660

## SURFACE MATERIAL KEY

PE Laminate Work surface  
V Veneer Work surface

### DESK // FREESTANDING, SINGLE PEDESTAL DESK (FREESTANDING, L-SHAPE, U-SHAPE)

| MODEL #   | DEPTH | WIDTH | -PE   | -V    |
|-----------|-------|-------|-------|-------|
| CBSD-3060 | 30    | 60    | 2,297 | 2,554 |
| CBSD-3066 | 30    | 66    | 2,500 | 2,778 |
| CBSD-3072 | 30    | 72    | 2,704 | 3,005 |
| CBSD-3078 | 30    | 78    | 2,882 | 3,202 |
| CBSD-3084 | 30    | 84    | 3,088 | 3,431 |
| CBSD-3660 | 36    | 60    | 2,704 | 3,005 |
| CBSD-3666 | 36    | 66    | 2,939 | 3,266 |
| CBSD-3672 | 36    | 72    | 3,170 | 3,522 |
| CBSD-3678 | 36    | 78    | 3,398 | 3,775 |
| CBSD-3684 | 36    | 84    | 3,615 | 4,015 |

### DESK // RUN-OFF DESK (T-SHAPE AND U-SHAPE)

| MODEL #   | DEPTH | WIDTH | -PE   | -V    |
|-----------|-------|-------|-------|-------|
| CBRO-3042 | 30    | 42    | 1,662 | 1,844 |
| CBRO-3048 | 30    | 48    | 1,875 | 2,082 |
| CBRO-3054 | 30    | 54    | 2,088 | 2,318 |
| CBRO-3060 | 30    | 60    | 2,297 | 2,554 |
| CBRO-3066 | 30    | 66    | 2,499 | 2,775 |
| CBRO-3072 | 30    | 72    | 2,704 | 3,005 |
| CBRO-3078 | 30    | 78    | 2,882 | 3,202 |
| CBRO-3084 | 30    | 84    | 3,088 | 3,431 |
| CBRO-3642 | 36    | 42    | 1,960 | 2,176 |
| CBRO-3648 | 36    | 48    | 2,210 | 2,456 |
| CBRO-3654 | 36    | 54    | 2,461 | 2,733 |
| CBRO-3660 | 36    | 60    | 2,702 | 3,003 |
| CBRO-3666 | 36    | 66    | 2,939 | 3,266 |
| CBRO-3672 | 36    | 72    | 3,168 | 3,521 |
| CBRO-3678 | 36    | 78    | 3,398 | 3,775 |
| CBRO-3684 | 36    | 84    | 3,615 | 4,015 |



# WORK SURFACES

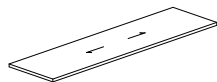

CBC-2490

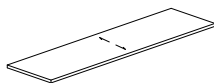

CBBR-2490

## SURFACE MATERIAL KEY

PE Laminate Work surface  
V Veneer Work surface

### CREDENZA/LATERAL FILE TOPS // FREESTANDING, SIDE, BACK CREDENZA

| MODEL #   | DEPTH | WIDTH | -PE   | -V    |
|-----------|-------|-------|-------|-------|
| CBC-2430  | 24    | 30    | 1,203 | 1,336 |
| CBC-2436  | 24    | 36    | 1,316 | 1,463 |
| CBC-2442  | 24    | 42    | 1,426 | 1,584 |
| CBC-2448  | 24    | 48    | 1,522 | 1,690 |
| CBC-2454  | 24    | 54    | 1,637 | 1,815 |
| CBC-2460  | 24    | 60    | 1,929 | 2,146 |
| CBC-2466  | 24    | 66    | 2,109 | 2,339 |
| CBC-2472  | 24    | 72    | 2,281 | 2,534 |
| CBC-2478  | 24    | 78    | 2,453 | 2,726 |
| CBC-2484  | 24    | 84    | 2,623 | 2,912 |
| CBC-2490  | 24    | 90    | 2,788 | 3,096 |
| CBC-2496  | 24    | 96    | 2,949 | 3,278 |
| CBC-24102 | 24    | 102   | 3,110 | 3,453 |
| CBC-24108 | 24    | 108   | 3,270 | 3,628 |
| CBC-24114 | 24    | 114   | 3,418 | 3,798 |
| CBC-24120 | 24    | 120   | 3,577 | 3,974 |

### DESK // FREESTANDING, SINGLE PEDESTAL DESK (FREESTANDING, L-SHAPE, U-SHAPE)

| MODEL #    | DEPTH | WIDTH | -PE   | -V    |
|------------|-------|-------|-------|-------|
| CBBR-2430  | 24    | 30    | 1,203 | 1,336 |
| CBBR-2436  | 24    | 36    | 1,316 | 1,463 |
| CBBR-2442  | 24    | 42    | 1,426 | 1,584 |
| CBBR-2448  | 24    | 48    | 1,522 | 1,690 |
| CBBR-2454  | 24    | 54    | 1,637 | 1,815 |
| CBBR-2460  | 24    | 60    | 1,929 | 2,146 |
| CBBR-2466  | 24    | 66    | 2,109 | 2,339 |
| CBBR-2472  | 24    | 72    | 2,281 | 2,534 |
| CBBR-2478  | 24    | 78    | 2,453 | 2,726 |
| CBBR-2484  | 24    | 84    | 2,623 | 2,912 |
| CBBR-2490  | 24    | 90    | 2,788 | 3,096 |
| CBBR-2496  | 24    | 96    | 2,949 | 3,278 |
| CBBR-24102 | 24    | 102   | 3,110 | 3,453 |
| CBBR-24108 | 24    | 108   | 3,270 | 3,628 |
| CBBR-24114 | 24    | 114   | 3,418 | 3,798 |
| CBBR-24120 | 24    | 120   | 3,577 | 3,974 |



# WORK SURFACES

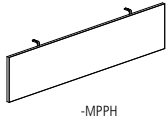

| OPTIONS  | CODE   | PRICE   | NOTES   |
|--|--------|---------|---|
| <b>Modesty Panel Options (Required with Hoop or Panel Base):</b> |        |         |   |
| Painted Modesty Panel Half Height                                | -MPPH  | \$1,231 |   |
| Wood Modesty Panel Half Height                                   | -MPWH  | \$1,231 |   |
| Painted Modesty Panel Full Height                                | -MPPF  | \$1,355 |   |
| Wood Modesty Panel Full Height                                   | -MPWF  | \$1,355 |   |
| <b>2"-Diameter Grommet Options:</b>                              |        |         |   |
| Center Grommet   | -WPRC  | \$234   |   |
| Left Grommet   | -WPRL  | \$234   |   |
| Right Grommet  | -WPRR  | \$234   |   |
| Left and Right Grommet   | -WPR2  | \$465   |   |
| Polished Chrome Grommet  | -PCG   | \$98    | Upcharge per Grommet  |
| <b>Power Spec / USB Spec Options:</b>                            |        |         |   |
| Center Power Spec or USB Spec                                    | -SP-C  |         | Power Spec / USB Spec specified separately.<br>See page 44. |
| Left Power Spec or USB Spec                                      | -SP-L  |         |   |
| Right Power Spec or USB Spec                                     | -SP-R  |         |   |
| Left & Right Power Spec or USB Spec                              | -SP-LR |         |   |
| <b>Pencil Stop Options (Specify per work surface):</b>           |        |         |   |
| Pencil Stop (along depth of work surface)                        | -PSD   | \$172   |   |
| Pencil Stop (along length of work surface)                       | -PSL   | \$172   |   |
| Polished Chrome Pencil Stop                                      | -PSPC  | \$98    | Upcharger per Pencil Stop                                   |

## GENERAL INFORMATION

- Work surface height 29-1/2"
- Edge profile is square
- Half height modesty panels are 12"-high
- Grommet is 2" Diameter. Available in Powder Coat, Clear Anodized or Polished Chrome (upcharge applies).
- Work surface tops and storage fronts will be grain-matched sets based on configuration
- When specifying left and right, handedness is oriented to the user
- There will be 1/4" gap between height adjustable and static worksurfaces, the lift controller is a dual switch system
- Desk modesty panel required on desks with 2 panel bases, 2 hoop bases, or a combination of hoop and panel bases
- Desk modesty panel with two hoop legs may be flush with the edge of the work surface or inset 6"
- Desk modesty panel will be inset from the edge of the work surface for both panel legs and pedestals
- Panel supports run full depth of the work surface
- Grain direction should always run parallel to a seam
- Pencil stop available in Powder coat, Clear Anodized, and Polished finishes
- Polished chrome pencil stop maximum length is 114"; 120" polished chrome pencil stop will have a seam at center
- Pencil stop not available on Run-Off Desks
- Grommets in height adjustable Bridges, Returns, and Credenzas available at center location only
- Grain direction on wood grain laminates will always run the length of the work surface
- Only one pencil stop may be specified per work surface
- Optional half height modesty panel available on run-off desk; full height modesty is not an option for run-off desks
- Work surface power available on page 44

### REQUIRED INFORMATION (ORDER CANNOT BE ENTERED WITHOUT THIS INFORMATION)

See appendix pages vi-vii for surface material options.

- Choose Veneer Finish, if applicable
- Choose Metal Finish, if applicable
- Choose Laminate, if applicable
- Choose Edge Band Finish



# STATIONARY WORK SURFACE SUPPORTS AND STORAGE

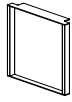

HOOP LEG

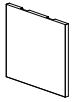

PANEL LEG

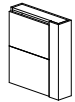
PANEL LEG  
ADJACENT  
ADJ HEIGHTBOX BOX FILE  
PEDESTALFILE FILE  
PEDESTALLATERAL FILE  
PEDESTAL

## SURFACE MATERIAL KEY

|    |                              |
|----|------------------------------|
| S  | All Paint                    |
| VS | Veneer Case with Paint Front |
| V  | All Veneer                   |

### HOOP LEG

| MODEL #     | DEPTH | WIDTH | DESCRIPTION                      | PRICE | -S | -VS | -V |
|-------------|-------|-------|----------------------------------|-------|----|-----|----|
| CBHL-24-[ ] | 24    | 2.5   | Metal Hoop Leg 24"D Work Surface | 894   | -  | -   | -  |
| CBHL-30-[ ] | 30    | 2.5   | Metal Hoop Leg 30"D Work Surface | 1,116 | -  | -   | -  |
| CBHL-36-[ ] | 36    | 2.5   | Metal Hoop Leg 36"D Work Surface | 1,255 | -  | -   | -  |

### PANEL LEG

| MODEL #     | DEPTH | WIDTH | DESCRIPTION                 | -S    | -VS | -V    |
|-------------|-------|-------|-----------------------------|-------|-----|-------|
| CBPL-24-[ ] | 24    | 1.5   | Panel Leg 24"D Work Surface | 1,099 | -   | 1,155 |
| CBPL-30-[ ] | 30    | 1.5   | Panel Leg 30"D Work Surface | 1,219 | -   | 1,281 |
| CBPL-36-[ ] | 36    | 1.5   | Panel Leg 36"D Work Surface | 1,348 | -   | 1,421 |

### PANEL LEG WITH KEEL // KEEL REQUIRED WITH PANEL LEG WHEN THE ADJACENT BRIDGE/RETURN HAS AN ACCESS PANEL

| MODEL #      | DEPTH | WIDTH | DESCRIPTION                           | -S    | -VS | -V    |
|--------------|-------|-------|---------------------------------------|-------|-----|-------|
| CBPLK-24-[ ] | 24    | 1.5   | Panel Leg 24"D Work Surface with Keel | 1,031 | -   | 1,083 |
| CBPLK-30-[ ] | 30    | 1.5   | Panel Leg 30"D Work Surface with Keel | 1,144 | -   | 1,203 |
| CBPLK-36-[ ] | 36    | 1.5   | Panel Leg 36"D Work Surface with Keel | 1,267 | -   | 1,333 |

### PANEL LEG ADJACENT ADJUSTABLE HEIGHT

| MODEL #      | DEPTH | WIDTH | DESCRIPTION                                  | -S    | -VS   | -V    |
|--------------|-------|-------|--|-------|-------|-------|
| CBPLH-24-[ ] | 24    | 5     | Panel Leg 24"D WS, Matches Adj Ht Wall Depth | 1,554 | 1,638 | 1,638 |
| CBPLH-30-[ ] | 30    | 5     | Panel Leg 30"D WS, Matches Adj Ht Wall Depth | 1,786 | 1,879 | 1,879 |
| CBPLH-36-[ ] | 36    | 5     | Panel Leg 36"D WS, Matches Adj Ht Wall Depth | 2,052 | 2,158 | 2,158 |

### BOX/BOX/FILE PEDESTAL

| MODEL #       | DEPTH | WIDTH | DESCRIPTION                               | -S    | -VS   | -V    |
|---------------|-------|-------|---|-------|-------|-------|
| CBPS-BBF-1524 | 24    | 15.5  | Box Box File Pedestal (Desk Support Only) | 2,571 | 2,706 | 2,706 |
| CBPS-BBF-1530 | 30    | 15.5  | Box Box File Pedestal (Desk Support Only) | 2,772 | 2,920 | 2,920 |
| CBPS-BBF-1824 | 24    | 18    | Box Box File Pedestal                     | 2,790 | 2,935 | 2,935 |
| CBPS-BBF-1830 | 30    | 18    | Box Box File Pedestal                     | 3,174 | 3,344 | 3,344 |

### FILE/FILE PEDESTAL

| MODEL #      | DEPTH | WIDTH | DESCRIPTION                            | -S    | -VS   | -V    |
|--------------|-------|-------|--|-------|-------|-------|
| CBPS-FF-1524 | 24    | 15.5  | File File Pedestal (Desk Support Only) | 2,571 | 2,706 | 2,706 |
| CBPS-FF-1530 | 30    | 15.5  | File File Pedestal (Desk Support Only) | 2,772 | 2,920 | 2,920 |
| CBPS-FF-1824 | 24    | 18    | File File Pedestal                     | 2,790 | 2,935 | 2,935 |
| CBPS-FF-1830 | 30    | 18    | File File Pedestal                     | 3,174 | 3,344 | 3,344 |

### LATERAL FILE PEDESTAL

| MODEL #      | DEPTH | WIDTH | DESCRIPTION           | -S    | -VS   | -V    |
|--------------|-------|-------|-----------------------|-------|-------|-------|
| CBPS-LF-3024 | 24    | 30    | Lateral File Pedestal | 3,078 | 3,239 | 3,239 |
| CBPS-LF-3624 | 24    | 36    | Lateral File Pedestal | 3,384 | 3,560 | 3,560 |

[ ] Specify Left (-L) or Right (-R)



# STATIONARY WORK SURFACE SUPPORTS AND STORAGE



OPEN SHELF  
PEDESTAL



DOOR PEDESTAL

## SURFACE MATERIAL KEY

|    |                              |
|----|------------------------------|
| S  | All Paint                    |
| VS | Veneer Case with Paint Front |
| V  | All Veneer                   |

### OPEN SHELF PEDESTAL

| MODEL #      | DEPTH | WIDTH | DESCRIPTION         | -S    | -VS | -V    |
|--------------|-------|-------|---------------------|-------|-----|-------|
| CBPS-OS-1824 | 24    | 18    | Open Shelf Pedestal | 2,572 | -   | 2,706 |
| CBPS-OS-3024 | 24    | 30    | Open Shelf Pedestal | 2,703 | -   | 2,845 |
| CBPS-OS-3624 | 24    | 36    | Open Shelf Pedestal | 2,771 | -   | 2,915 |

### DOOR PEDESTAL

| MODEL #         | DEPTH | WIDTH | DESCRIPTION                  | -S    | -VS   | -V    |
|-----------------|-------|-------|------------------------------|-------|-------|-------|
| CBPS-D-1824-[ ] | 24    | 18    | Single Door Storage Pedestal | 2,895 | 3,047 | 3,047 |
| CBPS-DD-3024    | 24    | 30    | Double Door Storage Pedestal | 3,026 | 3,185 | 3,185 |
| CBPS-DD-3624    | 24    | 36    | Double Door Storage Pedestal | 3,332 | 3,507 | 3,507 |

[ ] Specify Left (-L) or Right (-R)





# STATIONARY WORK SURFACE SUPPORTS AND STORAGE

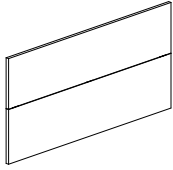

CBAP-1S

## SURFACE MATERIAL KEY

|   |         |
|---|---------|
| S | Painted |
| V | Veneer  |

## ACCESS PANEL

| MODEL # | HEIGHT | DESCRIPTION                         | -S    | -V    |
|---------|--------|-------------------------------------|-------|-------|
| CBAP-0S | 26     | Access Panel for openings 12"-48"   | 1,093 | 1,149 |
| CBAP-1S | 26     | Access Panel for openings 49"-66"   | 1,215 | 1,279 |
| CBAP-2S | 26     | Access Panel for openings 67"-84"   | 1,340 | 1,408 |
| CBAP-3S | 26     | Access Panel for openings 85"-102"  | 1,469 | 1,547 |
| CBAP-4S | 26     | Access Panel for openings 103"-120" | 1,617 | 1,704 |

## OPTIONS

### CODE

### PRICE

### NOTES

#### Polished Chrome Options:

Polished Chrome Hoop Leg

-PCHL

\$1,276

#### Pedestal Options:

No Locks

-NL

No Charge

Undermount Soft Close Drawer Slide

-US

\$172

#### Pull Options:

Integrated Pull

-IP

No Charge

Metal Tabl Pull

-MT

No Charge

Polished Chrome Pull

-PCP

\$219

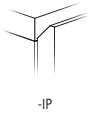

-IP



-MT

## GENERAL INFORMATION

- Specify supports left to right
- Access modesty panels are not available in widths less than 10"; for an opening less than 10", it will be left open
- Grain direction is vertical
- Pencil trays standard within Box Drawers
- Work surface tops and storage fronts will be grain-matched sets based on configuration
- Face locking standard on all desk pedestals, locks are always located on the right
- When specifying left and right, handedness is oriented to the user
- Hoop and Panel legs require a modesty
- Pedestal is standard with white drawer boxes and sidemount self closing drawer slides; undermount soft close slides are optional
- Lateral file drawers are not available with undermount slides
- Lateral file drawers are not self closing
- Work surface height adjustable range of travel 28"-45"
- Access Panel required for openings greater than 60"
- 15"-wide Pedestals are for use as desk supports only
- Panel leg supports must run the full depth of the work surface
- Desk pedestals, when combined with a Panel leg, must run the full depth of the work surface
- 15.5"-wide pedestals accommodate side-to-side legal filing
- 18"-wide pedestals accommodate side-to-side and front-to-back letter filing and side-to-side legal filing
- 30"-wide and 36"-wide pedestals accommodate side-to-side and front-to-back letter and legal filing
- Wire Manager not included as standard on Hoop Leg

### REQUIRED INFORMATION (ORDER CANNOT BE ENTERED WITHOUT THIS INFORMATION)

See appendix pages vi-vii for surface material options.

- Choose Veneer Finish, if applicable
- Choose Metal Finish, if applicable
- Choose Paint Finish, if applicable



# ADJUSTABLE HEIGHT WORK SURFACE SUPPORTS

PRIMARY DESK AS ADJUSTABLE HEIGHT (WORK SURFACE AND BASE INCLUDED)

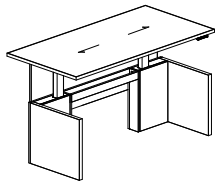

FREESTANDING DESK

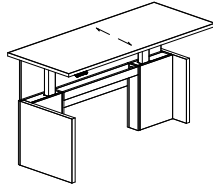

RUN-OFF DESK

## SURFACE MATERIAL KEY

PE Laminate Top with Square Edge  
V All Veneer

### ADJUSTABLE HEIGHT FREESTANDING DESK

| MODEL #    | DEPTH | WIDTH | DESCRIPTION  | -PE    | -V     |
|------------|-------|-------|--|--------|--------|
| CBAFD-3060 | 30    | 60    | Freestanding Adj. Ht Panel Bases w/ Full Height Modesty 30" x 60" Desk | 10,048 | 10,576 |
| CBAFD-3066 | 30    | 66    | Freestanding Adj. Ht Panel Bases w/ Full Height Modesty 30" x 66" Desk | 10,258 | 10,798 |
| CBAFD-3072 | 30    | 72    | Freestanding Adj. Ht Panel Bases w/ Full Height Modesty 30" x 72" Desk | 10,465 | 11,013 |
| CBAFD-3078 | 30    | 78    | Freestanding Adj. Ht Panel Bases w/ Full Height Modesty 30" x 78" Desk | 10,673 | 11,237 |
| CBAFD-3084 | 30    | 84    | Freestanding Adj. Ht Panel Bases w/ Full Height Modesty 30" x 84" Desk | 10,888 | 11,461 |
| CBAFD-3660 | 36    | 60    | Freestanding Adj. Ht Panel Bases w/ Full Height Modesty 36" x 60" Desk | 10,568 | 11,123 |
| CBAFD-3666 | 36    | 66    | Freestanding Adj. Ht Panel Bases w/ Full Height Modesty 36" x 66" Desk | 10,808 | 11,377 |
| CBAFD-3672 | 36    | 72    | Freestanding Adj. Ht Panel Bases w/ Full Height Modesty 36" x 72" Desk | 11,042 | 11,623 |
| CBAFD-3678 | 36    | 78    | Freestanding Adj. Ht Panel Bases w/ Full Height Modesty 36" x 78" Desk | 11,264 | 11,856 |
| CBAFD-3684 | 36    | 84    | Freestanding Adj. Ht Panel Bases w/ Full Height Modesty 36" x 84" Desk | 11,496 | 12,099 |

### ADJUSTABLE HEIGHT RUN-OFF DESK

| MODEL #        | DEPTH | WIDTH | DESCRIPTION  | -PE    | -V     |
|----------------|-------|-------|--|--------|--------|
| CBARO-3060-[ ] | 30    | 60    | Run-Off Desk Adj. Ht Panel Bases w/ Full Height Modesty 30" x 60" Desk | 10,048 | 10,576 |
| CBARO-3066-[ ] | 30    | 66    | Run-Off Desk Adj. Ht Panel Bases w/ Full Height Modesty 30" x 66" Desk | 10,258 | 10,798 |
| CBARO-3072-[ ] | 30    | 72    | Run-Off Desk Adj. Ht Panel Bases w/ Full Height Modesty 30" x 72" Desk | 10,465 | 11,013 |
| CBARO-3078-[ ] | 30    | 78    | Run-Off Desk Adj. Ht Panel Bases w/ Full Height Modesty 30" x 78" Desk | 10,673 | 11,237 |
| CBARO-3084-[ ] | 30    | 84    | Run-Off Desk Adj. Ht Panel Bases w/ Full Height Modesty 30" x 84" Desk | 10,888 | 11,461 |
| CBARO-3660-[ ] | 36    | 60    | Run-Off Desk Adj. Ht Panel Bases w/ Full Height Modesty 36" x 60" Desk | 10,568 | 11,123 |
| CBARO-3666-[ ] | 36    | 66    | Run-Off Desk Adj. Ht Panel Bases w/ Full Height Modesty 36" x 66" Desk | 10,808 | 11,377 |
| CBARO-3672-[ ] | 36    | 72    | Run-Off Desk Adj. Ht Panel Bases w/ Full Height Modesty 36" x 72" Desk | 11,042 | 11,623 |
| CBARO-3678-[ ] | 36    | 78    | Run-Off Desk Adj. Ht Panel Bases w/ Full Height Modesty 36" x 78" Desk | 11,264 | 11,856 |
| CBARO-3684-[ ] | 36    | 84    | Run-Off Desk Adj. Ht Panel Bases w/ Full Height Modesty 36" x 84" Desk | 11,496 | 12,099 |

[ ] Specify Left (-L) or Right (-R)

#### OPTIONS

##### Panel Base Finish Options:

|        |     |           |
|--------|-----|-----------|
| Veneer | -VB | No Charge |
| Paint  | -PB | No Charge |

##### Modesty Panel Options:

|                                   |       |           |
|-----------------------------------|-------|-----------|
| Painted Modesty Panel Full Height | -MPPF | No Charge |
| Wood Modesty Panel Full Height    | -MPWF | No Charge |

##### 2"-Diameter Grommet Options:

|                         |       |       |                      |
|-------------------------|-------|-------|----------------------|
| Center Grommet          | -WPRC | \$234 |                      |
| Left Grommet            | -WPRL | \$234 |                      |
| Right Grommet           | -WPRR | \$234 |                      |
| Left and Right Grommet  | -WPR2 | \$465 |                      |
| Polished Chrome Grommet | -PCG  | \$98  | Upcharge per Grommet |

##### Power Spec / USB Spec Options:

|                                     |        |  |  |
|-------------------------------------|--------|--|--|
| Center Power Spec or USB Spec       | -SP-C  |  |  |
| Left Power Spec or USB Spec         | -SP-L  |  |  |
| Right Power Spec or USB Spec        | -SP-R  |  |  |
| Left & Right Power Spec or USB Spec | -SP-LR |  |  |

Power Spec / USB Spec specified separately.  
See page 44.



# ADJUSTABLE HEIGHT WORK SURFACE SUPPORTS

PRIMARY DESK AS ADJUSTABLE HEIGHT (WORK SURFACE AND BASE INCLUDED)

## GENERAL INFORMATION

- Grain direction is vertical
- Grommet is 2" Diameter. Available in Powder Coat, Clear Anodized or Polished Chrome (upcharge applies).
- Pencil trays standard within Box Drawer, runs depth of the drawer box
- Work surface tops and storage fronts will be grain-matched sets based on configuration
- Face locking standard on all desk pedestals, locks are always located on the right
- When specifying left and right, handedness is oriented to the user
- Adjustable height panel base requires a full height modesty, modesty included in model number above
- Pedestal is standard with white drawer boxes and sidemount self closing drawer slides
- Work surface height adjustable range of travel 28" -46"
- Lift mechanisms are designed to support all desk components, plus a maximum of 100lbs additional weight
- Height adjustable lift mechanism is warranted for 2 years
- Lift mechanisms for both wall and T leg applications are only available in powder coat finishes
- There will be 1/4" gap between height adjustable and static worksurfaces, the lift controller is a dual switch system
- Work surface power available on page 44
- Power Spec or USB Spec not available in individual work surfaces if Grommet option is selected

### REQUIRED INFORMATION (ORDER CANNOT BE ENTERED WITHOUT THIS INFORMATION)

See appendix pages vi-vii for surface material options.

- Choose Veneer Finish, if applicable
- Choose Metal Finish, if applicable
- Choose Paint Finish, if applicable

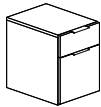

CBFP-BF-1521

### SURFACE MATERIAL KEY

|    |                              |
|----|------------------------------|
| S  | All Paint                    |
| VS | Veneer Case with Paint Front |
| V  | All Veneer                   |

## FREESTANDING STORAGE PEDESTAL

| MODEL #      | DEPTH | WIDTH | DESCRIPTION           | -S    | -VS   | -V    |
|--------------|-------|-------|-----------------------|-------|-------|-------|
| CBFP-BF-1521 | 21    | 15    | Freestanding Box/File | 2,754 | 2,898 | 2,898 |

### OPTIONS

#### Pedestal Options:

- No Locks (Pedestals)
- Undermount Soft Close Drawer Slide

|     |           |
|-----|-----------|
| -NL | No Charge |
| -US | \$172     |

#### Pull Options:

- Integrated Pull
- Metal Tabl Pull
- Polished Chrome Pull

|      |           |
|------|-----------|
| -IP  | No Charge |
| -MT  | No Charge |
| -PCP | \$219     |

#### Seat Cushion (1-1/2 yds)

|            |         |         |
|------------|---------|---------|
| COM Fabric | -SC-COM | \$455   |
| Grade A    | -SC-A   | \$623   |
| Grade B    | -SC-B   | \$673   |
| Grade C    | -SC-C   | \$769   |
| Grade D    | -SC-D   | \$861   |
| Grade E    | -SC-E   | \$953   |
| Grade F    | -SC-F   | \$1,016 |
| Grade G    | -SC-G   | \$1,110 |
| Grade H    | -SC-H   | \$1,157 |

## GENERAL INFORMATION

- Grain direction is vertical
- Pencil trays standard within Box Drawer, runs depth of the drawer box
- Face locking standard on all desk pedestals, locks are always located on the right
- Pedestal is standard with white drawer boxes and sidemount self closing drawer slides
- 15"-wide pedestals accommodate side-to-side legal filing

### REQUIRED INFORMATION (ORDER CANNOT BE ENTERED WITHOUT THIS INFORMATION)

See appendix pages vi-vii for surface material options.

- Choose Veneer Finish, if applicable
- Choose Metal Finish, if applicable (Options include Chrome, Clear Anodized, and Powder Coat finishes)
- Choose Paint Finish, if applicable

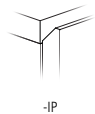

-IP



-MT



# ADJUSTABLE HEIGHT WORK SURFACE SUPPORTS

PRIMARY DESK AS ADJUSTABLE HEIGHT (WORK SURFACE AND BASE INCLUDED)

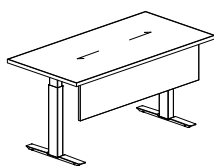

T-LEG FREESTANDING DESK

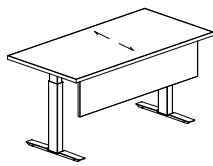

T-LEG RUN-OFF DESK

## SURFACE MATERIAL KEY

PE Laminate Top with Square Edge Top  
V Veneer Top

### T-LEG ADJUSTABLE HEIGHT FREESTANDING DESK

| MODEL #   | DEPTH | WIDTH | -PE   | -V    |
|-----------|-------|-------|-------|-------|
| CBAD-2442 | 24    | 42    | 4,176 | 4,397 |
| CBAD-2448 | 24    | 48    | 4,272 | 4,497 |
| CBAD-2454 | 24    | 54    | 4,355 | 4,584 |
| CBAD-3048 | 30    | 48    | 4,634 | 4,877 |
| CBAD-3054 | 30    | 54    | 4,865 | 5,119 |
| CBAD-3060 | 30    | 60    | 5,102 | 5,369 |
| CBAD-3066 | 30    | 66    | 5,303 | 5,584 |
| CBAD-3072 | 30    | 72    | 5,497 | 5,787 |
| CBAD-3648 | 36    | 48    | 5,004 | 5,268 |
| CBAD-3654 | 36    | 54    | 5,274 | 5,551 |
| CBAD-3660 | 36    | 60    | 5,544 | 5,832 |
| CBAD-3666 | 36    | 66    | 5,782 | 6,083 |
| CBAD-3672 | 36    | 72    | 6,016 | 6,334 |

### T-LEG ADJUSTABLE HEIGHT RUN-OFF DESK

| MODEL #   | DEPTH | WIDTH | -PE   | -V    |
|-----------|-------|-------|-------|-------|
| CBAR-2442 | 24    | 42    | 4,176 | 4,397 |
| CBAR-2448 | 24    | 48    | 4,272 | 4,497 |
| CBAR-2454 | 24    | 54    | 4,355 | 4,584 |
| CBAR-3048 | 30    | 48    | 4,634 | 4,877 |
| CBAR-3054 | 30    | 54    | 4,865 | 5,119 |
| CBAR-3060 | 30    | 60    | 5,102 | 5,369 |
| CBAR-3066 | 30    | 66    | 5,303 | 5,584 |
| CBAR-3072 | 30    | 72    | 5,497 | 5,787 |
| CBAR-3648 | 36    | 48    | 5,004 | 5,268 |
| CBAR-3654 | 36    | 54    | 5,274 | 5,551 |
| CBAR-3660 | 36    | 60    | 5,544 | 5,832 |
| CBAR-3666 | 36    | 66    | 5,782 | 6,083 |
| CBAR-3672 | 36    | 72    | 6,016 | 6,334 |

## OPTIONS

### Modesty Panel Options:

Painted Modesty Panel Half Height  
Wood Modesty Panel Half Height

## CODE

-MPPH  
-MPWH

## PRICE

\$1,231  
\$1,231

## NOTES

### 2"-Diameter Grommet Options:

Center Grommet

-WPRC

\$234

Polished Chrome Grommet

-PCG

\$98

Upcharge per Grommet

### Power Spec / USB Spec Options:

Center Power Spec or USB Spec

-SP-C

Power Spec / USB Spec specified separately.  
See page 44.



# ADJUSTABLE HEIGHT WORK SURFACE SUPPORTS

PRIMARY DESK AS ADJUSTABLE HEIGHT (WORK SURFACE AND BASE INCLUDED)

## GENERAL INFORMATION

- Grain direction is vertical
- Grommet is 2" Diameter. Available in Powder Coat, Clear Anodized or Polished Chrome (upcharge applies).
- Pencil trays standard within Box Drawer, runs depth of the drawer box
- Work surface tops and storage fronts will be grain-matched sets based on configuration
- Face locking standard on all desk pedestals, locks are always located on the right
- When specifying left and right, handedness is oriented to the user
- Adjustable height panel base requires a full height modesty, modesty included in model number above
- Pedestal is standard with white drawer boxes and sidemount self closing drawer slides
- Work surface height adjustable range of travel 28" -46"
- Lift mechanisms are designed to support all desk components, plus a maximum of 100lbs additional weight
- Height adjustable lift mechanism is warranted for 2 years
- Lift mechanisms for both wall and T leg applications are only available in powder coat finishes
- There will be 1/4" gap between height adjustable and static worksurfaces, the lift controller is a dual switch system
- Work surface power available on page 44
- Power Spec or USB Spec not available in individual work surfaces if Grommet option is selected

### REQUIRED INFORMATION (ORDER CANNOT BE ENTERED WITHOUT THIS INFORMATION)

See appendix pages vi-vii for surface material options.

- Choose Veneer Finish, if applicable
- Choose Metal Finish, if applicable
- Choose Paint Finish, if applicable

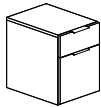

CBFP-BF-1521

### SURFACE MATERIAL KEY

|    |                              |
|----|------------------------------|
| S  | All Paint                    |
| VS | Veneer Case with Paint Front |
| V  | All Veneer                   |

## FREESTANDING STORAGE PEDESTAL

| MODEL #      | DEPTH | WIDTH | DESCRIPTION           | -S    | -VS   | -V    |
|--------------|-------|-------|-----------------------|-------|-------|-------|
| CBFP-BF-1521 | 21    | 15    | Freestanding Box/File | 2,754 | 2,898 | 2,898 |

### OPTIONS

#### Pedestal Options:

|                                    |     |           |
|------------------------------------|-----|-----------|
| No Locks (Pedestals)               | -NL | No Charge |
| Undermount Soft Close Drawer Slide | -US | \$172     |

#### Pull Options:

|                      |      |           |
|----------------------|------|-----------|
| Integrated Pull      | -IP  | No Charge |
| Metal Tabl Pull      | -MT  | No Charge |
| Polished Chrome Pull | -PCP | \$219     |

#### Seat Cushion (1-1/2 yds)

|            |         |         |
|------------|---------|---------|
| COM Fabric | -SC-COM | \$455   |
| Grade A    | -SC-A   | \$623   |
| Grade B    | -SC-B   | \$673   |
| Grade C    | -SC-C   | \$769   |
| Grade D    | -SC-D   | \$861   |
| Grade E    | -SC-E   | \$953   |
| Grade F    | -SC-F   | \$1,016 |
| Grade G    | -SC-G   | \$1,110 |
| Grade H    | -SC-H   | \$1,157 |

## GENERAL INFORMATION

- Grain direction is vertical
- Pencil trays standard within Box Drawer, runs depth of the drawer box
- Face locking standard on all desk pedestals, locks are always located on the right
- Pedestal is standard with white drawer boxes and sidemount self closing drawer slides
- 15"-wide pedestals accommodate side-to-side legal filing

### REQUIRED INFORMATION (ORDER CANNOT BE ENTERED WITHOUT THIS INFORMATION)

See appendix pages vi-vii for surface material options.

- Choose Veneer Finish, if applicable
- Choose Metal Finish, if applicable (Options include Chrome, Clear Anodized, and Powder Coat finishes)
- Choose Paint Finish, if applicable



# ADJUSTABLE HEIGHT WORK SURFACE SUPPORTS

FOR SECONDARY WORK SURFACES (BRIDGES, RETURNS AND CREDENZAS)

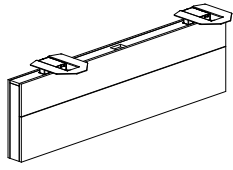

CBA-W-84

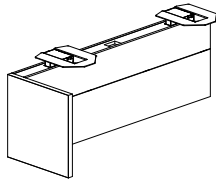

CBA-P-72

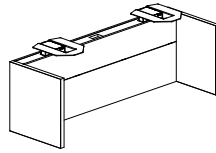

CBA-PP-72

## SURFACE MATERIAL KEY

|    |                              |
|----|------------------------------|
| S  | All Paint                    |
| VS | Veneer Case with Paint Front |
| V  | All Veneer                   |

## ADJUSTABLE HEIGHT

| MODEL #      | DEPTH | WIDTH | DESCRIPTION   | -S    | -VS   | -V    |
|--------------|-------|-------|---|-------|-------|-------|
| CBA-W-42     | 5     | 42    | Wall Support w/ Lifts, Access Panel                     | 5,247 | 5,523 | 5,523 |
| CBA-W-48     | 5     | 48    | Wall Support w/ Lifts, Access Panel                     | 5,554 | 5,845 | 5,845 |
| CBA-W-54     | 5     | 54    | Wall Support w/ Lifts, Access Panel                     | 5,877 | 6,187 | 6,187 |
| CBA-W-60     | 5     | 60    | Wall Support w/ Lifts, Access Panel                     | 6,215 | 6,539 | 6,539 |
| CBA-W-66     | 5     | 66    | Wall Support w/ Lifts, Access Panel                     | 6,554 | 6,896 | 6,896 |
| CBA-W-72     | 5     | 72    | Wall Support w/ Lifts, Access Panel                     | 6,906 | 7,271 | 7,271 |
| CBA-W-78     | 5     | 78    | Wall Support w/ Lifts, Access Panel                     | 7,282 | 7,663 | 7,663 |
| CBA-W-84     | 5     | 84    | Wall Support w/ Lifts, Access Panel                     | 7,675 | 8,079 | 8,079 |
| CBA-P-42-[ ] | 5     | 42    | Wall Support w/ Lifts, Access Panel, and One End Panel  | 5,810 | 6,118 | 6,118 |
| CBA-P-48-[ ] | 5     | 48    | Wall Support w/ Lifts, Access Panel, and One End Panel  | 6,118 | 6,439 | 6,439 |
| CBA-P-54-[ ] | 5     | 54    | Wall Support w/ Lifts, Access Panel, and One End Panel  | 6,439 | 6,777 | 6,777 |
| CBA-P-60-[ ] | 5     | 60    | Wall Support w/ Lifts, Access Panel, and One End Panel  | 6,777 | 7,133 | 7,133 |
| CBA-P-66-[ ] | 5     | 66    | Wall Support w/ Lifts, Access Panel, and One End Panel  | 7,116 | 7,489 | 7,489 |
| CBA-P-72-[ ] | 5     | 72    | Wall Support w/ Lifts, Access Panel, and One End Panel  | 7,474 | 7,863 | 7,863 |
| CBA-P-78-[ ] | 5     | 78    | Wall Support w/ Lifts, Access Panel, and One End Panel  | 7,847 | 8,259 | 8,259 |
| CBA-P-84-[ ] | 5     | 84    | Wall Support w/ Lifts, Access Panel, and One End Panel  | 8,235 | 8,669 | 8,669 |
| CBA-PP-60    | 5     | 60    | Wall Support w/ Lifts, Access Panel, and Two End Panels | 7,340 | 7,729 | 7,729 |
| CBA-PP-66    | 5     | 66    | Wall Support w/ Lifts, Access Panel, and Two End Panels | 7,679 | 8,083 | 8,083 |
| CBA-PP-72    | 5     | 72    | Wall Support w/ Lifts, Access Panel, and Two End Panels | 8,034 | 8,459 | 8,459 |
| CBA-PP-78    | 5     | 78    | Wall Support w/ Lifts, Access Panel, and Two End Panels | 8,408 | 8,850 | 8,850 |
| CBA-PP-84    | 5     | 84    | Wall Support w/ Lifts, Access Panel, and Two End Panels | 8,799 | 9,263 | 9,263 |

[ ] Specify Left (-L) or Right (-R) End Panel

## GENERAL INFORMATION

- Grain direction is vertical
- Work surface is specified separately
- Work surface tops and storage fronts will be grain-matched sets based on configuration
- When specifying left and right, handedness is oriented to the user
- Height adjustable lift mechanism is warranted for 2 years
- Lift mechanisms for both wall and T leg applications are only available in powdercoat finishes
- There will be 1/4" gap between height adjustable and static worksurfaces, the lift controller is a dual switch system
- Work surface travel range 28"-46"
- Adjustable height wall enclosures include a cutout in the back panel to access electrical or data ports

### REQUIRED INFORMATION (ORDER CANNOT BE ENTERED WITHOUT THIS INFORMATION)

See appendix pages vi-vii for surface material options.

- Choose Veneer Finish, if applicable
- Choose Metal Finish, if applicable
- Choose Paint Finish, if applicable



# WALL-MOUNT OPEN SHELF OVERHEADS

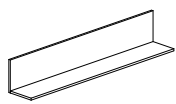

SINGLE WOOD SHELF  
WITH BACK PANEL

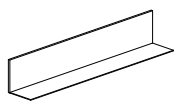

SINGLE METAL SHELF  
WITH BACK PANEL

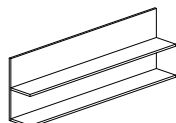

DOUBLE WOOD SHELF  
WITH BACK PANEL

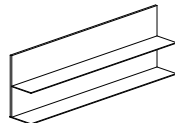

DOUBLE METAL SHELF  
WITH BACK PANEL

## SURFACE MATERIAL KEY

|    |                                     |
|----|-------------------------------------|
| S  | Painted Back Panel and Shelf        |
| VS | Veneer Back Panel and Painted Shelf |
| V  | Veneer Back Panel and Shelf         |

### SINGLE WOOD SHELF WITH BACK PANEL

| MODEL #    | HEIGHT | WIDTH | DEPTH | DESCRIPTION                     | -S    | -VS   | -V    |
|------------|--------|-------|-------|---------------------------------|-------|-------|-------|
| CBWW-6070  | 16.75  | 60    | 13.7  | Single Wood Shelf w/ Back Panel | 2,974 | 3,132 | 3,132 |
| CBWW-6670  | 16.75  | 66    | 13.7  | Single Wood Shelf w/ Back Panel | 3,124 | 3,289 | 3,289 |
| CBWW-7270  | 16.75  | 72    | 13.7  | Single Wood Shelf w/ Back Panel | 3,273 | 3,444 | 3,444 |
| CBWW-7870  | 16.75  | 78    | 13.7  | Single Wood Shelf w/ Back Panel | 3,420 | 3,601 | 3,601 |
| CBWW-8470  | 16.75  | 84    | 13.7  | Single Wood Shelf w/ Back Panel | 3,570 | 3,756 | 3,756 |
| CBWW-9070  | 16.75  | 90    | 13.7  | Single Wood Shelf w/ Back Panel | 3,716 | 3,914 | 3,914 |
| CBWW-9670  | 16.75  | 96    | 13.7  | Single Wood Shelf w/ Back Panel | 3,865 | 4,065 | 4,065 |
| CBWW-10270 | 16.75  | 102   | 13.7  | Single Wood Shelf w/ Back Panel | 4,016 | 4,224 | 4,224 |
| CBWW-10870 | 16.75  | 108   | 13.7  | Single Wood Shelf w/ Back Panel | 4,164 | 4,381 | 4,381 |
| CBWW-11470 | 16.75  | 114   | 13.7  | Single Wood Shelf w/ Back Panel | 4,310 | 4,536 | 4,536 |
| CBWW-12070 | 16.75  | 120   | 13.7  | Single Wood Shelf w/ Back Panel | 4,409 | 4,642 | 4,642 |

### SINGLE METAL SHELF WITH BACK PANEL

| MODEL #    | HEIGHT | WIDTH | DEPTH | DESCRIPTION                      | -S    | -VS | -V    |
|------------|--------|-------|-------|----------------------------------|-------|-----|-------|
| CBMM-6070  | 16.75  | 60    | 13.7  | Single Metal Shelf w/ Back Panel | 2,974 | -   | 3,132 |
| CBMM-6670  | 16.75  | 66    | 13.7  | Single Metal Shelf w/ Back Panel | 3,124 | -   | 3,289 |
| CBMM-7270  | 16.75  | 72    | 13.7  | Single Metal Shelf w/ Back Panel | 3,273 | -   | 3,444 |
| CBMM-7870  | 16.75  | 78    | 13.7  | Single Metal Shelf w/ Back Panel | 3,420 | -   | 3,601 |
| CBMM-8470  | 16.75  | 84    | 13.7  | Single Metal Shelf w/ Back Panel | 3,570 | -   | 3,756 |
| CBMM-9070  | 16.75  | 90    | 13.7  | Single Metal Shelf w/ Back Panel | 3,716 | -   | 3,914 |
| CBMM-9670  | 16.75  | 96    | 13.7  | Single Metal Shelf w/ Back Panel | 3,865 | -   | 4,065 |
| CBMM-10270 | 16.75  | 102   | 13.7  | Single Metal Shelf w/ Back Panel | 4,016 | -   | 4,224 |
| CBMM-10870 | 16.75  | 108   | 13.7  | Single Metal Shelf w/ Back Panel | 4,164 | -   | 4,381 |
| CBMM-11470 | 16.75  | 114   | 13.7  | Single Metal Shelf w/ Back Panel | 4,310 | -   | 4,536 |
| CBMM-12070 | 16.75  | 120   | 13.7  | Single Metal Shelf w/ Back Panel | 4,409 | -   | 4,642 |

### DOUBLE WOOD SHELF WITH BACK PANEL

| MODEL #    | HEIGHT | WIDTH | DEPTH | DESCRIPTION                     | -S    | -VS   | -V    |
|------------|--------|-------|-------|---------------------------------|-------|-------|-------|
| CBWW-6084  | 31     | 60    | 13.7  | Double Wood Shelf w/ Back Panel | 3,753 | 3,949 | 3,949 |
| CBWW-6684  | 31     | 66    | 13.7  | Double Wood Shelf w/ Back Panel | 3,942 | 4,147 | 4,147 |
| CBWW-7284  | 31     | 72    | 13.7  | Double Wood Shelf w/ Back Panel | 4,130 | 4,345 | 4,345 |
| CBWW-7884  | 31     | 78    | 13.7  | Double Wood Shelf w/ Back Panel | 4,315 | 4,540 | 4,540 |
| CBWW-8484  | 31     | 84    | 13.7  | Double Wood Shelf w/ Back Panel | 4,502 | 4,741 | 4,741 |
| CBWW-9084  | 31     | 90    | 13.7  | Double Wood Shelf w/ Back Panel | 4,692 | 4,937 | 4,937 |
| CBWW-9684  | 31     | 96    | 13.7  | Double Wood Shelf w/ Back Panel | 4,877 | 5,135 | 5,135 |
| CBWW-10284 | 31     | 102   | 13.7  | Double Wood Shelf w/ Back Panel | 5,066 | 5,331 | 5,331 |
| CBWW-10884 | 31     | 108   | 13.7  | Double Wood Shelf w/ Back Panel | 5,254 | 5,528 | 5,528 |
| CBWW-11484 | 31     | 114   | 13.7  | Double Wood Shelf w/ Back Panel | 5,439 | 5,726 | 5,726 |
| CBWW-12084 | 31     | 120   | 13.7  | Double Wood Shelf w/ Back Panel | 5,626 | 5,922 | 5,922 |

### DOUBLE METAL SHELF WITH BACK PANEL

| MODEL #    | HEIGHT | WIDTH | DEPTH | DESCRIPTION                      | -S    | -VS | -V    |
|------------|--------|-------|-------|----------------------------------|-------|-----|-------|
| CBMM-6084  | 31     | 60    | 13.7  | Double Metal Shelf w/ Back Panel | 3,753 | -   | 3,949 |
| CBMM-6684  | 31     | 66    | 13.7  | Double Metal Shelf w/ Back Panel | 3,942 | -   | 4,147 |
| CBMM-7284  | 31     | 72    | 13.7  | Double Metal Shelf w/ Back Panel | 4,130 | -   | 4,345 |
| CBMM-7884  | 31     | 78    | 13.7  | Double Metal Shelf w/ Back Panel | 4,315 | -   | 4,540 |
| CBMM-8484  | 31     | 84    | 13.7  | Double Metal Shelf w/ Back Panel | 4,502 | -   | 4,741 |
| CBMM-9084  | 31     | 90    | 13.7  | Double Metal Shelf w/ Back Panel | 4,692 | -   | 4,937 |
| CBMM-9684  | 31     | 96    | 13.7  | Double Metal Shelf w/ Back Panel | 4,877 | -   | 5,135 |
| CBMM-10284 | 31     | 102   | 13.7  | Double Metal Shelf w/ Back Panel | 5,066 | -   | 5,331 |
| CBMM-10884 | 31     | 108   | 13.7  | Double Metal Shelf w/ Back Panel | 5,254 | -   | 5,528 |
| CBMM-11484 | 31     | 114   | 13.7  | Double Metal Shelf w/ Back Panel | 5,439 | -   | 5,726 |
| CBMM-12084 | 31     | 120   | 13.7  | Double Metal Shelf w/ Back Panel | 5,626 | -   | 5,922 |



# WALL-MOUNT OPEN SHELF OVERHEADS

| OPTIONS                         | CODE | PRICE | NOTES |
|---------------------------------|------|-------|-------|
| ADD Tasklight (Wood Shelf Only) | -TL  | \$902 |       |

## GENERAL INFORMATION

- All overhead storage is wall-mounted
- Grain direction is vertical
- Shelf depth is 12.7"
- Wood shelves are 1"-thick with a square edge profile
- Metal shelves are 5/16"-thick with a square edge profile
- Single height overheads can be mounted at the 84" height, there is 21" clearance from the bottom of the overhead to the top of the work surface when work surface is raised to its highest position
- Double shelves cannot be above a height adjustable work surface
- Wood shelves available with an optional integrated LED tasklight
- Metal shelves do not have the option for a tasklight
- Metal storage shelves are available in Clear Anodized only
- Tackboard and glass magnetic board option available. See pages 35-38.
- Wall-Mount Overhead shelves require a back panel below to conceal mounting hardware

### REQUIRED INFORMATION (ORDER CANNOT BE ENTERED WITHOUT THIS INFORMATION)

See appendix pages vi-vii for surface material options.

- Choose Veneer Finish, if applicable
- Choose Paint Finish for wood shelf, if applicable





# WALL-MOUNT SLIDING DOOR OVERHEADS

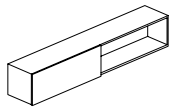

CBOW-1S-96S

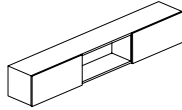

CBOW-2S-120S

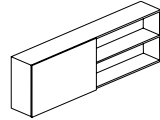

CBOW-1S-84D

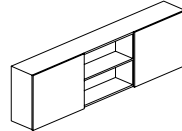

CBOW-2S-120D

## SURFACE MATERIAL KEY

|    |                              |
|----|------------------------------|
| S  | All Paint                    |
| VS | Veneer Case with Paint Door  |
| V  | All Veneer                   |
| SG | Painted Case with Glass Door |
| VG | Veneer Case with Glass Door  |

## SLIDING DOOR // SINGLE HEIGHT

| MODEL #       | HEIGHT | WIDTH | DEPTH | DESCRIPTION  | -S    | -VS    | -V     | -SG    | -VG    |
|---------------|--------|-------|-------|--|-------|--------|--------|--------|--------|
| CBOW-1S-60S   | 17     | 60    | 17.3  | 30" Sliding Door   | 6,498 | 6,840  | 6,840  | 7,278  | 7,659  |
| CBOW-1S-66S   | 17     | 66    | 17.3  | 33" Sliding Door   | 6,823 | 7,181  | 7,181  | 7,644  | 8,045  |
| CBOW-1S-72S   | 17     | 72    | 17.3  | 36" Sliding Door   | 7,148 | 7,523  | 7,523  | 8,007  | 8,427  |
| CBOW-1S-78S   | 17     | 78    | 17.3  | 39" Sliding Door   | 7,476 | 7,867  | 7,867  | 8,366  | 8,807  |
| CBOW-1S-84S   | 17     | 84    | 17.3  | 42" Sliding Door   | 7,796 | 8,207  | 8,207  | 8,730  | 9,190  |
| CBOW-1S-90S   | 17     | 90    | 17.3  | 45" Sliding Door   | 8,123 | 8,550  | 8,550  | 9,096  | 9,573  |
| CBOW-1S-96S   | 17     | 96    | 17.3  | 48" Sliding Door   | 8,445 | 8,893  | 8,893  | 9,457  | 9,956  |
| CBOW-1S-102S  | 17     | 102   | 17.3  | 51" Sliding Door   | 8,770 | 9,231  | 9,231  | 9,819  | 10,338 |
| CBOW-1S-108S  | 17     | 108   | 17.3  | 54" Sliding Door   | 9,098 | 9,575  | 9,575  | 10,187 | 10,722 |
| CBOW-2S-114S  | 17     | 114   | 17    | 38" Sliding Door Left/ Open Center/ 38" Sliding Door Right | 9,422 | 9,917  | 9,917  | 10,550 | 11,105 |
| CBOW-2S-120S  | 17     | 120   | 17    | 40" Sliding Door Left/ Open Center/ 40" Sliding Door Right | 9,749 | 10,258 | 10,258 | 10,187 | 10,722 |
| CBOW-1SD-60S  | 17     | 60    | 19.25 | 30" Sliding Door   | 6,498 | 6,840  | 6,840  | 7,278  | 7,659  |
| CBOW-1SD-66S  | 17     | 66    | 19.25 | 33" Sliding Door   | 6,823 | 7,181  | 7,181  | 7,644  | 8,011  |
| CBOW-1SD-72S  | 17     | 72    | 19.25 | 36" Sliding Door   | 7,148 | 7,523  | 7,523  | 8,007  | 8,427  |
| CBOW-1SD-78S  | 17     | 78    | 19.25 | 39" Sliding Door   | 7,476 | 7,867  | 7,867  | 8,366  | 8,807  |
| CBOW-1SD-84S  | 17     | 84    | 19.25 | 42" Sliding Door   | 7,796 | 8,207  | 8,207  | 8,730  | 9,190  |
| CBOW-1SD-90S  | 17     | 90    | 19.25 | 45" Sliding Door   | 8,123 | 8,550  | 8,550  | 9,096  | 9,573  |
| CBOW-1SD-96S  | 17     | 96    | 19.25 | 48" Sliding Door   | 8,445 | 8,893  | 8,893  | 9,457  | 9,956  |
| CBOW-1SD-102S | 17     | 102   | 19.25 | 51" Sliding Door   | 8,770 | 9,231  | 9,231  | 9,819  | 10,338 |
| CBOW-1SD-108S | 17     | 108   | 19.25 | 54" Sliding Door   | 9,098 | 9,575  | 9,575  | 10,187 | 10,722 |
| CBOW-2SD-114S | 17     | 114   | 19.25 | 38" Sliding Door Left/ Open Center/ 38" Sliding Door Right | 9,422 | 9,917  | 9,917  | 10,550 | 11,105 |
| CBOW-2SD-120S | 17     | 120   | 19.25 | 40" Sliding Door Left/ Open Center/ 40" Sliding Door Right | 9,749 | 10,258 | 10,258 | 10,187 | 10,722 |

## SLIDING DOOR // DOUBLE HEIGHT

| MODEL #       | HEIGHT | WIDTH | DEPTH | DESCRIPTION  | -S     | -VS    | -V     | -SG    | -VG    |
|---------------|--------|-------|-------|--|--------|--------|--------|--------|--------|
| CBOW-1S-60D   | 31.25  | 60    | 17.25 | 30" Sliding Door   | 8,123  | 8,550  | 8,550  | 9,582  | 10,087 |
| CBOW-1S-66D   | 31.25  | 66    | 17.25 | 33" Sliding Door   | 8,528  | 8,976  | 8,976  | 10,062 | 10,591 |
| CBOW-1S-72D   | 31.25  | 72    | 17.25 | 36" Sliding Door   | 8,937  | 9,404  | 9,404  | 10,538 | 11,092 |
| CBOW-1S-78D   | 31.25  | 78    | 17.25 | 39" Sliding Door   | 9,339  | 9,832  | 9,832  | 11,016 | 11,596 |
| CBOW-1S-84D   | 31.25  | 84    | 17.25 | 42" Sliding Door   | 9,749  | 10,258 | 10,258 | 11,496 | 12,099 |
| CBOW-2S-90D   | 31.25  | 90    | 17.25 | 30" Sliding Door Left/30" Center Open/30" Sliding Door Right | 10,151 | 10,686 | 10,686 | 11,976 | 12,605 |
| CBOW-2S-96D   | 31.25  | 96    | 17.25 | 32" Sliding Door Left/32" Center Open/32" Sliding Door Right | 10,555 | 11,110 | 11,110 | 12,453 | 13,107 |
| CBOW-2S-102D  | 31.25  | 102   | 17.25 | 34" Sliding Door Left/34" Center Open/34" Sliding Door Right | 10,965 | 11,540 | 11,540 | 12,933 | 13,612 |
| CBOW-2S-108D  | 31.25  | 108   | 17.25 | 36" Sliding Door Left/36" Center Open/36" Sliding Door Right | 11,365 | 11,966 | 11,966 | 13,410 | 14,116 |
| CBOW-2S-114D  | 31.25  | 114   | 17.25 | 38" Sliding Door Left/38" Center Open/38" Sliding Door Right | 11,774 | 12,392 | 12,392 | 13,888 | 14,620 |
| CBOW-2S-120D  | 31.25  | 120   | 17.25 | 40" Sliding Door Left/40" Center Open/40" Sliding Door Right | 12,181 | 12,822 | 12,822 | 14,369 | 15,126 |
| CBOW-1SD-60D  | 31.25  | 60    | 19.25 | 30" Sliding Door   | 8,123  | 8,550  | 8,550  | 9,582  | 10,087 |
| CBOW-1SD-66D  | 31.25  | 66    | 19.25 | 33" Sliding Door   | 8,528  | 8,976  | 8,976  | 10,062 | 10,591 |
| CBOW-1SD-72D  | 31.25  | 72    | 19.25 | 36" Sliding Door   | 8,937  | 9,404  | 9,404  | 10,538 | 11,092 |
| CBOW-1SD-78D  | 31.25  | 78    | 19.25 | 39" Sliding Door   | 9,339  | 9,832  | 9,832  | 11,016 | 11,596 |
| CBOW-1SD-84D  | 31.25  | 84    | 19.25 | 42" Sliding Door   | 9,749  | 10,258 | 10,258 | 11,496 | 12,099 |
| CBOW-2SD-90D  | 31.25  | 90    | 19.25 | 30" Sliding Door Left/30" Center Open/30" Sliding Door Right | 10,151 | 10,686 | 10,686 | 11,976 | 12,605 |
| CBOW-2SD-96D  | 31.25  | 96    | 19.25 | 32" Sliding Door Left/32" Center Open/32" Sliding Door Right | 10,555 | 11,110 | 11,110 | 12,453 | 13,107 |
| CBOW-2SD-102D | 31.25  | 102   | 19.25 | 34" Sliding Door Left/34" Center Open/34" Sliding Door Right | 10,965 | 11,540 | 11,540 | 12,933 | 13,612 |
| CBOW-2SD-108D | 31.25  | 108   | 19.25 | 36" Sliding Door Left/36" Center Open/36" Sliding Door Right | 11,365 | 11,966 | 11,966 | 13,410 | 14,116 |
| CBOW-2SD-114D | 31.25  | 114   | 19.25 | 38" Sliding Door Left/38" Center Open/38" Sliding Door Right | 11,774 | 12,392 | 12,392 | 13,888 | 14,620 |
| CBOW-2SD-120D | 31.25  | 120   | 19.25 | 40" Sliding Door Left/40" Center Open/40" Sliding Door Right | 12,181 | 12,822 | 12,822 | 14,369 | 15,126 |



# WALL-MOUNT FULL DOOR OVERHEADS

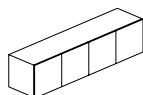

CBOW-F-72S

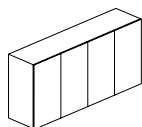

CBOW-F-72D

## SURFACE MATERIAL KEY

|    |                              |
|----|------------------------------|
| S  | All Paint                    |
| VS | Veneer Case with Paint Door  |
| V  | All Veneer                   |
| SG | Painted Case with Glass Door |
| VG | Veneer Case with Glass Door  |

## FULL DOOR

| MODEL #      | HEIGHT | WIDTH | DEPTH | DESCRIPTION | -S     | -VS    | -V     | -SG    | -VG    |
|--------------|--------|-------|-------|-------------|--------|--------|--------|--------|--------|
| CBOW-F-72S   | 17     | 72    | 17.25 | 4 Doors     | 5,883  | 6,192  | 6,192  | 7,234  | 7,614  |
| CBOW-F-90S   | 17     | 90    | 17.25 | 5 Doors     | 6,765  | 7,119  | 7,119  | 8,321  | 8,756  |
| CBOW-F-108S  | 17     | 108   | 17.25 | 6 Doors     | 7,474  | 7,863  | 7,863  | 9,185  | 9,670  |
| CBOW-FD-72S  | 17     | 72    | 19.25 | 4 Doors     | 5,883  | 6,192  | 6,192  | 7,234  | 7,614  |
| CBOW-FD-90S  | 17     | 90    | 19.25 | 5 Doors     | 6,765  | 7,119  | 7,119  | 8,321  | 8,756  |
| CBOW-FD-108S | 17     | 108   | 19.25 | 6 Doors     | 7,474  | 7,863  | 7,863  | 9,185  | 9,670  |
| CBOW-F-72D   | 31.25  | 72    | 17.25 | 4 Doors     | 9,096  | 9,573  | 9,573  | 11,188 | 11,776 |
| CBOW-F-90D   | 31.25  | 90    | 17.25 | 5 Doors     | 10,460 | 11,008 | 11,008 | 12,864 | 13,539 |
| CBOW-F-108D  | 31.25  | 108   | 17.25 | 6 Doors     | 11,548 | 12,157 | 12,157 | 14,201 | 14,951 |
| CBOW-FD-72D  | 31.25  | 72    | 19.25 | 4 Doors     | 9,096  | 9,573  | 9,573  | 11,188 | 11,776 |
| CBOW-FD-90D  | 31.25  | 90    | 19.25 | 5 Doors     | 10,460 | 11,008 | 11,008 | 12,864 | 13,539 |
| CBOW-FD-108D | 31.25  | 108   | 19.25 | 6 Doors     | 11,548 | 12,157 | 12,157 | 14,201 | 14,951 |

## OPTIONS

| OPTIONS                                 | CODE | PRICE        | NOTES |
|---|------|--------------|-------|
| Remove Task Light                       | -NTL | Deduct \$902 |       |
| <b>Satin Glass Options:</b>             |      |              |       |
| Satin glass for Single Height Overheads | -SGS | \$522        |       |
| Satin glass for Double Height Overheads | -SGD | \$695        |       |

## GENERAL INFORMATION

- All overhead storage is wall-mounted
- Grain direction is vertical
- Overhead depth is 17.25" or 19.25", interior depth is 13-1/2" or 15-1/2"
- Overheads are shipped with mounting hardware for attachment to structural wall
- Single Height Overheads can be mounted at the 84" height, there is 21" clearance from the bottom of the overhead to the top of the work surface when work surface is raised to its highest position
- Double Height Overheads cannot be mounted above a height adjustable work surface
- Task lights included but may be removed as an option
- Task lights can dim
- Customers are responsible for ensuring that the structural wall has adequate strength to support the overhead and its contents
- Glass overhead doors are tempered, interior frame on all glass doors is anodized
- Back panel options consist of tackable fabric, magnetic glass, and veneer/paint panel with display shelves. See pages 35-38.
- Wall-Mount Overhead is recommended to be paired with a back panel to conceal gap between overhead and architectural wall
- Shelves within double high overheads are adjustable.

### REQUIRED INFORMATION (ORDER CANNOT BE ENTERED WITHOUT THIS INFORMATION)

See appendix pages vi-vii for surface material options.

- Choose Veneer Finish
- Choose Paint Finish, if applicable
- Choose Glass Finish, if applicable



# 29"-HIGH WALL PANELS

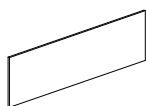

CBTF-2996

## FABRIC TACK PANEL

| MODEL #    | W X H    | PANEL SECTIONS | YARDAGE | COM   | A     | B     | C     | D     | E     | F     | G     | H     |
|------------|----------|----------------|---------|-------|-------|-------|-------|-------|-------|-------|-------|-------|
| CBTF-2960  | 60 x 29  | 1              | 2       | 741   | 940   | 1,032 | 1,142 | 1,240 | 1,343 | 1,441 | 1,542 | 1,590 |
| CBTF-2966  | 66 x 29  | 1              | 2.25    | 790   | 1,009 | 1,127 | 1,240 | 1,353 | 1,468 | 1,582 | 1,694 | 1,741 |
| CBTF-2972  | 72 x 29  | 1              | 2.5     | 832   | 1,077 | 1,210 | 1,333 | 1,461 | 1,584 | 1,713 | 1,835 | 1,882 |
| CBTF-2978  | 78 x 29  | 1              | 2.75    | 874   | 1,154 | 1,289 | 1,426 | 1,568 | 1,709 | 1,846 | 1,981 | 2,032 |
| CBTF-2984  | 84 x 29  | 1              | 3       | 916   | 1,215 | 1,368 | 1,523 | 1,665 | 1,818 | 1,969 | 2,123 | 2,169 |
| CBTF-2990  | 90 x 29  | 1              | 3.25    | 951   | 1,277 | 1,442 | 1,606 | 1,764 | 1,933 | 2,097 | 2,262 | 2,313 |
| CBTF-2996  | 96 x 29  | 1              | 3.5     | 985   | 1,342 | 1,515 | 1,693 | 1,865 | 2,041 | 2,218 | 2,397 | 2,405 |
| CBTF-29102 | 102 x 29 | 2              | 3.75    | 1,021 | 1,401 | 1,590 | 1,775 | 1,965 | 2,153 | 2,339 | 2,534 | 2,580 |
| CBTF-29108 | 108 x 29 | 2              | 4       | 1,050 | 1,455 | 1,654 | 1,857 | 2,057 | 2,261 | 2,459 | 2,659 | 2,707 |
| CBTF-29114 | 114 x 29 | 2              | 4.25    | 1,076 | 1,510 | 1,719 | 1,934 | 2,149 | 2,365 | 2,572 | 2,793 | 2,842 |
| CBTF-29120 | 120 x 29 | 2              | 4.5     | 1,111 | 1,561 | 1,791 | 2,015 | 2,238 | 2,465 | 2,694 | 2,920 | 2,968 |



CBMG-2996

## MAGNETIC GLASS PANEL

| MODEL #    | W X H    | PANEL SECTIONS | GLASS PANEL |
|------------|----------|----------------|-------------|
| CBMG-2960  | 60 x 29  | 1              | 2,443       |
| CBMG-2966  | 66 x 29  | 1              | 2,545       |
| CBMG-2972  | 72 x 29  | 1              | 2,653       |
| CBMG-2978  | 78 x 29  | 1              | 2,763       |
| CBMG-2984  | 84 x 29  | 1              | 2,878       |
| CBMG-2990  | 90 x 29  | 1              | 2,996       |
| CBMG-2996  | 96 x 29  | 1              | 3,121       |
| CBMG-29102 | 102 x 29 | 2              | 3,250       |
| CBMG-29108 | 108 x 29 | 2              | 3,385       |
| CBMG-29114 | 114 x 29 | 2              | 3,526       |
| CBMG-29120 | 120 x 29 | 2              | 3,671       |

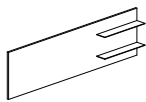

CBPD-2996

### SURFACE MATERIAL KEY

S Painted Panel  
V Veneer Panel

## PANEL WITH DISPLAY SHELVES

| MODEL #        | W X H    | PANEL SECTIONS | -S    | -V    |
|----------------|----------|----------------|-------|-------|
| CBPD-2960-[ ]  | 60 x 29  | 1              | 2,322 | 2,443 |
| CBPD-2966-[ ]  | 66 x 29  | 1              | 2,420 | 2,545 |
| CBPD-2972-[ ]  | 72 x 29  | 1              | 2,518 | 2,653 |
| CBPD-2978-[ ]  | 78 x 29  | 1              | 2,625 | 2,763 |
| CBPD-2984-[ ]  | 84 x 29  | 1              | 2,732 | 2,878 |
| CBPD-2990-[ ]  | 90 x 29  | 1              | 2,845 | 2,996 |
| CBPD-2996-[ ]  | 96 x 29  | 1              | 2,966 | 3,121 |
| CBPD-29102-[ ] | 102 x 29 | 1              | 3,088 | 3,250 |
| CBPD-29108-[ ] | 108 x 29 | 1              | 3,216 | 3,385 |
| CBPD-29114-[ ] | 114 x 29 | 1              | 3,350 | 3,526 |
| CBPD-29120-[ ] | 120 x 29 | 1              | 3,489 | 3,671 |

[ ] Specify Display Shelves Left (-L) or Right (-R)



## 29"-HIGH WALL PANELS

| OPTIONS                                | CODE | NOTES                        |
|--|------|------------------------------|
| <b>Display Shelf Width Options:</b>    |      |                              |
| 24"                                    | -24  | Includes two Display Shelves |
| 30"                                    | -30  | Includes two Display Shelves |
| 36"                                    | -36  | Includes two Display Shelves |
| <b>Display Shelf Material Options:</b> |      |                              |
| Metal                                  | -MDS |                              |
| Glass                                  | -GDS |                              |

### GENERAL INFORMATION

- Fabric tackboards 102" and greater will have an even split two-piece construction
- Glass magnetic boards 102" and greater will have an even split two-piece construction
- Glass magnetic boards are only available in gloss finish options
- Back-painted glass is low-iron glass
- Magnets are included with glass magnetic panels
- 43"-H Tackboard or glass magnetic board should be specified for a single height overhead mounted at 84" height
- 29"-H Tackboard or glass magnetic board should be specified for a double height overhead mounted at 70" height
- See page ix for fabric restrictions
- Metal display shelves are available in clear anodized or powder coat metal finishes
- Display shelves are low-iron glass and available in gloss or satin; no additional upcharge for satin glass display shelf
- Black back-painted glass is only available in satin finish

#### REQUIRED INFORMATION (ORDER CANNOT BE ENTERED WITHOUT THIS INFORMATION)

See appendix pages vi-vii for surface material options.

- Choose Fabric, if applicable
- Choose Glass Finish, if applicable
- Choose Veneer Finish
- Choose Paint Finish, if applicable
- Choose Metal Finish, if applicable



# 43" -HIGH WALL PANELS

BACK PANELS FOR USE WITH SINGLE HIGH OVERHEAD OR SHELF MOUNTED AT 84" HEIGHT

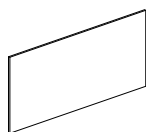

CBTF-4396

## FABRIC TACK PANEL

| MODEL #    | W X H    | PANEL SECTIONS | YARDAGE | COM   | A     | B     | C     | D     | E     | F     | G     | H     |
|------------|----------|----------------|---------|-------|-------|-------|-------|-------|-------|-------|-------|-------|
| CBTF-4360  | 60 x 43  | 1              | 2       | 763   | 965   | 1,062 | 1,171 | 1,276 | 1,383 | 1,481 | 1,585 | 1,638 |
| CBTF-4366  | 66 x 43  | 1              | 2       | 809   | 1,044 | 1,161 | 1,276 | 1,392 | 1,510 | 1,625 | 1,745 | 1,791 |
| CBTF-4372  | 72 x 43  | 1              | 3       | 856   | 1,111 | 1,244 | 1,372 | 1,505 | 1,629 | 1,762 | 1,890 | 1,938 |
| CBTF-4378  | 78 x 43  | 1              | 2.8     | 902   | 1,185 | 1,327 | 1,469 | 1,614 | 1,760 | 1,898 | 2,038 | 2,089 |
| CBTF-4384  | 84 x 43  | 1              | 3.0     | 943   | 1,251 | 1,409 | 1,566 | 1,716 | 1,873 | 2,029 | 2,186 | 2,234 |
| CBTF-4390  | 90 x 43  | 1              | 3.3     | 981   | 1,315 | 1,482 | 1,652 | 1,818 | 1,990 | 2,158 | 2,328 | 2,378 |
| CBTF-4396  | 96 x 43  | 1              | 3.5     | 1,009 | 1,381 | 1,561 | 1,744 | 1,920 | 2,098 | 2,281 | 2,465 | 2,476 |
| CBTF-43102 | 102 x 43 | 2              | 3.8     | 1,049 | 1,442 | 1,638 | 1,826 | 2,019 | 2,214 | 2,407 | 2,608 | 2,657 |
| CBTF-43108 | 108 x 43 | 2              | 4.0     | 1,080 | 1,500 | 1,706 | 1,914 | 2,119 | 2,327 | 2,532 | 2,737 | 2,788 |
| CBTF-43114 | 114 x 43 | 2              | 4.3     | 1,109 | 1,554 | 1,770 | 1,991 | 2,208 | 2,433 | 2,648 | 2,874 | 2,925 |
| CBTF-43120 | 120 x 43 | 2              | 4.5     | 1,143 | 1,605 | 1,843 | 2,073 | 2,306 | 2,537 | 2,771 | 3,004 | 3,053 |

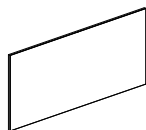

CBMG-4396

## MAGNETIC GLASS PANEL

| MODEL #    | W X H    | PANEL SECTIONS | GLASS PANEL |
|------------|----------|----------------|-------------|
| CBMG-4360  | 60 x 43  | 1              | 3,617       |
| CBMG-4366  | 66 x 43  | 1              | 3,765       |
| CBMG-4372  | 72 x 43  | 1              | 3,924       |
| CBMG-4378  | 78 x 43  | 1              | 4,086       |
| CBMG-4384  | 84 x 43  | 1              | 4,258       |
| CBMG-4390  | 90 x 43  | 1              | 4,434       |
| CBMG-4396  | 96 x 43  | 1              | 4,620       |
| CBMG-43102 | 102 x 43 | 2              | 4,811       |
| CBMG-43108 | 108 x 43 | 2              | 5,013       |
| CBMG-43114 | 114 x 43 | 2              | 5,221       |
| CBMG-43120 | 120 x 43 | 2              | 5,437       |

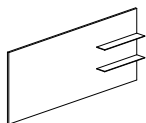

CBPD-4396

## SURFACE MATERIAL KEY

S Painted Panel  
V Veneer Panel

## PANEL WITH DISPLAY SHELVES

| MODEL #        | W X H    | PANEL SECTIONS | -S    | -V    |
|----------------|----------|----------------|-------|-------|
| CBPD-4360-[ ]  | 60 x 43  | 1              | 3,438 | 3,617 |
| CBPD-4366-[ ]  | 66 x 43  | 1              | 3,580 | 3,765 |
| CBPD-4372-[ ]  | 72 x 43  | 1              | 3,726 | 3,924 |
| CBPD-4378-[ ]  | 78 x 43  | 1              | 3,882 | 4,086 |
| CBPD-4384-[ ]  | 84 x 43  | 1              | 4,046 | 4,258 |
| CBPD-4390-[ ]  | 90 x 43  | 1              | 4,212 | 4,434 |
| CBPD-4396-[ ]  | 96 x 43  | 1              | 4,386 | 4,620 |
| CBPD-43102-[ ] | 102 x 43 | 1              | 4,570 | 4,811 |
| CBPD-43108-[ ] | 108 x 43 | 1              | 4,761 | 5,013 |
| CBPD-43114-[ ] | 114 x 43 | 1              | 4,958 | 5,221 |
| CBPD-43120-[ ] | 120 x 43 | 1              | 5,166 | 5,437 |

[ ] Specify Display Shelves Left (-L) or Right (-R)



# 43"-HIGH WALL PANELS

| OPTIONS                                | CODE | NOTES                        |
|--|------|------------------------------|
| <b>Display Shelf Width Options:</b>    |      |                              |
| 24"                                    | -24  | Includes two Display Shelves |
| 30"                                    | -30  | Includes two Display Shelves |
| 36"                                    | -36  | Includes two Display Shelves |
| <b>Display Shelf Material Options:</b> |      |                              |
| Metal                                  | -MDS |                              |
| Glass                                  | -GDS |                              |

## GENERAL INFORMATION

- Fabric tackboards 102" and greater will have an even split two-piece construction
- Glass magnetic boards 102" and greater will have an even split two-piece construction
- Glass magnetic boards are only available in gloss finish options
- Back-painted glass is low-iron glass
- Magnets are included with glass magnetic panels
- 43"-H Tackboard or glass magnetic board should be specified for a single height overhead mounted at 84" height
- 29"-H Tackboard or glass magnetic board should be specified for a double height overhead mounted at 70" height
- See page ix for fabric restrictions
- Metal display shelves are available in clear anodized or powder coat metal finishes
- Display shelves are low-iron glass and available in gloss or satin; no additional upcharge for satin glass display shelf
- Black back-painted glass is only available in satin finish

### REQUIRED INFORMATION (ORDER CANNOT BE ENTERED WITHOUT THIS INFORMATION)

See appendix pages vi-vii for surface material options.

- Choose Fabric, if applicable
- Choose Glass Finish, if applicable
- Choose Veneer Finish
- Choose Paint Finish, if applicable
- Choose Metal Finish, if applicable



# TOWERS



CBTW-18-2470



CBTW-30-1770



CTTW-18-2484



CTTW-36-2484

## SURFACE MATERIAL KEY

|    |                              |
|----|------------------------------|
| S  | All Paint                    |
| VS | Veneer Case with Paint Front |
| V  | All Veneer                   |

## 70"-HIGH TOWERS

| MODEL #  | WIDTH | DEPTH | HEIGHT | DESCRIPTION   | -S    | -VS   | -V    |
|--|-------|-------|--------|---|-------|-------|-------|
| <b>WORK SURFACE DEPTH ALIGNED TOWERS</b>   |       |       |        |   |       |       |       |
| <b>26"D (flush with worksurface edge with tack / overhead)</b>                                 |       |       |        |   |       |       |       |
| CBTW-12-2670-[ ]   | 12    | 26    | 70     | Wardrobe  | 4,166 | 4,383 | 4,383 |
| CBTW-18-2670-[ ]   | 18    | 26    | 70     | Wardrobe  | 4,995 | 5,259 | 5,259 |
| CBTW-36-2670   | 36    | 26    | 70     | Double Door Wardrobe w/ 1 Fixed Shelf and 3 Adj Shelves | 7,492 | 7,887 | 7,887 |
| <b>24"D (flush with worksurface edge without tack / overhead)</b>                              |       |       |        |   |       |       |       |
| CBTW-12-2470-[ ]   | 12    | 24    | 70     | Wardrobe  | 4,166 | 4,383 | 4,383 |
| CBTW-18-2470-[ ]   | 18    | 24    | 70     | Wardrobe  | 4,995 | 5,259 | 5,259 |
| CBTW-36-2470   | 36    | 24    | 70     | Double Door Wardrobe w/ 1 Fixed Shelf and 3 Adj Shelves | 7,492 | 7,887 | 7,887 |
| <b>OVERHEAD DEPTH ALIGNED TOWERS</b>   |       |       |        |   |       |       |       |
| <b>17"D (For use with adjacent 17"D overhead with sliding door)</b>                            |       |       |        |   |       |       |       |
| CBTW-24S-1770[ ]   | 24    | 17    | 70     | Wardrobe  | 5,027 | 5,291 | 5,291 |
| CBTS-30S-1770[ ]   | 30    | 17    | 70     | Double Door Storage w/ 1 Fixed Shelf and 3 Adj Shelves  | 6,030 | 6,349 | 6,349 |
| <b>19"D (For use with adjacent 19" legal depth overhead with sliding door)</b>                 |       |       |        |   |       |       |       |
| CBTW-24S-1970[ ]   | 24    | 19    | 70     | Wardrobe  | 5,027 | 5,291 | 5,291 |
| CBTS-30S-1970[ ]   | 30    | 19    | 70     | Double Door Storage w/ 1 Fixed Shelf and 3 Adj Shelves  | 6,030 | 6,349 | 6,349 |
| <b>17"D (For use with adjacent 17"D overhead with hinged doors or open shelves)</b>            |       |       |        |   |       |       |       |
| CBTW-24H-1770[ ]   | 24    | 17    | 70     | Wardrobe  | 5,027 | 5,291 | 5,291 |
| CBTS-30H-1770[ ]   | 30    | 17    | 70     | Double Door Storage w/ 1 Fixed Shelf and 3 Adj Shelves  | 6,030 | 6,349 | 6,349 |
| <b>19"D (For use with adjacent 19" legal depth overhead with hinged doors or open shelves)</b> |       |       |        |   |       |       |       |
| CBTW-24H-1970[ ]   | 24    | 19    | 70     | Wardrobe  | 5,027 | 5,291 | 5,291 |
| CBTS-30H-1970[ ]   | 30    | 19    | 70     | Double Door Storage w/ 1 Fixed Shelf and 3 Adj Shelves  | 6,030 | 6,349 | 6,349 |

[ ] Specify Left (-L) and Right (-R) support

## 84"-HIGH TOWERS

| MODEL #  | WIDTH | DEPTH | HEIGHT | DESCRIPTION  | -S    | -VS   | -V    |
|--|-------|-------|--------|--|-------|-------|-------|
| <b>WORK SURFACE DEPTH ALIGNED TOWERS</b>   |       |       |        |  |       |       |       |
| <b>26"D (flush with worksurface edge with tack / overhead)</b>                                 |       |       |        |  |       |       |       |
| CBTW-12-2684[ ]  | 12    | 26    | 84     | Wardrobe   | 4,355 | 4,587 | 4,587 |
| CBTW-18-2684[ ]  | 18    | 26    | 84     | Wardrobe   | 5,228 | 5,502 | 5,502 |
| CBTW-36-2684   | 36    | 26    | 84     | Double Door Wardrobe w/ 1 Fixed and 3 Adj Shelves      | 7,839 | 8,250 | 8,250 |
| <b>24"D (flush with worksurface edge without tack / overhead)</b>                              |       |       |        |  |       |       |       |
| CBTW-12-2484[ ]  | 12    | 24    | 84     | Wardrobe   | 4,355 | 4,587 | 4,587 |
| CBTW-18-2484[ ]  | 18    | 24    | 84     | Wardrobe   | 5,228 | 5,502 | 5,502 |
| CBTW-36-2484   | 36    | 24    | 84     | Double Door Wardrobe w/ 1 Fixed and 3 Adj Shelves      | 7,839 | 8,250 | 8,250 |
| <b>OVERHEAD DEPTH ALIGNED TOWERS</b>   |       |       |        |  |       |       |       |
| <b>17"D (For use with adjacent 17"D overhead with sliding door)</b>                            |       |       |        |  |       |       |       |
| CBTW-24S-1784[ ]   | 24    | 17    | 84     | Wardrobe   | 5,257 | 5,534 | 5,534 |
| CBTS-30S-1784[ ]   | 30    | 17    | 84     | Double Door Storage w/ 1 Fixed Shelf and 4 Adj Shelves | 6,308 | 6,641 | 6,641 |
| <b>19"D (For use with adjacent 19" legal depth overhead with sliding door)</b>                 |       |       |        |  |       |       |       |
| CBTW-24S-1984[ ]   | 24    | 19    | 84     | Wardrobe   | 5,257 | 5,534 | 5,534 |
| CBTS-30S-1984[ ]   | 30    | 19    | 84     | Double Door Storage w/ 1 Fixed Shelf and 4 Adj Shelves | 6,308 | 6,641 | 6,641 |
| <b>17"D (For use with adjacent 17"D overhead with hinged doors or open shelves)</b>            |       |       |        |  |       |       |       |
| CBTW-24H-1784[ ]   | 24    | 19    | 84     | Wardrobe   | 5,257 | 5,534 | 5,534 |
| CBTS-30H-1784[ ]   | 30    | 19    | 84     | Double Door Storage w/ 1 Fixed Shelf and 4 Adj Shelves | 6,308 | 6,641 | 6,641 |
| <b>19"D (For use with adjacent 19" legal depth overhead with hinged doors or open shelves)</b> |       |       |        |  |       |       |       |
| CBTW-24H-1984[ ]   | 24    | 19    | 84     | Wardrobe   | 5,257 | 5,534 | 5,534 |
| CBTS-30H-1984[ ]   | 30    | 19    | 84     | Double Door Storage w/ 1 Fixed Shelf and 4 Adj Shelves | 6,308 | 6,641 | 6,641 |

[ ] Specify Left (-L) and Right (-R) support



# TOWERS

| OPTIONS                        | CODE | PRICE | NOTES |
|--------------------------------|------|-------|-------|
| Tower Locks                    | -LO  | \$303 |       |
| Mirror                         | -MR  | \$349 |       |
| Additional Storage Shelves (2) | -SH2 | \$513 |       |

## GENERAL INFORMATION

- Grain direction is vertical
- Towers are standard without locks
- Single Door Towers will have a full height integral pull
- Double Door Towers will have touch latch
- Optional mirror ships uninstalled, with a mounting template
- Freestanding 12"-wide Towers must be fastened to the adjacent case
- Shallow depth 24"-wide Wardrobe Tower 17" and 19" depth include:
  - 1 fixed shelf above wardrobe bar
  - Can accept two sets of optional adjustable shelves
  - Optional adjustable shelves are located at 14" and 27" above bottom panel, with three pre bored holes for adjustment
- Shallow depth 30"-wide Double Door Tower 17" and 19" depth include:
  - 1 fixed shelf 36" above the bottom panel
  - 70"H tower includes three adjustable shelves and can accept one set of optional adjustable shelf
  - 84"H tower includes four adjustable shelves and can accept one set of optional adjustable shelves
  - Side panels of tower are pre bored with 12 locations for optional shelf placement both above and below the fixed shelf
  - Lock option on Double Door Towers includes two locks, one on each door
- Towers 24" and 26" deep include the following:
  - 1 fixed shelf - a hat shelf above the wardrobe bar
  - The 70"H tower has 58" clearance from the wardrobe bar to the bottom panel
  - The 84"H tower has 72" clearance from the wardrobe bar to the bottom panel
  - Double Door Towers will have a center vertical divider panel and include three adjustable shelves located at 41", 28", and 14" above bottom panel, with three pre-bored holes for adjustment
  - Lock option on Double Door Towers includes two locks, one on each door
  - Double Door Tower is universal. The wardrobe and storage shelves are field reversible.

### REQUIRED INFORMATION (ORDER CANNOT BE ENTERED WITHOUT THIS INFORMATION)

See appendix pages vi-vii for surface material options.

- Choose Veneer Finish
- Choose Paint Finish, if applicable





# MEETING TABLES



ROUND

## SURFACE MATERIAL KEY

|    |                               |
|----|-------------------------------|
| PE | Laminate Top with Square Edge |
| V  | Veneer                        |
| G  | Glass                         |

## ROUND TABLE

| MODEL # | DIAMETER | BASE QTY. | TOP SECTIONS | SEATING CAPACITY | -PE   | -V    | -G    |
|---------|----------|-----------|--------------|------------------|-------|-------|-------|
| CBRO-36 | 36       | 1         | 1            | 3                | 3,093 | 3,451 | 5,341 |
| CBRO-42 | 42       | 1         | 1            | 4                | 3,431 | 3,840 | 5,997 |
| CBRO-48 | 48       | 1         | 1            | 5                | 4,241 | 4,759 | 7,492 |
| CBRO-54 | 54       | 1         | 1            | 6                | 5,227 | 5,882 | 9,327 |

## OPTIONS

### CODE

### PRICE

### NOTES

#### Polished Chrome Options:

Polished Chrome Base

-PCX

\$640

#### Satin Glass

-RSG

\$430

## EDGE PROFILE



Laminate with Square Edge



Wood Edge



Glass Edge

## GENERAL INFORMATION

- Veneer tops are 1-1/8" thick with 3/16"-deep hardwood edge band
- Overall table height 29-1/2"
- No power options are available
- Laminate tops are 1-1/8"-thick with 2mm edge
- Tops include a 1-1/8"-thick sub-top with 3/16"-deep hardwood edge band and 1/4"-thick back painted glass
- Metal X base not available in CA clear anodized
- Subtop material on glass tops can be either paint or veneer

### REQUIRED INFORMATION (ORDER CANNOT BE ENTERED WITHOUT THIS INFORMATION)

See appendix pages vi-vii for surface material options.

- Choose Veneer Finish, if applicable
- Choose Metal Finish
- Choose Laminate Finish, if applicable
- Choose Edge Band Finish, if applicable
- Choose Glass Finish, if applicable
- Choose Subtop Finish, if applicable (Paint Finish or Veneer Species)



# ACCESSORIES

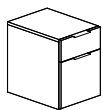

CBFP-BF-1521

## SURFACE MATERIAL KEY

|    |                              |
|----|------------------------------|
| S  | All Paint                    |
| VS | Veneer Case with Paint Front |
| V  | All Veneer                   |

## FREESTANDING STORAGE PEDESTAL

| MODEL #      | DEPTH | WIDTH | DESCRIPTION           | -S    | -VS   | -V    |
|--------------|-------|-------|-----------------------|-------|-------|-------|
| CBFP-BF-1521 | 21    | 15    | Freestanding Box/File | 2,754 | 2,898 | 2,898 |

## OPTIONS

### Pedestal Options:

No Locks (Pedestals)

**-NL**

No Charge

Undermount Soft Close Drawer Slide

**-US**

\$172

### Pull Options:

Integrated Pull

**-IP**

No Charge

Metal Tabl Pull

**-MT**

No Charge

Polished Chrome Pull

**-PCP**

\$219

### Seat Cushion (1-1/2 yds)

COM Fabric

**-SC-COM**

\$455

Grade A

**-SC-A**

\$623

Grade B

**-SC-B**

\$673

Grade C

**-SC-C**

\$769

Grade D

**-SC-D**

\$861

Grade E

**-SC-E**

\$953

Grade F

**-SC-F**

\$1,016

Grade G

**-SC-G**

\$1,110

Grade H

**-SC-H**

\$1,157

## GENERAL INFORMATION

- Grain direction is vertical
- Pencil trays standard within Box Drawer, runs depth of the drawer box
- Face locking standard on all desk pedestals, locks are always located on the right
- Pedestal is standard with white drawer boxes and sidemount self closing drawer slides
- 15"-wide pedestals accommodate side-to-side legal filing

### REQUIRED INFORMATION (ORDER CANNOT BE ENTERED WITHOUT THIS INFORMATION)

See appendix pages vi-vii for surface material options.

- Choose Veneer Finish, if applicable
- Choose Metal Finish, if applicable (Options include Chrome, Clear Anodized, and Powder Coat finishes)
- Choose Paint Finish, if applicable



# ACCESSORIES

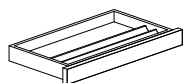

CENTER DRAWER

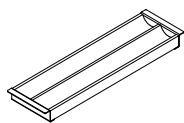

PENCIL TRAY AND DIVIDERS

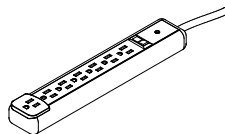

PLUG STRIP

## SURFACE MATERIAL KEY

V Veneer  
P Paint

### CENTER DRAWER

| MODEL # | W x D x H   | -V  | -P  |
|---------|-------------|-----|-----|
| CD-200  | 20 x 12 x 2 | 953 | 906 |

#### GENERAL INFORMATION

- The drawer box is white melamine.

### PENCIL TRAY AND DIVIDERS

| MODEL # | W x D x H     | DESCRIPTION                                      | PRICE |
|---------|---------------|--|-------|
| PT-15   | 13 x 4.25 x 1 | For use with Freestanding Pedestal               | 145   |
| PT-18   | 16 x 4.25 x 1 | For use with Pedestals supporting a work surface | 167   |

#### GENERAL INFORMATION

- Pencil Trays rest on the edge of the drawer box and are positioned front to back

### PLUG STRIP

| MODEL # | W x D x H           | DESCRIPTION            | PRICE |
|---------|---------------------|------------------------|-------|
| MOA-10  | 2.05 x 11.69 x 1.32 | Black Power Plug Strip | 201   |

#### GENERAL INFORMATION

- 15 amps - Mounts into Wire Trough
- Includes (7) outlets, surge protection and 12' electrical cord



# POWER AND DATA OPTIONS

| POWER SPEC   | MODEL #  | DESCRIPTION                            | PRICE |
|--|----------|--|-------|
| <br>PWR-R-W | PWR-R-B  | Round Power Spec with Black Faceplate  | 128   |
|  | PWR-R-W  | Round Power Spec with White Faceplate  | 128   |
|  | PWR-SQ-B | Square Power Spec with Black Faceplate | 128   |
|  | PWR-SQ-W | Square Power Spec with White Faceplate | 128   |



PWR-R-W



PWR-SQ-W

## GENERAL INFORMATION

- Includes one simplex receptable
- 12' cord

### REQUIRED INFORMATION: (ORDER CANNOT BE ENTERED WITHOUT THIS INFORMATION)

See appendix pages vi-vii for surface material options.

- Choose Metal Finish: Satin Nickel (SNB) or Chrome (CB)
- Work surface must be specified with Spec location code to include cutout that accepts Spec unit

| USB SPEC  | MODEL #   | DESCRIPTION                           | PRICE |
|---|-----------|---------------------------------------|-------|
| <br>USBC-R-W | USBC-R-B  | Round Data Spec with Black Faceplate  | 267   |
|   | USBC-R-W  | Round Data Spec with White Faceplate  | 267   |
|   | USBC-SQ-B | Square Data Spec with Black Faceplate | 267   |
|   | USBC-SQ-W | Square Data Spec with White Faceplate | 267   |



USBC-R-W



USBC-SQ-W

## GENERAL INFORMATION

- Includes one charging USB-A+C
- 12' cord

### REQUIRED INFORMATION: (ORDER CANNOT BE ENTERED WITHOUT THIS INFORMATION)

See appendix pages vi-vii for surface material options.

- Choose Metal Finish: Satin Nickel (SNB) or Chrome (CB)
- Work surface must be specified with Spec location code to include cutout that accepts Spec unit

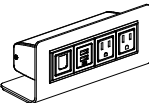
| TECH ZONE   | MODEL #    | DESCRIPTION   | SIMPLEX OUTLETS | OPEN DATA PORTS | CHARGING USB-A+C | PRICE |
|---|------------|---|-----------------|-----------------|------------------|-------|
| <br>ZONE-USB-C | ZONE-DATA  | (2) Simplex receptacles, (2) Open data ports                      | 2               | 2               | -                | 375   |
|   | ZONE-USB-C | (2) Simplex receptacles, (1) Charging USB-A+C, (1) Open data port | 2               | 1               | 1                | 449   |

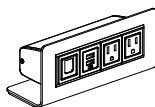

ZONE-USB-C



ZONE-DATA

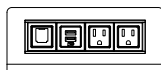

ZONE-USB-C

## GENERAL INFORMATION

- 72" long plug-in infeed cord
- Finish is black
- Includes a Voice/Data Adapter Kit to accept couplers and jacks when required



# Appendix

---



This price book supercedes all previous versions.

**Before placing your order, confirm you have all required information necessary. Lead times for orders begin after all required information is included and correct.**

## Delivery Information

We know lead times are important and sticking to them even more so. We work to maintain a 6-8 week lead time on all standard products in this book from receipt of a clean order. All orders are acknowledged with an approximate shipping date and will be invoiced with the price in effect at the date the purchase order is received. For current lead times, please review [www.nucraft.com/resources/lead-times](http://www.nucraft.com/resources/lead-times).

Shipping charges are prepaid (within the continental U.S.). Therefore, pricing is a delivered price based on normal ground transportation. If you have special instructions, need to ship by air, or are shipping to Alaska or Hawaii, contact NuCraft Customer Service. NuCraft can also help arrange to have products blanket wrapped for an additional charge. Contact the NuCraft Customer Service team or specify it on your purchase order.

**Minimum Freight Charge: Any order below \$3,000 net will be assessed a \$500 net minimum freight charge (one per order).**

Orders are subject to acquiring the materials required for manufacturing. Fulfillment can be affected by strikes, fires, embargoes and acts of government. These elements are beyond our control.

NuCraft offers a variety of services to accommodate a wide range of delivery requirements. Availability of these services is dependent on a number of factors and may not be offered with all shipments. Examples of delivery services that have additional fees include:

- Specific date
- Specific time of day, morning or afternoon
- Delivery to a warehouse before delivery to its final destination (unless product is picked up at the warehouse)

Contact the NuCraft Customer Service team for availability and pricing on these services.

## Freight Terms

Shipping charges for NuCraft products are prepaid for standard delivery in the continental United States. Standard delivery is defined as follows: Product is delivered on a 53' trailer being pulled by a long-haul tractor (total length of 85'). Facility will receive delivery Monday through Friday between the hours of 8:00 AM and 4:00 PM. Facility has docks with levelers and a fork truck for unloading. Product will be loaded on load bars two levels high. Receiving facility is responsible to have personnel on hand to unload the truck upon arrival, drivers do not unload. Delivery sites or times that do not meet these criteria may be accommodated, but will incur a charge to cover additional shipping costs. Please **notify NuCraft a minimum of two weeks prior to shipment** to arrange special services and determine additional charges.

## Storage

NuCraft has no storage facilities for finished product. If a customer cannot accept an order when it is ready for shipment, the customer must designate an alternative shipping address. If no address is provided, NuCraft may, at its discretion, transfer the product to storage. If product is transferred to an off-site storage facility, the customer may be charged for transportation to the facility and for any associated storage fees. NuCraft considers transfer of the product to a storage facility the equivalent of shipment, including invoicing and payment. Customers assume the risk of damage or loss during storage.

## Transportation Times and Delays

Third party carriers that NuCraft contracts with will make reasonable efforts to accommodate requested delivery times and dates. Scheduled delivery appointments may, however, be delayed for a variety of reasons, including inclement weather, traffic, transportation equipment problems, and delays encountered at other delivery locations along the delivery route. NuCraft does not recommend scheduling activities that depend on the delivery appointment (for example, scheduling furniture installers to install furniture the day of the delivery appointment). NuCraft shall not be liable for any costs incurred as a result of a missed delivery appointment.

## Shipment Damage Claims

Legal title to merchandise passes to the buyer upon acceptance by the carrier. Inspect all cartons upon delivery. Details of visible damage should be noted on the delivery receipt. Do not destroy packaging, transport to site, or install product if damage is found upon inspection. Inspection of products should be completed upon delivery to the receiver. If visible damage is apparent, a claim should be filed immediately with NuCraft Customer Service. If visible damage is not apparent, sign the delivery receipt "No visible damage." This will allow recourse for a concealed damage claim. Concealed damage claims must be filed within 15 days of receipt, **prior to transporting or installing any product.**

Do not destroy packing materials until shipment has been inspected. If damage is found, proceed to file a claim with NuCraft Customer Service.

**Failure to make any claims against NuCraft within 15 days shall constitute acceptance of the merchandise and a waiver of any defects, errors or shortages discovered upon inspection.**

## Cancellations

Cancellations must be reviewed by our Customer Service team. Because we build your products to order, orders cannot be cancelled once processing has begun. Processing includes but is not limited to development of shop drawings and other engineering drawings. If cancellation is approved, a processing fee of 20-100% will be assessed based on the status of the order.

## Change Order Policy

NuCraft will make every attempt to honor any reasonable change request to product provided that the request is received prior to start of production. Change orders will be accepted only if the request is made in writing and received in time to make the change. NuCraft reserves the right to increase our acknowledged price and ship date if necessary to make the requested changes. Please submit any change order request to our Customer Service team. NuCraft will assess charges to the customer as stipulated in the following:

- Standard Orders: Change orders received prior to production will be charged \$400 net to cover administrative costs.
- Special Orders: Change orders received prior to production will be charged \$400 net to cover administrative costs. There may be additional costs associated with engineering labor required for the change order.
- Change orders received after production must be evaluated by NuCraft. If approved, the charge will be \$400 net plus any restocking charges accumulated. There may be additional costs associated with engineering and/or manufacturing labor, as well as material costs, required for the change order.



## Repair Authorization

Prior written approval is required for repairs of merchandise charged to NuCraft. Failure to do so will result in customer funded repairs.

## Payment Terms

Deposits are required at the time of order due to the custom nature of our products. See information regarding Cancellations above.

Credit terms are available to qualified customers. Please contact AR@NuCraft.com to start the application process. Note that the credit application process requires a valid sales tax exemption or resale tax certificate, Form W-9, and three current trade references.

Credit Card Payments are accepted via web portal. Please contact AR@NuCraft.com for payment instructions. Note that a 2% convenience fee will be added for using this payment method and no early pay discounts are allowed on credit card payments.

## Warranty

NuCraft Furniture is warranted to be free from defects in materials and workmanship for a period of ten years of single shift use. Limitations include:

- Mechanical Devices such as latches, casters, and other moving components are warranted for five years of the date of original delivery.
- Height adjustable components are warranted for two years of the date of original delivery.
- The following are warranted for one year of the date of original delivery:
  - Textiles
  - Electrical Components
  - Refrigeration Units
  - Custom Products not described in NuCraft's Catalogue

This warranty is applicable only if furniture is properly installed and maintained in an office environment. This warranty extends only to products manufactured and sold in North America and only to original purchasers acquiring new NuCraft product through authorized dealers or approved sellers.

During this warranty period, NuCraft's sole obligation is to repair or replace, at NuCraft's discretion, products which prove to be defective during the warranty period.

This warranty does not cover:

- Damage caused by a carrier.
- Damage from user modification, misuse, abuse, accident, or negligence.
- Customer's Own Material (COM) specified by the customer that is not a standard product offering.
- Color, grain, or texture of wood and other covering material.

**NuCraft extends no other warranties, expressed or implied, including warranty of merchantability or fitness for a particular purpose. NuCraft shall not be liable for loss of time, inconvenience, commercial loss, incidental or consequential damages.**

## Environmental Statement

NuCraft is committed to supporting responsible environmental policies and practices in all that we do. We strive for sustainability, weighing our business decisions against the costs to the ecological, social and economic systems they affect.

Our products are manufactured to meet the credit requirements of the U.S. Green Building Council's LEED rating systems in one or more of the following categories:

- Recycled Content
- Certified Wood
- Low-Emitting Materials

## Computer Aided Planning

NuCraft products and pricing are available via CET and 2020 Worksheet, an AutoCAD®-based space planning tool.

2020 Worksheet is an integrated software system developed specifically for interior designers and facility planners to enhance workplace performance. This modern suite of applications works together seamlessly, in concert. Navigate catalogs, select products, design in plan view and 3D, assign options, create worksheets and build a project where you want, when you want. Take your pick. It's dynamic and interactive. Design projects are a work in progress. And now you can perform any of the many discrete tasks that go into a project any time, any place.

Product symbols (Revit, 2D and 3D) are available on the NuCraft website at [www.nucraft.com/resources/designer-tools/product-symbols](http://www.nucraft.com/resources/designer-tools/product-symbols).

## iSpec®

NuCraft offers a free online product configuration and specification service that saves you time and allows you to be creative while leaving the nuts and bolts to someone else. No specific software is required, nor is there any learning curve. This service applies to all NuCraft products. For additional information, visit [www.nucraft.com/resources/designer-tools/ispec](http://www.nucraft.com/resources/designer-tools/ispec).



## Surface Materials Palette

We crafted our materials palette using the same demanding standards that distinguish our furniture. Thoughtful design and attention to every detail elevate your possibilities.

Anchored by NuCraft veneers, unrivaled for clarity, quality, and depth of finish, our collection of surface materials comprises a sophisticated set of balanced elements that supports your design vision.

Some elements have their roots in NuCraft's rich heritage. Others are new materials and reflect current trends and taste. Together, they ensure that you're ready for today and positioned well for the future. Beautifully.

## Custom Finishes

NuCraft specializes in expert custom finish matching. For a nominal upcharge we can provide custom finishes, and we are frequently asked to match the finishes of other furniture manufacturers. For finishes that appear unusual to match or for customers directly requesting a sample, a finish sample will be sent for approval prior to entering the order.

Custom finishes requiring colored varnishes to create a painted look can only be applied to Maple veneer and require one extra week in addition to the standard lead time. NuCraft's standard black finish (G82) can be applied to all NuCraft standard veneers. Walnut is the standard black veneer. Other species must be specified when ordering.

Clear coat on a special veneer requires an approved sample.

Custom finishes carry a 10% upcharge per item, per finish, capped at \$2,200 List.

Custom finish upcharges are not applied to any item that is not wood. Example: casters, ganging connectors, power options.

## Treatments

**Note: Default veneer sheen will vary per finish and product. Default finish is bolded on pages vi-vii. If no direction is provided on incoming orders, default sheen will be selected. In addition, default veneer cut is noted in the price list. If no direction is provided on incoming orders, default cut will be selected.**

**Gloss:** Gloss is a durable finish that tends to nicely mask normal wear and leaves wood grain visible to the eye. It achieves a medium gloss open pore appearance (40 – 50 sheen range). Finish numbers preceded by the letter "G" indicate a Gloss finish.

**Matte:** Like Gloss, Matte is durable, tends to nicely mask normal wear and leaves wood grain visible to the eye. It achieves a low luster, open pore appearance (10 – 20 sheen range). Finish numbers preceded by the letter "M" indicate a Matte finish.

Since each veneer type responds differently to both types of treatment, all will have a distinctive look and feel when finished. For example, a Walnut veneer with a Gloss treatment will remain much more textured than a Cherry veneer with the same treatment.

## About the Wood

All NuCraft veneers are carefully selected for uniformity of color and grain. Still, wood is a natural substance and minor variations may occur due to its own uniqueness. Because of this, the furniture you receive may not be an exact match to our samples.

NuCraft takes great pride in our finish color consistency. However, wood is a natural product that will have color variation within a single piece of furniture, as well as from one piece to the next. Other factors also affect color over time, such as exposure to light (both intensity and duration). For example, lighter finishes cause more variation in colors over time.

In cases where a returning customer wants a precise match with existing furniture, we recommend sending a sample of the existing furniture finish. Please contact NuCraft Customer Service to determine an appropriate sample. This will ensure a finish match between old and new orders. This type of order is considered a control sample. There will be a 10% upcharge on an order of this type. Due to natural aging of veneers, natural finishes may vary.

## Care and Maintenance of Wood Finishes

Our finish material is a crystal clear, urethane acrylic blend. This type of finish may be repaired in the field by a qualified refinisher.

NuCraft recommends using a damp cloth to clean your fine wood furniture. Always wipe with the grain of the wood. Should your wood furniture require a more thorough cleaning, we recommend using a mild cleaner such as Joy dish soap or Murphy's oil soap, thoroughly diluted in water (one part soap to thirty parts water). Water will not damage NuCraft's finish, but it may leave surface spots when it dries. To avoid this, dry the surface with a soft cloth after it is cleaned. Marks that cannot be removed with the cleaning methods above may be able to be removed using naphtha, a mild degreasing solvent.

Caution: while the use of polishes that contain wax, petroleum solvents or silicones may immediately enhance the "shine" of a product, it may also eventually remove the fine original finish applied in our factory. Silicone on the surface of wood may also make it very difficult to respray or refinish.

All NuCraft furniture is inspected and polished before it leaves our factory. In some instances, the packing materials may imprint on the factory polish. Cleaning and polishing the furniture once it is unpacked will normally restore the furniture to its original beauty.

In some cases, the rubber support feet used on the bottom of common office equipment (teleconferencing phones, laptops, microphones, copiers, etc.) can create unsightly marks in the surface of wood tops, due to oxidation of the lacquer finish. We suggest these machines be placed on a protective type of padding, such as felt.

Wood will fade as a result of exposure to UV light. This is particularly prevalent with light finishes. If color changes due to fading are a concern for your application, the impact can be minimized by selecting medium to dark stains for your wood surfaces. Our top coat includes a UV inhibitor which makes the finishes less prone to fading.





## Laminates

Selected Formica®, Nevamar®, and Wilsonart® laminates are available on Training Tables, Conference Tables, Conference Room Furniture and select Occasional Tables. For standard laminate and wood pricing, refer to individual item pricing columns. It is important to note that wood grain laminates are unable to be grain matched over multi-piece table top applications.

## Non-Standard Laminates and Linoleums

To order a color other than those on our list (see pages vi-vii), refer to Nevamar or Formica standard grade, matte texture laminate offerings and Forbo Furniture Linoleums (excluding manufacturers' non-standard matte offering).

Nucraft can support other laminate and linoleum options beyond what can be found as standard options on pages vi-viii. For pricing, please send a request to [quotes@nucraft.com](mailto:quotes@nucraft.com).

## Care and Maintenance of Laminate and Novawrap

Laminate and Novawrap surfaces may be cleaned with a damp cloth and ordinary soap or non-abrasive household liquid detergent. Dry the surface with a clean cloth or soft paper towel to prevent streaks from appearing.

## Care and Maintenance of Metal

Metal surfaces can be wiped with a damp cloth and rubbed dry. A mild non-abrasive household liquid detergent can be used if necessary. Regular maintenance of metal components, including tightening of fasteners and light lubrication of moving parts, will extend the life of your furniture.

## Satin Etched Glass

Glass color may vary slightly on multi-piece conference table tops over 180" x 60" when satin etched glass is specified due to the iron content and etching process of the glass.

## Care and Maintenance of Glass

Clear or frosted glass may be cleaned with commercial glass cleaner. Be sure to use a lint-free cloth if cleaning the frosted side of the glass.

## Stone and Solid Surface Material

Despite its reputation for durability, natural stone can easily be broken during handling and/or installation if proper techniques are not followed. In addition, Nucraft is not responsible for the installation of natural stone or solid surface materials on its products. Therefore, installers specifically trained in the installation of these materials must be utilized to ensure a quality installation. Nucraft shall not be liable for any damages incurred during the handling and/or installation of natural stone or solid surface materials on its products.

## Care and Maintenance of Granite

Granite surfaces may be cleaned with a damp cloth and ordinary soap or non-abrasive household liquid detergent. Dry the surface with a clean cloth or soft paper towel to prevent streaks from appearing.

## Care and Maintenance of Leather

Genuine leather requires very little care. Nucraft recommends that leather be dusted regularly. If a more thorough cleaning is needed, use lukewarm water and a mild, non-abrasive soap. Generate some lather and lightly rub the surface with cheesecloth. Rinse off any soap film with clean water and towel dry. The leather may dry dull. To restore the leather to a normal gloss, rub it with a clean towel. Never use furniture polish, oil, varnish or ammonia. Saddle soap may be used to prevent the leather from becoming brittle or cracked and to maintain the original supple finish.

## Touch Up Finish Kits

| Model # | Description | Price |
|---------|-------------|-------|
| KIT-M   | Metal Kit   | 85    |
| KIT-P   | Paint Kit   | 85    |
| KIT-S   | Stain Kit   | 85    |

## REQUIRED INFORMATION:

### (ORDER CANNOT BE ENTERED WITHOUT THIS INFORMATION)

- Kit model number
- Quantity of kits
- Specify finish (See pages vi-vii)

## General Information:

- Touch-up kits must be ordered on a purchase order separate from Nucraft product due to Hazmat shipping

## Retrofit & Replacements

If needing a partial placement or retrofit solution, please reach out to our quote team. Grain/color matched in a set.



## VENEER

### STANDARD

Default veneer sheen will vary per finish and were determined by a team of experts who reviewed the colorways to determine if gloss or matte best highlighted the natural characteristics of the species of wood and the color of the stain. Default finish is bolded. If no direction is provided, default sheen will be selected.

|                     | Matte        | Gloss      |
|---------------------|--------------|------------|
| <b>Rift Cut Oak</b> |              |            |
| Carbon              | M03          | <b>G03</b> |
| <b>Flat Cut Oak</b> |              |            |
| Artisan             | <b>M68</b>   | G68        |
| Coco                | <b>M67</b>   | G67        |
| Dove                | <b>M66</b>   | G66        |
| Dune                | <b>M05</b>   | G05        |
| Midnight            | <b>M69</b>   | G69        |
| Portobello          | <b>M7413</b> | G7413      |
| Winter              | <b>M70</b>   | G70        |
| <b>Flaky Oak</b>    |              |            |
| Sahara              | <b>M61</b>   | G61        |
| <b>Cherry</b>       |              |            |
| Auburn              | M93          | <b>G93</b> |
| Cognac              | M21          | <b>G21</b> |
| <b>Walnut</b>       |              |            |
| Marron              | <b>M35</b>   | G35        |
| Mocha               | <b>M33</b>   | G33        |
| Onyx                | M82          | <b>G82</b> |
| Otter               | M31          | <b>G31</b> |
| Zinc                | M30          | <b>G30</b> |
| <b>Maple</b>        |              |            |
| Natural Maple       | M60          | <b>G60</b> |
| <b>Linea</b>        |              |            |
| Euro Birch Linea    | <b>M09</b>   | G09        |
| Oak Linea           | <b>M08</b>   | G08        |
| Silver Birch Linea  | M10          | <b>G10</b> |
| Walnut Linea        | <b>M27</b>   | G27        |
| <b>Paldao</b>       |              |            |
| Canyon              | M77          | <b>G77</b> |
| Paldao              | <b>M76</b>   | G76        |
| Thicket             | <b>M75</b>   | G75        |

## LAMINATE

Coordinating wood finish and edgeband options listed below.

|                            |         | Solid Edge Band |                     |
|----------------------------|---------|-----------------|---------------------|
| Solid Laminates            |         |                 |                     |
| Formica Brite White        | 459-58  |                 | R01                 |
| Formica Dover White        | 7197-58 |                 | R01                 |
| Formica Folkstone          | 927-58  |                 | R03                 |
| Formica Graphite           | 837-58  |                 | R05                 |
| Formica Graystone          | 464-58  |                 | R02                 |
| Formica Pearl              | 934-58  |                 | R02                 |
| Patterned Laminates        |         |                 |                     |
| Nevamar Calm Distinction   | VA6001T |                 | R05                 |
| Nevamar Cool Chic          | VA7002T |                 | R02                 |
| Nevamar Easy Elegance      | VA5002T |                 | R05                 |
| Nevamar Serene Stardom     | VA5001T |                 | R05                 |
| Wilsonart Sheer Mesh       | 4876-38 |                 | R02                 |
| Wilsonart Grey Mesh        | 4877-38 |                 | R02                 |
| Wilsonart Pewter Mesh      | 4878-38 |                 | R05                 |
|                            |         | Wood Finish     | Woodgrain Edge Band |
| Wood Grain Laminates       |         |                 |                     |
| Formica Aged Ash           | 8844-58 | M8844           | R8844               |
| Formica Blackened Legno    | 8848-58 | M8848           | R8848               |
| Formica Bleached Legno     | 8845-58 | M8845           | R8845               |
| Formica Chestnut Woodline  | 5884-58 | M5884           | R5884               |
| Formica Espresso Pear      | 5489-58 | M5489           | R5489               |
| Formica Natural Ash        | 8843-58 | M8843           | R8843               |
| Formica Oiled Legno        | 8846-58 | M8846           | R8846               |
| Formica Pecan Woodline     | 5883-58 | M5883           | R5883               |
| Formica Planked Coffee Oak | 7413-58 | M7413           | F7413               |
| Formica Sand Maple         | 9237-58 | G60             | W7909               |
| Formica Smoky Brown Pear   | 5488-58 | M5488           | R5488               |
| Formica Thermo Walnut      | 6402-58 | M6402           | R6402               |
| Formica Urban Planked Oak  | 9312-58 | M9312           | R9312               |
| Formica Weathered Ash      | 8842-58 | M8842           | R8842               |
| Formica White Ash          | 8841-58 | M8841           | R8841               |

## GLASS

|                             | <b>Satin</b> | <b>Gloss</b> |
|-----------------------------|--------------|--------------|
| <b>Satin or Gloss Glass</b> |              |              |
| Black                       | BS           | -            |
| Clove                       | VS           | VG           |
| Meringue                    | MS           | MG           |
| Moonlight                   | MLS          | MLG          |
| Storm                       | STS          | STG          |
| Quill                       | QS           | QG           |
| White                       | WS           | WG           |



## METAL

---

### Powder Coat

|              |       |
|--------------|-------|
| Aged Bronze  | A8010 |
| Black        | A44   |
| Burnished    | A8009 |
| Cloud        | A8004 |
| Foil         | A8006 |
| Galaxy       | A8007 |
| Moonlight    | A87   |
| Satin Bronze | A8011 |
| Shadow       | A8005 |
| Storm        | A8012 |

### Metal

|                 |    |
|-----------------|----|
| Clear Anodized* | CA |
|-----------------|----|

\*Available on overhead metal shelf only.

## PAINT

---

|              |       |
|--------------|-------|
| Aged Bronze  | S8010 |
| Black        | S44   |
| Burnished    | S88   |
| Cloud        | S8004 |
| Foil         | S8006 |
| Galaxy       | S8007 |
| Moonlight    | S87   |
| Satin Bronze | S8011 |
| Shadow       | S8005 |
| Storm        | S8012 |

### Paint to Match

To request a custom paint color, contact Nucraft Customer Service.

A paint sample must be matched and approved prior to order.

## EDGE BAND

---

|           |     |
|-----------|-----|
| Ashen     | R04 |
| Parchment | R02 |
| Shale     | R05 |
| Stone     | R03 |
| Whitecap  | R01 |

# UPHOLSTERY FABRIC



Applies to Pedestal Cushions.

Nucraft is pleased to partner with KnollTextiles, Kvadrat, Spinneybeck, and UltraFabrics to offer a concise selection of standard upholstery fabrics pre-approved for use on our products, with prices that are figured into our graded-in system. We've carefully curated a selection of each of the textile's color lines to coordinate with our materials offering. However, all colorways are approved and available as standard. Please contact fabric manufacturer for sampling support.

## Knoll Hourglass\* | K1523 | Grade B

|          |    |
|----------|----|
| Aegean   | 18 |
| Alley    | 27 |
| Bark     | 21 |
| Beeswax  | 6  |
| Bluebird | 13 |
| Flax     | 5  |
| Gull     | 2  |
| Misty    | 24 |
| Sandbar  | 3  |
| Sizzle   | 9  |
| Spring   | 16 |
| Tart     | 11 |

## UltraFabrics Brisa Original | 533 | Grade C

|                |      |
|----------------|------|
| Abyss          | 9378 |
| Apple Green    | 4448 |
| Ash            | 5802 |
| Aztec          | 3823 |
| Bark           | 3914 |
| Beet Root      | 1361 |
| Birch          | 3019 |
| Black Onyx     | 5749 |
| Blue Sea       | 2621 |
| Bone           | 3822 |
| Cabernet       | 9400 |
| Cambridge Blue | 2645 |
| Canyon         | 3825 |
| Caramel        | 3591 |
| Celery         | 4510 |
| Cinnabar       | 8245 |
| Clear Quartz   | 6528 |
| Coffee Bean    | 3023 |
| Cream          | 3863 |
| Desert Clay    | 3864 |
| Esmeralda      | 4302 |
| Evening Blue   | 2620 |
| Ginger         | 3051 |
| Harbor Mist    | 2793 |
| Hazey          | 5360 |
| Honeydew       | 4345 |

|               |      |
|---------------|------|
| Ice Pink      | 6596 |
| Iceberg       | 3272 |
| Indigo        | 2683 |
| Koi           | 8202 |
| Lambs Ear     | 4361 |
| Mineral       | 2697 |
| Moon          | 3277 |
| Mystic Beige  | 3775 |
| New Sand      | 3946 |
| Night Navy    | 2694 |
| Olive         | 4488 |
| Peat          | 3200 |
| Pompeian Red  | 1383 |
| Putty         | 3915 |
| Quicksilver   | 5820 |
| Rising Tide   | 2794 |
| Rose Red      | 1344 |
| Sage          | 4487 |
| Salsa         | 1373 |
| Seaweed       | 4303 |
| Shiitake      | 3022 |
| Skyway        | 2696 |
| Sterling Blue | 2698 |
| Truffle       | 3913 |
| White         | 5747 |
| Wishbone      | 3276 |
| Wrought Iron  | 5703 |
| Yukon Gold    | 8269 |

## Knoll Hopsack\* | K1206 | Grade C

|         |    |
|---------|----|
| Admiral | 11 |
| Black   | 16 |
| Buff    | 1  |
| Lime    | 4  |
| Magenta | 9  |
| Putty   | 13 |
| Red     | 10 |
| Stucco  | 2  |

## Knoll Felt\* | K1207 | Grade D

|        |    |
|--------|----|
| Apple  | 3  |
| Cadet  | 11 |
| Canary | 5  |
| Ivory  | 1  |
| Mocha  | 15 |
| Pewter | 17 |
| Poppy  | 7  |
| Tar    | 20 |

\*In addition to being available on all of our Pedestal cushion applications, these upholstery fabrics are approved for tackzone application and drawer bottoms on Nucraft products.



## LEATHER

### Spinneybeck Vincenza | VZ | Grade E

|                          |      |
|--------------------------|------|
| Appia Antica             | 2120 |
| Black                    | BLCK |
| Castello di Bellaguardia | 2112 |
| Cinque Terre             | 2122 |
| Costozza                 | 2116 |
| Peralolo                 | 2115 |
| Ponte Furo               | 2102 |
| Nocciola                 | 2117 |
| Salvi                    | 2101 |
| Scamozzi                 | 2114 |
| Villabalzana             | 2108 |

### Spinneybeck Volo | VO | Grade F

|             |      |
|-------------|------|
| Black       | BLCK |
| Casablanca  | 975  |
| Dromedary   | 977  |
| Lichen      | 902  |
| Mauve Beige | 954  |
| Oatmeal     | 957  |
| Parchment   | 960  |
| Petroglyph  | 962  |
| Rust        | 905  |
| Talc        | 939  |
| Tuscany     | 963  |

## GRADED-IN FABRIC PROGRAM

Top quality upholstery and fabrics have been graded into the price lists. We work with various distributors and now offer a larger selection of fabrics. For fabric grades and availability, check our website at [www.nucraft.com](http://www.nucraft.com).

| NET PRICE PER YARD  | NUCRAFT GRADE |
|---------------------|---------------|
| \$0 - \$30.00       | A             |
| \$30.01 - \$45.00   | B             |
| \$45.01 - \$60.00   | C             |
| \$60.01 - \$75.00   | D             |
| \$75.01 - \$90.00   | E             |
| \$90.01 - \$105.00  | F             |
| \$105.01 - \$120.00 | G             |
| \$120.01 - \$135.00 | H             |

\$135.00 and above: Contact Nucraft Customer Service



Nucraft is pleased to have partnered with KnollTextiles to offer a concise selection of standard fabrics pre-approved for use on our products, with prices that are figured into our graded-in system. We've carefully curated a selection of each of the textile's color lines to coordinate with our materials offering. However, all colorways are approved and available as standard. Please contact fabric manufacturer for sampling support.

All tackzone fabrics are applied railroaded.

## KnollTextiles Beacon | W1597 | Grade A

|           |    |
|-----------|----|
| Bonfire   | 7  |
| Cool Gray | 11 |
| Dust      | 12 |
| Fossil    | 3  |
| Hotshot   | 6  |
| Marsh     | 4  |
| Nile      | 9  |
| potlight  | 1  |
| Putty     | 10 |
| Reef      | 8  |
| Saffron   | 5  |
| Tusk      | 2  |

## KnollTextiles Reflect | W884 | Grade B

|           |     |
|-----------|-----|
| Ecru      | 5A  |
| Ember     | 9A  |
| Ice       | 1A  |
| Lagoon    | 14A |
| Sharkskin | 13A |
| Sterling* | 3A  |
| Target    | 10A |
| Titanium  | 2A  |

\*Default Fabric

## GRADED-IN FABRIC PROGRAM

Top quality upholstery and fabrics have been graded into the price lists. We work with various distributors and now offer a larger selection of fabrics. For fabric grades and availability, check our website at [www.nucraft.com](http://www.nucraft.com).

| NET PRICE PER YARD  | NUCRAFT GRADE |
|---------------------|---------------|
| \$0 - \$30.00       | A             |
| \$30.01 - \$45.00   | B             |
| \$45.01 - \$60.00   | C             |
| \$60.01 - \$75.00   | D             |
| \$75.01 - \$90.00   | E             |
| \$90.01 - \$105.00  | F             |
| \$105.01 - \$120.00 | G             |
| \$120.01 - \$135.00 | H             |

\$135.00 and above: Contact Nucraft Customer Service



## For COM orders please include the following:

- Name of customer
- Customer's purchase order number
- Model number and quantity of piece(s) to be covered
- Specify right-way or railroad application (railroad is the default if no selection is made)
- If fabric is a stripe or pattern, specify vertical or horizontal application
- Supplier's name, material number and description

## YARDAGE ESTIMATING

All yardages in the price list are based on 54" wide plain (no match) fabric. The following is a guide for fabrics that are less than 54" wide or have a pattern match.

### Fabric Less Than 54" Wide

For 50" wide fabrics allow 10% additional fabric

For 48" wide fabrics allow 15% additional fabric

For 45" wide fabrics allow 20% additional fabric

For 36" wide fabrics allow 50% additional fabric

### For Pattern Match Fabrics

3" to 14" repeat allow 15% additional fabric

15" to 19" repeat allow 20% additional fabric

20" to 27" repeat allow 25% additional fabric

28" to 36" repeat allow 30% additional fabric

Nucraft may add a charge for sewing, cutting and matching unusual COM or COL materials to cover additional costs. Call customer service for pricing.

## It is the sole responsibility of the customer to determine that the fabric is appropriate for the application in which it will be used.

Once COM/COL is accepted, Nucraft assumes no responsibility for its overall appearance, flammability, normal durability, color fastness or any other quality after upholstered on a Nucraft product beyond our normal quality standards.

## FIRE RESISTANCE

Nucraft will only work with textiles that meet the ACT Voluntary Performance Guidelines:

- Nucraft fabric tack panels incorporate fabrics that meet the ASTM E 84 standard US flammability test for wrapped panels.
- Nucraft upholstery fabrics for benches and cushions must meet one or more of the following flammability tests; NFPA 260, NFPA 701, or CAL 117.
- All COM fabrics must meet the required flammability standards per fabric application.
- Nucraft reserves the right to decline any fabrics that do not meet ACT standard flammability requirements.

## COM LEATHER SPECIFICS

The following is a guide for specifying leather requirements. The guide is based on the following general information.

A full "domestic" hide is approximately 50-60 square feet. A specialty or calf hide is approximately 35 square feet. Of this footage there are various non-usable areas included in the hide's size. Conversion of fabric yardage to leather is approximately 1 yard = 18 square feet.

### Bench Requirements

48" benches will require 1/2 domestic hide or 1 full calf hide.

60" benches will require 1 domestic hide or 2 calf hides.

72" benches will require approximately 1 full domestic hide or 3 calf hides.

The boxing around the seat, if required, will have 4-6 seams that will be placed aesthetically based on the yield and usable remains of the hides.