

NUCRAFT

Tova Installation Instructions

ID:

Before Beginning Installation

- Read through the entire instruction thoroughly.
- A minimum of 2 persons is required for this assembly.
- These instructions reflect typical assemblies. They may not match your specific configuration.

Required Tools

- Allen Wrench
- Socket Set
- Glide Wrench
- Drill Driver
- #2 Phillips Bit

Provided Hardware

- HW8009

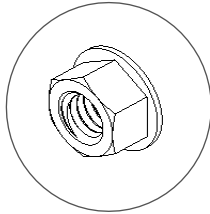

- HW2685

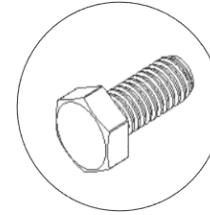

- HW1099

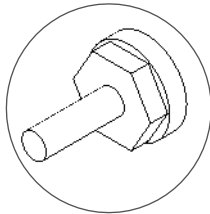

- HW2174

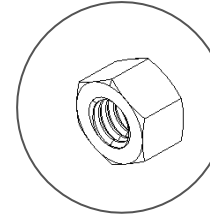

- HW0746

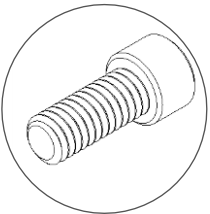

- HW1856

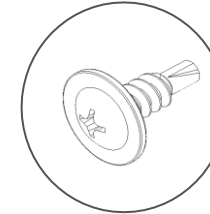

- HW0091

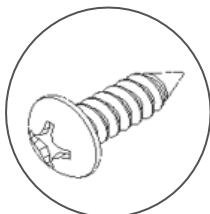

- Tite-Joint Fastener

Provided Hardware

- HW1099

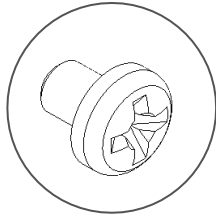

- HW0902

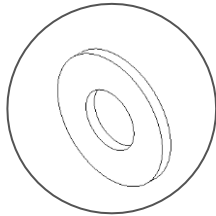

- HW2001



- HW0266

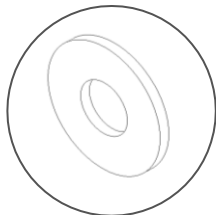

Tova

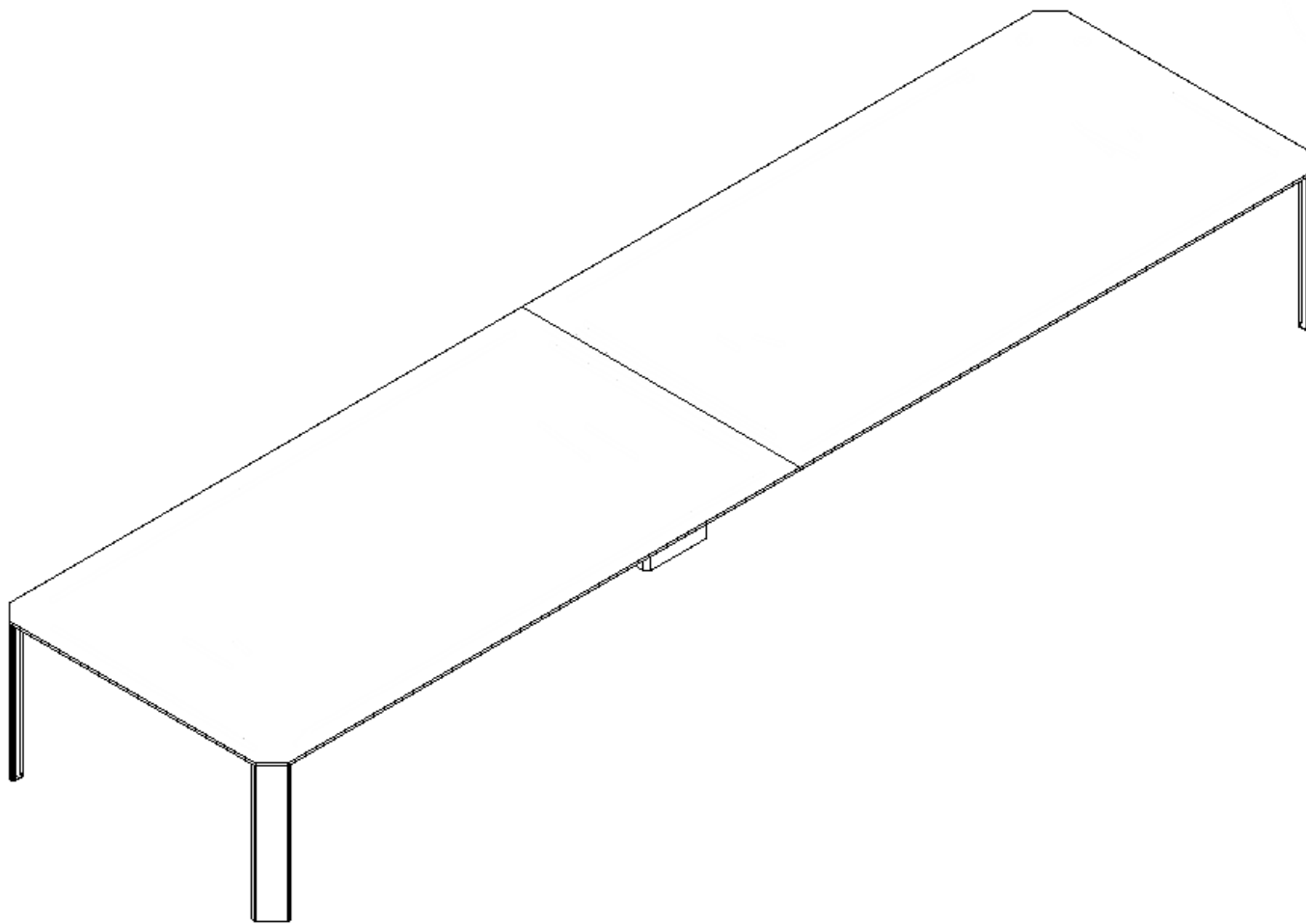

Tova Exploded View

1. Work Surface
2. Frame
3. Corner Blocks
4. Center Blocks
5. Aprons
6. Leg Assembly
7. Center Column

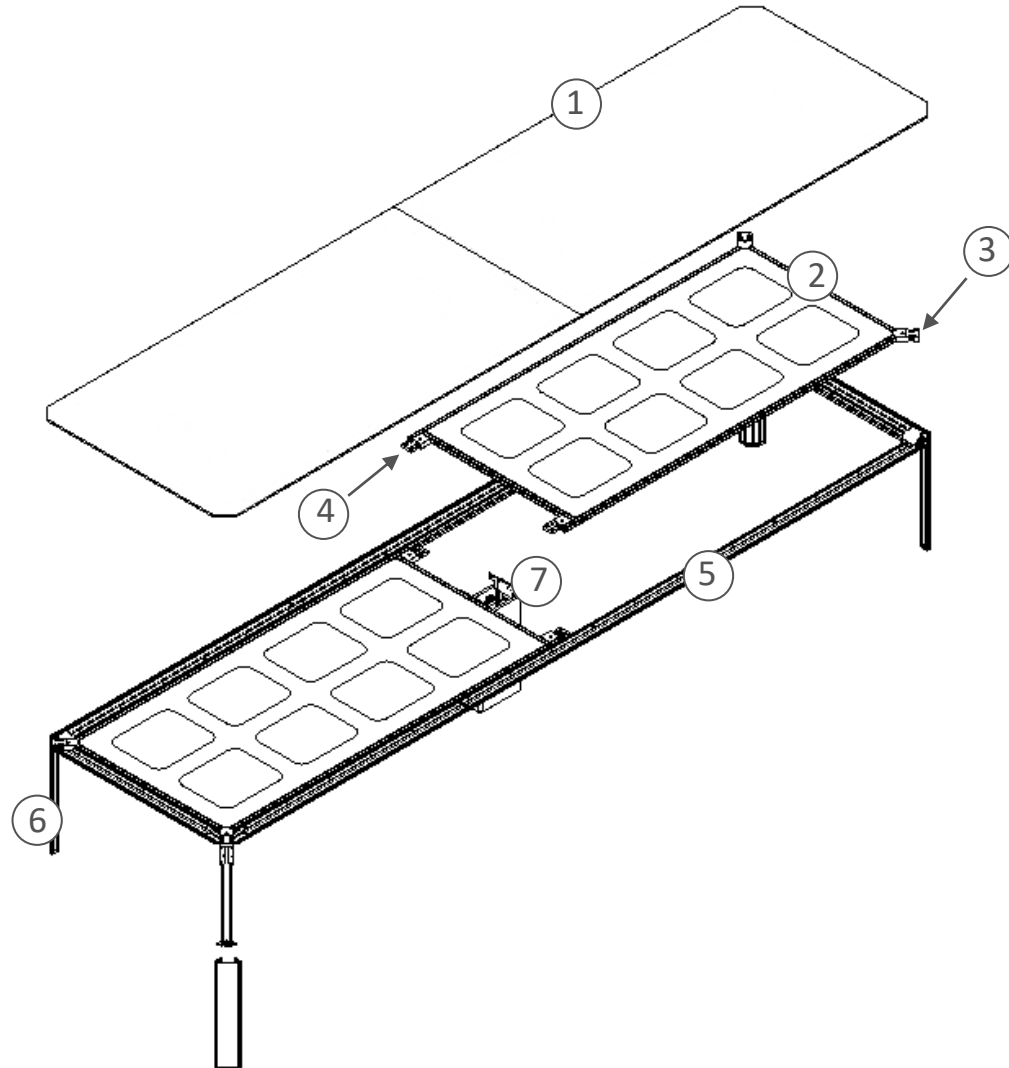

Step 1: Frames

- Set frame on the floor.
- For two-piece frames: Center Blocks will be facing up on one frame, and facing down on the other. This will allow the two halves to link together in later step.

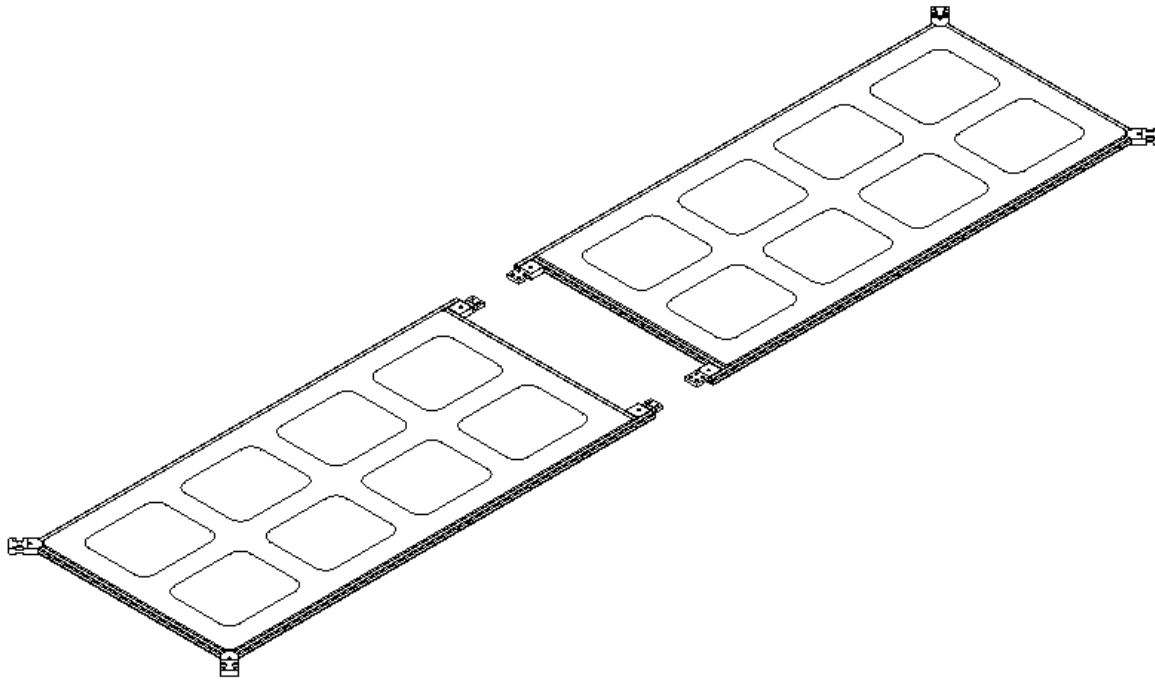

Step 2: Leg Assembly

- To create the leg assembly:
 - A. Locate the cattail structure (a preassembled set screw, lug, and threaded rod).
 - B. Secure two cattail structures to the frame's corner block.
 - C. Slide the leg extrusion over the cattails.
 - D. Place end plate over bottom of extrusion and secure with provided nuts HW8009. Screw on glide last HW8009.
- Add the legs to all 4 corner blocks.

A



B

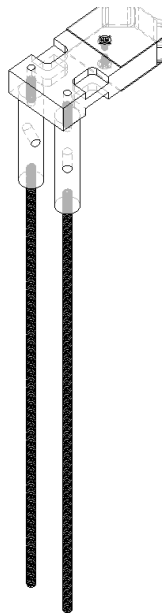

C

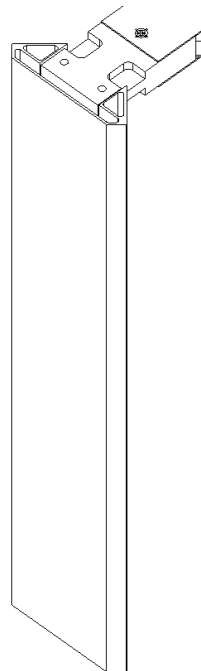

D

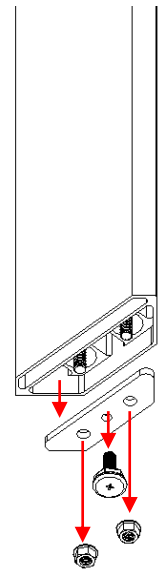

Step 3: Flip Frame

- Use the cardboard from the packaging to protect the edge of frame if necessary.
- With two people, flip the frame to the correct orientation.

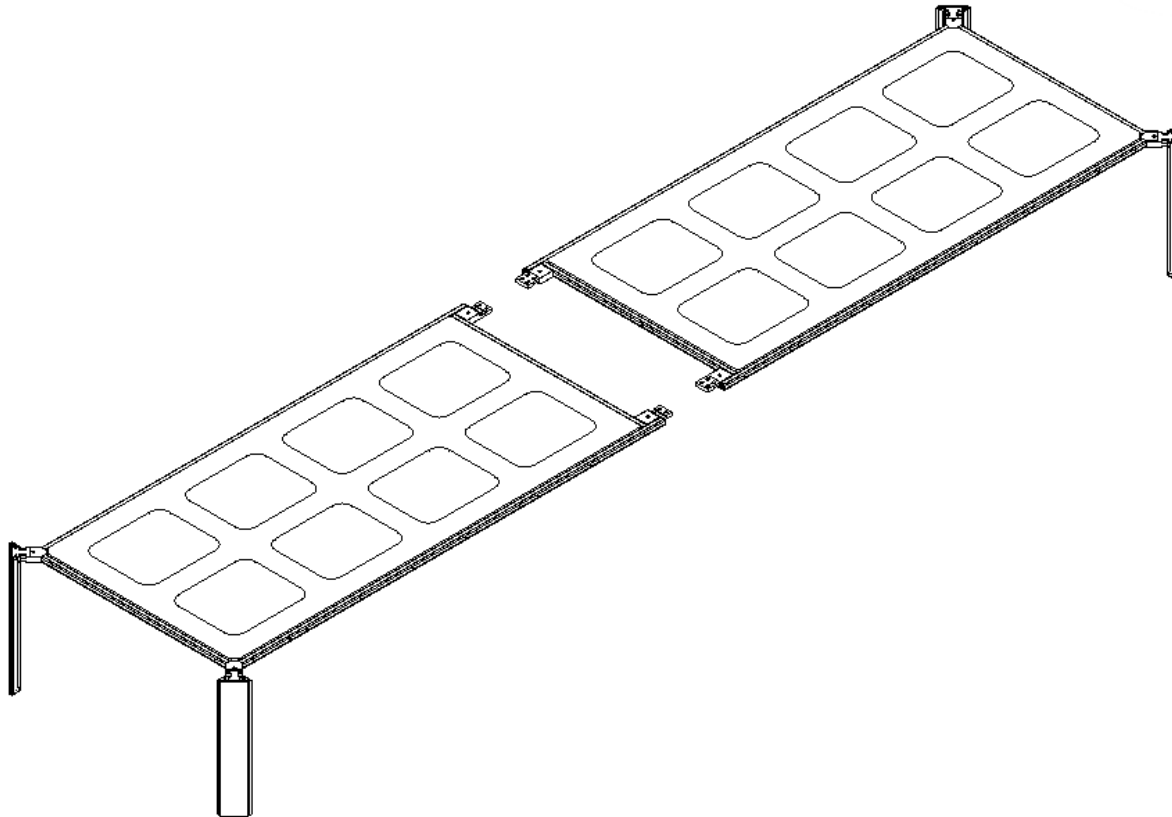

Step 4a: Frame Section 1 to Center Column

NOTE: One piece frames continue to step 5.

For the first section of a two-piece frame; secure center column to one half of the table with four hex bolts HW2685, four washers HW0266, and four nuts HW2174. Leave bolts loose until later step.

- NOTE: The first half of the frame needs to have the center blocks facing up. This will allow the second half to easily connect.

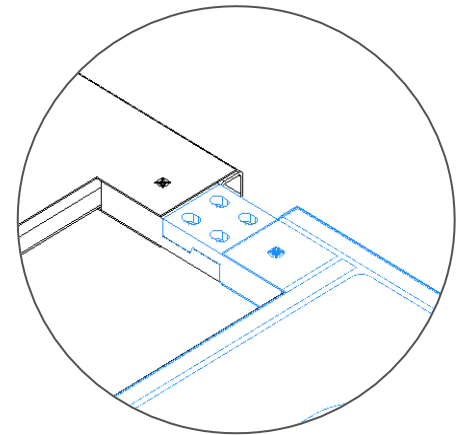
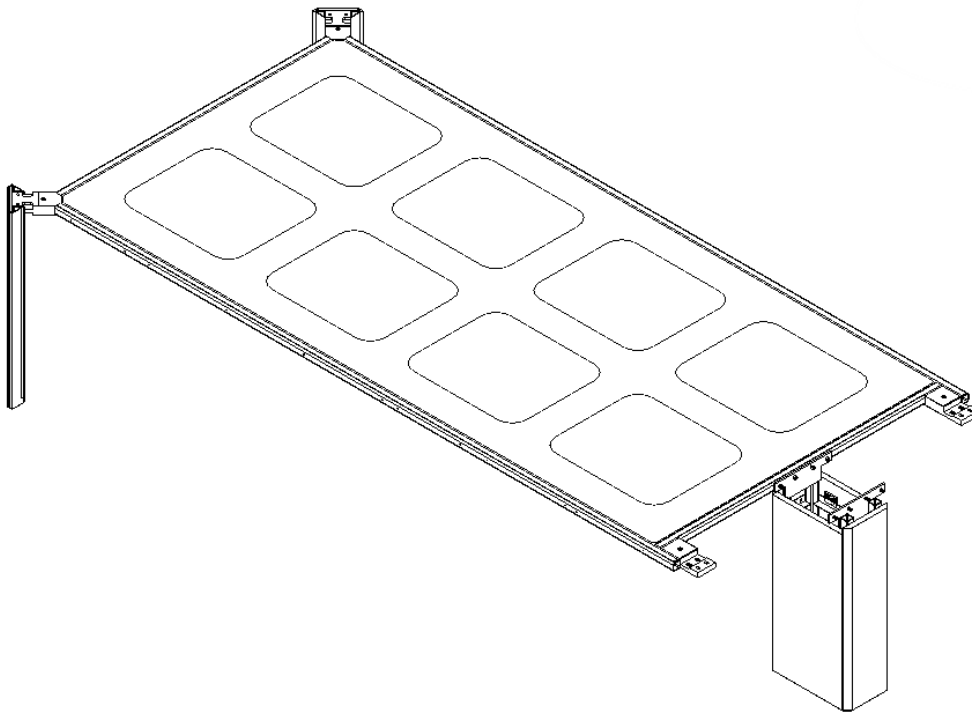

Step 4b: Frame Section 2 to Center Column

- Link the second half of the frame by hooking center blocks. Fasten the center blocks together with HW2714 nuts and HW0746 bolts.
- Secure frame to column base with four hex bolts HW2685, four washers HW0266, and four nuts HW2174.

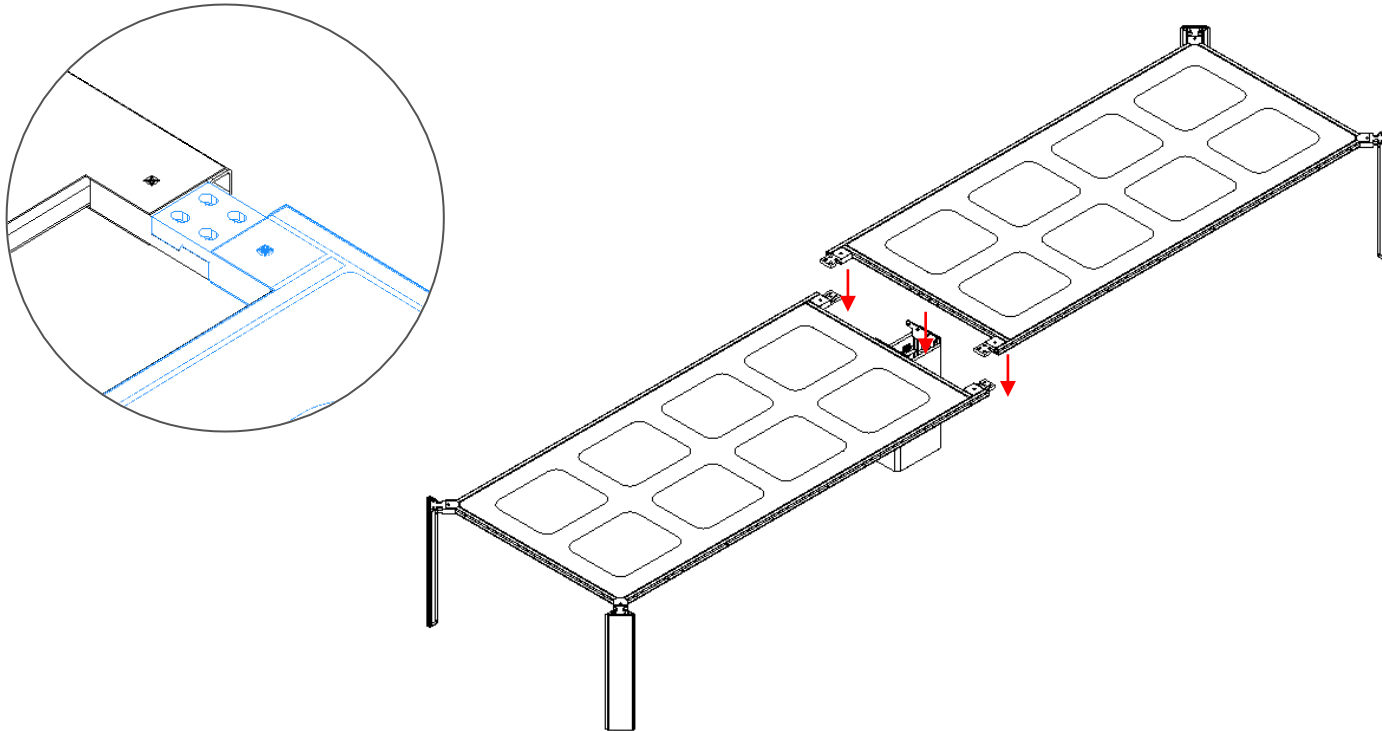

Step 5: Inner Aprons

- The apron is made up of 2 extrusions.
- Each apron extrusion is labeled with letters and are to be installed in the corresponding position.
- Align the inner extrusion to the predrilled holes in the frame. Attach loosely with screws HW2001 and washers HW0902.
- Align the extrusion to be flush with the top of the frame. Then tighten.

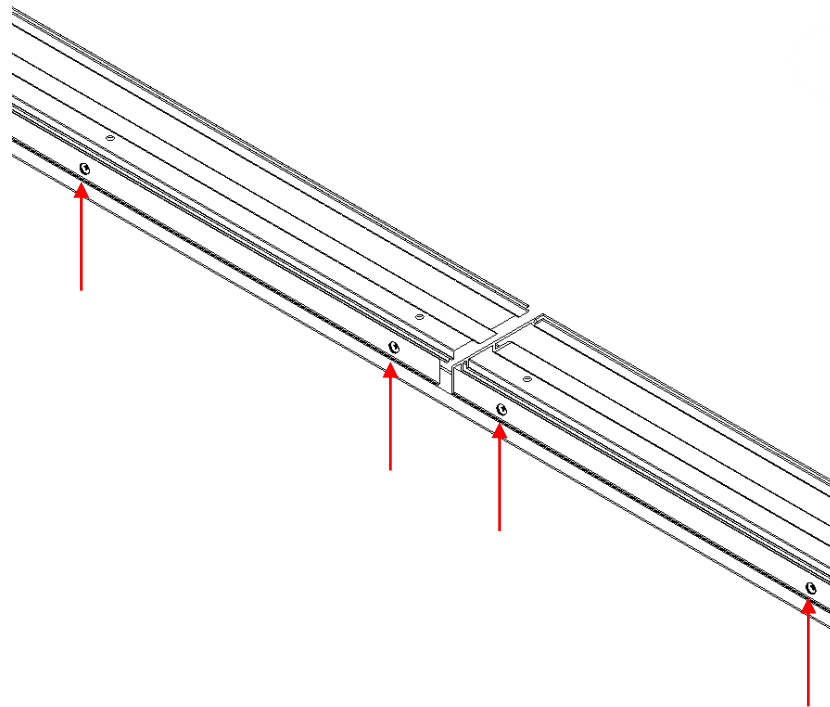

Step 6: Veneer/Laminate Work Surface

- Note: For stone and glass work surfaces, skip to step 8.
- Set veneer/laminate work surfaces onto table frame.
- Two-piece tops have tite-joint grooves at the center. Use provided hardware and tite-joint fastener tool to secure both pieces together.
- Once in place, screw HW0091 through the aprons into the inserts (on the underside of the work surface).
- Place pre-taped mending plates in the center to the top above the column base and attach with HW0091 wood screws.

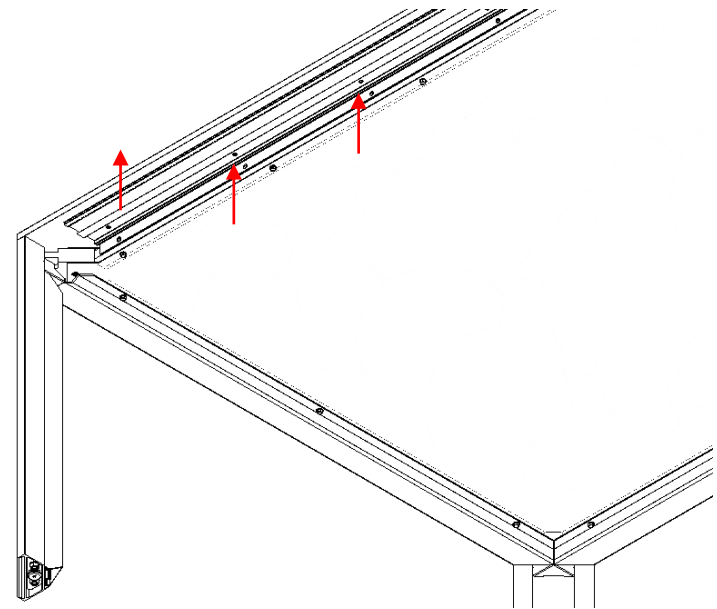
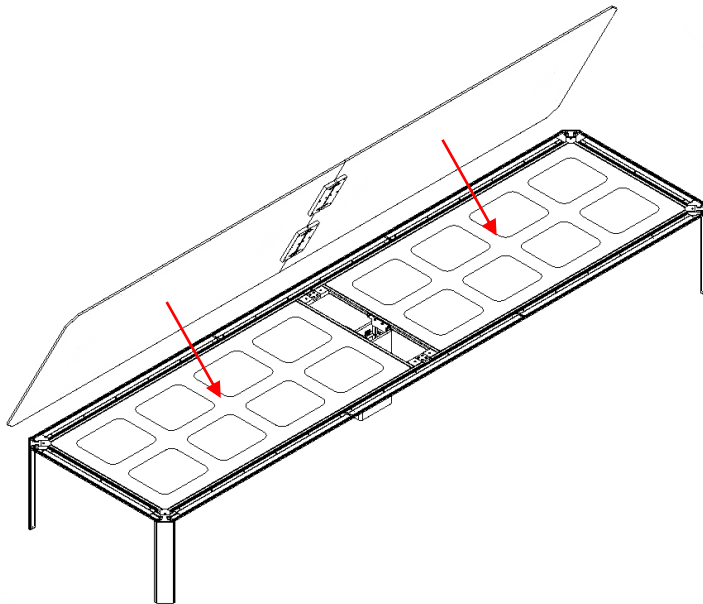

Step 7: Outer Aprons

- The apron is made up of 2 extrusions.
- The outer extrusion has to be assembled after the veneer/laminate work surfaces are in place.
- Slide the outer extrusion into the groove of the first. Secure with bolts HW3984 to the underside of the frame.
- Each apron extrusion is labeled with letters and are to be installed in the corresponding position.

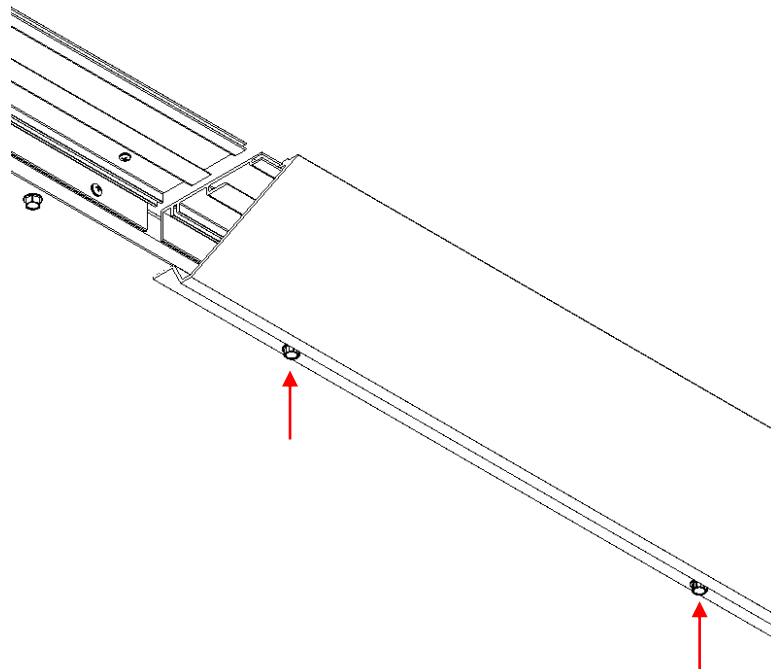

Step 8: Glass / Stone Work Surface

- Glass and stone work surfaces sit on top of the table frame.
- Both parts of the apron need to be installed before placing the glass or stone work surface on top.

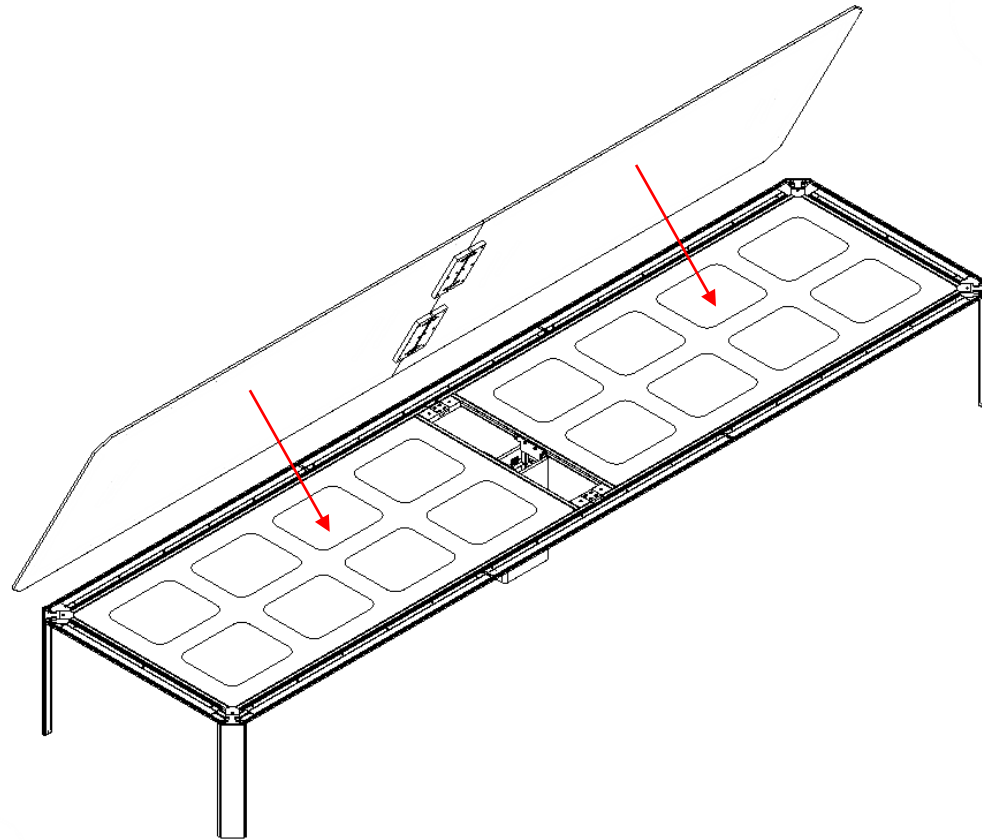

Step 9: Leg Alignment

- With the top in place, the legs may need to be aligned to the top.
- Use a rubber mallet to lightly tap the sides of the leg until it is centered to the corner.

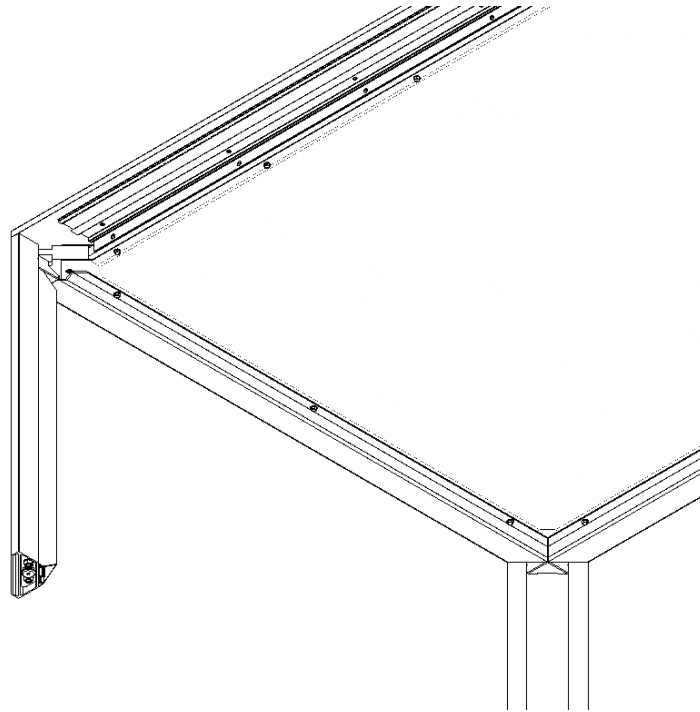

Step 10: Level Base

Use the glides on the bottom of the legs and center column to make adjustments.

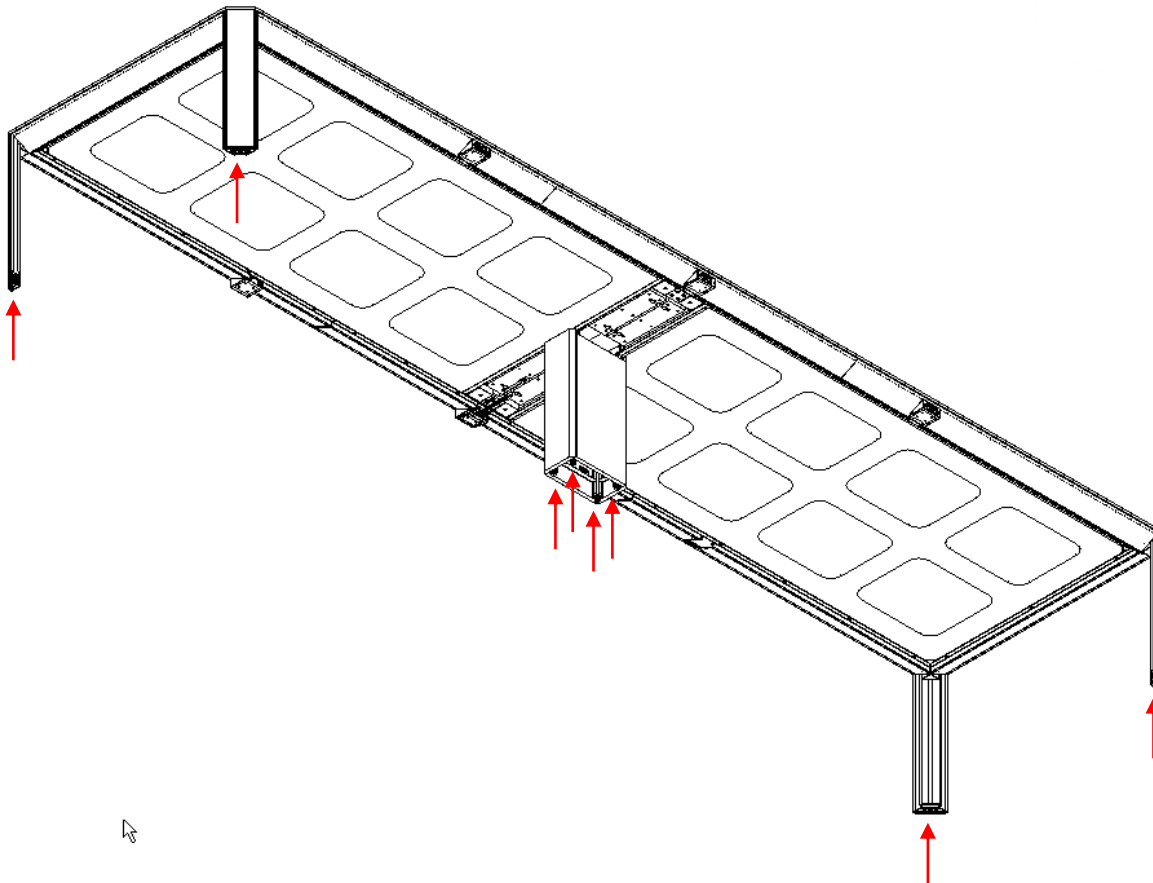

Step 11: Attach Wire Management Leg

If applicable:

- Attach leg wire manager to customer desired leg.
 - It can be placed on any of the 4 outer legs.

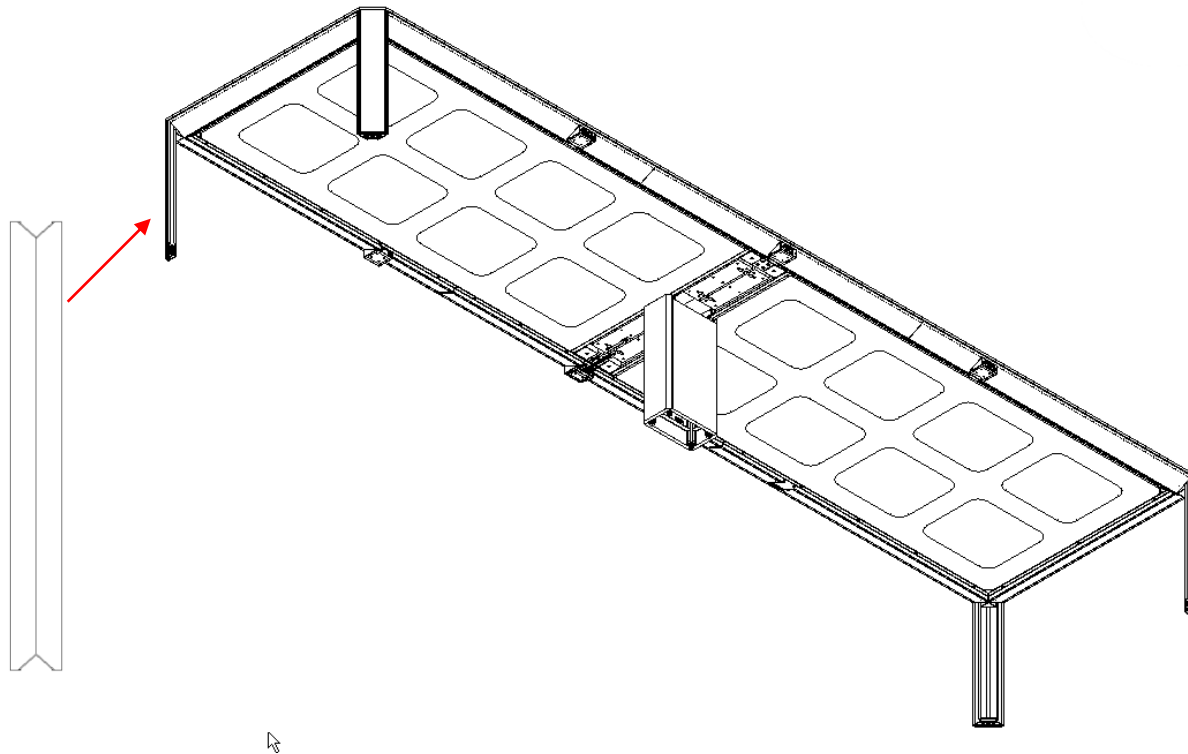

Step 12a: Wire Routing

When wire routing there are 4 components to consider:

1. Tab Power
 2. Junction Wiring
 3. Infeed Wire
 4. Wire Management Pan
- The junction wiring is the unit that connects the tab power to the infeed.
 - The infeed wire has a plug or hardwire to connect to floor core, which powers the table.
 - The wire manager pan is to be secured to the underside of the table at the spine to hold any excess wires.

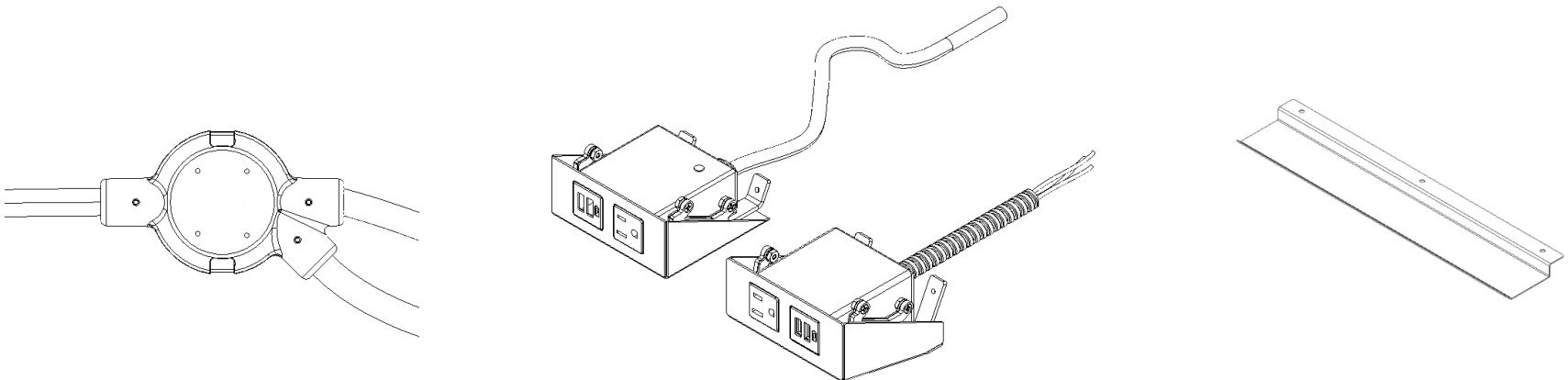

Step 12b: Wire Routing

Depending on the table configuration, here are a few suggested wire routing paths.

- Begin by running the infeed wire:
 - If there is no center column, run the infeed wire through the leg with the wire manager cap.
 - If there is a center column, run the infeed wire through the center of the column.
- Next connect the tab power to the branches of the junction wiring.
- To conceal the wires underneath the table:
 - Gather the excess wires at the spine of the table. Hold in place with the wire manager pan.
 - Pre-drilled 3/32" holes accept attaching hardware HW1856.
 - Use provided clips and Velcro to further secure the wires to the underside of the table.
 - (See "x's" on image for suggested clip placement)

